

**MODELS:**

- ECOSPLIT I-II

**VERSIONS:**

- 16S112 (1296 xxx xxx)

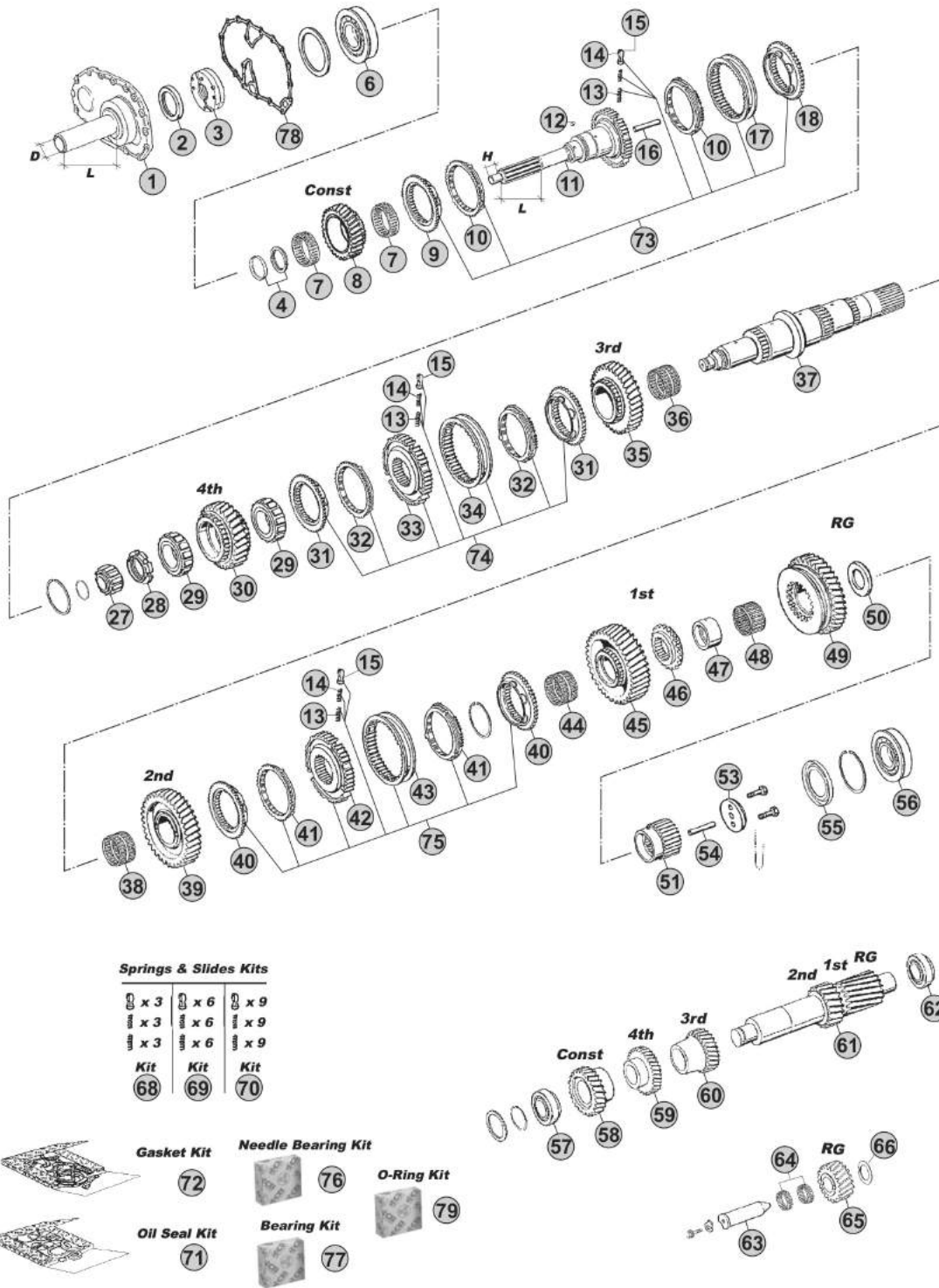

Our spare parts are not the originals but interchangeable with the originals ones. All original equipment manufacturers' numbers, pictures and models used in this catalogue are for reference only. Our products bear our trade-mark.

**Notes**

- (B) R. 11,46-0,85
- (C) R. 13,68-1,00

Our spare parts are not the originals but interchangeable with the originals ones. All original equipment manufacturers' numbers, pictures and models used in this catalogue are for reference only. Our products bear our trade-mark.

Fig.	CEI no.	ZF no.	Description	Q.ty	Notes	165112				
1	128.339	1297 302 011	Front Cover	1	(10)	●				
1	135.231	1297 302 012	Front Cover	1	(11) L=170 D=54	●				
1	128.337	1297 302 013	Front Cover	1	(12)	●				
2	139.937	0750 111 002	Oil Seal 48x75x8	1		●				
2	239.003	0634 100 182	Oil Seal	1	(13)	●				
3	280.348	1295 202 041	Oil Pump	1		●				
4	298.400	1499 298 003	Washers Kit Th. 4,00mm	1		●				
4	298.401	1499 298 002	Washers Kit Th. 3,90mm	1		●				
4	298.402	1499 298 001	Washers Kit Th. 3,80mm	1		●				
6	130.305	0750 118 131	Bearing 80x150x27,50	1		●				
6	130.517	0750 118 007	Bearing 75x150x31,5 mm	1	(20)	●				
7	137.139	0735 320 799	Needle Cage 88x96x23	2		●				
7	137.163	0735 358 155	Needle Cage	2	(20)	●				
8	145.535	1296 302 002	Constant Gear 30 T	1	B	●				
8	145.447	1296 302 003	Constant Gear 28 T	1	C	●				
8	145.448	1296 302 023	Constant Gear 28 T	1	(20) C	●				
9	109.072	1295 304 278	Synchronizer Cone	1		●				
9	109.083	1295 304 165	Synchronizer Cone	1	(20)	●				
10	119.084	1295 304 004	Synchronizer Ring	2	Old Type	●				
10	119.175	1304 304 686	Synchronizer Ring	2	New Type	●				
11	102.222	1296 202 001	Input Shaft	1	L=115 H=32	●				
11	102.576	1296 221 001	Input Shaft	1	NMV130 (Clutch PTO)	●				
11	102.577	1296 221 002	Input Shaft	1	NMV130 (Clutch PTO)	●				
11	102.248	1296 202 004	Input Shaft	1	(20) L=115 H=32	●				
11	102.229	1296 202 006	Input Shaft	1		●				
11	102.578	1296 202 010	Input Shaft	1		●				
12	171.084	0635 470 012	Needle D.7x7	1		●				
13	156.037	0732 040 385	Outer Spring De.6x34	3	3x3 pcs.	●				
14	156.036	0732 040 386	Inner Spring De.3x34	3	3x3 pcs.	●				
15	160.116	1240 304 278	Pressure Piece	3	3x3 pcs.	●				
16	188.211	0730 062 323	Oil Plug	1		●				
17	154.097	1295 304 002	Sliding Sleeve	1		●				
18	109.072	1295 304 278	Synchronizer Cone	1		●				
27	137.081	0750 118 010	Roller Cage D.30x60x25,50	1		●				
28	187.412	0737 502 092	Grooved Nut M60x1,5	1		●				
29	137.155	0750 118 012	Roller Cage D.63x97,5x31,7	2		●				
30	146.448	1296 304 091	Gear 4th Speed 28 T	1	B	●				
30	146.362	1296 304 090	Gear 4th Speed 30 T	1	C	●				
31	109.072	1295 304 278	Synchronizer Cone	2		●				
32	119.084	1295 304 004	Synchronizer Ring	2	Old Type	●				
32	119.175	1304 304 686	Synchronizer Ring	2	New Type	●				
33	157.110	1297 304 031	Synchronizer Hub	1		●				
34	154.097	1295 304 002	Sliding Sleeve	1		●				

Date

09/2014

Notes

(10) For Input shaft 1296 202 006

(11) For Input shaft 1296 202 001

(12) For Input shaft 1296 221 001; 1296 221 002

(13) ONLY FOR INPUT SHAFT 1295 221 001/003 - 1296 221 001/002 - 1297 221 005/006/009

(20) SPECIAL MB VERSION. USE ITEMS MARKED (4) TOGETHER

**MODELS:**

- ECOSPLIT I-II

**VERSIONS:**

- 16S112 (1296 xxx xxx)

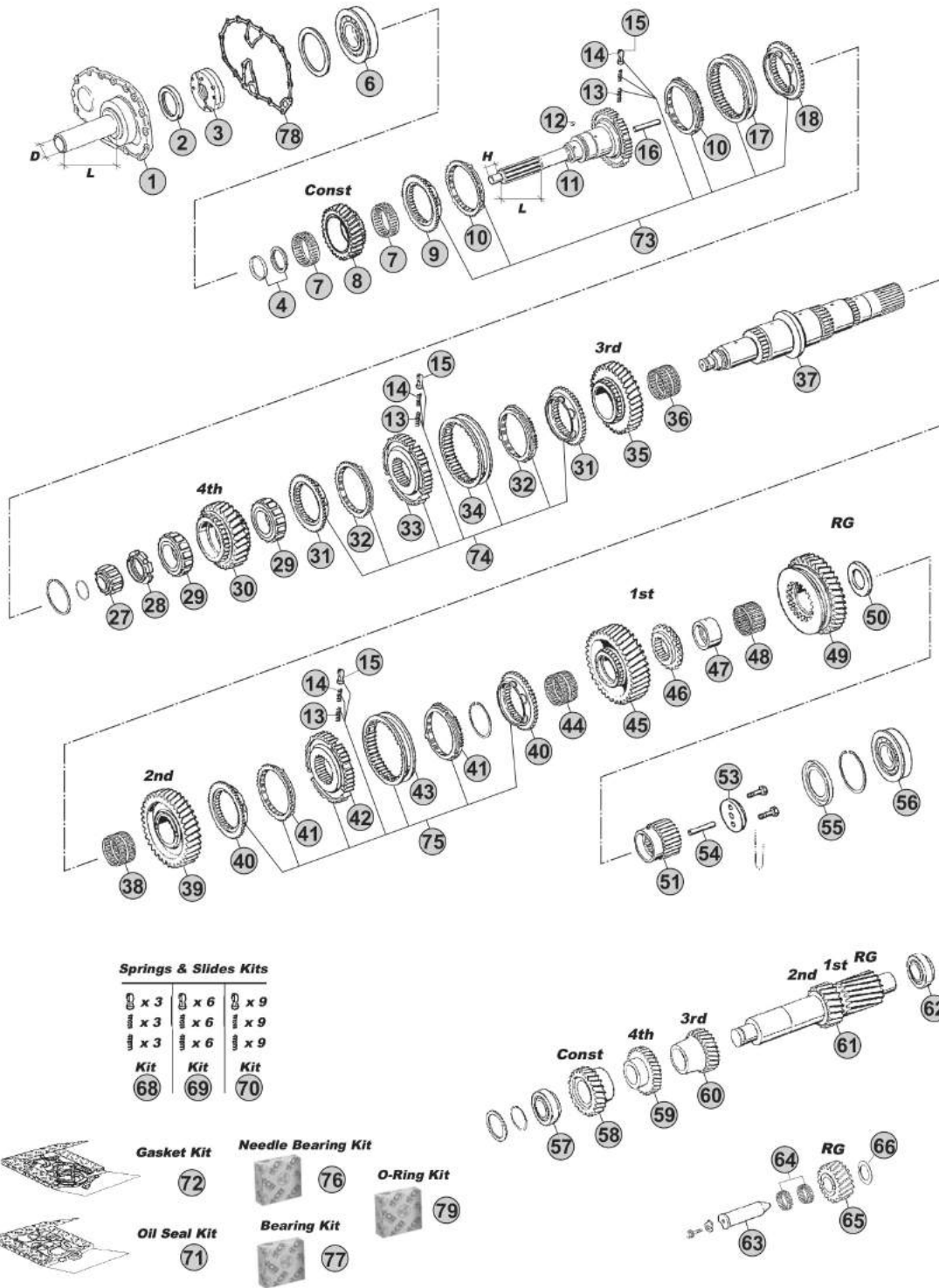

Our spare parts are not the originals but interchangeable with the originals ones. All original equipment manufacturers' numbers, pictures and models used in this catalogue are for reference only. Our products bear our trade-mark.

**Notes**

- (B) R. 11,46-0,85
- (C) R. 13,68-1,00

Our spare parts are not the originals but interchangeable with the originals ones. All original equipment manufacturers' numbers, pictures and models used in this catalogue are for reference only. Our products bear our trade-mark.

Fig.	CEI no.	ZF no.	Description	Q.ty	Notes	165112				
35	145.536	1296 304 088	Gear 3rd Speed 32 T	1	B	●				
35	145.494	1296 304 087	Gear 3rd Speed 34 T	1	C	●				
36	137.158	0735 320 460	Needle Cage D.82x90x46	1		●				
37	103.131	1296 304 119	Main Shaft	1		●				
38	137.407	0735 320 549	Needle Cage D.82x90x42	1		●				
39	145.537	1296 304 071	Gear 2nd Speed 37 T	1	B	●				
39	145.499	1296 304 070	Gear 2nd Speed 38 T	1	C	●				
40	109.074	1297 304 196	Synchronizer Cone	2		●				
40	109.072	1295 304 278	Synchronizer Cone	2	(30)	●				
41	119.125	1296 304 135	Synchronizer Ring	2	Z 54 - Alt. use 119.086	●				
41	119.086	1246 304 278	Synchronizer Ring	2	Z 42 - Alt. use 119.125	●				
41	119.084	1295 304 004	Synchronizer Ring	2	(30) Old Type	●				
41	119.175	1304 304 686	Synchronizer Ring	2	(30) New Type	●				
42	157.111	1297 304 195	Synchronizer Hub	1		●				
42	157.110	1297 304 031	Synchronizer Hub	1	(30)	●				
43	154.051	1257 304 020	Sliding Sleeve	1		●				
43	154.097	1295 304 002	Sliding Sleeve	1	(30)	●				
44	137.159	0735 320 548	Needle Cage 70x78x46	1		●				
45	145.538	1296 304 100	Gear 1st Speed 44 T	1	B	●				
45	145.505	1296 304 099	Gear 1st Speed 47 T	1	C	●				
46	109.075	1295 304 206	Synchronizer Cone	1		●				
47	117.203	1295 304 012	Bush D.60x75x38	1		●				
48	137.086	0750 115 059	Needle Cage 75x83x40	1		●				
49	147.151	1296 304 098	Reverse Gear 39 T	1	B	●				
49	147.136	1296 304 097	Reverse Gear 38 T	1	C	●				
50	169.756	1296 304 117	Thrust Washer	1		●				
51	157.211	1295 304 247	Sun Gear 27 T	1		●				
53	188.076	1272 304 021	Stop Washer	1		●				
54	189.671	0730 061 842	Oil Tube	1		●				
55	139.922	1295 304 129	Oil Collector	1		●				
56	130.240	0750 118 153	Bearing 60x130x31	1		●				
57	130.242	0750 117 010	Bearing 50,80x100x35	1		●				
58	146.449	1296 303 013	Constant Gear 31 T	1	B	●				
58	146.364	1296 303 014	Constant Gear 34 T	1	C	●				
59	146.450	1296 303 003	Gear 4th Speed 34 T	1	B	●				
59	146.363	1296 303 002	Gear 4th Speed 31 T	1	C	●				
60	146.451	1296 303 008	Gear 3rd Speed 28 T	1	B	●				
60	146.419	1296 303 009	Gear 3rd Speed 25 T	1	C	●				
61	105.117	1296 303 026	Countershaft 19/23 T	1	B	●				
61	105.104	1296 303 025	Countershaft 17/20 T	1	C	●				
62	130.307	0750 117 011	Bearing 50,8x104,7x39,6	1		●				
63	107.108	1295 305 056	Reverse Gear Pin	1		●				
64	137.007	0750 115 011	Needle Cage 45x53x21	2		●				

**Date**

09/2014

**Notes**
 (30) OLD TYPE. OLD SYNCHRO RING Ø 175,5 MM (Z 57 OR 30) -  
 STANDARD SYNCHRO RING Ø 192 MM (Z 63 OR 54) USE ITEMS  
 MARKED (6) TOGETHER



**MODELS:**

- ECOSPLIT I-II

**VERSIONS:**

- 16S112 (1296 xxx xxx)

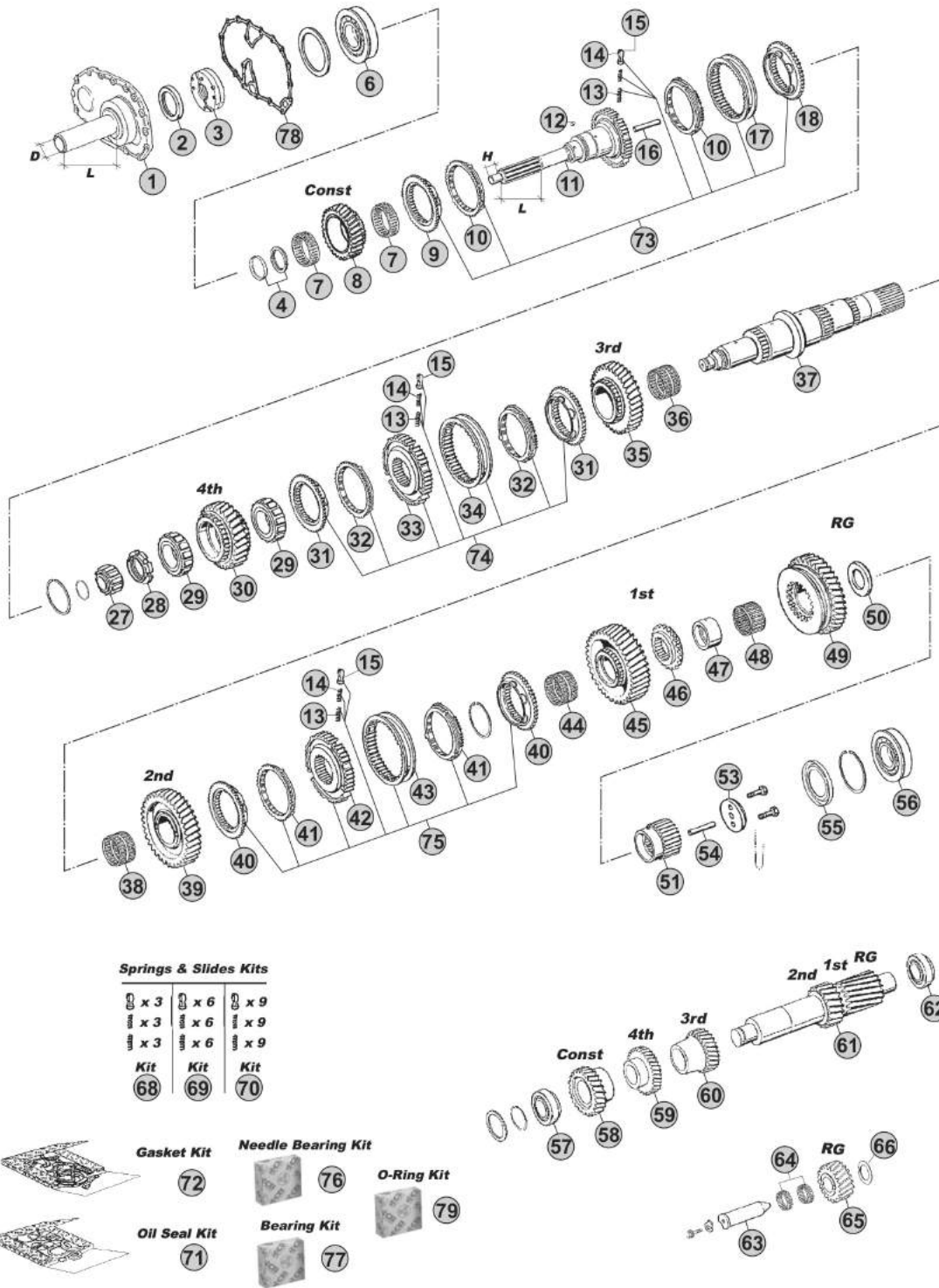

Our spare parts are not the originals but interchangeable with the originals ones. All original equipment manufacturers' numbers, pictures and models used in this catalogue are for reference only. Our products bear our trade-mark.

**Notes**

(B) R. 11,46-0,85

(C) R. 13,68-1,00

Our spare parts are not the originals but interchangeable with the originals ones. All original equipment manufacturers' numbers, pictures and models used in this catalogue are for reference only. Our products bear our trade-mark.

Fig.	CEI no.	ZF no.	Description	Q.ty	Notes	16S112				
65	147.133	1295 305 051	Reverse Gear 21 T	1	B	●				
65	147.094	1295 305 052	Reverse Gear 24 T	1	C	●				
66	169.234	0730 150 064	Thrust Washer	1		●				
68	198.339	1268 298 938	Spring Slide kit	1		●				
69	198.564		Spring Slide kit	1		●				
70	198.842	1295 298 933	Spring Slide kit	1		●				
71	198.428	1295 298 960	Oil Seal Ring Kit	1		●				
72	198.427	1295 298 915	Gasket Kit	1		●				
73	198.724	1295 298 936	Synchro Kit	1	W/"Old Type" synchro rings	●				
73	298.323	1297 298 962	Synchro Kit	1	W/"New Type" synchro rings	●				
74	198.807	1297 298 958	Synchron.Kit 3rd-4th Speed	1	W/"New Type" synchro rings	●				
75	198.809	1297 298 956	Synchron.kit 1st-2nd Speed	1		●				
76	298.403	1295 298 948	Needle cages kit	1		●				
77	298.404	1295 298 944	Bearings kit	1		●				
78	139.686	1313 302 014	Gasket	1		●				
79	298.405	1295 298 916	O-Ring Kit	1		●				

ECOSPLIT-II  
16S112

Date 09/2014 Notes \_\_\_\_\_



**MODELS:**

- ECOSPLIT I-II

**VERSIONS:**

- 16S112 (1296 xxx xxx)

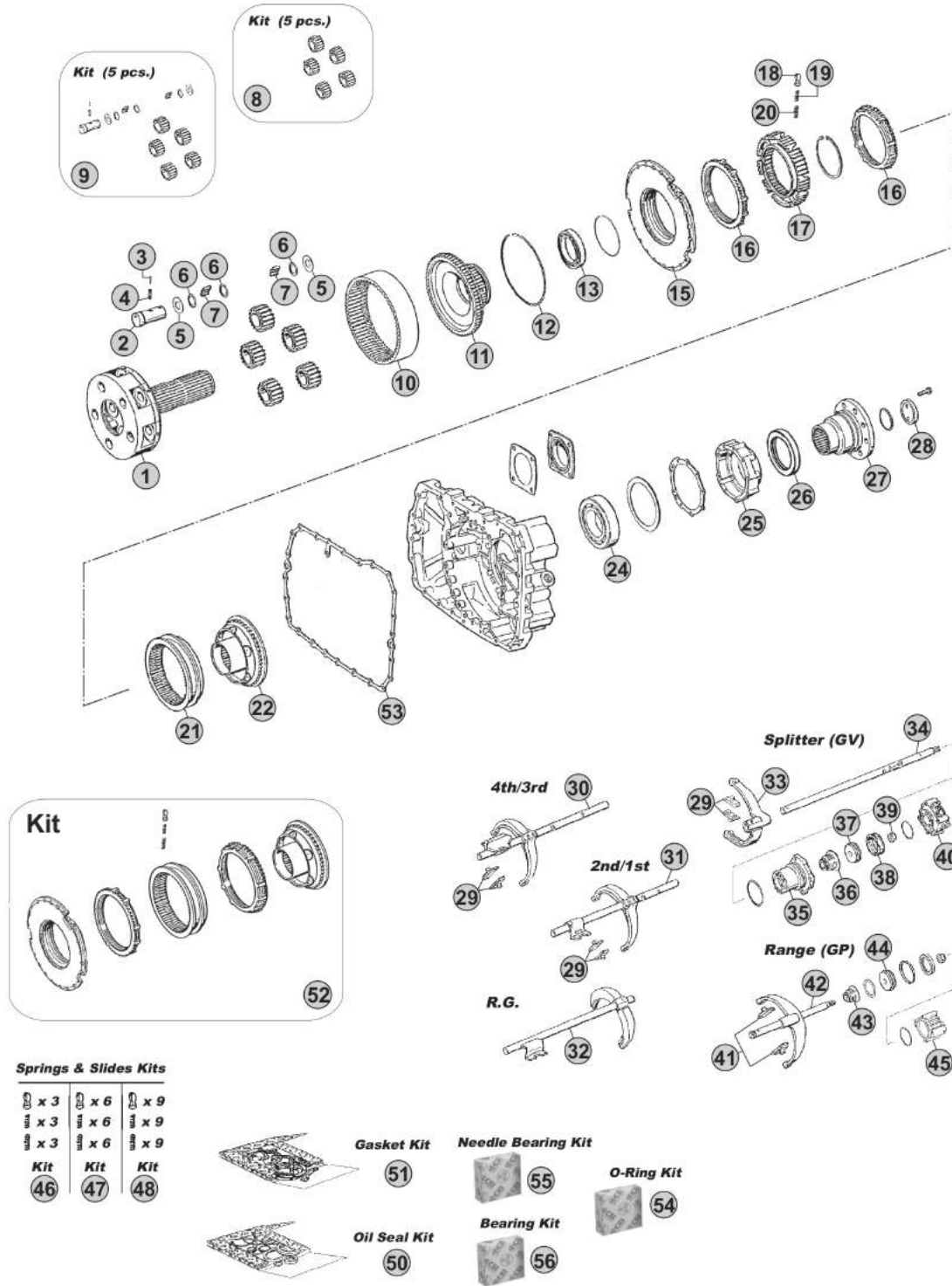

**Notes**

- (B) R. 11,46-0,85
- (C) R. 13,68-1,00

Our spare parts are not the originals but interchangeable with the originals ones. All original equipment manufacturers' numbers, pictures and models used in this catalogue are for reference only. Our products bear our trade-mark.

Our spare parts are not the originals but interchangeable with the originals ones. All original equipment manufacturers' numbers, pictures and models used in this catalogue are for reference only. Our products bear our trade-mark.

Fig.	CEI no.	ZF no.	Description	Q.ty	Notes	16S112			
1	190.169	1295 232 044	Planetary Carrier	1		●			
2	107.089	1269 332 036	Planetary Pin	5		●			
3	160.191	0631 329 017	Lock Pin 3x24	5		●			
4	160.192	0631 329 050	Lock Pin 5x24	5		●			
5	169.408	0501 305 887	Thrust Washer 29x57,5x1,5	10		●			
6	169.410	0730 103 846	Spacer Ring 29x39x1,00	15		●			
7	171.016	0735 470 057	Needle D.6x14,75 (180 pcs)	180		●			
8	198.357	1295 232 027	Planetary Gear Set (5 pcs)	1		●			
9	198.562	1296 298 904	Planetary Gear Set	1		●			
10	123.162	1295 332 053	Crown Gear 83 T	1		●			
11	150.112	1295 332 021	Carrier Hub 83 T	1		●			
12	111.129	0730 505 055	Locking Wire	1		●			
13	130.244	0750 116 166	Bearing 75x105x16	1		●			
15	198.358	1296 233 006	Synchro Cone	1		●			
16	119.085	1296 333 022	Synchronizer Ring	2	Old Type	●			
16	119.172	1296 333 045	Synchronizer Ring	2	New Type	●			
17	157.113	1296 333 002	Synchronizer Hub	1		●			
18	160.116	1240 304 278	Pressure Piece	9		●			
19	156.036	0732 040 386	Inner Spring De.3x34	9		●			
20	156.037	0732 040 385	Outer Spring De.6x34	9		●			
21	154.098	1296 333 023	Sliding Sleeve	1		●			
22	198.359	1295 233 025	Synchronizer Cone (36 Spl.)	1		●			
24	130.245	0750 116 394	Bearing 90x160x30	1		●			
25	128.260	1296 301 067	Cover	1		●			
25	128.098	1315 301 220	Cover	1		●			
26	139.878	0750 111 341	Oil Seal 105x130x12	1		●			
27	197.235	1295 238 003	Output Flange D.165 mm	1	D.165-8 H.	●			
27	197.161	1295 338 061	Output Flange D.180 mm	1	D.180-4 H.	●			
27	197.051	1295 338 014	Output Flange D.180 mm	1	D.180-10 H.	●			
27	197.168	1295 338 059	Output Flange D.180 mm	1	D.180-10 H.	●			
28	188.077	1295 332 051	Stop Washer	1		●			
28	188.250	1295 332 064	Stop Washer	1	Only with 1295 238 003	●			
29	141.068	1295 306 132	Bronze Slide	2	3x2 pcs.	●			
30		1296 206 064	Fork	1		●			
30		1296 206 061	Fork	1		●			
31		1296 206 063	Fork	1		●			
31		1296 206 062	Fork	1		●			
32		1296 206 077	Fork	1		●			
32		1296 206 078	Fork	1		●			
33	141.086	1313 312 002	Shift Yoke	1		●			
34	149.277	1296 312 001	Selector Rod	1		●			
35	132.046	1296 312 042	Cylinder	1		●			
36	139.331	0750 112 034	Cap Collar 25x38x14,2	1		●			

ECOSPLIT I-II  
16S112

Date

09/2014

Notes



**MODELS:**

- ECOSPLIT I-II

**VERSIONS:**

- 16S112 (1296 xxx xxx)

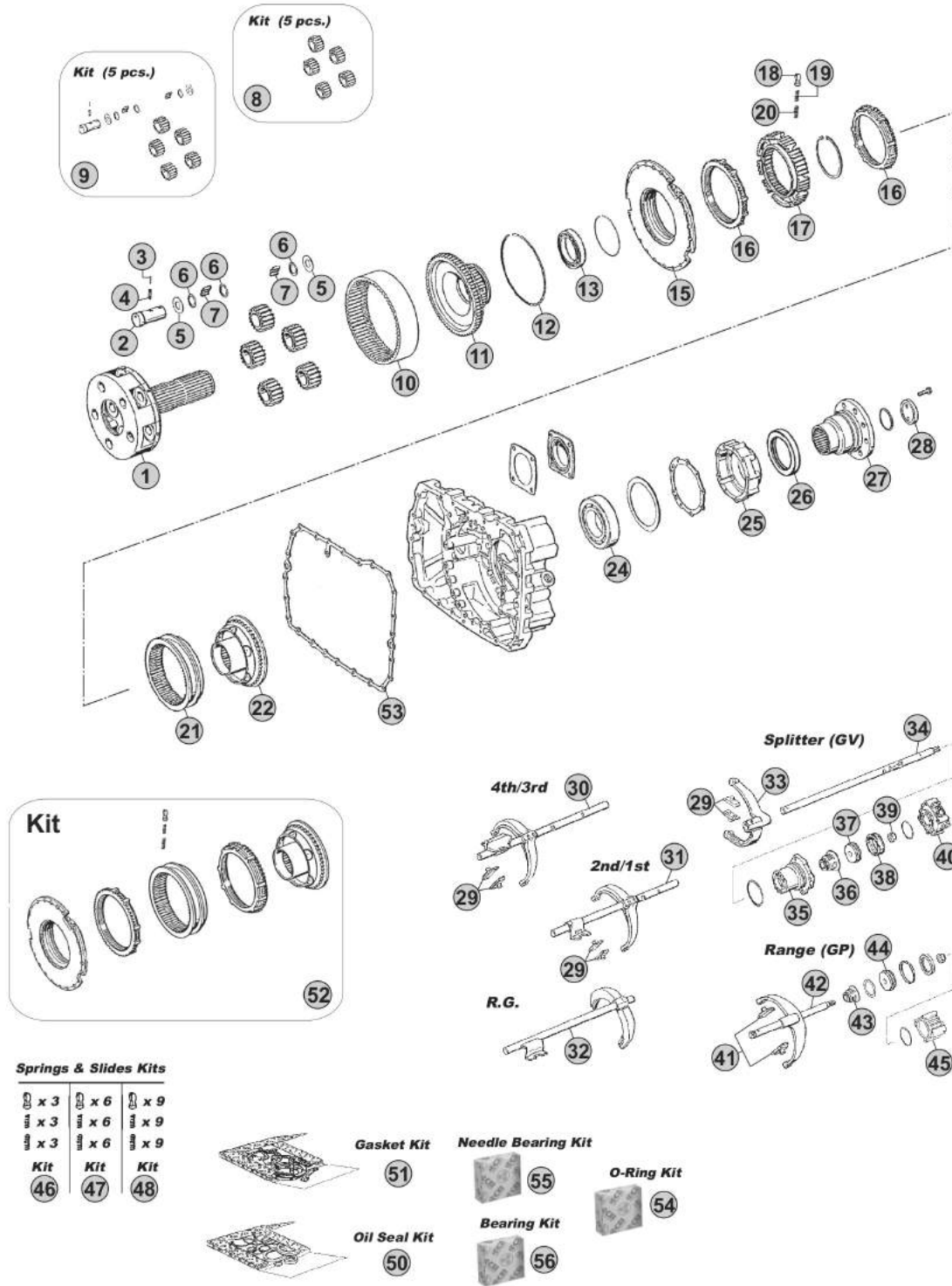

**Notes**

- (B) R. 11,46-0,85
- (C) R. 13,68-1,00

Our spare parts are not the originals but interchangeable with the originals ones. All original equipment manufacturers' numbers, pictures and models used in this catalogue are for reference only. Our products bear our trade-mark.

Our spare parts are not the originals but interchangeable with the originals ones. All original equipment manufacturers' numbers, pictures and models used in this catalogue are for reference only. Our products bear our trade-mark.

Fig.	CEI no.	ZF no.	Description	Q.ty	Notes	165112				
37	189.421	1296 312 053	Piston	1		●				
38	139.912	0750 112 089	Ring 53x63x16,2	1		●				
39	287.091	0737 300 037	Nut	1		●				
40	132.084	0750 132 032	Cylinder	1		●				
40	280.350	0750 132 033	Cylinder	1		●				
41	141.085	1296 334 004	Bronze Slide	2		●				
42		1313 234 011	Fork	1		●				
43	139.331	0750 112 034	Cap Collar 25x38x14,2	1		●				
44	189.422	1296 334 039	Piston	1		●				
45	132.047	1295 334 075	Cylinder	1		●				
46	198.339	1268 298 938	Spring Slide kit	1		●				
47	198.564		Spring Slide kit	1		●				
48	198.842	1295 298 933	Spring Slide kit	1		●				
50	198.428	1295 298 960	Oil Seal Ring Kit	1		●				
51	198.427	1295 298 915	Gasket Kit	1		●				
52	198.726	1295 298 937	Synchronizer kit	1	W/"Old Type" synchro rings	●				
53	139.685	1313 301 037	Gasket	1		●				
54	298.405	1295 298 916	O-Ring Kit	1		●				
55	298.403	1295 298 948	Needle cages kit	1		●				
56	298.404	1295 298 944	Bearings kit	1		●				

ECOSPLIT I-II  
165112

Date 09/2014 Notes \_\_\_\_\_

