

MODELS:

- ECOSPLIT I-II

VERSIONS:

- 16K130 (1295 xxx xxx)

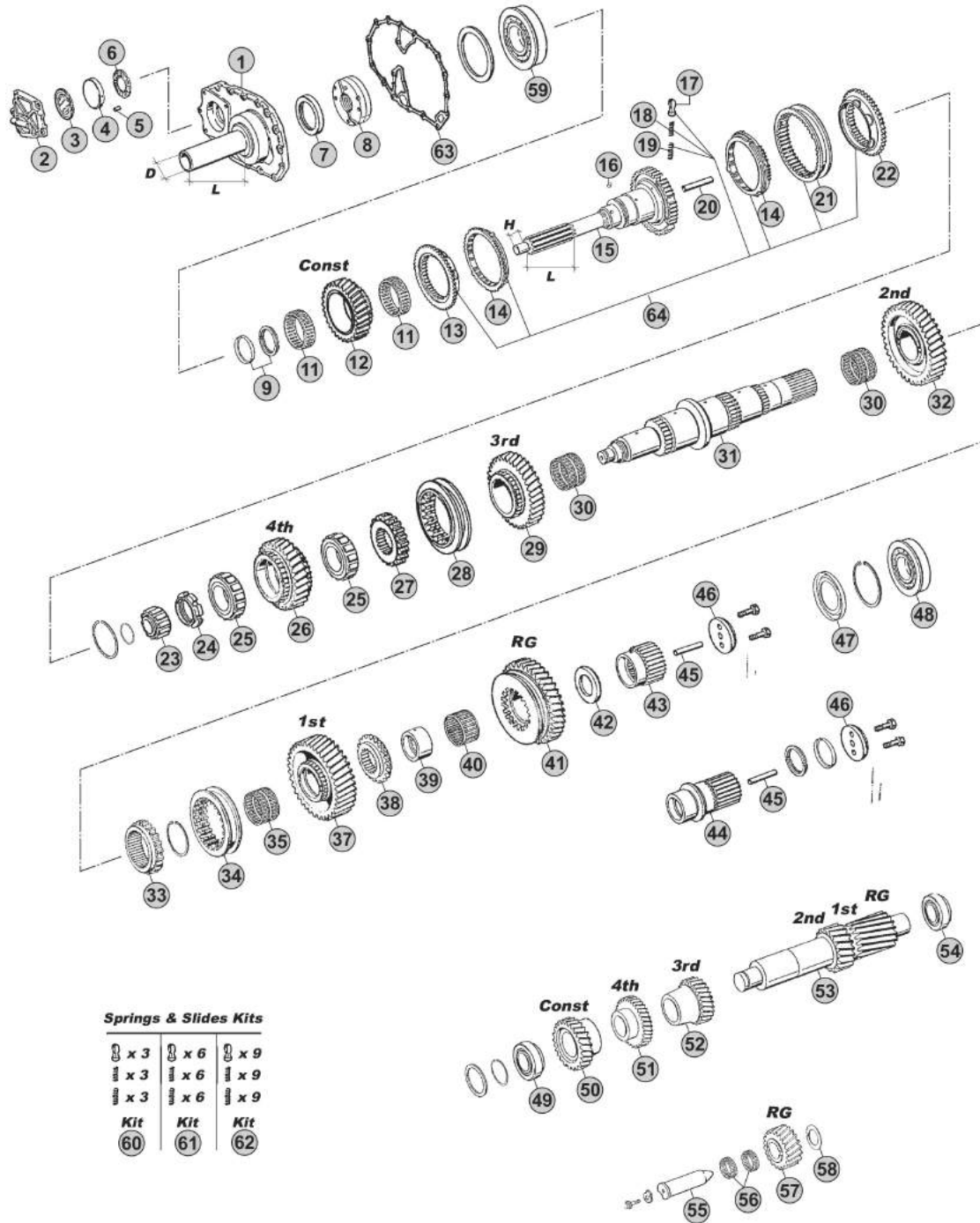

Our spare parts are not the originals but interchangeable with the originals ones. All original equipment manufacturers' numbers, pictures and models used in this catalogue are for reference only. Our products bear our trade-mark.

Notes

- (A) R. 11,46-0,85
- (B) R. 13,68-1,00
- (C) R. 14,29-0,82

Our spare parts are not the originals but interchangeable with the originals ones. All original equipment manufacturers' numbers, pictures and models used in this catalogue are for reference only. Our products bear our trade-mark.

Fig.	CEI no.	ZF no.	Description	Q.ty	Notes	16K130			
1	128.366	1297 302 018	Front Cover	1	(9) L=170 D=54	●			
1	128.367	1297 302 053	Front Cover	1	(9) L=170 D=60	●			
1	128.223	1297 302 019	Front Cover	1	(8)	●			
1	128.368	1297 302 238	Front Cover	1	(9)	●			
2	128.369	1295 303 030	Oil Pump Cover	1		●			
2	128.344	1295 303 031	Oil ring cover	1		●			
3	269.072	0750 190 012	Washer	1		●			
4	188.275	1268 303 062	Piston	1		●			
5	160.318	0731 302 032	Pin	1		●			
6	269.670	1268 203 059	Washer	1		●			
7	239.003	0634 100 182	Oil Seal	1	(13)	●			
7	139.937	0750 111 002	Oil Seal 48x75x8	1	(14)	●			
7	139.879	0734 310 387	Oil Seal 55x75x8	1	(15)	●			
8	280.348	1295 202 041	Oil Pump	1		●			
9	298.402	1499 298 001	Washers Kit Th. 3,80mm	1		●			
9	298.401	1499 298 002	Washers Kit Th. 3,90mm	1		●			
9	298.400	1499 298 003	Washers Kit Th. 4,00mm	1		●			
11	137.082	0735 320 786	Needle Cage 88x96x24,50	2		●			
12	145.489	1295 302 070	Constant Gear 30 T	1	A	●			
12	145.276	1295 302 071	Constant Gear 28 T	1	B	●			
12	145.541	1295 302 122	Constant Gear 29 T	1	C	●			
13	109.072	1295 304 278	Synchronizer Cone	1		●			
14	119.084	1295 304 004	Synchronizer Ring	2	Old Type	●			
14	119.175	1304 304 686	Synchronizer Ring	2	New Type	●			
15	102.230	1295 202 004	Input Shaft	1	L=118 H=32	●			
15	102.232	1295 202 007	Input Shaft	1		●			
15	102.579	1295 221 001	Input Shaft	1	NMV130 (Clutch PTO)	●			
15	102.254	1295 202 039	Input Shaft	1		●			
16	171.084	0635 470 012	Needle D.7x7	1		●			
17	160.116	1240 304 278	Pressure Piece	3		●			
18	156.036	0732 040 386	Inner Spring De.3x34	3		●			
19	156.037	0732 040 385	Outer Spring De.6x34	3		●			
20	188.211	0730 062 323	Oil Plug	1		●			
21	154.097	1295 304 002	Sliding Sleeve	1		●			
22	109.072	1295 304 278	Synchronizer Cone	1		●			
23	137.081	0750 118 010	Roller Cage D.30x60x25,50	1		●			
24	187.588	3081 303 063	Grooved Nut M50x1.5	1		●			
25	130.435	0750 118 017	Bearing D.55x90x33	2		●			
26	146.464	1295 304 181	Gear 4th Speed 28 T	1	A	●			
26	146.465	1295 304 182	Gear 4th Speed 30 T	1	B	●			
26	146.466	1295 304 303	Gear 4th Speed 26 T	1	C	●			
27	157.208	1295 304 234	Fixed Hub 3rd/4th Speed	1		●			
28	154.211	1295 304 179	Sliding Sleeve 3rd-4th Speed	1		●			

 ECOSPLIT I-II
16K130
Date

09/2014

Notes

(9) For oil pump cover 1295 303 030

(8) For oil pump cover 1295 303 031

(13) For Input shaft 1295 221 001

(14) For Oil pump cover 1297 302 019 - 1297 302 018

(15) For Oil pump cover 1295 302 053 - 1295 302 238

MODELS:

- ECOSPLIT I-II

VERSIONS:

- 16K130 (1295 xxx xxx)

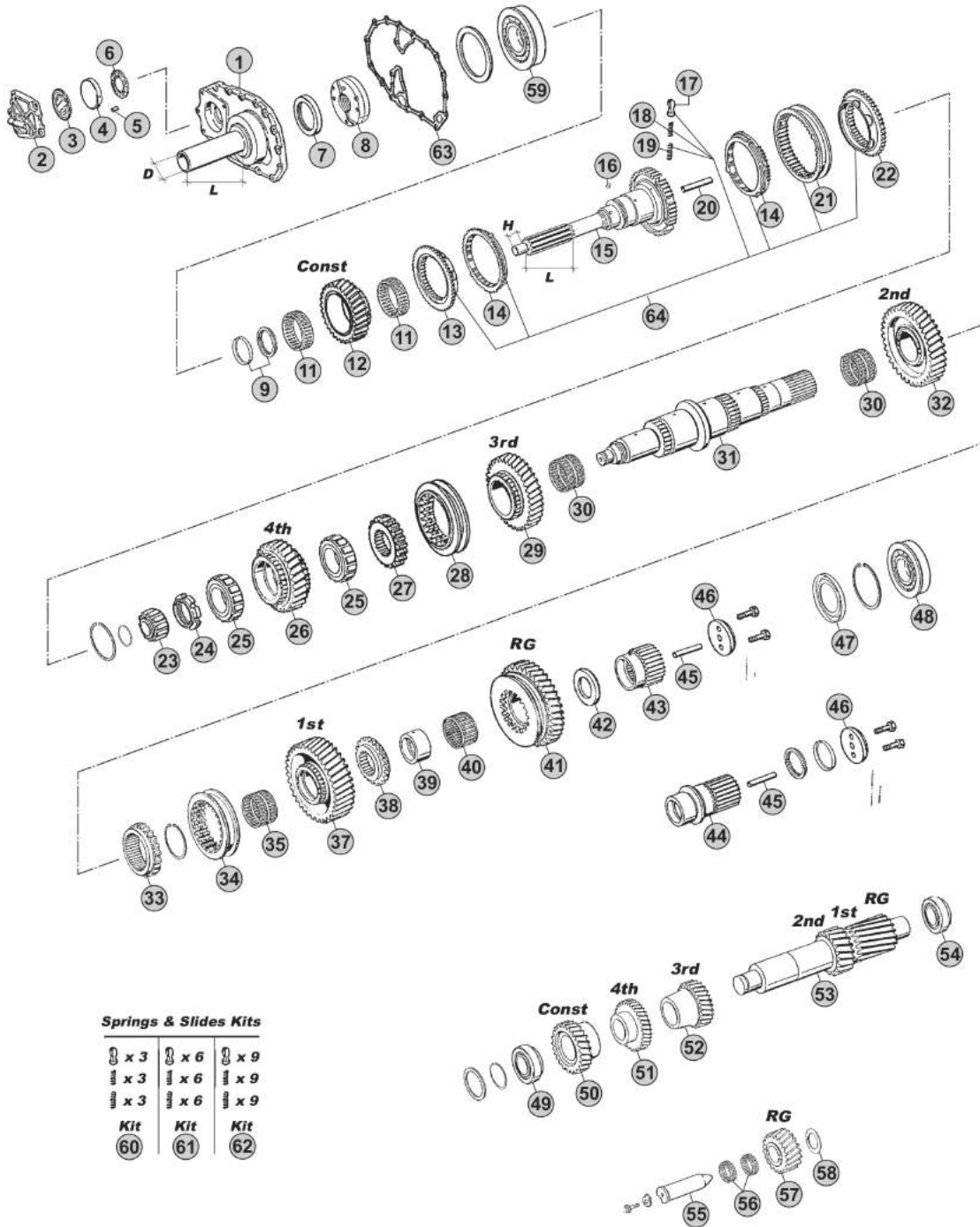

Our spare parts are not the originals but interchangeable with the originals ones. All original equipment manufacturers' numbers, pictures and models used in this catalogue are for reference only. Our products bear our trade-mark.

Notes

- (A) R. 11,46-0,85
- (B) R. 13,68-1,00
- (C) R. 14,29-0,82

Our spare parts are not the originals but interchangeable with the originals ones. All original equipment manufacturers' numbers, pictures and models used in this catalogue are for reference only. Our products bear our trade-mark.

Fig.	CEI no.	ZF no.	Description	Q.ty	Notes	16K130				
29	145.551	1295 304 188	Gear 3rd Speed 32 T	1	AC	●				
29	145.552	1295 304 187	Gear 3rd Speed 34 T	1	B	●				
30	137.158	0735 320 460	Needle Cage D.82x90x46	2		●				
31	103.141	1295 304 243	Main Shaft	1	AB	●				
31	103.142	1295 304 304	Main Shaft	1	C	●				
32	145.547	1295 304 185	Gear 2nd Speed 37 T	1	AC	●				
32	145.546	1295 304 184	Gear 2nd Speed 38 T	1	B	●				
33	157.197	1295 304 235	Fixed Hub 1st/2nd Speed	1		●				
34	154.212	1295 304 178	Sliding Sleeve 1st-2nd Speed	1		●				
35	137.406	0735 320 461	Needle Cage D.72x80x46	1		●				
37	145.548	1295 304 204	Gear 1st Speed 44 T	1	AC	●				
37	145.550	1295 304 205	Gear 1st Speed 47 T	1	B	●				
38	109.075	1295 304 206	Synchronizer Cone	1		●				
39	117.203	1295 304 012	Bush D.60x75x38	1	AB	●				
40	137.086	0750 115 059	Needle Cage 75x83x40	1		●				
41	147.138	1295 304 201	Reverse Gear 39 T	1	AC	●				
41	147.093	1295 304 200	Reverse Gear 38 T	1	B	●				
42	269.833	1295 304 241	Thrust Washer	1	AB	●				
43	157.211	1295 304 247	Sun Gear 27 T	1	AB	●				
44	157.207	1295 304 251	Sun Gear 24 T	1	C	●				
45	189.671	0730 061 842	Oil Tube	1		●				
46	188.076	1272 304 021	Stop Washer	1		●				
47	139.922	1295 304 129	Oil Collector	1	AB	●				
47	139.923	1297 301 004	Oil Collector	1	C	●				
48	130.240	0750 118 153	Bearing 60x130x31	1	AB	●				
48	130.934	0750 118 137	Bearing 80x140x26	1	C	●				
49	130.242	0750 117 010	Bearing 50,80x100x35	1		●				
50	146.354	1295 303 036	Constant Gear 31 T	1	A	●				
50	146.210	1295 303 101	Constant Gear 34 T	1	B	●				
50	146.457	1295 303 060	Constant Gear 32 T	1	C	●				
51	146.413	1295 303 028	Gear 4th Speed 34 T	1	A	●				
51	146.209	1295 303 027	Gear 4th Speed 31 T	1	B	●				
51	146.461	1295 303 094	Gear 4th Speed 35 T	1	C	●				
52	146.467	1295 303 005	Gear 3rd Speed 28 T	1	AC	●				
52	146.468	1295 303 006	Gear 3rd Speed 25 T	1	B	●				
53	105.120	1295 303 056	Countershaft 19/23 T	1	AC	●				
53	105.308	1295 303 089	Countershaft 19/23 T	1	(20) AC	●				
53	105.122	1295 303 055	Countershaft 17/20 T	1	B	●				
54	130.307	0750 117 011	Bearing 50,8x104,7x39,6	1		●				
55	107.108	1295 305 056	Reverse Gear Pin	1		●				
56	137.007	0750 115 011	Needle Cage 45x53x21	2		●				
57	147.133	1295 305 051	Reverse Gear 21 T	1	AC	●				
57	147.094	1295 305 052	Reverse Gear 24 T	1	B	●				

ECOSPLIT I-II
16K130

Date

09/2014

Notes

(20) Only for models having MNV130 (CLUTCH PTO)

MODELS:

- ECOSPLIT I-II

VERSIONS:

- 16K130 (1295 xxx xxx)

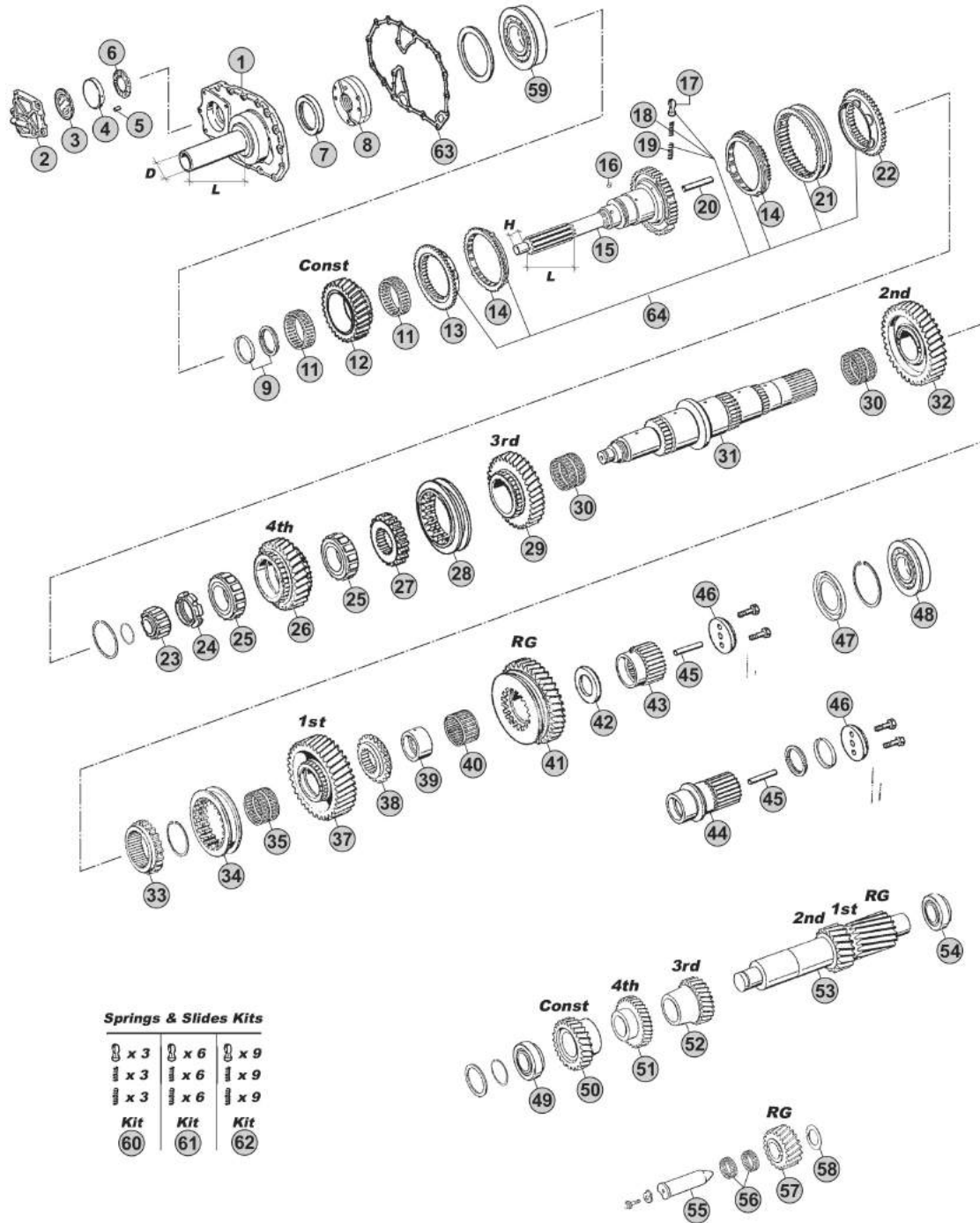

Our spare parts are not the originals but interchangeable with the originals ones. All original equipment manufacturers' numbers, pictures and models used in this catalogue are for reference only. Our products bear our trade-mark.

Notes

- (A) R. 11,46-0,85
- (B) R. 13,68-1,00
- (C) R. 14,29-0,82

MODELS:

- ECOSPLIT I-II

VERSIONS:

- 16K130 (1295 xxx xxx)

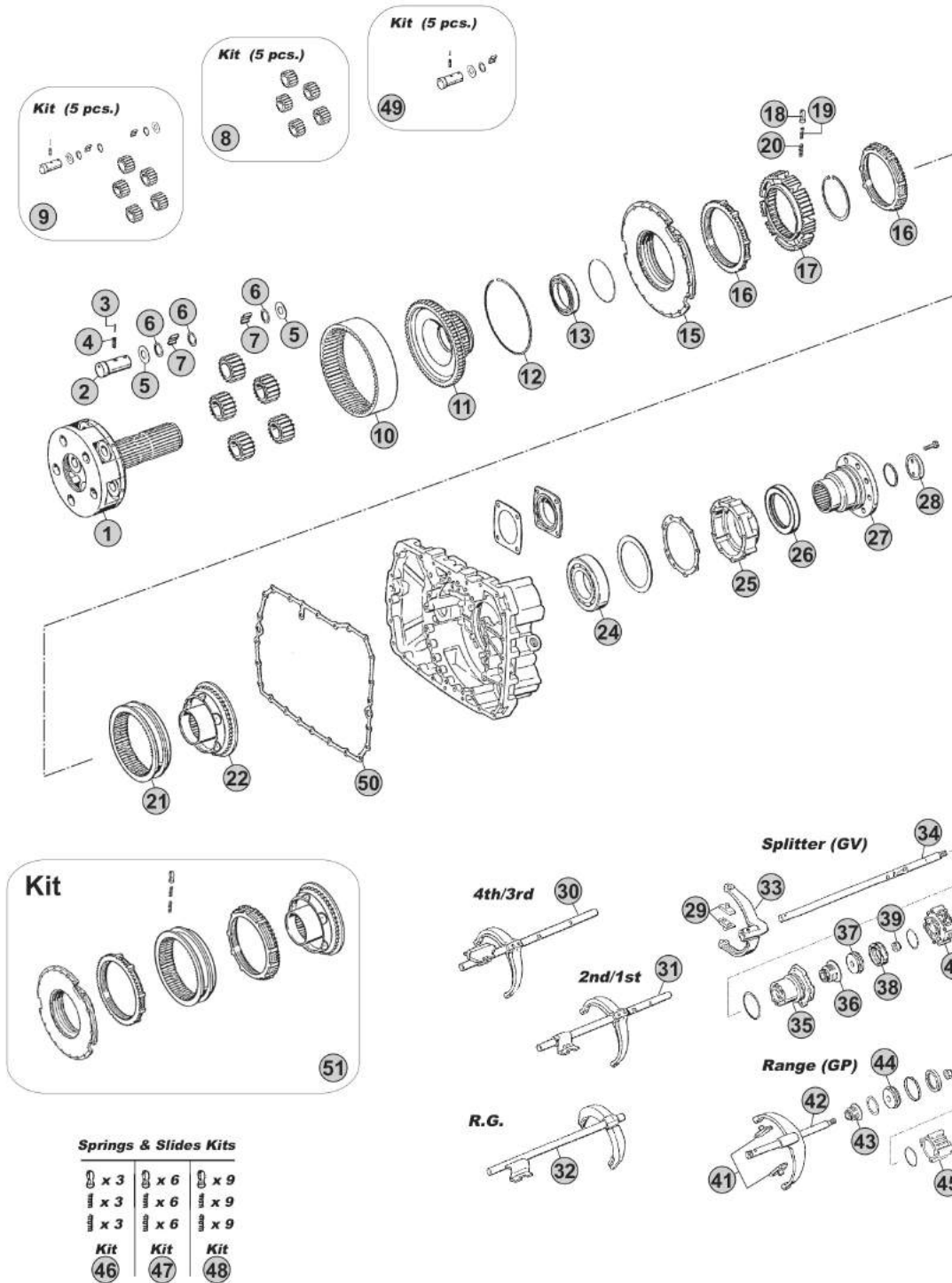

Springs & Slides Kits

x 3	x 6	x 9
x 3	x 6	x 9
x 3	x 6	x 9
Kit	Kit	Kit
46	47	48

Notes

- (A) R. 11,46-0,85
- (B) R. 13,68-1,00
- (C) R. 14,29-0,82

Our spare parts are not the originals but interchangeable with the originals ones. All original equipment manufacturers' numbers, pictures and models used in this catalogue are for reference only. Our products bear our trade-mark.

Our spare parts are not the originals but interchangeable with the originals ones. All original equipment manufacturers' numbers, pictures and models used in this catalogue are for reference only. Our products bear our trade-mark.

Fig.	CEI no.	ZF no.	Description	Q.ty	Notes	16K130				
1	190.169	1295 232 044	Planetary Carrier	1	AB	●				
1	190.555	1295 232 045	Planetary Carrier	1	C	●				
2	107.089	1269 332 036	Planetary Pin	5		●				
3	160.191	0631 329 017	Lock Pin 3x24	5		●				
4	160.192	0631 329 050	Lock Pin 5x24	5		●				
5	169.408	0501 305 887	Thrust Washer 29x57,5x1,5	10		●				
6	169.410	0730 103 846	Spacer Ring 29x39x1,00	15		●				
7	171.016	0735 470 057	Needle D.6x14,75 (180 pcs)	180		●				
8	198.357	1295 232 027	Planetary Gear Set (5 pcs)	1	AB	●				
8	198.437	1295 232 038	Planetary Gear Set (5 pcs)	1	C	●				
9	198.562	1296 298 904	Planetary Gear Set	1	AB	●				
10	123.162	1295 332 053	Crown Gear 83 T	1	AB	●				
10	123.208	1295 332 086	Crown Gear 86 T	1	C	●				
11	150.112	1295 332 021	Carrier Hub 83 T	1	AB	●				
11	150.142	1295 332 084	Carrier hub 86 T	1	C	●				
12	111.129	0730 505 055	Locking Wire	1	AB	●				
12	111.198	0730 505 056	Locking Wire	1	C	●				
13	130.244	0750 116 166	Bearing 75x105x16	1		●				
15	198.358	1296 233 006	Synchro Cone	1		●				
16	119.085	1296 333 022	Synchronizer Ring	2		●				
16	119.172	1296 333 045	Synchronizer Ring	2	New Type	●				
17	157.113	1296 333 002	Synchronizer Hub	1		●				
18	160.116	1240 304 278	Pressure Piece	9		●				
19	156.036	0732 040 386	Inner Spring De.3x34	9		●				
20	156.037	0732 040 385	Outer Spring De.6x34	9		●				
21	154.098	1296 333 023	Sliding Sleeve	1		●				
22	198.359	1295 233 025	Synchronizer Cone (36 Spl.)	1		●				
24	130.245	0750 116 394	Bearing 90x160x30	1		●				
25	128.098	1315 301 220	Cover	1		●				
25	128.260	1296 301 067	Cover	1		●				
26	139.878	0750 111 341	Oil Seal 105x130x12	1		●				
27	197.161	1295 338 061	Output Flange D.180 mm	1	D.180-4 H.	●				
27	197.051	1295 338 014	Output Flange D.180 mm	1	D.180-10 H.	●				
28	188.077	1295 332 051	Stop Washer	1		●				
29	141.068	1295 306 132	Bronze Slide	2		●				
30		1295 206 184	Fork	1		●				
30		1295 206 189	Fork	1		●				
31		1295 206 182	Fork	1		●				
31		1295 206 188	Fork	1		●				
32		1295 206 253	Fork	1		●				
32		1295 206 252	Fork	1		●				
33	141.086	1313 312 002	Shift Yoke	1		●				
34	149.275	1295 312 017	Rod	1		●				

 ECOSPLIT I-II
16K130

Date

09/2014

Notes

MODELS:

- ECOSPLIT I-II

VERSIONS:

- 16K130 (1295 xxx xxx)

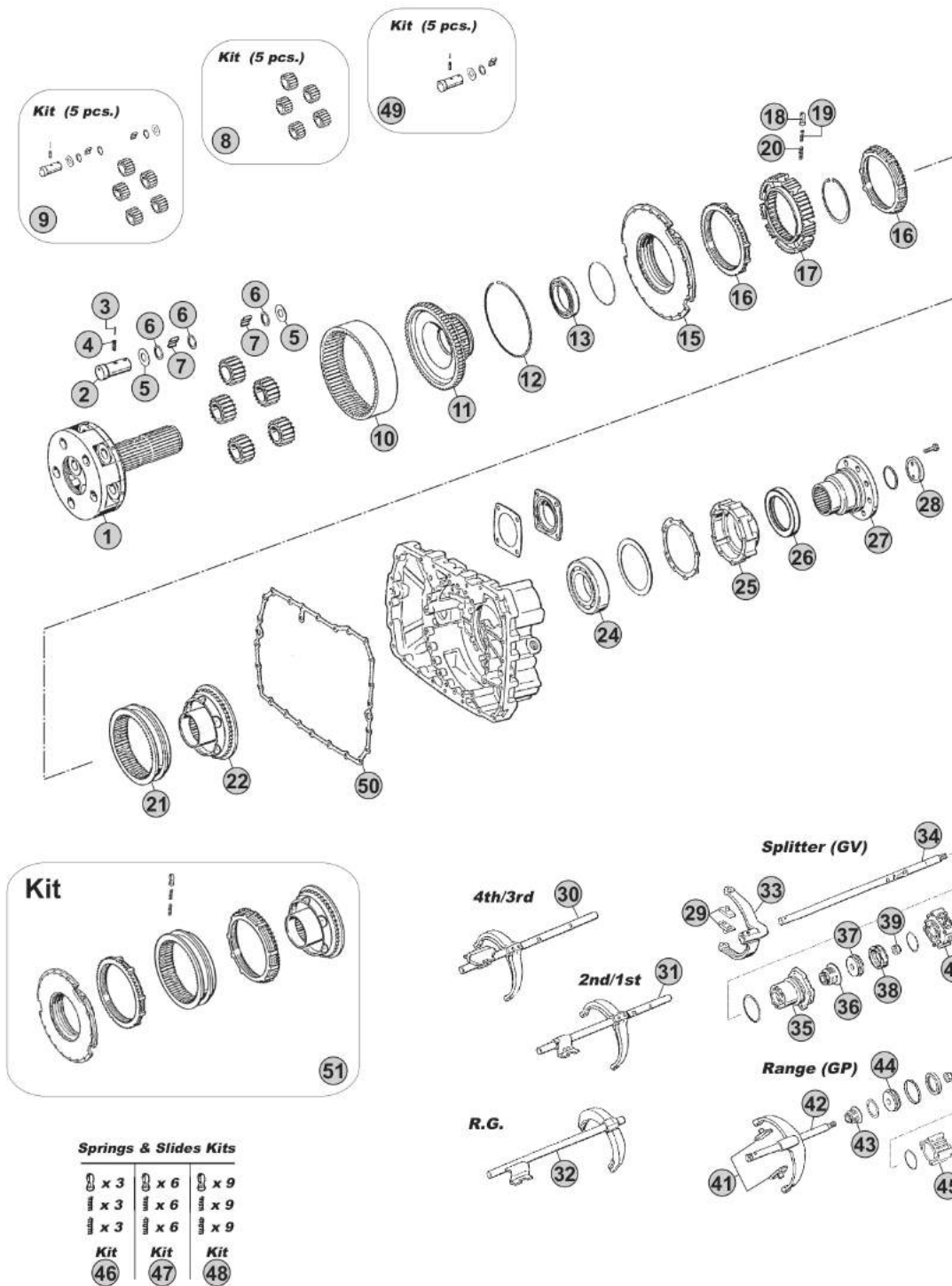

Notes

- (A) R. 11,46-0,85
- (B) R. 13,68-1,00
- (C) R. 14,29-0,82

