

MODELS:

- ECOSPLIT I-II

VERSIONS:

- 16S130 (1295 xxx xxx)

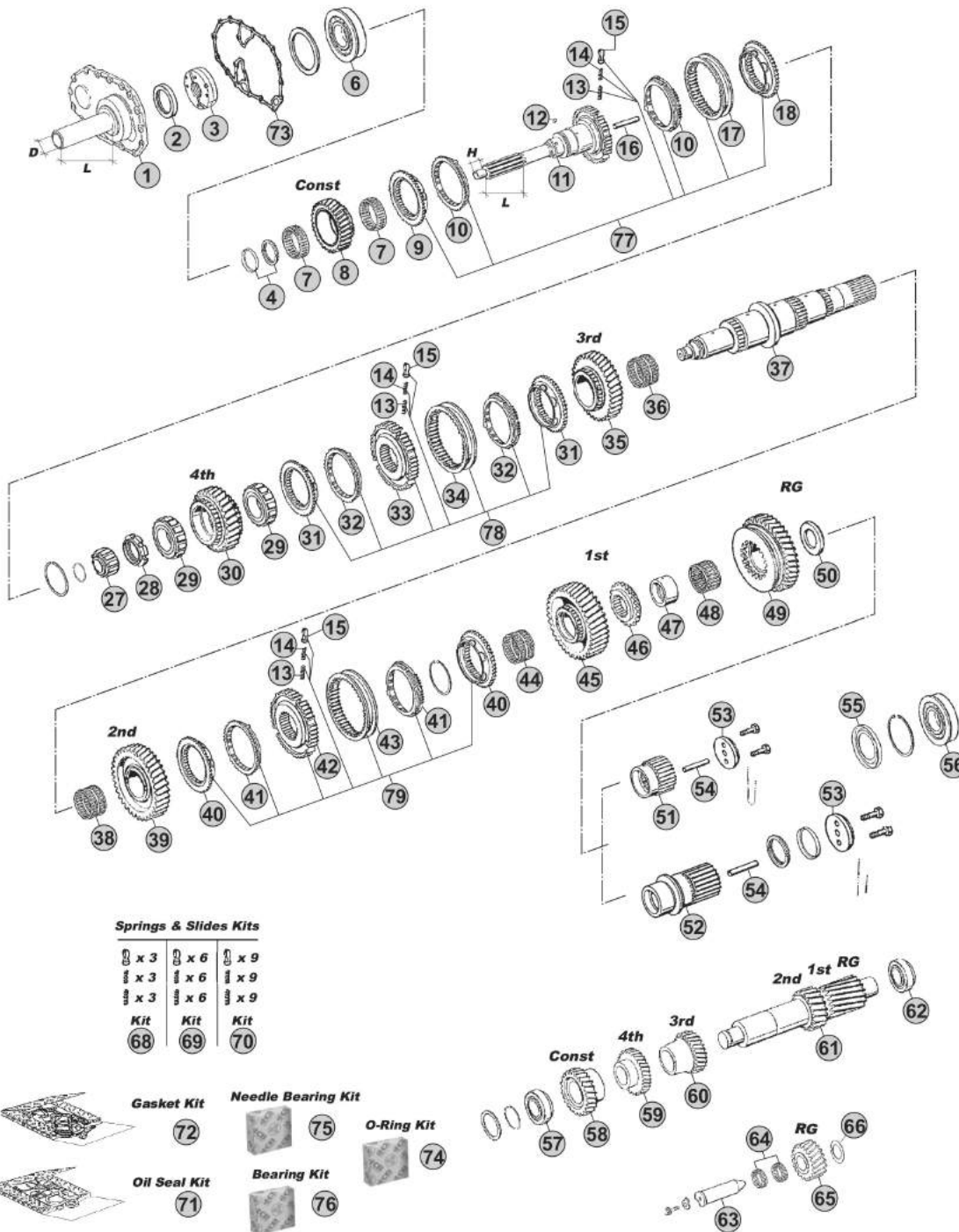

Our spare parts are not the originals but interchangeable with the originals ones. All original equipment manufacturers' numbers, pictures and models used in this catalogue are for reference only. Our products bear our trade-mark.

Notes

- (A) R. 10,14-0,72
- (B) R. 11,46-0,85
- (C) R. 13,68-1,00
- (D) R. 14,29-0,82

Our spare parts are not the originals but interchangeable with the originals ones. All original equipment manufacturers' numbers, pictures and models used in this catalogue are for reference only. Our products bear our trade-mark.

| Fig. | CEI no. | ZF no. | Description | Q.ty | Notes | 165130 | | | | |
|------|---------|--------------|-------------------------|------|---------------------|--------|--|--|--|--|
| 1 | 135.231 | 1297 302 012 | Front Cover | 1 | L=170 D=54 | ● | | | | |
| 1 | 135.201 | 1297 302 042 | Front Cover | 1 | L=170 D=60 | ● | | | | |
| 1 | 128.339 | 1297 302 011 | Front Cover | 1 | | ● | | | | |
| 1 | 128.337 | 1297 302 013 | Front Cover | 1 | | ● | | | | |
| 2 | 139.937 | 0750 111 002 | Oil Seal 48x75x8 | 1 | | ● | | | | |
| 2 | 239.003 | 0634 100 182 | Oil Seal | 1 | (13) | ● | | | | |
| 2 | 139.879 | 0734 310 387 | Oil Seal 55x75x8 | 1 | (14) | ● | | | | |
| 3 | 280.348 | 1295 202 041 | Oil Pump | 1 | | ● | | | | |
| 4 | 298.400 | 1499 298 003 | Washers Kit Th. 4,00mm | 1 | | ● | | | | |
| 4 | 298.401 | 1499 298 002 | Washers Kit Th. 3,90mm | 1 | | ● | | | | |
| 4 | 298.402 | 1499 298 001 | Washers Kit Th. 3,80mm | 1 | | ● | | | | |
| 6 | 130.305 | 0750 118 131 | Bearing 80x150x27,50 | 1 | | ● | | | | |
| 6 | 130.517 | 0750 118 007 | Bearing 75x150x31,5 mm | 1 | (20) | ● | | | | |
| 7 | 137.082 | 0735 320 786 | Needle Cage 88x96x24,50 | 2 | | ● | | | | |
| 7 | 137.163 | 0735 358 155 | Needle Cage | 2 | (20) | ● | | | | |
| 8 | 145.276 | 1295 302 071 | Constant Gear 28 T | 1 | AC | ● | | | | |
| 8 | 145.408 | 1295 302 074 | Constant Gear 28 T | 1 | (20) C | ● | | | | |
| 8 | 145.489 | 1295 302 070 | Constant Gear 30 T | 1 | B | ● | | | | |
| 8 | 145.541 | 1295 302 122 | Constant Gear 29 T | 1 | D | ● | | | | |
| 9 | 109.072 | 1295 304 278 | Synchronizer Cone | 1 | | ● | | | | |
| 9 | 109.083 | 1295 304 165 | Synchronizer Cone | 1 | (20) | ● | | | | |
| 10 | 119.084 | 1295 304 004 | Synchronizer Ring | 2 | Old Type | ● | | | | |
| 10 | 119.175 | 1304 304 686 | Synchronizer Ring | 2 | New Type | ● | | | | |
| 11 | 102.221 | 1295 202 028 | Input Shaft 57 T | 1 | L=125 H=30 | ● | | | | |
| 11 | 102.230 | 1295 202 004 | Input Shaft | 1 | L=118 H=32 | ● | | | | |
| 11 | 102.251 | 1295 202 008 | Input Shaft | 1 | L=116 H=21 | ● | | | | |
| 11 | 102.252 | 1295 202 011 | Input Shaft | 1 | L=120 H=32 | ● | | | | |
| 11 | 102.250 | 1295 202 005 | Input Shaft | 1 | | ● | | | | |
| 11 | 102.580 | 1295 202 006 | Input Shaft | 1 | | ● | | | | |
| 11 | 102.232 | 1295 202 007 | Input Shaft | 1 | | ● | | | | |
| 11 | 102.253 | 1295 202 012 | Input Shaft | 1 | | ● | | | | |
| 11 | 102.579 | 1295 221 001 | Input Shaft | 1 | NMV130 (Clutch PTO) | ● | | | | |
| 11 | 102.581 | 1295 221 002 | Input Shaft | 1 | NMV130 (Clutch PTO) | ● | | | | |
| 11 | 102.582 | 1295 221 003 | Input shaft | 1 | NMV130 (Clutch PTO) | ● | | | | |
| 11 | 102.583 | 1295 221 008 | Input Shaft | 1 | NMV130 (Clutch PTO) | ● | | | | |
| 11 | 102.231 | 1295 202 001 | Input Shaft | 1 | (20) | ● | | | | |
| 12 | 171.084 | 0635 470 012 | Needle D.7x7 | 1 | | ● | | | | |
| 13 | 156.037 | 0732 040 385 | Outer Spring De.6x34 | 3 | 3x3 pcs. | ● | | | | |
| 14 | 156.036 | 0732 040 386 | Inner Spring De.3x34 | 3 | 3x3 pcs. | ● | | | | |
| 15 | 160.116 | 1240 304 278 | Pressure Piece | 3 | 3x3 pcs. | ● | | | | |
| 16 | 188.211 | 0730 062 323 | Oil Plug | 1 | | ● | | | | |
| 17 | 154.097 | 1295 304 002 | Sliding Sleeve | 1 | | ● | | | | |
| 18 | 109.072 | 1295 304 278 | Synchronizer Cone | 1 | | ● | | | | |

Date

09/2014

Notes

(13) For Input shaft 1295 221 001/002/003/008

(14) For Input shaft 1295 202 008/013/024/025/028/039/045

(20) SPECIAL MB VERSION. USE ITEMS MARKED (4) TOGETHER

MODELS:

- ECOSPLIT I-II

VERSIONS:

- 16S130 (1295 xxx xxx)

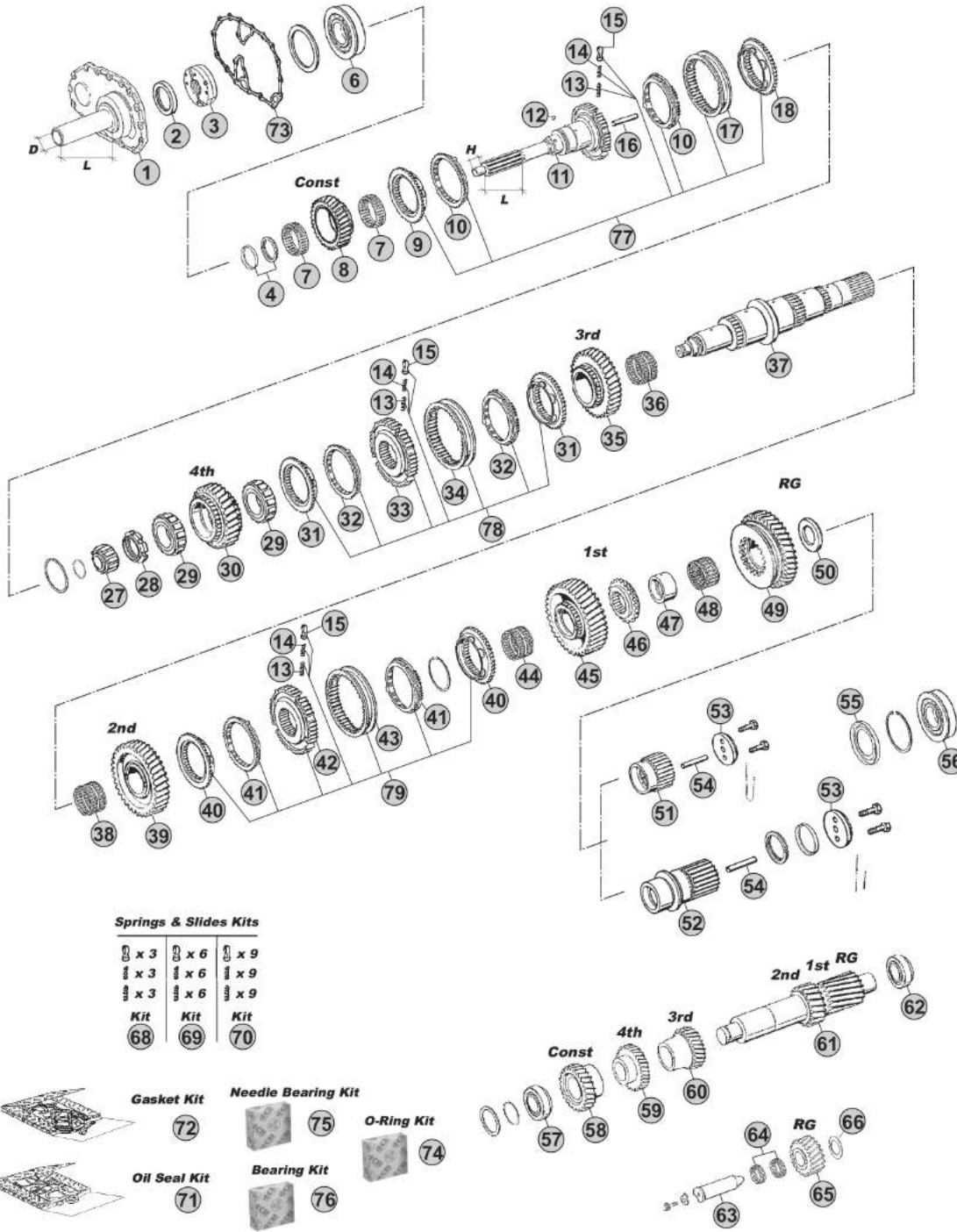

Our spare parts are not the originals but interchangeable with the originals ones. All original equipment manufacturers' numbers, pictures and models used in this catalogue are for reference only. Our products bear our trade-mark.

Notes

- (A) R. 10,14-0,72
- (B) R. 11,46-0,85
- (C) R. 13,68-1,00
- (D) R. 14,29-0,82

Our spare parts are not the originals but interchangeable with the originals ones. All original equipment manufacturers' numbers, pictures and models used in this catalogue are for reference only. Our products bear our trade-mark.

| Fig. | CEI no. | ZF no. | Description | Q.ty | Notes | 16S130 | | | | |
|------|---------|--------------|---------------------------|------|-------------------------|--------|--|--|--|--|
| 27 | 137.081 | 0750 118 010 | Roller Cage D.30x60x25,50 | 1 | | ● | | | | |
| 28 | 187.412 | 0737 502 092 | Grooved Nut M60x1,5 | 1 | | ● | | | | |
| 29 | 137.083 | 0750 118 005 | Roller Cage 63x97,5x34,80 | 2 | | ● | | | | |
| 30 | 146.212 | 1295 304 135 | Gear 4th Speed 30 T | 1 | AC | ● | | | | |
| 30 | 146.356 | 1295 304 136 | Gear 4th Speed 28 T | 1 | B | ● | | | | |
| 30 | 146.454 | 1295 304 236 | Gear 4th Speed 26 T | 1 | D | ● | | | | |
| 31 | 109.072 | 1295 304 278 | Synchronizer Cone | 2 | | ● | | | | |
| 32 | 119.084 | 1295 304 004 | Synchronizer Ring | 2 | Old Type | ● | | | | |
| 32 | 119.175 | 1304 304 686 | Synchronizer Ring | 2 | New Type | ● | | | | |
| 33 | 157.110 | 1297 304 031 | Synchronizer Hub | 1 | | ● | | | | |
| 34 | 154.097 | 1295 304 002 | Sliding Sleeve | 1 | | ● | | | | |
| 35 | 244.163 | 1295 304 269 | Gear 3rd Speed 25 T | 1 | A | ● | | | | |
| 35 | 145.495 | 1295 304 127 | Gear 3rd Speed 32 T | 1 | BD | ● | | | | |
| 35 | 145.277 | 1295 304 128 | Gear 3rd Speed 34 T | 1 | C | ● | | | | |
| 36 | 137.084 | 0735 320 418 | Needle Cage 82x90x49 | 1 | | ● | | | | |
| 37 | 103.274 | 1295 304 273 | Main Shaft | 1 | A | ● | | | | |
| 37 | 103.075 | 1295 304 245 | Main Shaft | 1 | BC | ● | | | | |
| 37 | 103.140 | 1295 304 250 | Main Shaft | 1 | D | ● | | | | |
| 38 | 137.112 | 0735 320 451 | Needle Cage 82x90x60 | 1 | A | ● | | | | |
| 38 | 137.084 | 0735 320 418 | Needle Cage 82x90x49 | 1 | BCD | ● | | | | |
| 39 | 244.164 | 1295 304 271 | Gear 2nd Speed 34 T | 1 | A | ● | | | | |
| 39 | 145.501 | 1295 304 120 | Gear 2nd Speed 37 T | 1 | BD | ● | | | | |
| 39 | 145.278 | 1295 304 121 | Gear 2nd Speed 38 T | 1 | C | ● | | | | |
| 40 | 109.074 | 1297 304 196 | Synchronizer Cone | 2 | | ● | | | | |
| 40 | 109.072 | 1295 304 278 | Synchronizer Cone | 2 | (30) | ● | | | | |
| 41 | 119.125 | 1296 304 135 | Synchronizer Ring | 2 | Z 54 - Alt. use 119.086 | ● | | | | |
| 41 | 119.086 | 1246 304 278 | Synchronizer Ring | 2 | Z 42 - Alt. use 119.125 | ● | | | | |
| 41 | 119.084 | 1295 304 004 | Synchronizer Ring | 2 | (30) | ● | | | | |
| 42 | 157.111 | 1297 304 195 | Synchronizer Hub | 1 | | ● | | | | |
| 42 | 157.110 | 1297 304 031 | Synchronizer Hub | 1 | (30) | ● | | | | |
| 43 | 154.051 | 1257 304 020 | Sliding Sleeve | 1 | | ● | | | | |
| 43 | 154.097 | 1295 304 002 | Sliding Sleeve | 1 | (30) | ● | | | | |
| 44 | 137.159 | 0735 320 548 | Needle Cage 70x78x46 | 1 | A | ● | | | | |
| 44 | 137.085 | 0735 320 496 | Needle Cage 70x78x55 | 1 | BCD | ● | | | | |
| 45 | 244.165 | 1295 304 270 | Gear 1st Speed 41 T | 1 | A | ● | | | | |
| 45 | 145.506 | 1295 304 203 | Gear 1st Speed 44 T | 1 | BD | ● | | | | |
| 45 | 145.279 | 1295 304 202 | Gear 1st Speed 47 T | 1 | C | ● | | | | |
| 46 | 109.184 | 1295 304 024 | Synchronizer Cone | 1 | A | ● | | | | |
| 46 | 109.075 | 1295 304 206 | Synchronizer Cone | 1 | BCD | ● | | | | |
| 47 | 117.203 | 1295 304 012 | Bush D.60x75x38 | 1 | ABC | ● | | | | |
| 48 | 137.086 | 0750 115 059 | Needle Cage 75x83x40 | 1 | | ● | | | | |
| 49 | 147.292 | 1295 304 272 | Reverse Gear 39 T | 1 | A | ● | | | | |
| 49 | 147.138 | 1295 304 201 | Reverse Gear 39 T | 1 | BD | ● | | | | |

Date

09/2014

Notes

(30) OLD TYPE. OLD SYNCHRO RING Ø 175,5 MM (Z 57 OR 30) -
STANDARD SYNCHRO RING Ø 192 MM (Z 63 OR 54) USE ITEMS
MARKED (6) TOGETHER

 ECOSPLIT I-II
16S130

MODELS:

- ECOSPLIT I-II

VERSIONS:

- 16S130 (1295 xxx xxx)

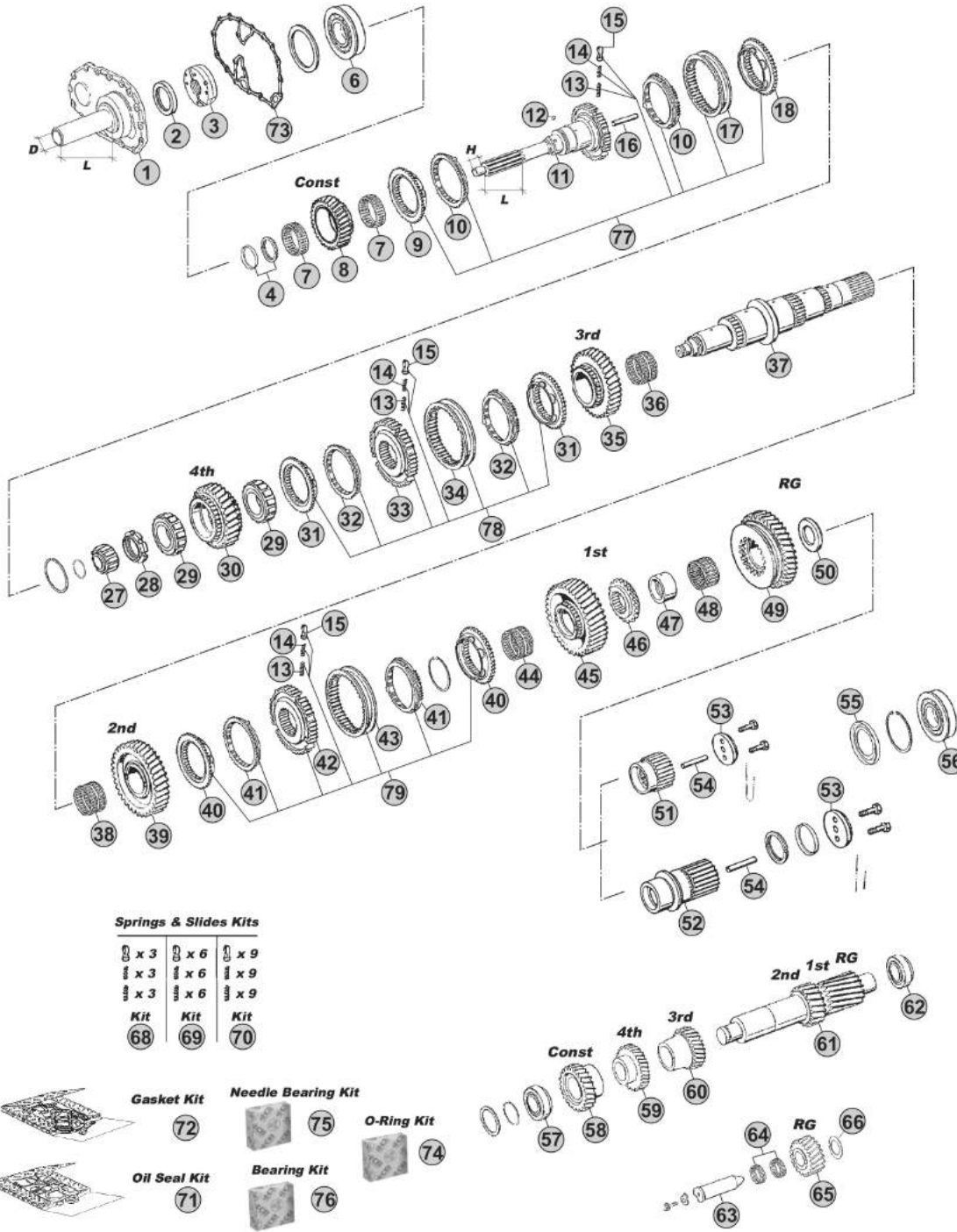

Our spare parts are not the originals but interchangeable with the originals ones. All original equipment manufacturers' numbers, pictures and models used in this catalogue are for reference only. Our products bear our trade-mark.

Notes

- (A) R. 10,14-0,72
- (B) R. 11,46-0,85
- (C) R. 13,68-1,00
- (D) R. 14,29-0,82

Our spare parts are not the originals but interchangeable with the originals ones. All original equipment manufacturers' numbers, pictures and models used in this catalogue are for reference only. Our products bear our trade-mark.

| Fig. | CEI no. | ZF no. | Description | Q.ty | Notes | 165130 | | | | |
|------|---------|--------------|----------------------------|------|----------------------------|--------|--|--|--|--|
| 49 | 147.093 | 1295 304 200 | Reverse Gear 38 T | 1 | C | ● | | | | |
| 50 | 169.409 | 1295 304 240 | Thrust Washer | 1 | ABC | ● | | | | |
| 51 | 157.112 | 1295 304 248 | Sun Gear 27 T | 1 | ABC | ● | | | | |
| 52 | 157.207 | 1295 304 251 | Sun Gear 24 T | 1 | D | ● | | | | |
| 53 | 188.076 | 1272 304 021 | Stop Washer | 1 | | ● | | | | |
| 54 | 189.671 | 0730 061 842 | Oil Tube | 1 | | ● | | | | |
| 55 | 139.922 | 1295 304 129 | Oil Collector | 1 | ABC | ● | | | | |
| 55 | 139.923 | 1297 301 004 | Oil Collector | 1 | D | ● | | | | |
| 56 | 130.240 | 0750 118 153 | Bearing 60x130x31 | 1 | ABC | ● | | | | |
| 56 | 130.934 | 0750 118 137 | Bearing 80x140x26 | 1 | D | ● | | | | |
| 57 | 130.242 | 0750 117 010 | Bearing 50,80x100x35 | 1 | | ● | | | | |
| 58 | 146.210 | 1295 303 101 | Constant Gear 34 T | 1 | AC | ● | | | | |
| 58 | 146.354 | 1295 303 036 | Constant Gear 31 T | 1 | B | ● | | | | |
| 58 | 146.457 | 1295 303 060 | Constant Gear 32 T | 1 | D | ● | | | | |
| 59 | 146.209 | 1295 303 027 | Gear 4th Speed 31 T | 1 | AC | ● | | | | |
| 59 | 146.413 | 1295 303 028 | Gear 4th Speed 34 T | 1 | B | ● | | | | |
| 59 | 146.461 | 1295 303 094 | Gear 4th Speed 35 T | 1 | D | ● | | | | |
| 60 | 146.751 | 1295 303 071 | Gear 3rd Speed 36 T | 1 | A | ● | | | | |
| 60 | 146.355 | 1295 303 025 | Gear 3rd Speed 28 T | 1 | BD | ● | | | | |
| 60 | 146.211 | 1295 303 026 | Gear 3rd Speed 25 T | 1 | C | ● | | | | |
| 61 | 105.278 | 1295 303 072 | Countershaft 19/23 T | 1 | A | ● | | | | |
| 61 | 105.119 | 1295 303 067 | Countershaft 19/23 T | 1 | BD | ● | | | | |
| 61 | 105.060 | 1295 303 066 | Countershaft 17/20 T | 1 | C | ● | | | | |
| 62 | 130.243 | 0750 117 008 | Bearing 50x110x42 | 1 | | ● | | | | |
| 63 | 107.108 | 1295 305 056 | Reverse Gear Pin | 1 | | ● | | | | |
| 64 | 137.007 | 0750 115 011 | Needle Cage 45x53x21 | 2 | | ● | | | | |
| 65 | 147.153 | 1297 305 003 | Reverse Gear 21 T | 1 | A | ● | | | | |
| 65 | 147.133 | 1295 305 051 | Reverse Gear 21 T | 1 | BD | ● | | | | |
| 65 | 147.094 | 1295 305 052 | Reverse Gear 24 T | 1 | C | ● | | | | |
| 66 | 169.234 | 0730 150 064 | Thrust Washer | 1 | | ● | | | | |
| 68 | 198.339 | 1268 298 938 | Spring Slide kit | 1 | | ● | | | | |
| 69 | 198.564 | | Spring Slide kit | 1 | | ● | | | | |
| 70 | 198.842 | 1295 298 933 | Spring Slide kit | 1 | | ● | | | | |
| 71 | 198.428 | 1295 298 960 | Oil Seal Ring Kit | 1 | | ● | | | | |
| 72 | 198.427 | 1295 298 915 | Gasket Kit | 1 | | ● | | | | |
| 73 | 139.686 | 1313 302 014 | Gasket | 1 | | ● | | | | |
| 74 | 298.405 | 1295 298 916 | O-Ring Kit | 1 | | ● | | | | |
| 75 | 298.406 | 1295 298 946 | Needle cages kit | 1 | | ● | | | | |
| 76 | 298.407 | 1295 298 941 | Bearing kit | 1 | | ● | | | | |
| 77 | 198.724 | 1295 298 936 | Synchro Kit | 1 | W/"Old Type" synchro rings | ● | | | | |
| 77 | 298.323 | 1297 298 962 | Synchro Kit | 1 | W/"New Type" synchro rings | ● | | | | |
| 78 | 198.807 | 1297 298 958 | Synchron.Kit 3rd-4th Speed | 1 | W/"New Type" synchro rings | ● | | | | |
| 79 | 198.809 | 1297 298 956 | Synchron.kit 1st-2nd Speed | 1 | | ● | | | | |

ECOSPLIT I-II
16S130

Date

Notes

09/2014

MODELS:

- ECOSPLIT I-II

VERSIONS:

- 16S130 (1295 xxx xxx)

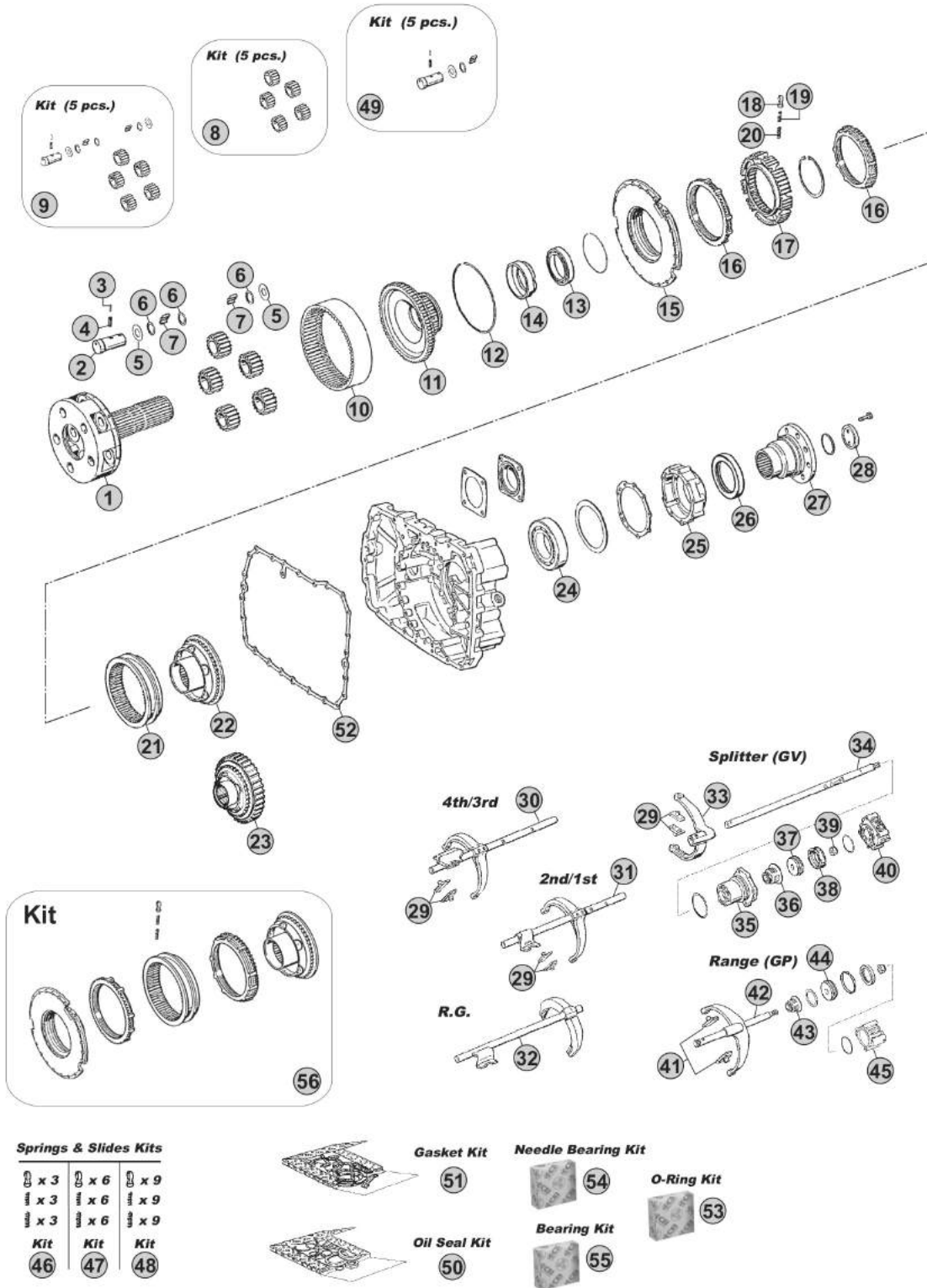

Springs & Slides Kits

| | | |
|------------|------------|------------|
| x 3 | x 6 | x 9 |
| x 3 | x 6 | x 9 |
| x 3 | x 6 | x 9 |
| Kit | Kit | Kit |
| 46 | 47 | 48 |



Notes

- (A) R. 10,14-0,72
- (B) R. 11,46-0,85
- (C) R. 13,68-1,00
- (D) R. 14,29-0,82

Our spare parts are not the originals but interchangeable with the originals ones. All original equipment manufacturers' numbers, pictures and models used in this catalogue are for reference only. Our products bear our trade-mark.

| Fig. | CEI no. | ZF no. | Description | Q.ty | Notes | 165130 | | | | |
|------|---------|--------------|-----------------------------|------|-------------------|--------|--|--|--|--|
| 1 | 190.169 | 1295 232 044 | Planetary Carrier | 1 | ABC | ● | | | | |
| 1 | 190.395 | 1297 232 045 | Planetary Carrier | 1 | D | ● | | | | |
| 2 | 107.089 | 1269 332 036 | Planetary Pin | 5 | ABC | ● | | | | |
| 2 | 107.163 | 1297 332 109 | Planet pin | 5 | D | ● | | | | |
| 3 | 160.191 | 0631 329 017 | Lock Pin 3x24 | 5 | | ● | | | | |
| 4 | 160.192 | 0631 329 050 | Lock Pin 5x24 | 5 | | ● | | | | |
| 5 | 169.408 | 0501 305 887 | Thrust Washer 29x57,5x1,5 | 10 | ABC | ● | | | | |
| 5 | 169.753 | 0501 306 212 | Thrust Washer 29x64x1,5 | 10 | D | ● | | | | |
| 6 | 169.410 | 0730 103 846 | Spacer Ring 29x39x1,00 | 15 | | ● | | | | |
| 7 | 171.016 | 0735 470 057 | Needle D.6x14,75 (180 pcs) | 180 | ABC | ● | | | | |
| 7 | 171.045 | 0750 119 143 | Needle 10x16,80 (120 pcs) | 120 | D | ● | | | | |
| 8 | 198.357 | 1295 232 027 | Planetary Gear Set (5 pcs) | 1 | ABC | ● | | | | |
| 8 | 198.810 | 1297 232 024 | Planetary Gear Set (5 pcs) | 1 | D | ● | | | | |
| 9 | 198.562 | 1296 298 904 | Planetary Gear Set | 1 | ABC | ● | | | | |
| 10 | 123.162 | 1295 332 053 | Crown Gear 83 T | 1 | ABC | ● | | | | |
| 10 | 123.208 | 1295 332 086 | Crown Gear 86 T | 1 | D | ● | | | | |
| 11 | 150.112 | 1295 332 021 | Carrier Hub 83 T | 1 | ABC | ● | | | | |
| 11 | 150.137 | 1297 332 035 | Carrier Hub 86 T | 1 | D | ● | | | | |
| 12 | 111.129 | 0730 505 055 | Locking Wire | 1 | ABC | ● | | | | |
| 12 | 111.198 | 0730 505 056 | Locking Wire | 1 | D | ● | | | | |
| 13 | 130.244 | 0750 116 166 | Bearing 75x105x16 | 1 | ABC | ● | | | | |
| 13 | 130.310 | 0750 116 165 | Bearing 80x110x16 | 1 | D | ● | | | | |
| 14 | 119.255 | 1297 332 122 | Intermediate Ring | 1 | D | ● | | | | |
| 15 | 198.358 | 1296 233 006 | Synchro Cone | 1 | | ● | | | | |
| 16 | 119.085 | 1296 333 022 | Synchronizer Ring | 2 | Old Type | ● | | | | |
| 16 | 119.172 | 1296 333 045 | Synchronizer Ring | 2 | New Type | ● | | | | |
| 17 | 157.113 | 1296 333 002 | Synchronizer Hub | 1 | | ● | | | | |
| 18 | 160.116 | 1240 304 278 | Pressure Piece | 9 | | ● | | | | |
| 19 | 156.036 | 0732 040 386 | Inner Spring De.3x34 | 9 | | ● | | | | |
| 20 | 156.037 | 0732 040 385 | Outer Spring De.6x34 | 9 | | ● | | | | |
| 21 | 154.098 | 1296 333 023 | Sliding Sleeve | 1 | | ● | | | | |
| 22 | 198.359 | 1295 233 025 | Synchronizer Cone (36 Spl.) | 1 | ABC | ● | | | | |
| 22 | 198.374 | 1313 233 001 | Synchronizer Cone (38 Spl.) | 1 | D | ● | | | | |
| 23 | 109.845 | 1297 333 117 | Synchronizer Cone | 1 | With Retarder ABC | ● | | | | |
| 23 | 109.772 | 1297 333 118 | Synchronizer Cone (38 Spl.) | 1 | With Retarder D | ● | | | | |
| 24 | 130.245 | 0750 116 394 | Bearing 90x160x30 | 1 | | ● | | | | |
| 25 | 128.260 | 1296 301 067 | Cover | 1 | | ● | | | | |
| 25 | 128.098 | 1315 301 220 | Cover | 1 | | ● | | | | |
| 26 | 139.878 | 0750 111 341 | Oil Seal 105x130x12 | 1 | | ● | | | | |
| 27 | 197.235 | 1295 238 003 | Output Flange D.165 mm | 1 | D.165-8 H. ABC | ● | | | | |
| 27 | 197.161 | 1295 338 061 | Output Flange D.180 mm | 1 | D.180-4 H.- ABC | ● | | | | |
| 27 | 197.051 | 1295 338 014 | Output Flange D.180 mm | 1 | D.180-10 H. ABC | ● | | | | |
| 27 | 197.168 | 1295 338 059 | Output Flange D.180 mm | 1 | D.180-10 H. ABC | ● | | | | |

Date

09/2014

Notes

 ECOSPLIT I-II
16S130

MODELS:

- ECOSPLIT I-II

VERSIONS:

- 16S130 (1295 xxx xxx)

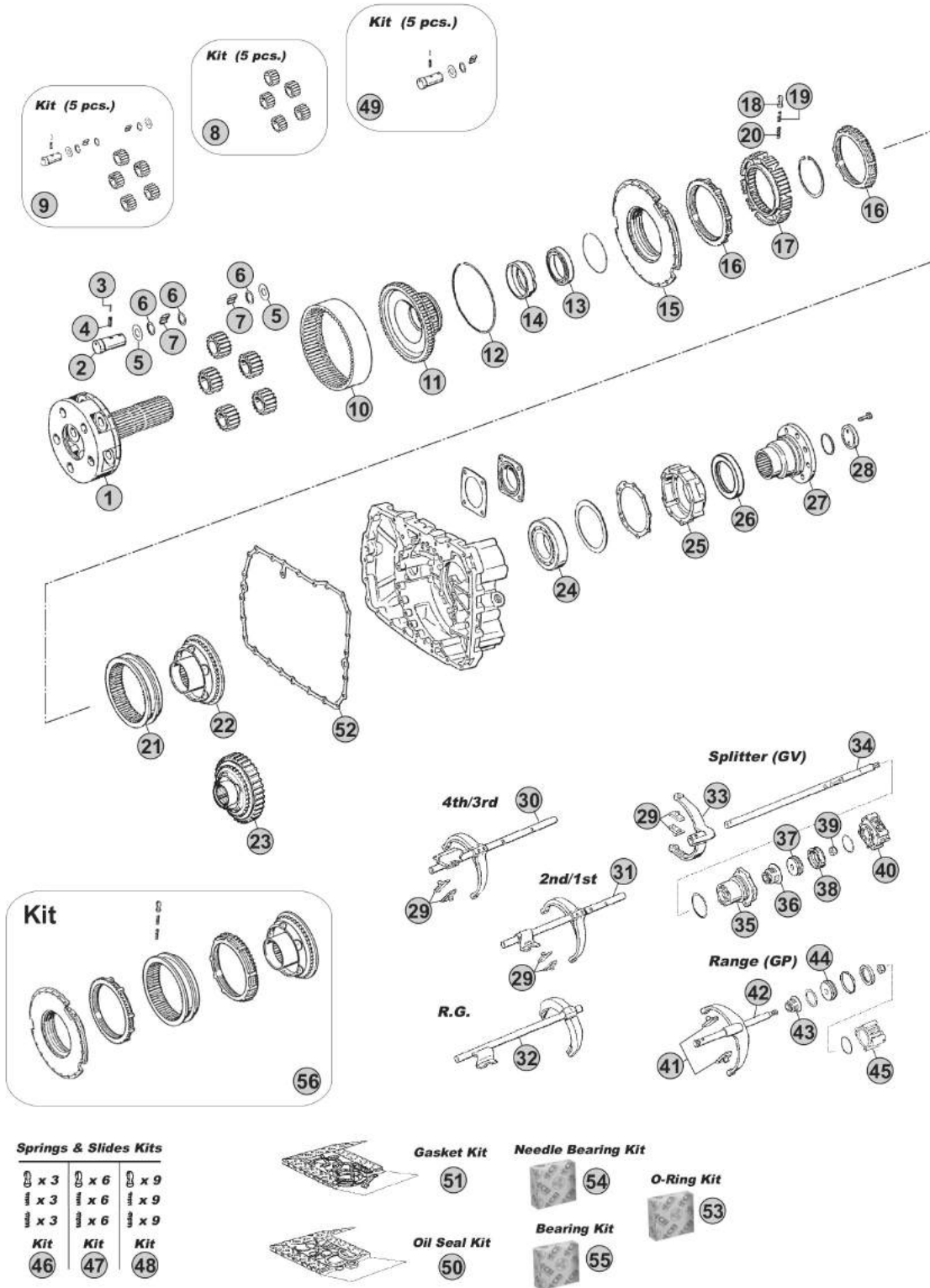

Notes

- (A) R. 10,14-0,72
- (B) R. 11,46-0,85
- (C) R. 13,68-1,00
- (D) R. 14,29-0,82

Our spare parts are not the originals but interchangeable with the originals ones. All original equipment manufacturers' numbers, pictures and models used in this catalogue are for reference only. Our products bear our trade-mark.

| Fig. | CEI no. | ZF no. | Description | Q.ty | Notes | 165130 | | | | |
|------|---------|--------------|-----------------------------|------|------------------------|--------|--|--|--|--|
| 27 | 197.074 | 1295 338 016 | Output Flange D.204 mm | 1 | D.204-4 H. ABC | ● | | | | |
| 27 | 197.234 | 1295 338 028 | Output Flange D.204 mm | 1 | D.204-4 H. ABC | ● | | | | |
| 27 | 197.167 | 1297 338 041 | Output Flange D.180 mm | 1 | D.180-4 H. D | ● | | | | |
| 27 | 197.162 | 1297 338 010 | Output Flange D.180 mm | 1 | D.180-10 H. D | ● | | | | |
| 28 | 188.077 | 1295 332 051 | Stop Washer | 1 | | ● | | | | |
| 28 | 188.250 | 1295 332 064 | Stop Washer | 1 | Only with 1295 238 003 | ● | | | | |
| 29 | 141.068 | 1295 306 132 | Bronze Slide | 2 | 3x2 pcs. | ● | | | | |
| 30 | 298.811 | 1295 206 219 | Complete Fork | 1 | | ● | | | | |
| 30 | 298.812 | 1295 206 212 | Complete Fork | 1 | | ● | | | | |
| 30 | 198.362 | 1295 206 213 | Complete Fork | 1 | | ● | | | | |
| 31 | 298.815 | 1295 206 223 | Complete Fork | 1 | | ● | | | | |
| 31 | 298.816 | 1295 206 217 | Complete Fork | 1 | | ● | | | | |
| 31 | 298.817 | 1295 206 214 | Complete Fork | 1 | | ● | | | | |
| 31 | 298.818 | 1295 206 215 | Complete Fork | 1 | | ● | | | | |
| 32 | 298.821 | 1295 206 250 | Complete Fork | 1 | | ● | | | | |
| 32 | 298.822 | 1295 206 249 | Complete Fork | 1 | | ● | | | | |
| 32 | 198.360 | 1295 206 255 | Complete Fork | 1 | | ● | | | | |
| 32 | 298.823 | 1295 206 254 | Complete Fork | 1 | | ● | | | | |
| 33 | 141.086 | 1313 312 002 | Shift Yoke | 1 | | ● | | | | |
| 34 | 149.172 | 1295 312 018 | Selector Rod | 1 | | ● | | | | |
| 35 | 132.046 | 1296 312 042 | Cylinder | 1 | | ● | | | | |
| 36 | 139.331 | 0750 112 034 | Cap Collar 25x38x14,2 | 1 | | ● | | | | |
| 37 | 189.421 | 1296 312 053 | Piston | 1 | | ● | | | | |
| 38 | 139.912 | 0750 112 089 | Ring 53x63x16,2 | 1 | | ● | | | | |
| 39 | 287.091 | 0737 300 037 | Nut | 1 | | ● | | | | |
| 40 | 132.084 | 0750 132 032 | Cylinder | 1 | | ● | | | | |
| 40 | 280.350 | 0750 132 033 | Cylinder | 1 | | ● | | | | |
| 41 | 141.085 | 1296 334 004 | Bronze Slide | 2 | | ● | | | | |
| 42 | 149.171 | 1312 234 002 | Fork | 1 | | ● | | | | |
| 42 | | 1295 334 025 | Fork | 1 | | ● | | | | |
| 43 | 139.331 | 0750 112 034 | Cap Collar 25x38x14,2 | 1 | | ● | | | | |
| 44 | 189.422 | 1296 334 039 | Piston | 1 | | ● | | | | |
| 45 | 132.047 | 1295 334 075 | Cylinder | 1 | | ● | | | | |
| 46 | 198.339 | 1268 298 938 | Spring Slide kit | 1 | | ● | | | | |
| 47 | 198.564 | | Spring Slide kit | 1 | | ● | | | | |
| 48 | 198.842 | 1295 298 933 | Spring Slide kit | 1 | | ● | | | | |
| 49 | 198.447 | | Overhaul Planetary Gear Kit | 1 | ABC | ● | | | | |
| 50 | 198.428 | 1295 298 960 | Oil Seal Ring Kit | 1 | | ● | | | | |
| 51 | 198.427 | 1295 298 915 | Gasket Kit | 1 | | ● | | | | |
| 52 | 139.685 | 1313 301 037 | Gasket | 1 | | ● | | | | |
| 53 | 298.405 | 1295 298 916 | O-Ring Kit | 1 | | ● | | | | |
| 54 | 298.406 | 1295 298 946 | Needle cages kit | 1 | | ● | | | | |
| 55 | 298.407 | 1295 298 941 | Bearing kit | 1 | | ● | | | | |

 ECOSPLIT I-II
16S130

Date

09/2014

Notes

MODELS:

- ECOSPLIT I-II

VERSIONS:

- 16S130 (1295 xxx xxx)

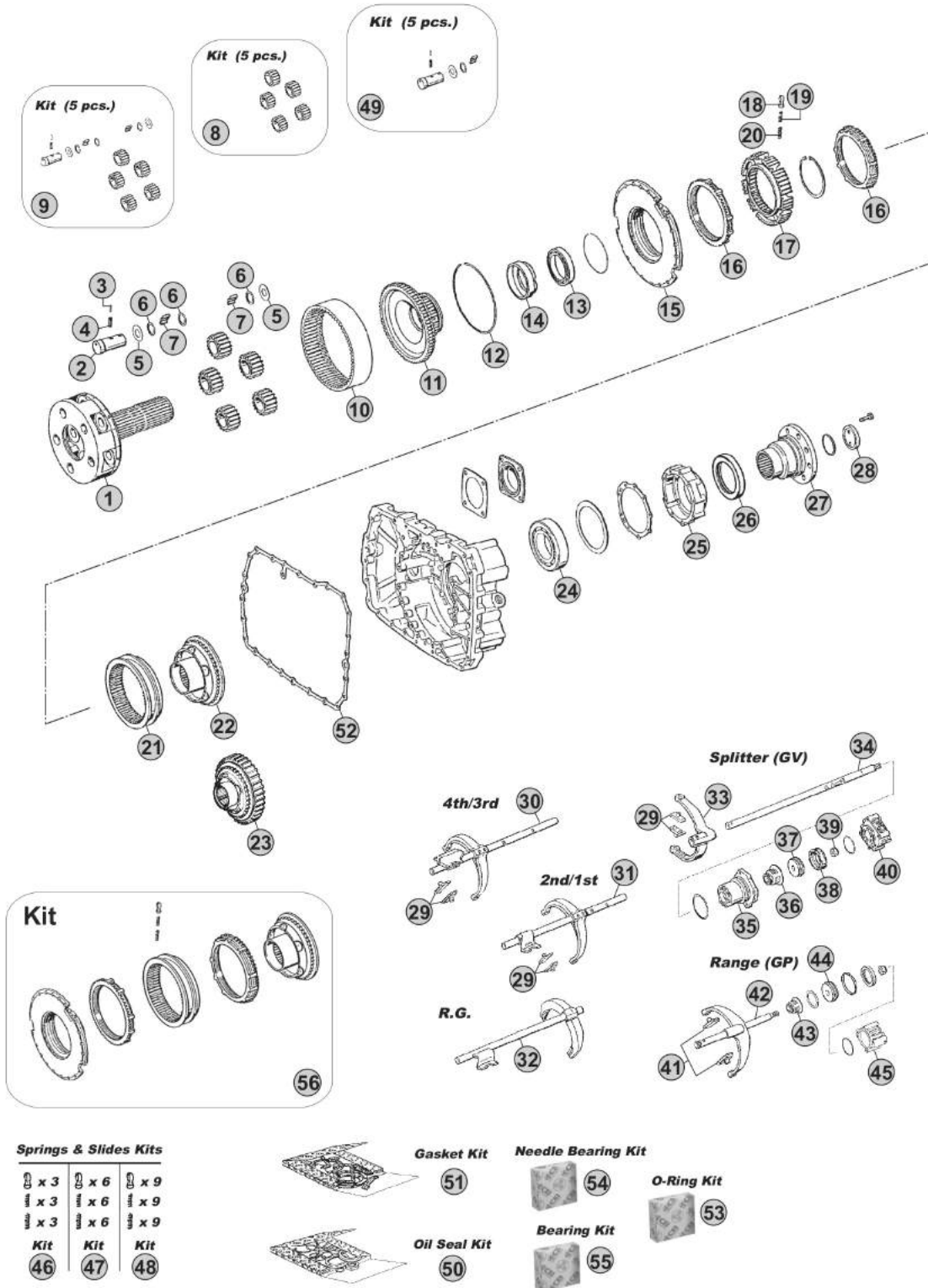

Springs & Slides Kits

| | | |
|------------|------------|------------|
| x 3 | x 6 | x 9 |
| x 3 | x 6 | x 9 |
| x 3 | x 6 | x 9 |
| Kit | Kit | Kit |
| 46 | 47 | 48 |



Notes

- (A) R. 10,14-0,72
- (B) R. 11,46-0,85
- (C) R. 13,68-1,00
- (D) R. 14,29-0,82

