

MODELS:

- ECOSPLIT I-II

VERSIONS:

- 16S130/1 (1295 xxx xxx)

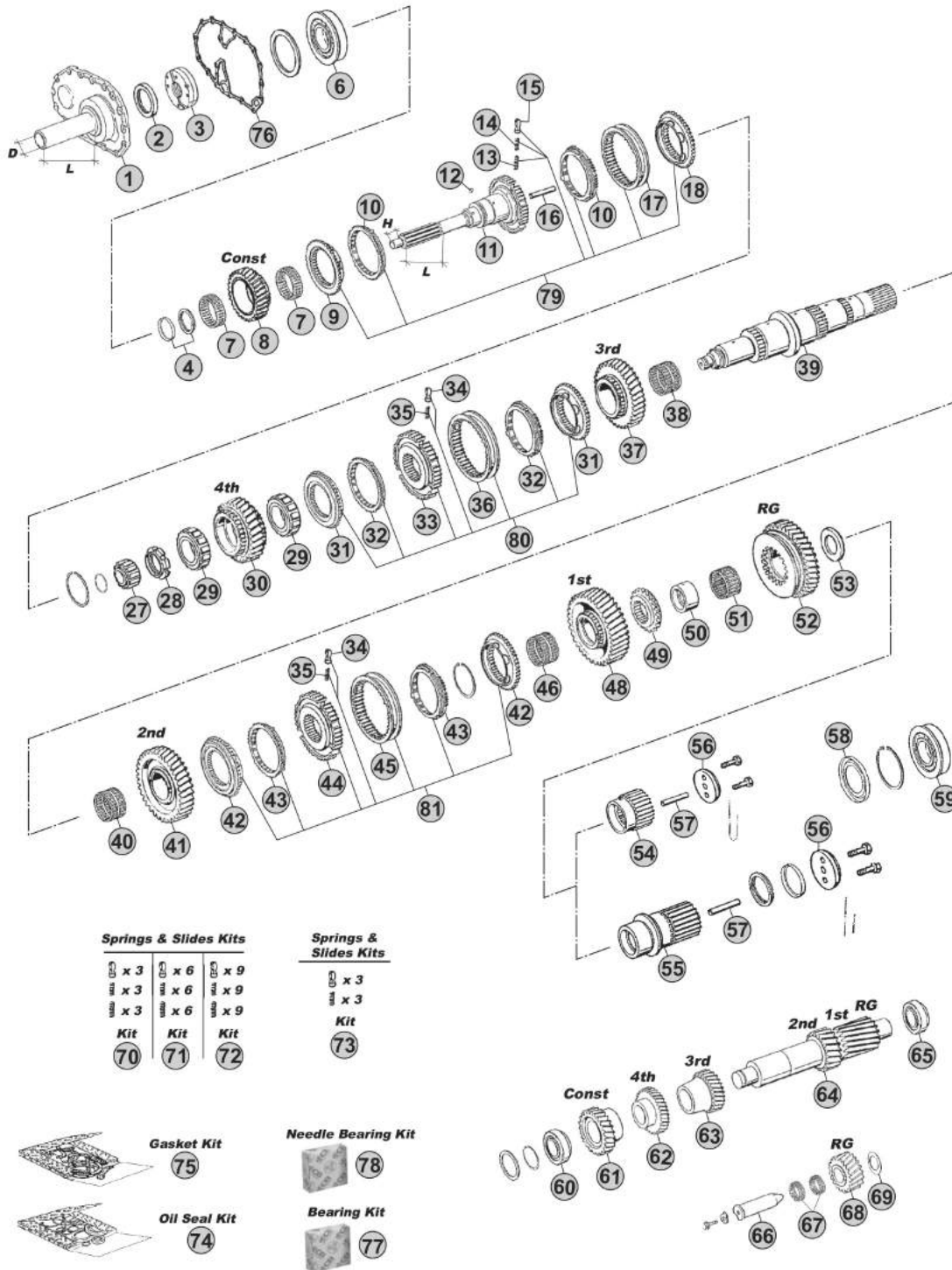

Our spare parts are not the originals but interchangeable with the originals ones. All original equipment manufacturers' numbers, pictures and models used in this catalogue are for reference only. Our products bear our trade-mark.

Notes

- (A) R. 10,14-0,72
- (B) R. 11,46-0,85
- (C) R. 13,68-1,00
- (D) R. 14,29-0,82

Our spare parts are not the originals but interchangeable with the originals ones. All original equipment manufacturers' numbers, pictures and models used in this catalogue are for reference only. Our products bear our trade-mark.

Fig.	CEI no.	ZF no.	Description	Q.ty	Notes	16S130/1				
1	128.339	1297 302 011	Front Cover	1	L=147-D=57	●				
2	139.937	0750 111 002	Oil Seal 48x75x8	1		●				
2	139.879	0734 310 387	Oil Seal 55x75x8	1	(13)	●				
2	239.003	0634 100 182	Oil Seal	1	(14)	●				
3	280.348	1295 202 041	Oil Pump	1		●				
4	298.400	1499 298 003	Washers Kit Th. 4,00mm	1		●				
4	298.401	1499 298 002	Washers Kit Th. 3,90mm	1		●				
4	298.402	1499 298 001	Washers Kit Th. 3,80mm	1		●				
6	130.305	0750 118 131	Bearing 80x150x27,50	1		●				
7	137.082	0735 320 786	Needle Cage 88x96x24,50	2		●				
8	145.276	1295 302 071	Constant Gear 28 T	1	AC	●				
8	145.489	1295 302 070	Constant Gear 30 T	1	B	●				
8	145.541	1295 302 122	Constant Gear 29 T	1	D	●				
9	109.072	1295 304 278	Synchronizer Cone	1		●				
10	119.084	1295 304 004	Synchronizer Ring	2	Old Type	●				
10	119.175	1304 304 686	Synchronizer Ring	2	New Type	●				
11	102.250	1295 202 005	Input Shaft	1	L=95 D=32	●				
11	102.584	1295 202 052	Input shaft	1		●				
11	102.582	1295 221 003	Input shaft	1	With NMV130 (Clutch PTO)	●				
12	171.084	0635 470 012	Needle D.7x7	1		●				
13	156.037	0732 040 385	Outer Spring De.6x34	3		●				
14	156.036	0732 040 386	Inner Spring De.3x34	3		●				
15	160.116	1240 304 278	Pressure Piece	3		●				
16	188.211	0730 062 323	Oil Plug	1		●				
17	154.097	1295 304 002	Sliding Sleeve	1		●				
18	109.072	1295 304 278	Synchronizer Cone	1		●				
27	137.081	0750 118 010	Roller Cage D.30x60x25,50	1		●				
28	187.412	0737 502 092	Grooved Nut M60x1,5	1		●				
29	137.083	0750 118 005	Roller Cage 63x97,5x34,80	2		●				
30	146.212	1295 304 135	Gear 4th Speed 30 T	1	AC	●				
30	146.356	1295 304 136	Gear 4th Speed 28 T	1	B	●				
30	146.454	1295 304 236	Gear 4th Speed 26 T	1	D	●				
31	109.114	1297 304 369	Synchronizer Cone	2		●				
32	119.119	1297 304 402	Synchronizer Ring	2	Old Type	●				
32	119.167	1297 304 484	Synchronizer Ring	2	New Type	●				
33	157.140	1297 304 446	Synchronizer Hub	1		●				
34	160.189	1297 304 436	Pressure Piece	3	2x3 pcs.	●				
35	156.140	0732 040 409	Spring De.6,5x23,50	3	2x3 pcs.	●				
36	154.135	1310 304 202	Sliding Sleeve	1		●				
37	244.163	1295 304 269	Gear 3rd Speed 25 T	1	A	●				
37	145.495	1295 304 127	Gear 3rd Speed 32 T	1	BD	●				
37	145.277	1295 304 128	Gear 3rd Speed 34 T	1	C	●				
38	137.084	0735 320 418	Needle Cage 82x90x49	1		●				

Date

09/2014

Notes

(13) For Input shaft 1295 202 052

(14) For Input shaft 1295 221 003

MODELS:

- ECOSPLIT I-II

VERSIONS:

- 16S130/1 (1295 xxx xxx)

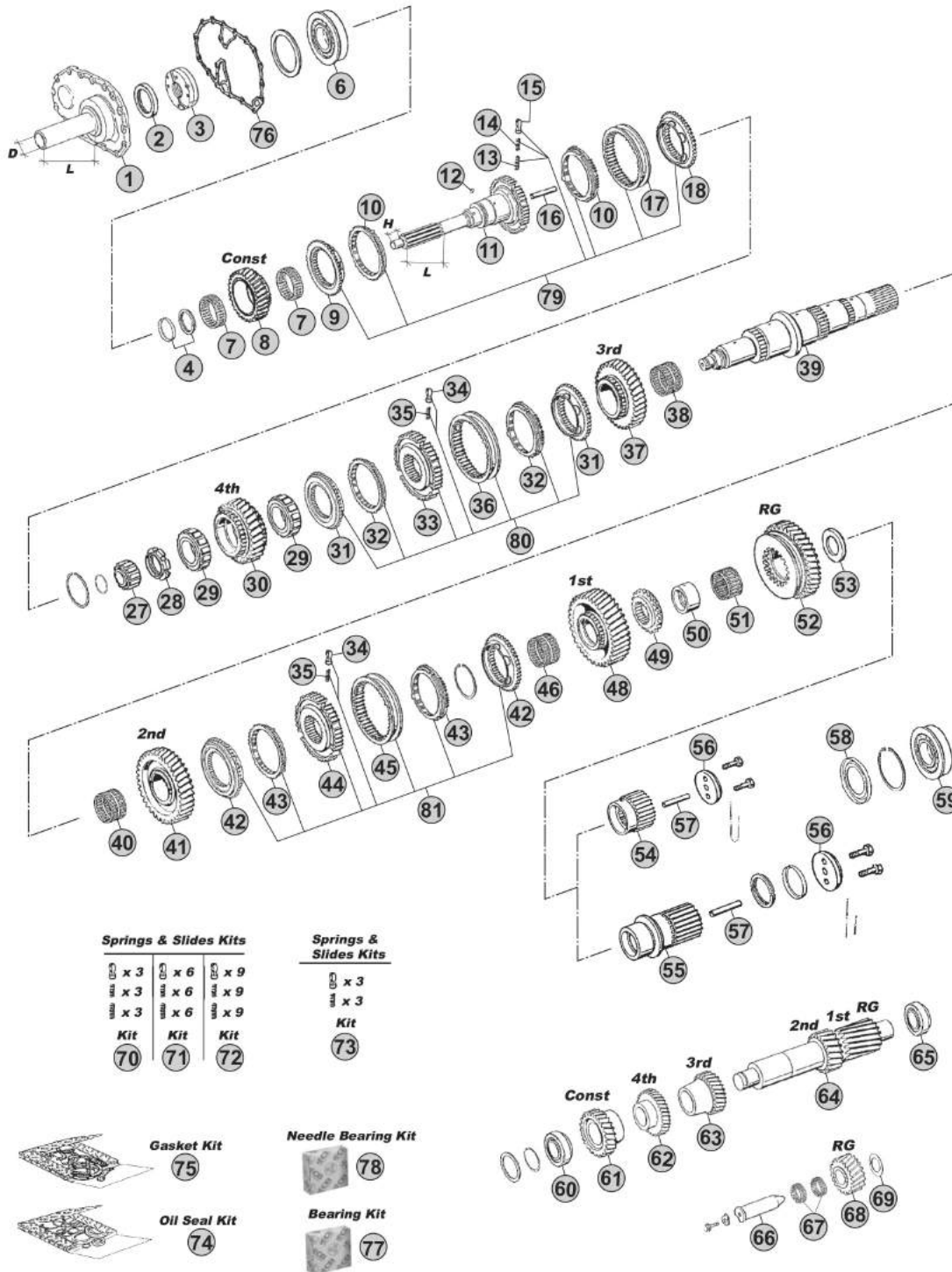

Our spare parts are not the originals but interchangeable with the originals ones. All original equipment manufacturers' numbers, pictures and models used in this catalogue are for reference only. Our products bear our trade-mark.

Notes

- (A) R. 10,14-0,72
- (B) R. 11,46-0,85
- (C) R. 13,68-1,00
- (D) R. 14,29-0,82

Our spare parts are not the originals but interchangeable with the originals ones. All original equipment manufacturers' numbers, pictures and models used in this catalogue are for reference only. Our products bear our trade-mark.

Fig.	CEI no.	ZF no.	Description	Q.ty	Notes	16S130/1				
39	103.274	1295 304 273	Main Shaft	1	A	●				
39	103.075	1295 304 245	Main Shaft	1	BC	●				
39	103.140	1295 304 250	Main Shaft	1	D	●				
40	137.112	0735 320 451	Needle Cage 82x90x60	1	A	●				
40	137.084	0735 320 418	Needle Cage 82x90x49	1	BCD	●				
41	244.164	1295 304 271	Gear 2nd Speed 34 T	1	A	●				
41	145.501	1295 304 120	Gear 2nd Speed 37 T	1	BD	●				
41	145.278	1295 304 121	Gear 2nd Speed 38 T	1	C	●				
42	109.113	1297 304 371	Synchronizer cone	2		●				
43	119.122	1297 304 401	Synchronizer Ring	2	Old Type	●				
43	119.166	1297 304 485	Synchronizer Ring	2	New Type	●				
44	157.139	1297 304 445	Synchronizer Hub	1		●				
45	154.136	1297 304 450	Sliding Sleeve	1		●				
46	137.159	0735 320 548	Needle Cage 70x78x46	1	A	●				
46	137.085	0735 320 496	Needle Cage 70x78x55	1	BCD	●				
48	244.165	1295 304 270	Gear 1st Speed 41 T	1	A	●				
48	145.506	1295 304 203	Gear 1st Speed 44 T	1	BD	●				
48	145.279	1295 304 202	Gear 1st Speed 47 T	1	C	●				
49	109.184	1295 304 024	Synchronizer Cone	1	A	●				
49	109.075	1295 304 206	Synchronizer Cone	1	BCD	●				
50	117.203	1295 304 012	Bush D.60x75x38	1	ABC	●				
51	137.086	0750 115 059	Needle Cage 75x83x40	1		●				
52	147.292	1295 304 272	Reverse Gear 39 T	1	A	●				
52	147.138	1295 304 201	Reverse Gear 39 T	1	BD	●				
52	147.093	1295 304 200	Reverse Gear 38 T	1	C	●				
53	169.409	1295 304 240	Thrust Washer	1	ABC	●				
54	157.112	1295 304 248	Sun Gear 27 T	1	ABC	●				
55	157.207	1295 304 251	Sun Gear 24 T	1	D	●				
56	188.076	1272 304 021	Stop Washer	1		●				
57	189.671	0730 061 842	Oil Tube	1		●				
58	139.922	1295 304 129	Oil Collector	1	ABC	●				
58	139.923	1297 301 004	Oil Collector	1	D	●				
59	130.240	0750 118 153	Bearing 60x130x31	1	ABC	●				
59	130.934	0750 118 137	Bearing 80x140x26	1	D	●				
60	130.242	0750 117 010	Bearing 50,80x100x35	1		●				
61	146.210	1295 303 101	Constant Gear 34 T	1	AC	●				
61	146.354	1295 303 036	Constant Gear 31 T	1	B	●				
61	146.457	1295 303 060	Constant Gear 32 T	1	D	●				
62	146.209	1295 303 027	Gear 4th Speed 31 T	1	AC	●				
62	146.413	1295 303 028	Gear 4th Speed 34 T	1	B	●				
62	146.461	1295 303 094	Gear 4th Speed 35 T	1	D	●				
63	146.751	1295 303 071	Gear 3rd Speed 36 T	1	A	●				
63	146.355	1295 303 025	Gear 3rd Speed 28 T	1	BD	●				

 ECOSPLIT-II
16S130/1

Date

09/2014

Notes

MODELS:

- ECOSPLIT I-II

VERSIONS:

- 16S130/1 (1295 xxx xxx)

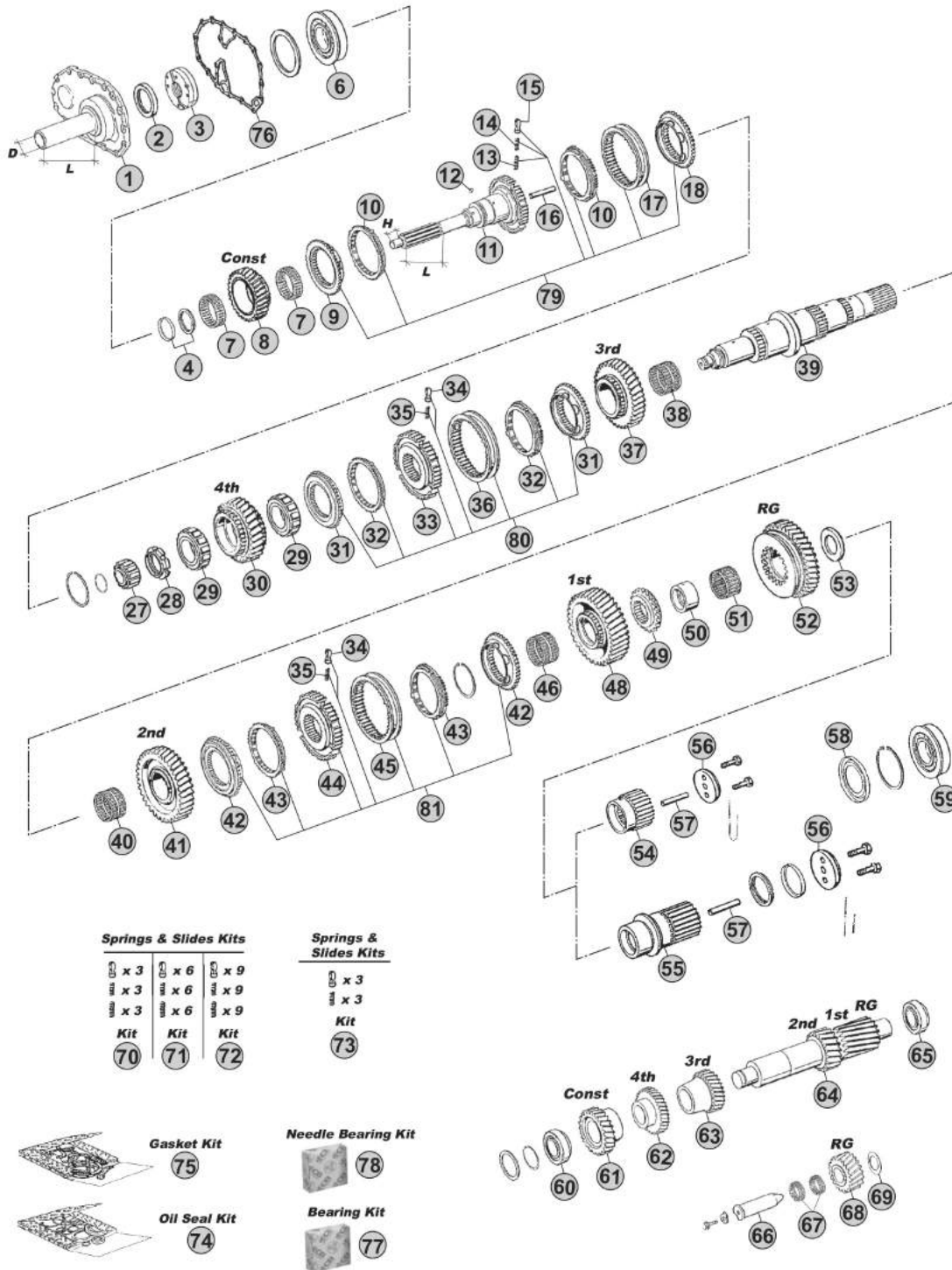

Our spare parts are not the originals but interchangeable with the originals ones. All original equipment manufacturers' numbers, pictures and models used in this catalogue are for reference only. Our products bear our trade-mark.

Notes

- (A) R. 10,14-0,72
- (B) R. 11,46-0,85
- (C) R. 13,68-1,00
- (D) R. 14,29-0,82

Our spare parts are not the originals but interchangeable with the originals ones. All original equipment manufacturers' numbers, pictures and models used in this catalogue are for reference only. Our products bear our trade-mark.

Fig.	CEI no.	ZF no.	Description	Q.ty	Notes					
63	146.211	1295 303 026	Gear 3rd Speed 25 T	1	C	●				
64	105.278	1295 303 072	Countershaft 19/23 T	1	A	●				
64	105.119	1295 303 067	Countershaft 19/23 T	1	BD	●				
64	105.060	1295 303 066	Countershaft 17/20 T	1	C	●				
65	130.243	0750 117 008	Bearing 50x110x42	1		●				
66	107.108	1295 305 056	Reverse Gear Pin	1		●				
67	137.007	0750 115 011	Needle Cage 45x53x21	2		●				
68	147.153	1297 305 003	Reverse Gear 21 T	1	A	●				
68	147.133	1295 305 051	Reverse Gear 21 T	1	BD	●				
68	147.094	1295 305 052	Reverse Gear 24 T	1	C	●				
69	169.234	0730 150 064	Thrust Washer	1		●				
70	198.339	1268 298 938	Spring Slide kit	1		●				
71	198.564		Spring Slide kit	1		●				
72	198.842	1295 298 933	Spring Slide kit	1		●				
73	198.843		Spring Slide kit	1		●				
74	198.428	1295 298 960	Oil Seal Ring Kit	1		●				
75	198.427	1295 298 915	Gasket Kit	1		●				
76	139.686	1313 302 014	Gasket	1		●				
77	298.407	1295 298 941	Bearing kit	1		●				
78	298.406	1295 298 946	Needle cages kit	1		●				
79	198.724	1295 298 936	Synchro Kit	1	W/"Old Type" synchro rings	●				
79	298.323	1297 298 962	Synchro Kit	1	W/"New Type" synchro rings	●				
80	298.802	1297 298 959	Synchro Kit	1	W/"New Type" synchro rings	●				
81	298.321	1297 298 957	Synchro Kit	1	W/"Old Type" synchro rings	●				

ECOSPLIT II
16S130/1

Date Notes

09/2014



MODELS:

- ECOSPLIT I-II

VERSIONS:

- 16S130/1 (1295 xxx xxx)

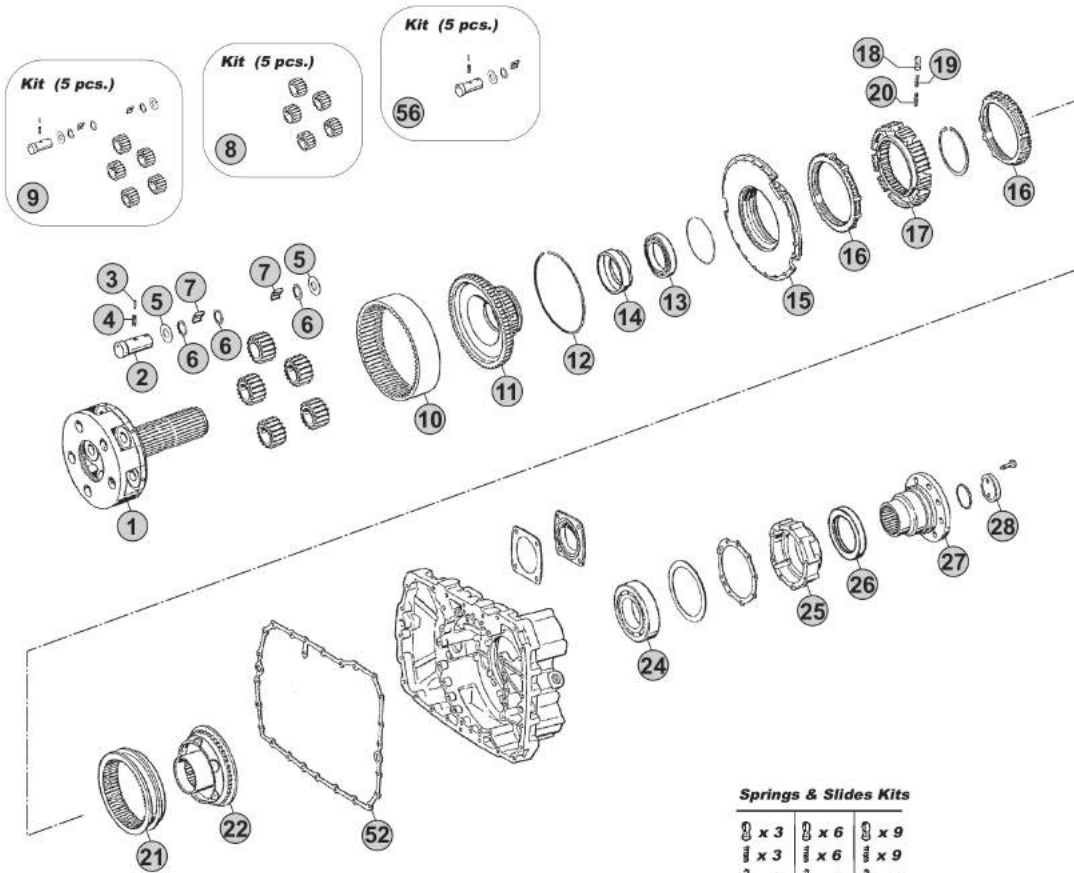

Springs & Slides Kits

x 3	x 6	x 9
x 3	x 6	x 9
x 3	x 6	x 9
Kit	Kit	Kit
47	48	49

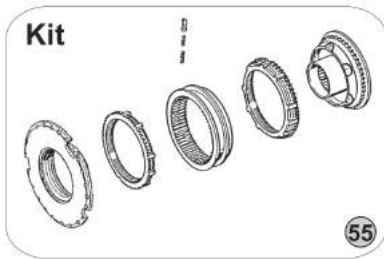

Shifting Forks

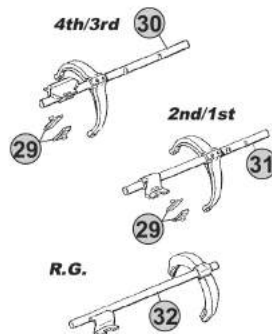

Splitter (GV) 35

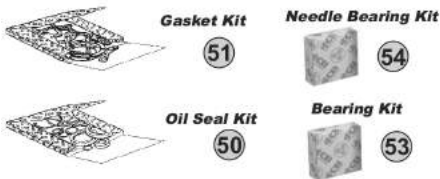
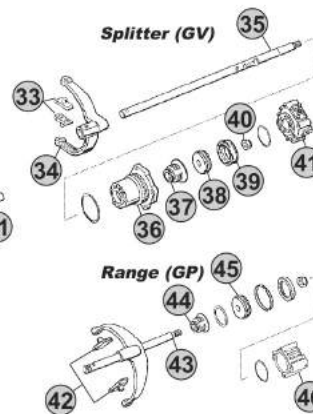

Notes

- (A) R. 10,14-0,72
- (B) R. 11,46-0,85
- (C) R. 13,68-1,00
- (D) R. 14,29-0,82

Our spare parts are not the originals but interchangeable with the originals ones. All original equipment manufacturers' numbers, pictures and models used in this catalogue are for reference only. Our products bear our trade-mark.

Our spare parts are not the originals but interchangeable with the originals ones. All original equipment manufacturers' numbers, pictures and models used in this catalogue are for reference only. Our products bear our trade-mark.

Fig.	CEI no.	ZF no.	Description	Q.ty	Notes	16S130/1			
1	190.169	1295 232 044	Planetary Carrier	1	ABC	●			
1	190.395	1297 232 045	Planetary Carrier	1	D	●			
2	107.089	1269 332 036	Planetary Pin	5	ABC	●			
2	107.163	1297 332 109	Planet pin	5	D	●			
3	160.191	0631 329 017	Lock Pin 3x24	5		●			
4	160.192	0631 329 050	Lock Pin 5x24	5		●			
5	169.408	0501 305 887	Thrust Washer 29x57,5x1,5	10	ABC	●			
5	169.753	0501 306 212	Thrust Washer 29x64x1,5	10	D	●			
6	169.410	0730 103 846	Spacer Ring 29x39x1,00	15		●			
7	171.016	0735 470 057	Needle D.6x14,75 (180 pcs)	180	ABC	●			
7	171.045	0750 119 143	Needle 10x16,80 (120 pcs)	120	D	●			
8	198.357	1295 232 027	Planetary Gear Set (5 pcs)	1	ABC	●			
8	198.810	1297 232 024	Planetary Gear Set (5 pcs)	1	D	●			
9	198.562	1296 298 904	Planetary Gear Set	1	ABC	●			
10	123.162	1295 332 053	Crown Gear 83 T	1	ABC	●			
10	123.208	1295 332 086	Crown Gear 86 T	1	D	●			
11	150.112	1295 332 021	Carrier Hub 83 T	1	ABC	●			
11	150.137	1297 332 035	Carrier Hub 86 T	1	D	●			
12	111.129	0730 505 055	Locking Wire	1	ABC	●			
12	111.198	0730 505 056	Locking Wire	1	D	●			
13	130.244	0750 116 166	Bearing 75x105x16	1	ABC	●			
13	130.310	0750 116 165	Bearing 80x110x16	1	D	●			
14	119.255	1297 332 122	Intermediate Ring	1	D	●			
15	198.358	1296 233 006	Synchro Cone	1		●			
16	119.085	1296 333 022	Synchronizer Ring	2	Old Type	●			
16	119.172	1296 333 045	Synchronizer Ring	2	New Type	●			
17	157.113	1296 333 002	Synchronizer Hub	1		●			
18	160.116	1240 304 278	Pressure Piece	9		●			
19	156.036	0732 040 386	Inner Spring De.3x34	9		●			
20	156.037	0732 040 385	Outer Spring De.6x34	9		●			
21	154.098	1296 333 023	Sliding Sleeve	1		●			
22	198.359	1295 233 025	Synchronizer Cone (36 Spl.)	1	ABC	●			
22	198.374	1313 233 001	Synchronizer Cone (38 Spl.)	1	D	●			
24	130.245	0750 116 394	Bearing 90x160x30	1		●			
25	128.260	1296 301 067	Cover	1		●			
25	128.098	1315 301 220	Cover	1		●			
26	139.878	0750 111 341	Oil Seal 105x130x12	1		●			
27	197.161	1295 338 061	Output Flange D.180 mm	1	D.180-4 H. ABC	●			
27	197.167	1297 338 041	Output Flange D.180 mm	1	D.180-4 H. D	●			
28	188.077	1295 332 051	Stop Washer	1		●			
29	141.163	1297 306 120	Slide	2	2x2 pcs.	●			
30	298.812	1295 206 212	Complete Fork	1		●			
31	298.816	1295 206 217	Complete Fork	1		●			

ECOSPLIT H-II
16S130/1

Date

09/2014

Notes

MODELS:

- ECOSPLIT I-II

VERSIONS:

- 16S130/1 (1295 xxx xxx)

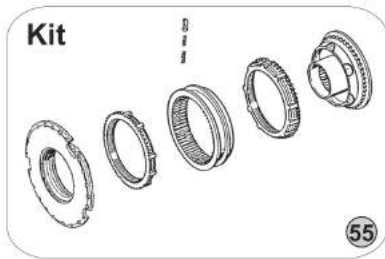
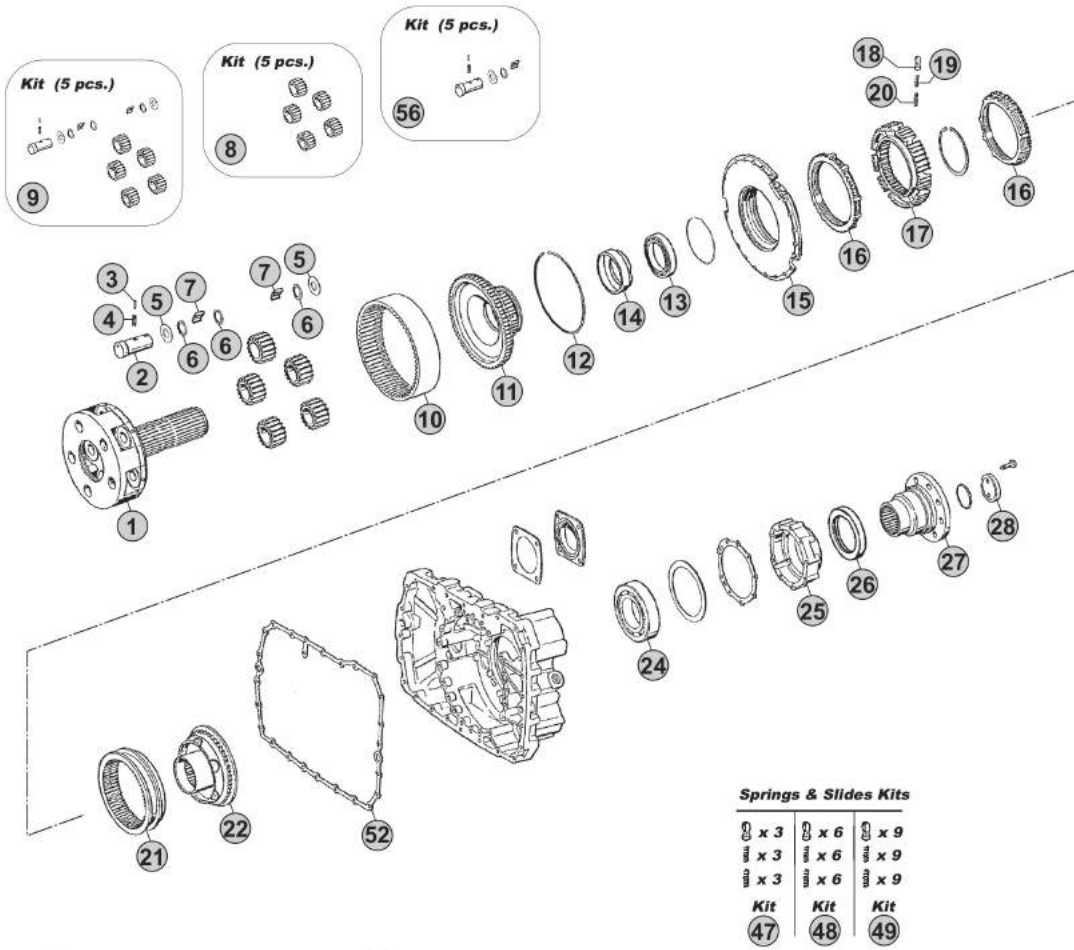

Shifting Forks

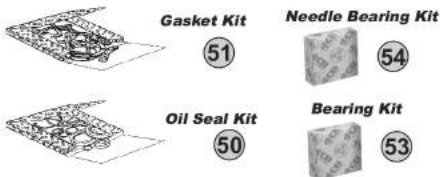
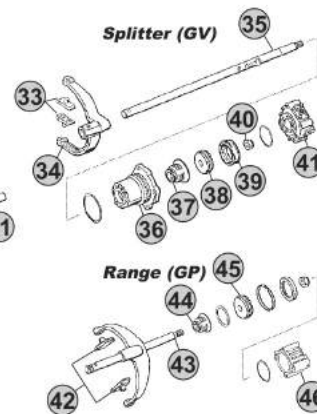
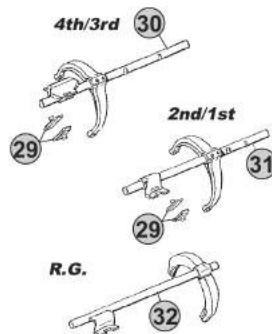

Notes

- (A) R. 10,14-0,72
- (B) R. 11,46-0,85
- (C) R. 13,68-1,00
- (D) R. 14,29-0,82

Our spare parts are not the originals but interchangeable with the originals ones. All original equipment manufacturers' numbers, pictures and models used in this catalogue are for reference only. Our products bear our trade-mark.

Fig.	CEI no.	ZF no.	Description	Q.ty	Notes	16S130/1			
31	298.818	1295 206 215	Complete Fork	1		●			
32	298.822	1295 206 249	Complete Fork	1		●			
32	298.823	1295 206 254	Complete Fork	1		●			
33	141.068	1295 306 132	Bronze Slide	2		●			
34	141.086	1313 312 002	Shift Yoke	1		●			
35	149.172	1295 312 018	Selector Rod	1		●			
36	132.046	1296 312 042	Cylinder	1		●			
37	139.331	0750 112 034	Cap Collar 25x38x14,2	1		●			
38	189.421	1296 312 053	Piston	1		●			
39	139.912	0750 112 089	Ring 53x63x16,2	1		●			
40	287.091	0737 300 037	Nut	1		●			
41	132.084	0750 132 032	Cylinder	1		●			
41	280.350	0750 132 033	Cylinder	1		●			
42	141.085	1296 334 004	Bronze Slide	2		●			
43	149.171	1312 234 002	Fork	1		●			
44	139.331	0750 112 034	Cap Collar 25x38x14,2	1		●			
45	189.422	1296 334 039	Piston	1		●			
46	132.047	1295 334 075	Cylinder	1		●			
47	198.339	1268 298 938	Spring Slide kit	1		●			
48	198.564		Spring Slide kit	1		●			
49	198.842	1295 298 933	Spring Slide kit	1		●			
50	198.428	1295 298 960	Oil Seal Ring Kit	1		●			
51	198.427	1295 298 915	Gasket Kit	1		●			
52	139.685	1313 301 037	Gasket	1		●			
53	298.407	1295 298 941	Bearing kit	1		●			
54	298.406	1295 298 946	Needle cages kit	1		●			
55	198.726	1295 298 937	Synchronizer kit	1	ABC W/"Old Type" synchro rings	●			
55	198.748	1295 298 939	Synchronizer kit	1	D W/"Old Type" synchro rings	●			
56	198.447		Overhaul Planetary Gear Kit	1	ABC	●			

ECOSPLIT II
16S130/1

Date 09/2014 Notes _____

