

MODELS:

- ECOSPLIT I-II

VERSIONS:

- 16K160 (1297 xxx xxx)

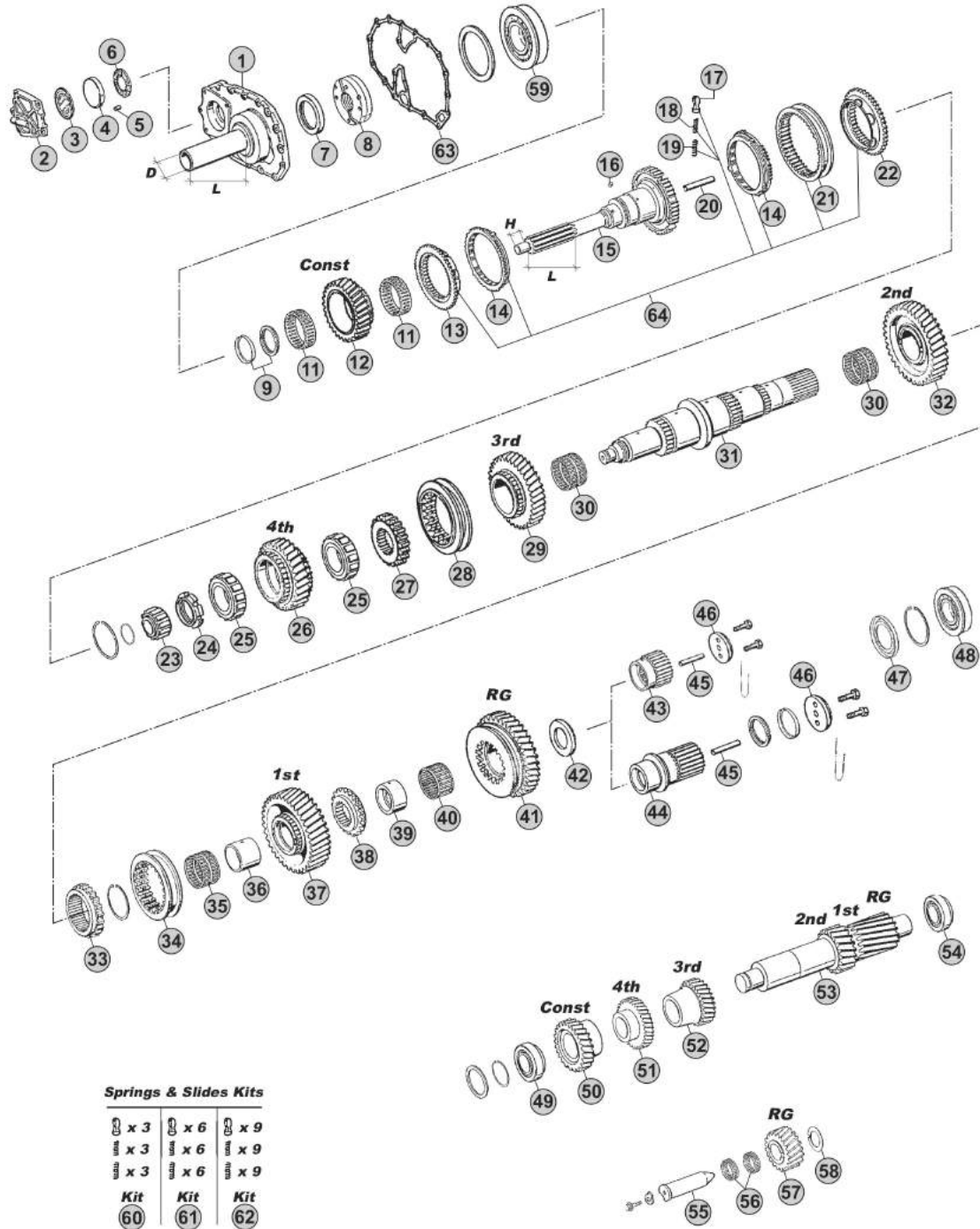

Springs & Slides Kits

x 3	x 6	x 9
x 3	x 6	x 9
x 3	x 6	x 9
Kit	Kit	Kit
60	61	62

Our spare parts are not the originals but interchangeable with the originals ones. All original equipment manufacturers' numbers, pictures and models used in this catalogue are for reference only. Our products bear our trade-mark.

Notes

- (A) R. 11,46-0,85
- (B) R. 13,68-1,00
- (C) R. 14,29-0,82

Our spare parts are not the originals but interchangeable with the originals ones. All original equipment manufacturers' numbers, pictures and models used in this catalogue are for reference only. Our products bear our trade-mark.

Fig.	CEI no.	ZF no.	Description	Q.ty	Notes	16K160				
1	128.366	1297 302 018	Front Cover	1	L=170 D=54	●				
1	128.367	1297 302 053	Front Cover	1	L=170 D=60	●				
1	128.223	1297 302 019	Front Cover	1		●				
2	128.369	1295 303 030	Oil Pump Cover	1		●				
3	269.072	0750 190 012	Washer	1		●				
4	188.275	1268 303 062	Piston	1		●				
5	160.318	0731 302 032	Pin	1		●				
6	269.670	1268 203 059	Washer	1		●				
7	139.937	0750 111 002	Oil Seal 48x75x8	1	(10)	●				
7	139.879	0734 310 387	Oil Seal 55x75x8	1	(11)	●				
7	239.003	0634 100 182	Oil Seal	1	(12)	●				
8	280.348	1295 202 041	Oil Pump	1		●				
9	298.400	1499 298 003	Washers Kit Th. 4,00mm	1		●				
9	298.401	1499 298 002	Washers Kit Th. 3,90mm	1		●				
9	298.402	1499 298 001	Washers Kit Th. 3,80mm	1		●				
11	137.153	0735 320 896	Needle Cage 88x96x29	2		●				
12	145.466	1297 302 177	Constant Gear 30 T	1	A	●				
12	145.406	1297 302 176	Constant Gear 28 T	1	B	●				
12	145.405	1297 302 250	Constant Gear 29 T	1	C	●				
13	109.072	1295 304 278	Synchronizer Cone	1		●				
14	119.084	1295 304 004	Synchronizer Ring	2	Old Type	●				
14	119.175	1304 304 686	Synchronizer Ring	2	New Type	●				
15	102.223	1297 202 053	Input Shaft	1	L=125 H=30	●				
15	102.247	1297 202 008	Input Shaft	1	L=118 H=25	●				
15	102.235	1297 202 011	Input Shaft	1	L=118 H=32	●				
15	102.585	1297 202 045	Input Shaft	1		●				
15	102.588	1297 221 006	Input Shaft	1	NMV130 (Clutch PTO)	●				
16	171.084	0635 470 012	Needle D.7x7	1		●				
17	160.116	1240 304 278	Pressure Piece	3		●				
18	156.036	0732 040 386	Inner Spring De.3x34	3		●				
19	156.037	0732 040 385	Outer Spring De.6x34	3		●				
20	188.211	0730 062 323	Oil Plug	1		●				
21	154.097	1295 304 002	Sliding Sleeve	1		●				
22	109.072	1295 304 278	Synchronizer Cone	1		●				
23	137.113	0750 118 038	Roller Cage 35x68x27,50	1		●				
24	187.412	0737 502 092	Grooved Nut M60x1,5	1		●				
25	137.083	0750 118 005	Roller Cage 63x97,5x34,80	2		●				
26	145.529	1297 304 128	Gear 4th Speed 28 T	1	A	●				
26	145.420	1297 304 127	Gear 4th Speed 30 T	1	B	●				
26	145.530	1297 304 258	Gear 4th Speed 29 T	1	C	●				
27	157.195	1297 304 188	Fixed Hub 4th/5th Speed	1		●				
28	154.189	1297 304 120	Sliding Sleeve	1		●				
29	145.531	1297 304 116	Gear 3rd Speed 32 T	1	AC	●				

Date

09/2014

Notes

(10) For Input shaft 1297 202 008

(11) For Input shaft 1297 202 053

(12) For Input shaft 1297 221 006

MODELS:

- ECOSPLIT I-II

VERSIONS:

- 16K160 (1297 xxx xxx)

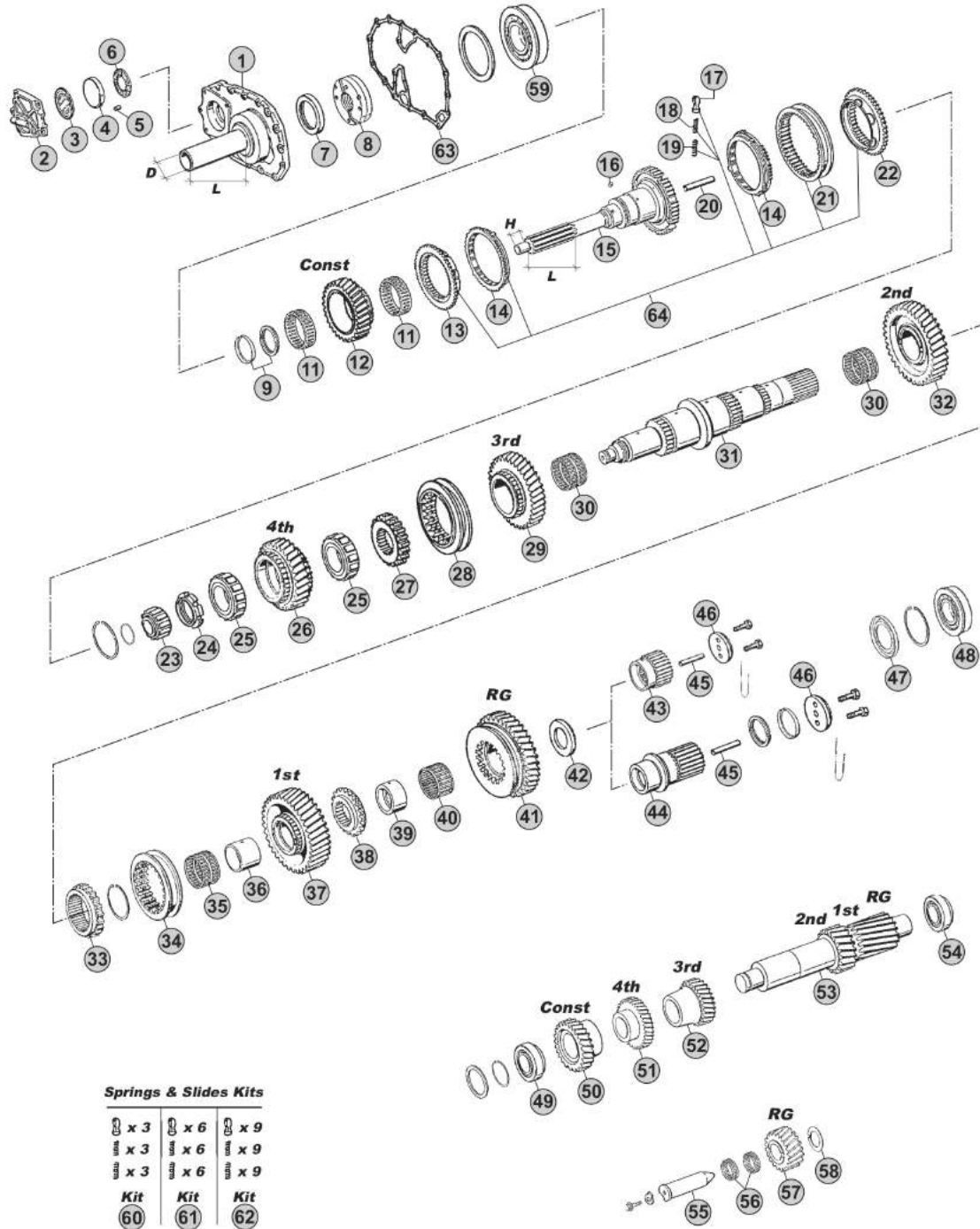

Springs & Slides Kits

x 3	x 6	x 9
x 3	x 6	x 9
x 3	x 6	x 9
Kit	Kit	Kit
60	61	62

Notes

- (A) R. 11,46-0,85
- (B) R. 13,68-1,00
- (C) R. 14,29-0,82

Our spare parts are not the originals but interchangeable with the originals ones. All original equipment manufacturers' numbers, pictures and models used in this catalogue are for reference only. Our products bear our trade-mark.

Our spare parts are not the originals but interchangeable with the originals ones. All original equipment manufacturers' numbers, pictures and models used in this catalogue are for reference only. Our products bear our trade-mark.

Fig.	CEI no.	ZF no.	Description	Q.ty	Notes	16K160				
29	145.468	1297 304 115	Gear 3rd Speed 34 T	1	B	●				
30	137.084	0735 320 418	Needle Cage 82x90x49	2		●				
31	103.134	1297 304 179	Main Shaft	1	AB	●				
31	103.139	1297 304 264	Main Shaft	1	C	●				
32	145.532	1297 304 113	Gear 2nd Speed 37 T	1	AC	●				
32	145.467	1297 304 112	Gear 2nd Speed 38 T	1	B	●				
33	157.197	1295 304 235	Fixed Hub 1st/2nd Speed	1		●				
34	154.188	1297 304 119	Sliding Sleeve	1		●				
35	137.161	0735 320 568	Needle Cage D.82x90x53	1		●				
36	117.317	1297 304 055	Bush	1		●				
37	145.534	1297 304 151	Gear 1st Speed 44 T	1	AC	●				
37	145.469	1297 304 150	Gear 1st Speed 47 T	1	B	●				
38	109.178	1297 304 154	Synchronizer Cone	1		●				
39	117.318	1297 304 034	Bush	1	AB	●				
40	137.111	0735 320 486	Needle Cage 78x86x44	1		●				
41	147.109	1297 304 149	Reverse Gear 39 T	1	AC	●				
41	147.140	1297 304 148	Reverse Gear 38 T	1	B	●				
42	169.758	1297 304 177	Thrust Washer	1	AB	●				
43	157.177	1297 304 187	Sun Gear 27 T	1	AB	●				
44	157.206	1297 304 265	Side Gear 24 T	1	C	●				
45	189.671	0730 061 842	Oil Tube	1		●				
46	188.076	1272 304 021	Stop Washer	1		●				
47	139.922	1295 304 129	Oil Collector	1	AB	●				
47	139.923	1297 301 004	Oil Collector	1	C	●				
48	130.240	0750 118 153	Bearing 60x130x31	1	AB	●				
48	130.934	0750 118 137	Bearing 80x140x26	1	C	●				
49	130.242	0750 117 010	Bearing 50,80x100x35	1		●				
50	146.383	1297 303 074	Constant Gear 31 T	1	A	●				
50	146.322	1297 303 066	Constant Gear 34 T	1	B	●				
50	146.319	1297 303 098	Constant Gear 32 T	1	C	●				
51	146.382	1297 303 072	Gear 4th Speed 34 T	1	A	●				
51	146.381	1297 303 065	Gear 4th Speed 31 T	1	B	●				
51	146.447	1297 303 114	Gear 4th Speed 39 T	1	C	●				
52	146.446	1297 303 081	Gear 3rd Speed 28 T	1	AC	●				
52	146.380	1297 303 077	Gear 3rd Speed 25 T	1	B	●				
53	105.116	1297 303 048	Countershaft 19/23 T	1	AC	●				
53	105.309	1297 303 070	Countershaft 19-23 T	1	(20) AC	●				
53	105.091	1297 303 047	Countershaft 17/20 T	1	B	●				
54	130.243	0750 117 008	Bearing 50x110x42	1		●				
55	107.108	1295 305 056	Reverse Gear Pin	1		●				
56	137.007	0750 115 011	Needle Cage 45x53x21	2		●				
57	147.133	1295 305 051	Reverse Gear 21 T	1	AC	●				
57	147.094	1295 305 052	Reverse Gear 24 T	1	B	●				

 ECOSPLIT I-II
16K160

Date

09/2014

Notes

(20) Only for models having MNV130 (CLUTCH PTO)

MODELS:

- ECOSPLIT I-II

VERSIONS:

- 16K160 (1297 xxx xxx)

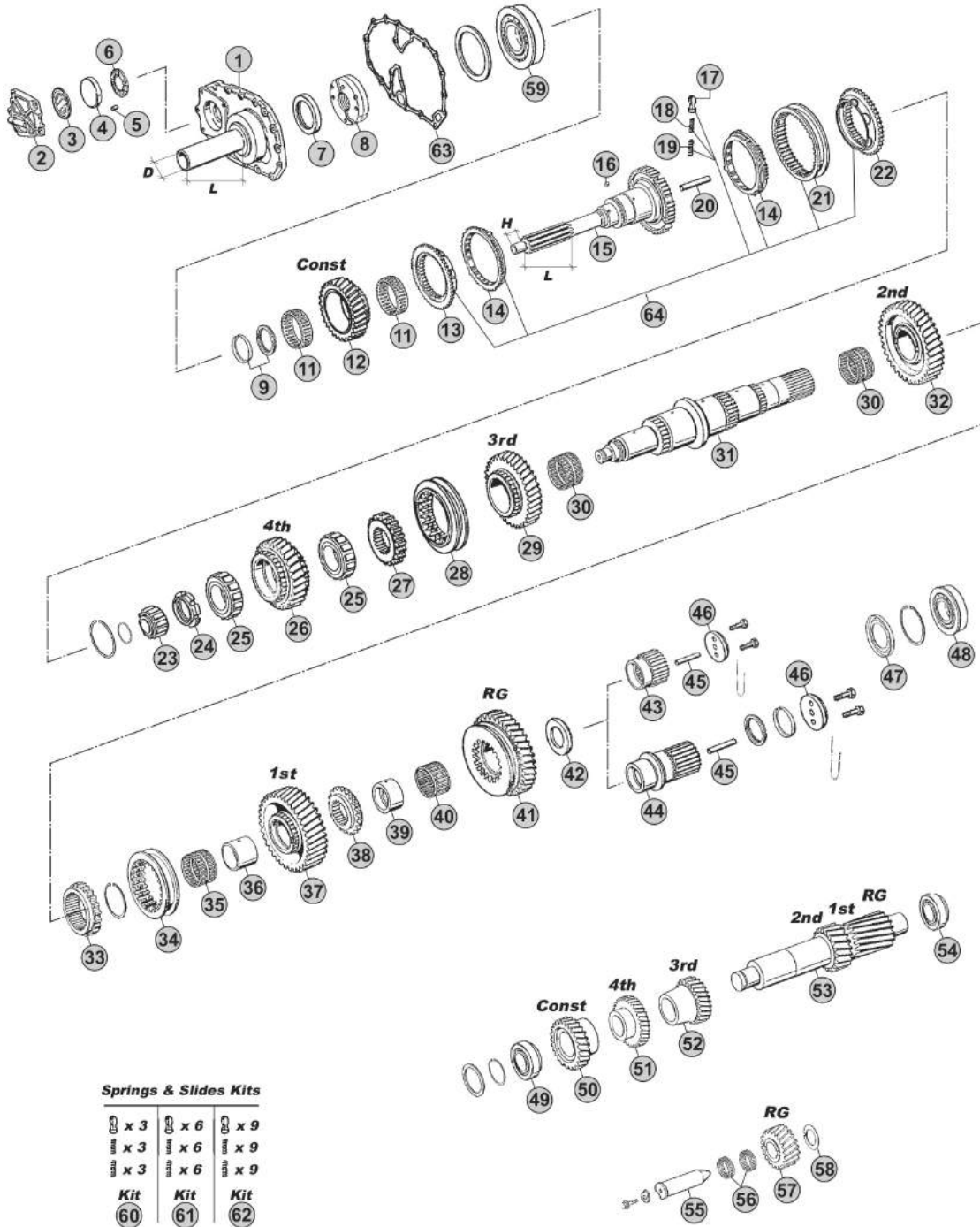

Springs & Slides Kits

x 3	x 6	x 9
x 3	x 6	x 9
x 3	x 6	x 9
Kit	Kit	Kit
60	61	62

Our spare parts are not the originals but interchangeable with the originals ones. All original equipment manufacturers' numbers, pictures and models used in this catalogue are for reference only. Our products bear our trade-mark.

Notes

- (A) R. 11,46-0,85
- (B) R. 13,68-1,00
- (C) R. 14,29-0,82

MODELS:

- ECOSPLIT I-II

VERSIONS:

- 16K160 (1297 xxx xxx)

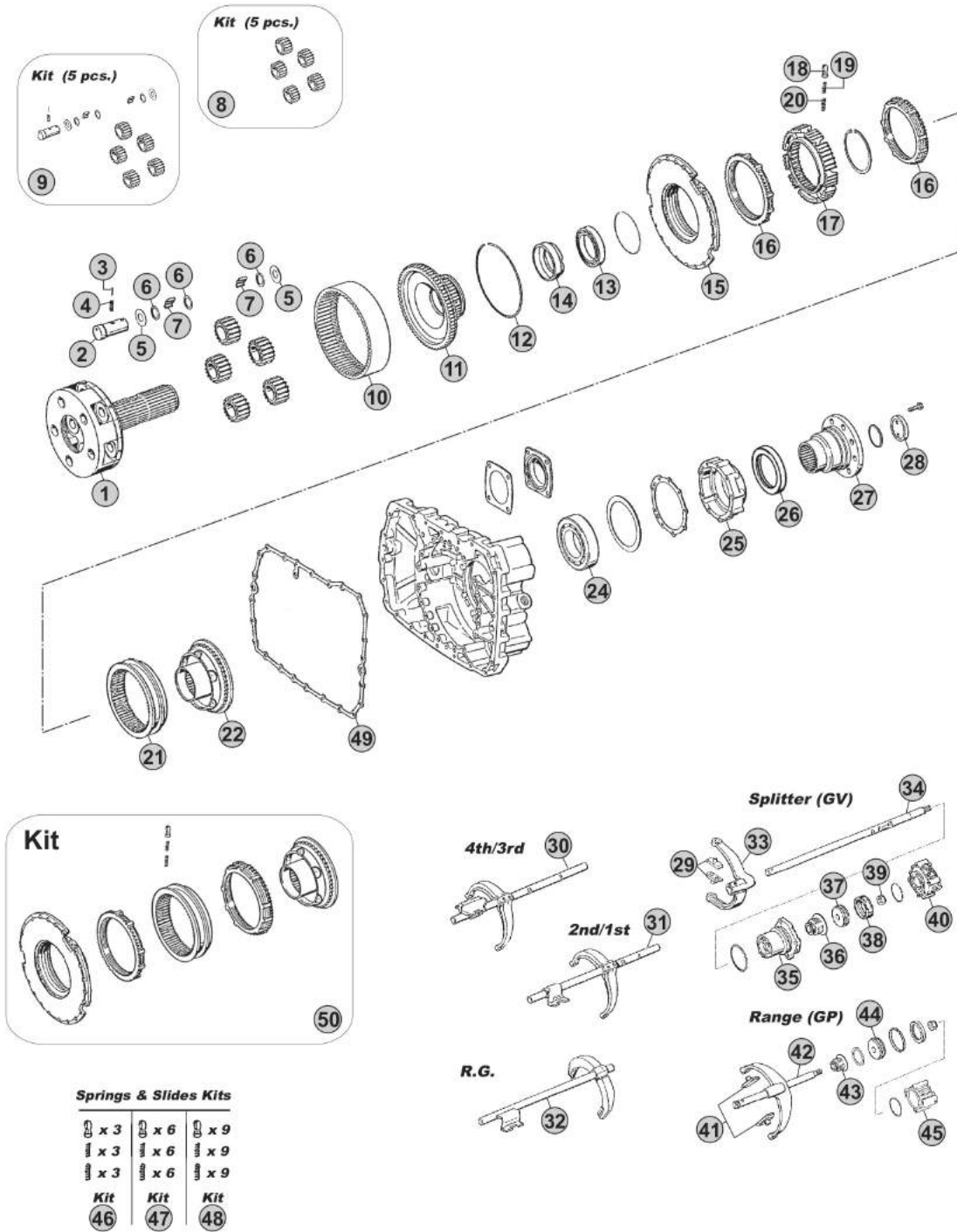

Notes

- (A) R. 11,46-0,85
- (B) R. 13,68-1,00
- (C) R. 14,29-0,82

Our spare parts are not the originals but interchangeable with the originals ones. All original equipment manufacturers' numbers, pictures and models used in this catalogue are for reference only. Our products bear our trade-mark.

Fig.	CEI no.	ZF no.	Description	Q.ty	Notes	16K160				
1	190.396	1297 232 039	Planetary Carrier	1	AB	●				
1	190.395	1297 232 045	Planetary Carrier	1	C	●				
2	107.163	1297 332 109	Planet pin	5		●				
3	160.191	0631 329 017	Lock Pin 3x24	5		●				
4	160.192	0631 329 050	Lock Pin 5x24	5		●				
5	169.753	0501 306 212	Thrust Washer 29x64x1,5	10		●				
6	169.410	0730 103 846	Spacer Ring 29x39x1,00	15		●				
7	171.045	0750 119 143	Needle 10x16,80 (120 pcs)	120		●				
8	198.803	1297 232 023	Planetary Gear Set (5 pcs)	1	AB	●				
8	198.810	1297 232 024	Planetary Gear Set (5 pcs)	1	C	●				
9	198.704	1297 298 912	Planetary Gear Set (5 pcs)	1	AB	●				
9	298.807	1297 298 919	Planetary Gear Set	1	C	●				
10	123.217	1297 332 080	Crown Gear 83 T	1	AB	●				
10	123.208	1295 332 086	Crown Gear 86 T	1	C	●				
11	150.138	1297 332 017	Carrier Hub 83 T	1	AB	●				
11	150.137	1297 332 035	Carrier Hub 86 T	1	C	●				
12	111.129	0730 505 055	Locking Wire	1	AB	●				
12	111.198	0730 505 056	Locking Wire	1	C	●				
13	130.310	0750 116 165	Bearing 80x110x16	1		●				
14	119.255	1297 332 122	Intermediate Ring	1		●				
15	198.358	1296 233 006	Synchro Cone	1		●				
16	119.085	1296 333 022	Synchronizer Ring	2	Old Type	●				
16	119.172	1296 333 045	Synchronizer Ring	2	New Type	●				
17	157.113	1296 333 002	Synchronizer Hub	1		●				
18	160.116	1240 304 278	Pressure Piece	9		●				
19	156.036	0732 040 386	Inner Spring De.3x34	9		●				
20	156.037	0732 040 385	Outer Spring De.6x34	9		●				
21	154.098	1296 333 023	Sliding Sleeve	1		●				
22	198.374	1313 233 001	Synchronizer Cone (38 Spl.)	1		●				
24	130.245	0750 116 394	Bearing 90x160x30	1		●				
25	128.260	1296 301 067	Cover	1		●				
26	139.878	0750 111 341	Oil Seal 105x130x12	1		●				
27	197.167	1297 338 041	Output Flange D.180 mm	1	D.180-4 H.	●				
27	197.162	1297 338 010	Output Flange D.180 mm	1	D.180-10 H.	●				
28	188.077	1295 332 051	Stop Washer	1		●				
29	141.068	1295 306 132	Bronze Slide	2		●				
30		1297 206 077	Fork	1		●				
30		1297 206 083	Fork	1		●				
31	141.248	1297 206 076	Fork	1		●				
31		1297 206 082	Fork	1		●				
32		1297 206 172	Fork	1		●				
32		1297 206 173	Fork	1		●				
32		1297 206 184	Fork	1		●				

 ECOSPLIT I-II
16K160

Date

09/2014

Notes

MODELS:

- ECOSPLIT I-II

VERSIONS:

- 16K160 (1297 xxx xxx)

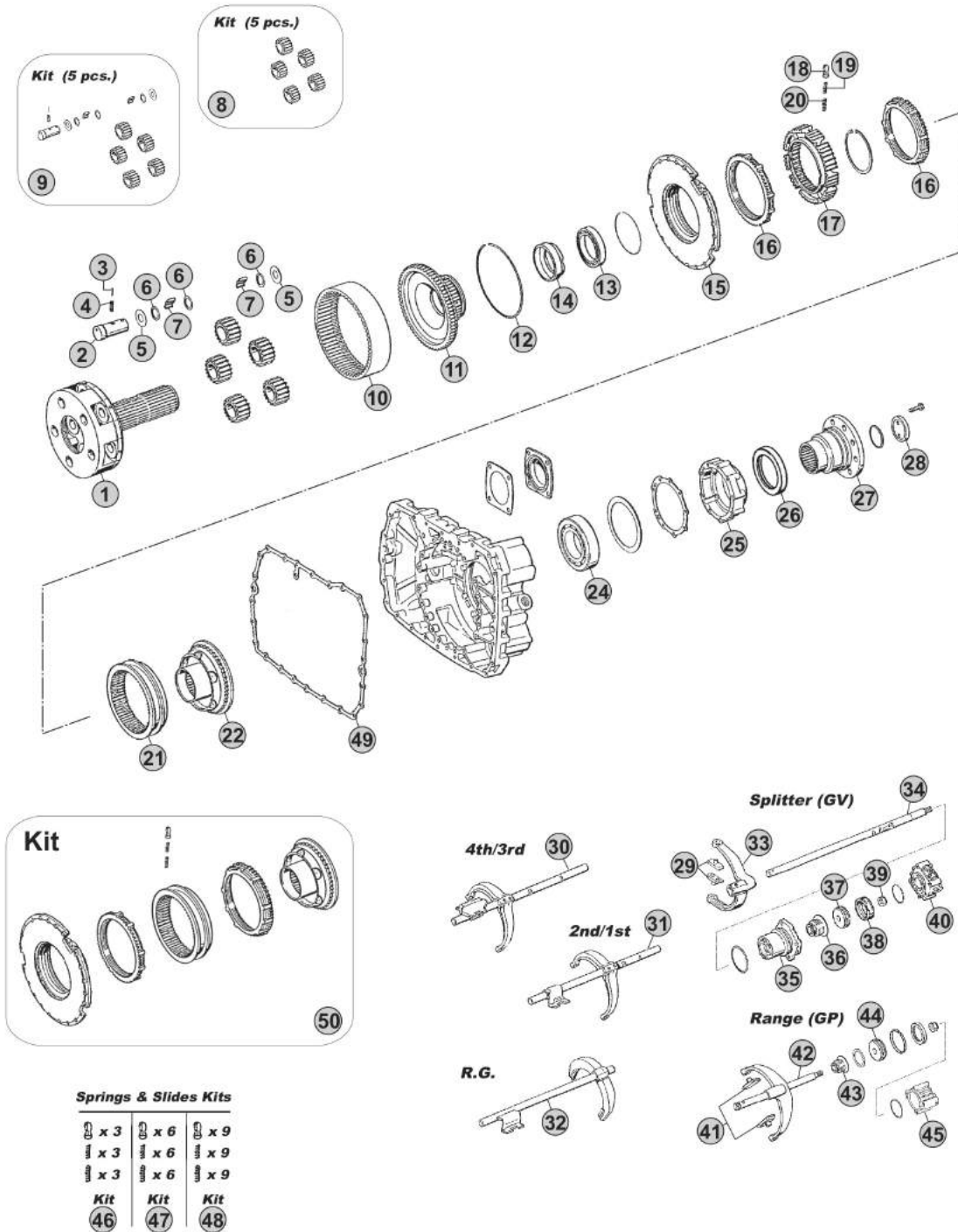

Our spare parts are not the originals but interchangeable with the originals ones. All original equipment manufacturers' numbers, pictures and models used in this catalogue are for reference only. Our products bear our trade-mark.

Notes

- (A) R. 11,46-0,85
- (B) R. 13,68-1,00
- (C) R. 14,29-0,82

