

MODELS:

- ECOSPLIT I-II

VERSIONS:

- 16S160/A (1297 xxx xxx)

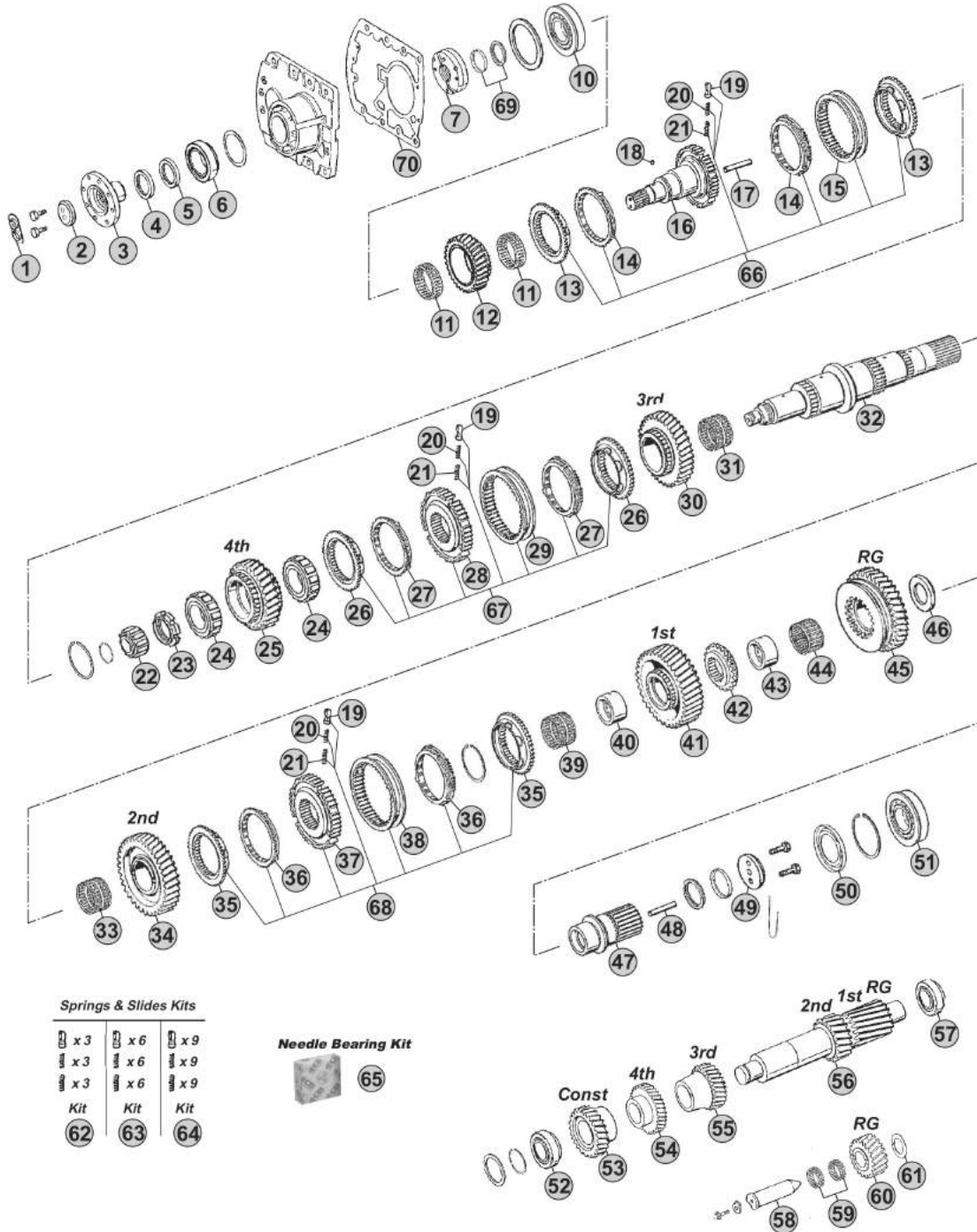

Springs & Slides Kits

x3	x6	x9
x3	x6	x9
x3	x6	x9
Kit	Kit	Kit
62	63	64

Needle Bearing Kit



Notes

- (A) R. 11,74-0,87
- (B) R. 14,01-1,02
- (C) R. 17,47-1,02

Our spare parts are not the originals but interchangeable with the originals ones. All original equipment manufacturers' numbers, pictures and models used in this catalogue are for reference only. Our products bear our trade-mark.

Fig.	CEI no.	ZF no.	Description	Q.ty	Notes	16S160/A				
1	188.274	1269 302 164	Stop Washer	1		●				
2	188.078	1269 302 065	Stop Washer	1		●				
3	155.327	1286 304 043	Input Flange	1		●				
4	139.973	0734 300 140	Oil Seal 70x90x10	1		●				
5	139.974	0634 310 648	Oil Seal 70x90x10	1		●				
6	130.432	0750 117 418	Bearing	1		●				
7	280.348	1295 202 041	Oil Pump	1		●				
10	130.306	0750 117 431	Bearing 75x150x30,50	1		●				
11	137.153	0735 320 896	Needle Cage 88x96x29	2		●				
12	145.466	1297 302 177	Constant Gear 30 T	1	A	●				
12	145.406	1297 302 176	Constant Gear 28 T	1	B	●				
12	145.407	1297 302 241	Constant Gear 26 T	1	C	●				
13	109.072	1295 304 278	Synchronizer Cone	2		●				
14	119.084	1295 304 004	Synchronizer Ring	2	Old Type	●				
14	119.175	1304 304 686	Synchronizer Ring	2	New Type	●				
15	154.097	1295 304 002	Sliding Sleeve	1		●				
16	102.237	1297 202 044	Input Shaft	1		●				
17	188.211	0730 062 323	Oil Plug	1		●				
18	171.084	0635 470 012	Needle D.7x7	1		●				
19	160.116	1240 304 278	Pressure Piece	3	3x3 pcs.	●				
20	156.036	0732 040 386	Inner Spring De.3x34	3	3x3 pcs.	●				
21	156.037	0732 040 385	Outer Spring De.6x34	3	3x3 pcs.	●				
22	137.113	0750 118 038	Roller Cage 35x68x27,50	1		●				
23	187.412	0737 502 092	Grooved Nut M60x1,5	1		●				
24	137.157	0750 118 220	Roller Cage D.63x97,5x37,50	2		●				
25	146.384	1297 304 267	Gear 4th Speed 28 T	1	A	●				
25	146.318	1297 304 260	Gear 4th Speed 30 T	1	B	●				
25	146.294	1297 304 413	Gear 4th Speed 29 T	1	C	●				
26	109.072	1295 304 278	Synchronizer Cone	2		●				
27	119.084	1295 304 004	Synchronizer Ring	2	Old Type	●				
27	119.175	1304 304 686	Synchronizer Ring	2	New Type	●				
28	157.110	1297 304 031	Synchronizer Hub	1		●				
29	154.097	1295 304 002	Sliding Sleeve	1		●				
30	145.470	1297 304 266	Gear 3rd Speed 32 T	1	A	●				
30	145.450	1297 304 261	Gear 3rd Speed 34 T	1	B	●				
30	145.377	1297 304 414	Gear 3rd Speed 34 T	1	C	●				
31	137.112	0735 320 451	Needle Cage 82x90x60	1		●				
32	103.322	1297 304 221	Main Shaft	1		●				
33	137.109	0735 320 452	Needle Cage 82x90x55	1		●				
34	145.500	1297 304 269	Gear 2nd Speed 37 T	1	A	●				
34	145.375	1297 304 442	Gear 2nd Speed 38 T	1	BC	●				
35	109.074	1297 304 196	Synchronizer Cone	2		●				
36	119.125	1296 304 135	Synchronizer Ring	2	Z 54 - Alt. use 119.086	●				

 ECOSPLIT-II
16S160/A

Date

09/2014

Notes

MODELS:

- ECOSPLIT I-II

VERSIONS:

- 16S160/A (1297 xxx xxx)

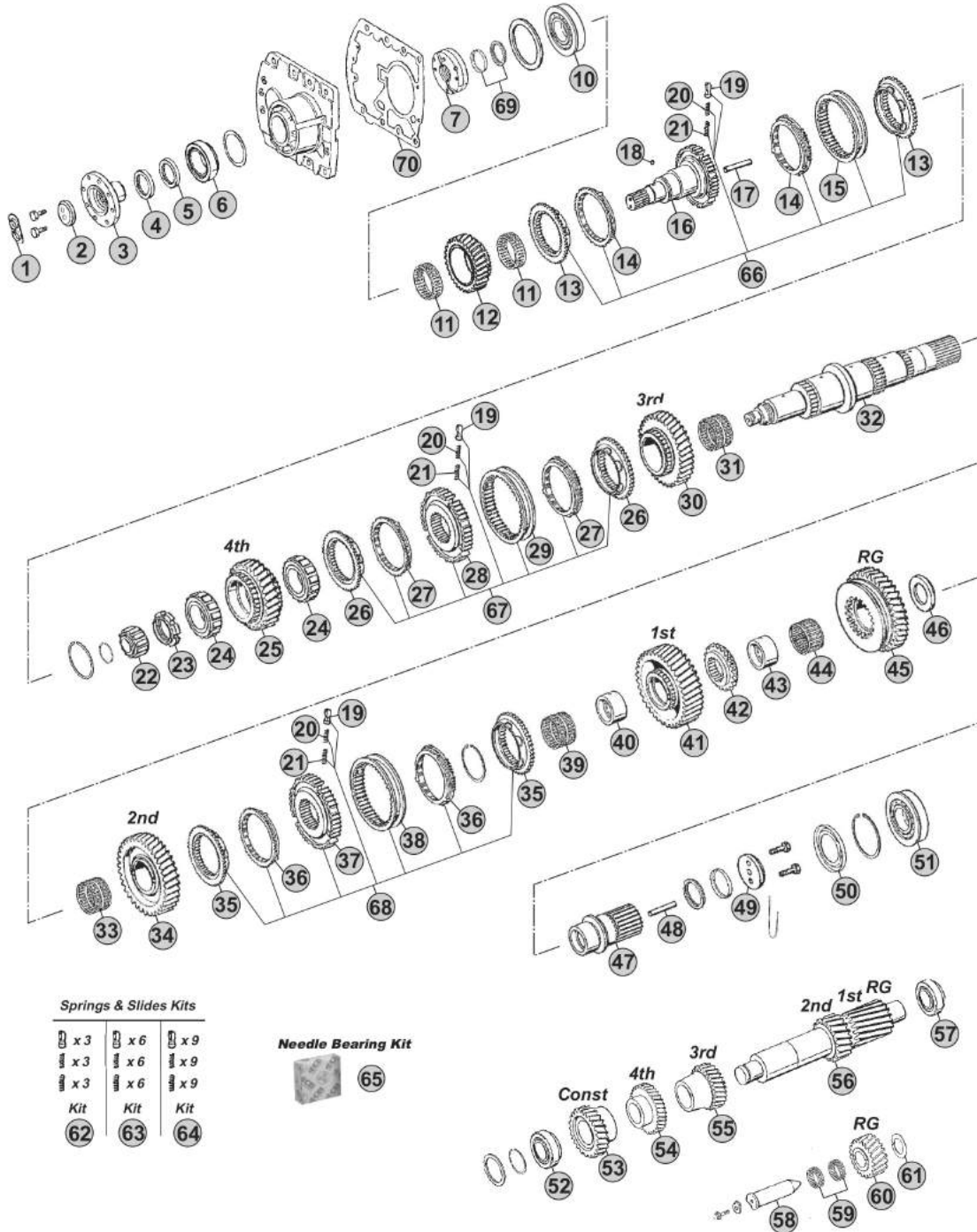

Springs & Slides Kits

x3	x6	x9
x3	x6	x9
x3	x6	x9
Kit	Kit	Kit
62	63	64

Needle Bearing Kit



Notes

- (A) R. 11,74-0,87
- (B) R. 14,01-1,02
- (C) R. 17,47-1,02

Our spare parts are not the originals but interchangeable with the originals ones. All original equipment manufacturers' numbers, pictures and models used in this catalogue are for reference only. Our products bear our trade-mark.

Fig.	CEI no.	ZF no.	Description	Q.ty	Notes	16S160/A				
36	119.086	1246 304 278	Synchronizer Ring	2	Z 42 - Alt. use 119.125	●				
37	157.111	1297 304 195	Synchronizer Hub	1		●				
38	154.051	1257 304 020	Sliding Sleeve	1		●				
39	137.110	0735 320 487	Needle Cage 82x90x68	1		●				
40	117.246	1297 304 035	Bush	1		●				
41	145.507	1297 304 270	Gear 1st Speed 44 T	1	A	●				
41	145.376	1297 304 441	Gear 1st Speed 47 T	1	BC	●				
42	109.178	1297 304 154	Synchronizer Cone	1		●				
43	117.318	1297 304 034	Bush	1		●				
44	137.111	0735 320 486	Needle Cage 78x86x44	1		●				
45	147.109	1297 304 149	Reverse Gear 39 T	1	A	●				
45	147.140	1297 304 148	Reverse Gear 38 T	1	BC	●				
46	169.757	1297 304 381	Thrust Washer	1		●				
47	157.239	1297 304 253	Sun Gear	1	AB	●				
47	157.243	1297 304 190	Sun gear	1	C	●				
48	189.671	0730 061 842	Oil Tube	1		●				
49	188.076	1272 304 021	Stop Washer	1		●				
50	139.923	1297 301 004	Oil Collector	1		●				
51	130.702	0750 118 006	Bearing 65x140x33	1		●				
52	130.242	0750 117 010	Bearing 50,80x100x35	1		●				
53	146.383	1297 303 074	Constant Gear 31 T	1	A	●				
53	146.322	1297 303 066	Constant Gear 34 T	1	B	●				
53	146.321	1297 303 086	Constant Gear 35 T	1	C	●				
54	146.382	1297 303 072	Gear 4th Speed 34 T	1	A	●				
54	146.381	1297 303 065	Gear 4th Speed 31 T	1	B	●				
54	146.416	1297 303 123	Gear 4th Speed 32 T	1	C	●				
55	146.357	1297 303 073	Gear 3rd Speed 28 T	1	A	●				
55	146.421	1297 303 067	Gear 3rd Speed 25 T	1	B	●				
55	146.422	1297 303 132	Gear 3rd Speed 26 T	1	C	●				
56	105.092	1297 303 075	Countershaft 19/23 T	1	A	●				
56	105.093	1297 303 140	Countershaft 17/20 T	1	BC	●				
57	130.308	0750 117 009	Bearing 49,2x103,1x43,6	1		●				
58	107.276	1297 305 008	Reverse Gear Pin	1		●				
59	137.007	0750 115 011	Needle Cage 45x53x21	2		●				
60	147.133	1295 305 051	Reverse Gear 21 T	1	A	●				
60	147.094	1295 305 052	Reverse Gear 24 T	1	BC	●				
61	169.234	0730 150 064	Thrust Washer	1		●				
62	198.339	1268 298 938	Spring Slide kit	1		●				
63	198.564		Spring Slide kit	1		●				
64	198.842	1295 298 933	Spring Slide kit	1		●				
65	298.425	1295 298 947	Needle Cages Kit	1		●				
66	198.724	1295 298 936	Synchro Kit	1	W/"Old Type" synchro rings	●				
66	298.323	1297 298 962	Synchro Kit	1	W/"New Type" synchro rings	●				

ECOSPLIT I-II
16S160/A

Date

09/2014

Notes

MODELS:

- ECOSPLIT I-II

VERSIONS:

- 16S160/A (1297 xxx xxx)

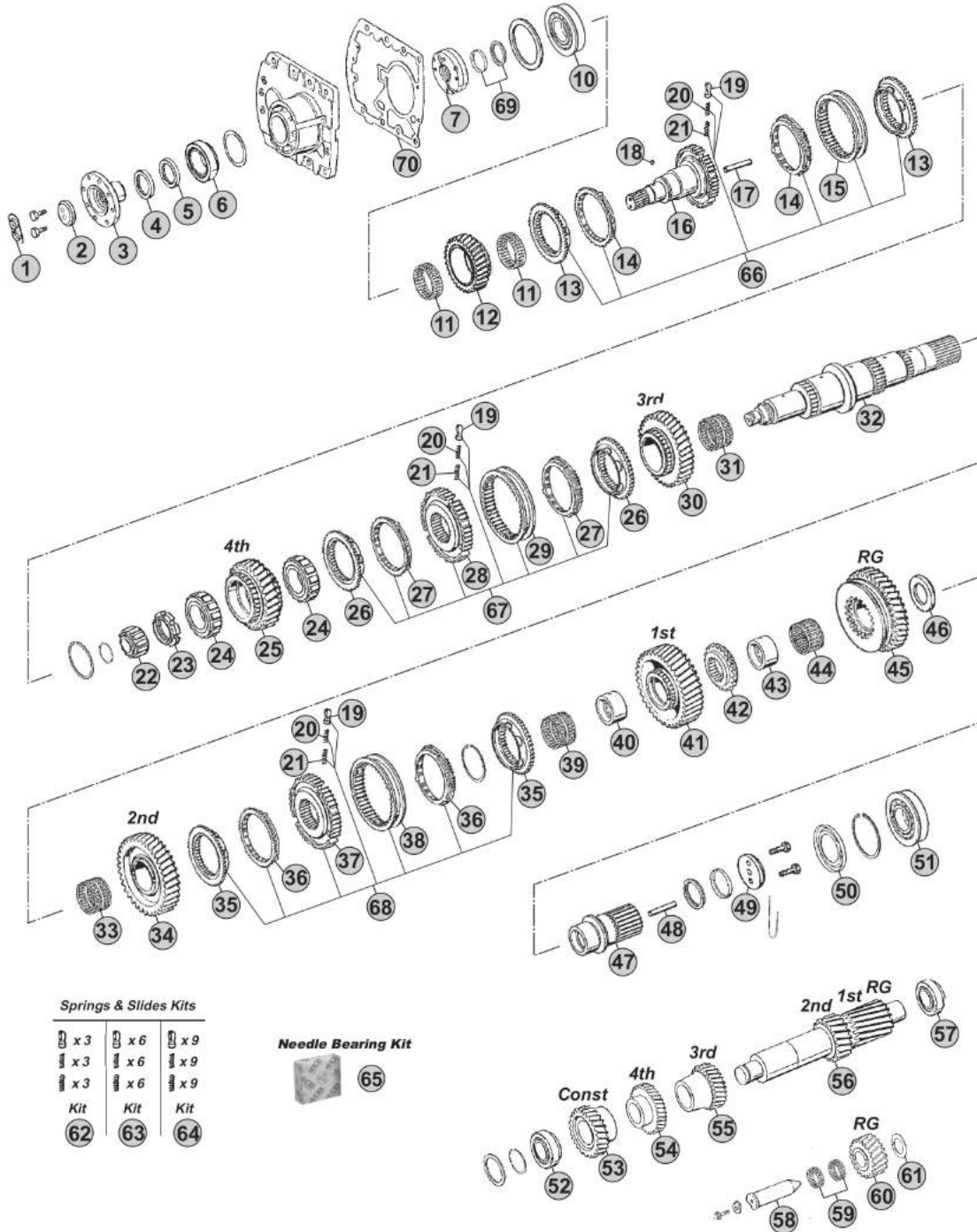

Springs & Slides Kits

x3	x6	x9
x3	x6	x9
x3	x6	x9
Kit	Kit	Kit
62	63	64

Needle Bearing Kit



Notes

- (A) R. 11,74-0,87
- (B) R. 14,01-1,02
- (C) R. 17,47-1,02

Our spare parts are not the originals but interchangeable with the originals ones. All original equipment manufacturers' numbers, pictures and models used in this catalogue are for reference only. Our products bear our trade-mark.

Fig.	CEI no.	ZF no.	Description	Q.ty	Notes	16S160/A			
67	198.807	1297 298 958	Synchron.Kit 3rd-4th Speed	1	W/"New Type" synchro rings	●			
68	198.809	1297 298 956	Synchron.kit 1st-2nd Speed	1		●			
69	298.408	1499 298 136	Shims Kit Th. 4,35mm	1		●			
69	298.409	1499 298 135	Shims Kit Th. 4,30mm	1		●			
69	298.410	1499 298 134	Shims Kit Th. 4,25mm	1		●			
69	298.411	1499 298 133	Shims Kit Th. 4,20mm	1		●			
69	298.412	1499 298 132	Shims Kit Th. 4,15mm	1		●			
69	298.413	1499 298 131	Shims Kit Th. 4,10mm	1		●			
69	298.419	1499 298 130	Shims Kit Th. 4,05mm	1		●			
69	298.420	1499 298 129	Shims Kit Th.4,00 mm	1		●			
69	298.421	1499 298 128	Shims Kit Th.3,95 mm	1		●			
69	298.422	1499 298 127	Shims Kit Th.3,90 mm	1		●			
69	298.423	1499 298 126	Shims Kit Th.3,85 mm	1		●			
69	298.424	1499 298 125	Shims Kit Th.3,80 mm	1		●			
70	239.004	1313 302 044	Gasket	1		●			

ECOSPLIT H-II
16S160/A

Date 09/2014 Notes



MODELS:

- ECOSPLIT I-II

VERSIONS:

- 16S160/A (1297 xxx xxx)

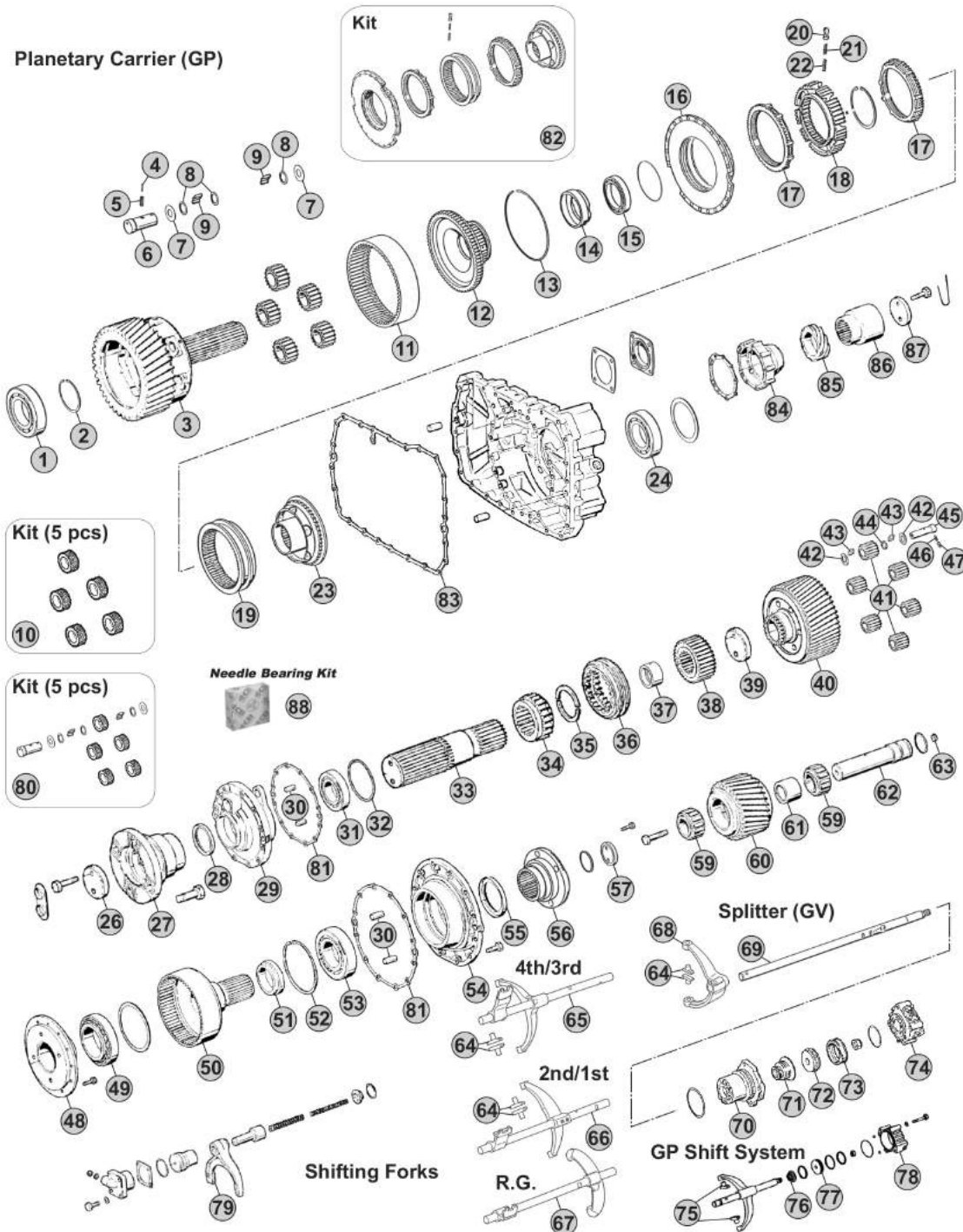

Notes

- (A) R. 11,74-0,87
- (B) R. 14,01-1,02
- (C) R. 17,47-1,02

Our spare parts are not the originals but interchangeable with the originals ones. All original equipment manufacturers' numbers, pictures and models used in this catalogue are for reference only. Our products bear our trade-mark.

Fig.	CEI no.	ZF no.	Description	Q.ty	Notes	16S160/A			
1	130.433	0735 410 110	Bearing 110x200x38	1		●			
2	111.440	0630 501 058	Retainer Ring	1		●			
3	190.553	1297 232 057	Planetary Carrier	1	AB	●			
3	190.557	1297 232 058	Planetary Carrier	1	C	●			
4	160.191	0631 329 017	Lock Pin 3x24	5		●			
5	160.192	0631 329 050	Lock Pin 5x24	5		●			
6	107.163	1297 332 109	Planet pin	5		●			
7	169.753	0501 306 212	Thrust Washer 29x64x1,5	10		●			
8	169.410	0730 103 846	Spacer Ring 29x39x1,00	15		●			
9	171.045	0750 119 143	Needle 10x16,80 (120 pcs)	120		●			
10	198.803	1297 232 023	Planetary Gear Set (5 pcs)	1	AB	●			
10	198.810	1297 232 024	Planetary Gear Set (5 pcs)	1	C	●			
11	123.217	1297 332 080	Crown Gear 83 T	1	AB	●			
11	123.331	1297 332 086	Crown Gear 86 T	1	C	●			
12	150.138	1297 332 017	Carrier Hub 83 T	1	AB	●			
12	150.137	1297 332 035	Carrier Hub 86 T	1	C	●			
13	111.129	0730 505 055	Locking Wire	1	AB	●			
13	111.198	0730 505 056	Locking Wire	1	C	●			
14	119.255	1297 332 122	Intermediate Ring	1		●			
15	130.310	0750 116 165	Bearing 80x110x16	1		●			
16	198.358	1296 233 006	Synchro Cone	1		●			
17	119.085	1296 333 022	Synchronizer Ring	2	Old Type	●			
17	119.172	1296 333 045	Synchronizer Ring	2	New Type	●			
18	157.113	1296 333 002	Synchronizer Hub	1		●			
19	154.098	1296 333 023	Sliding Sleeve	1		●			
20	160.116	1240 304 278	Pressure Piece	9		●			
21	156.036	0732 040 386	Inner Spring De.3x34	9		●			
22	156.037	0732 040 385	Outer Spring De.6x34	9		●			
23	198.374	1313 233 001	Synchronizer Cone (38 Spl.)	1		●			
24	130.245	0750 116 394	Bearing 90x160x30	1		●			
26	188.077	1295 332 051	Stop Washer	1		●			
27	197.167	1297 338 041	Output Flange D.180 mm	1		●			
27	197.162	1297 338 010	Output Flange D.180 mm	1		●			
28	139.975	0750 111 107	Oil Seal	1		●			
29	128.341	1297 339 030	Rear Cover	1		●			
30	160.313	0631 306 776	Pin	2	2x2 pcs.	●			
31	130.245	0750 116 394	Bearing 90x160x30	1		●			
32	111.441	0630 502 054	Retainer Ring	1		●			
33	103.313	1297 339 029	Output Shaft 38 T	1	AB	●			
33	103.315	1297 339 028	Output Shaft	1	C	●			
34	155.328	1297 339 024	Fixed Hub	1		●			
35	269.814	1297 339 005	Shim	1		●			
36	154.514	1297 339 035	Sliding Sleeve	1		●			

ECOSPLIT II
16S160/A

Date

09/2014

Notes

MODELS:

- ECOSPLIT I-II

VERSIONS:

- 16S160/A (1297 xxx xxx)

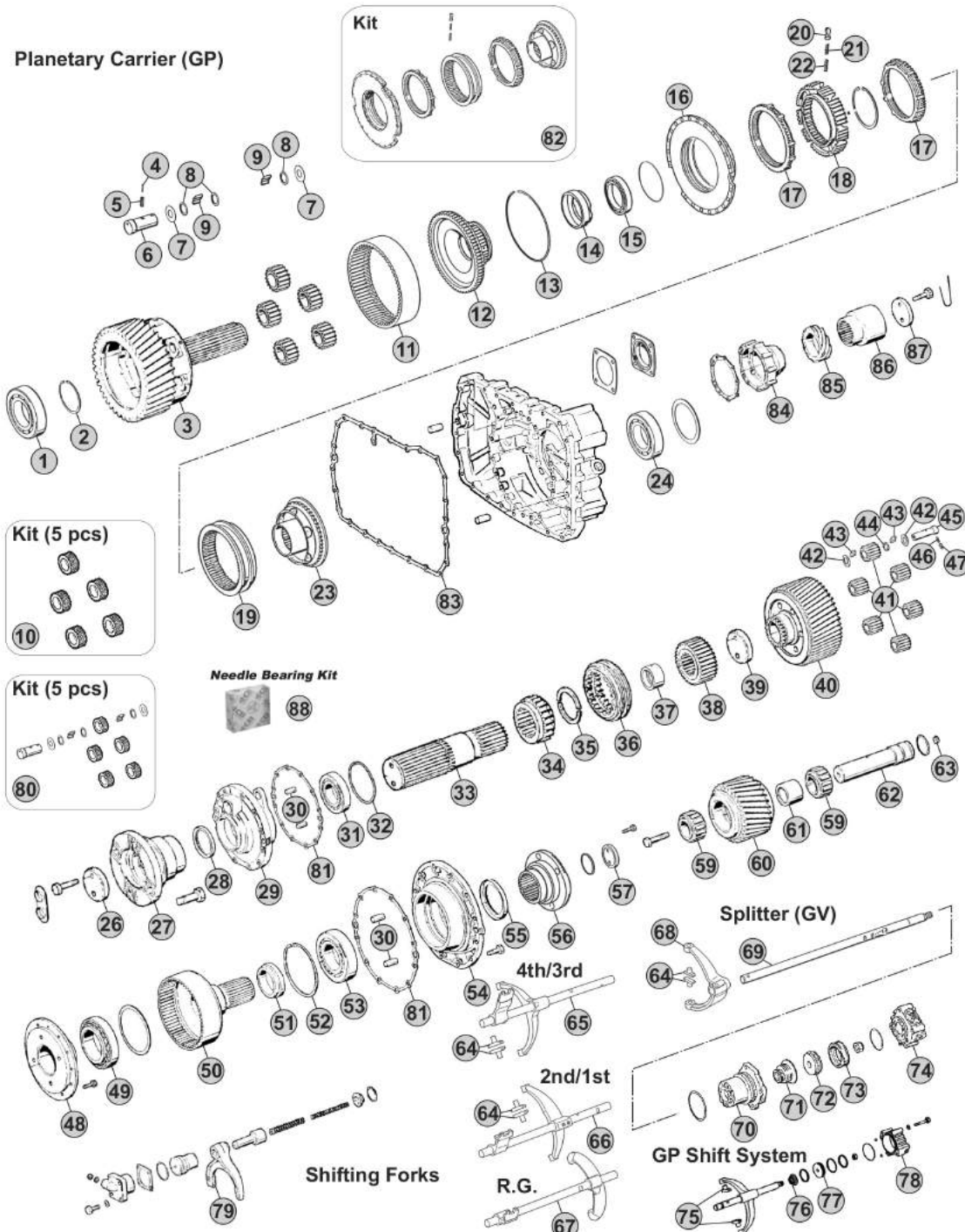

Notes

- (A) R. 11,74-0,87
- (B) R. 14,01-1,02
- (C) R. 17,47-1,02

Our spare parts are not the originals but interchangeable with the originals ones. All original equipment manufacturers' numbers, pictures and models used in this catalogue are for reference only. Our products bear our trade-mark.

Fig.	CEI no.	ZF no.	Description	Q.ty	Notes	16S160/A				
37	117.481	1297 339 003	Bush	1		●				
38	157.240	1297 339 002	Sun Gear 41 T	1		●				
39	269.815	1259 303 004	Washer	1		●				
40	190.558	1312 237 002	Planetary Carrier	1	AC	●				
40	190.554	1312 237 001	Planetary Carrier	1	B	●				
41	298.156	1297 237 005	Planetary Gear Set	1	AC	●				
41	298.115	1297 237 006	Planetary Gear Set	1	B	●				
42	269.671	0730 002 088	Washer	10	AC	●				
42	269.816	0730 002 087	Washer	12	B	●				
43	171.088	0635 490 013	Needle 3,5x17,8	300	AC	●				
43	171.008	0635 490 053	Needle	300	B	●				
44	269.672	0730 104 292	Ring	5	AC	●				
44	269.817	0730 104 290	Ring	6	B	●				
45	107.222	1297 337 009	Planetary pin	5	AC	●				
45	160.314	1297 337 027	Planetary pin	6	B	●				
46	160.315	0631 329 014	Lock Pin	6		●				
47	160.316	0631 329 046	Lock pin	6		●				
48	128.342	1297 337 017	Rear Cover	1		●				
49	130.434	0635 370 030	Bearing	2		●				
50	103.314	1297 338 048	Output Shaft	1		●				
51	269.818	1297 338 019	Thrust Ring	1		●				
52	111.441	0630 502 054	Retainer Ring	1		●				
53	130.245	0750 116 394	Bearing 90x160x30	1		●				
54	128.343	1297 338 083	Cover	1		●				
55	139.975	0750 111 107	Oil Seal	1		●				
56	197.167	1297 338 041	Output Flange D.180 mm	1		●				
56	197.162	1297 338 010	Output Flange D.180 mm	1		●				
57	188.077	1295 332 051	Stop Washer	1		●				
59	137.016	0750 118 016	Needle Cage 55x106,5x43	2		●				
60	244.207	1312 336 001	Gear Low Speed	1		●				
61	117.505	1297 336 008	Bush	1		●				
62	160.317	1297 336 010	Pin	1		●				
63	185.065	0636 301 048	Screw Plug	1		●				
64	141.068	1295 306 132	Bronze Slide	2	3x2 pcs.	●				
65		1297 206 110	Complete Fork	1		●				
66		1297 206 109	Complete Fork	1		●				
67	298.824	1297 206 174	Complete Fork	1		●				
68	141.086	1313 312 002	Shift Yoke	1		●				
69	149.274	1297 312 011	Gear Shift Rail	1		●				
70	132.046	1296 312 042	Cylinder	1		●				
71	139.331	0750 112 034	Cap Collar 25x38x14,2	1		●				
72	189.421	1296 312 053	Piston	1		●				
73	139.912	0750 112 089	Ring 53x63x16,2	1		●				

ECOSPLIT II
16S160/A

Date

09/2014

Notes

MODELS:

- ECOSPLIT I-II

VERSIONS:

- 16S160/A (1297 xxx xxx)

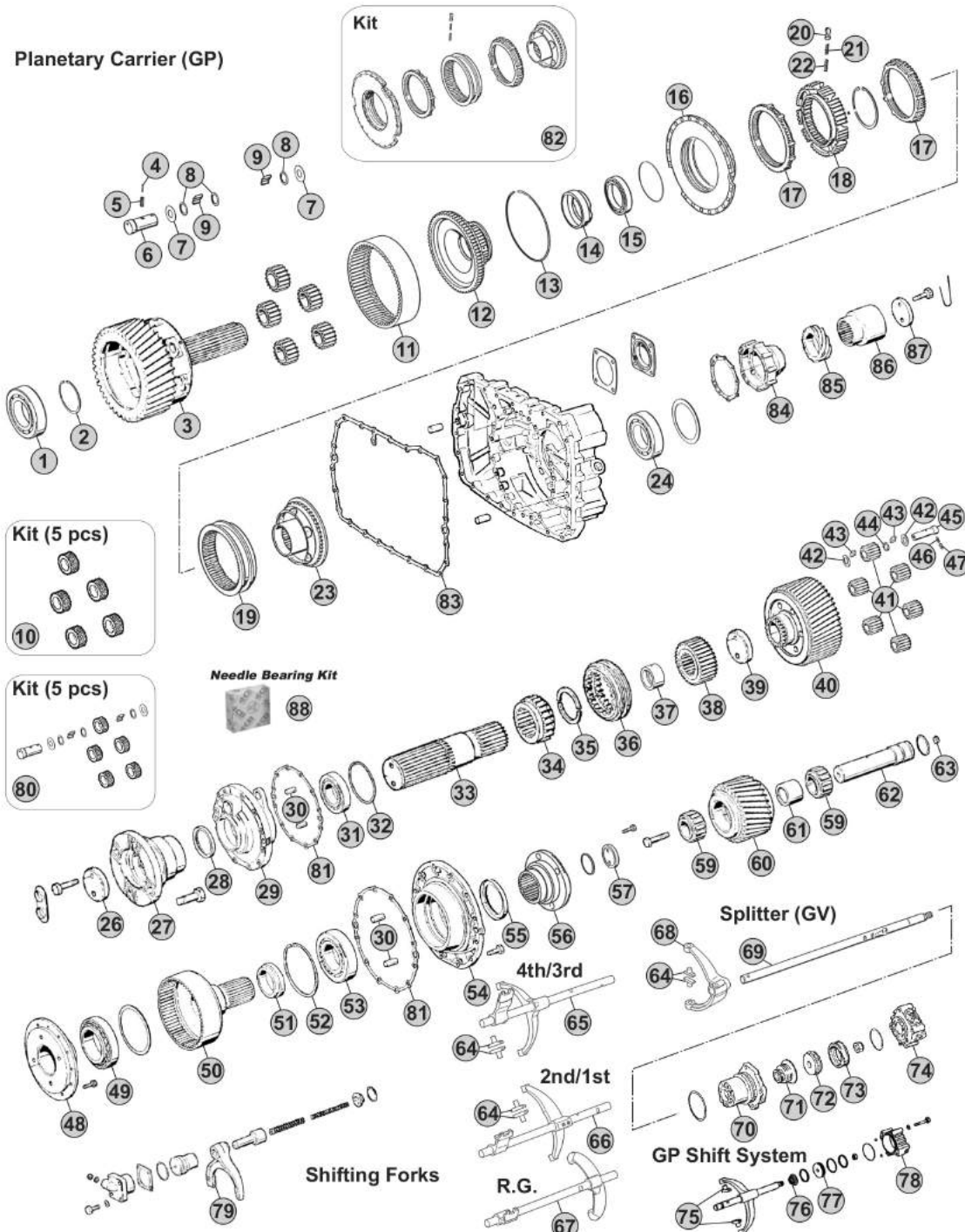

Notes

- (A) R. 11,74-0,87
- (B) R. 14,01-1,02
- (C) R. 17,47-1,02

Our spare parts are not the originals but interchangeable with the originals ones. All original equipment manufacturers' numbers, pictures and models used in this catalogue are for reference only. Our products bear our trade-mark.

Fig.	CEI no.	ZF no.	Description	Q.ty	Notes	16S160/A			
74	132.084	0750 132 032	Cylinder	1		●			
74	280.350	0750 132 033	Cylinder	1		●			
75	141.085	1296 334 004	Bronze Slide	2		●			
76	139.331	0750 112 034	Cap Collar 25x38x14,2	1		●			
77	189.422	1296 334 039	Piston	1		●			
78	132.047	1295 334 075	Cylinder	1		●			
79		1297 339 021	Fork	1		●			
80	198.704	1297 298 912	Planetary Gear Set (5 pcs)	1	AB	●			
80	298.807	1297 298 919	Planetary Gear Set	1	C	●			
81	239.006	1313 339 002	Gasket	2		●			
82	198.748	1295 298 939	Synchronizer kit	1	W/"Old Type" synchro rings	●			
83	239.005	0501 311 961	Gasket	1		●			
84	128.352	1297 301 023	Cover	1		●			
85	126.029	1297 338 001	Speedometer gear	1		●			
86	117.506	1297 332 039	Bush	1		●			
87	188.077	1295 332 051	Stop Washer	1		●			
88	298.425	1295 298 947	Needle Cages Kit	1		●			

ECOSPLIT-II
16S160/A

Date 09/2014 Notes _____

