

MODELS:

- ECOSPLIT I-II

VERSIONS:

- 16S190/1 (1297 xxx xxx)

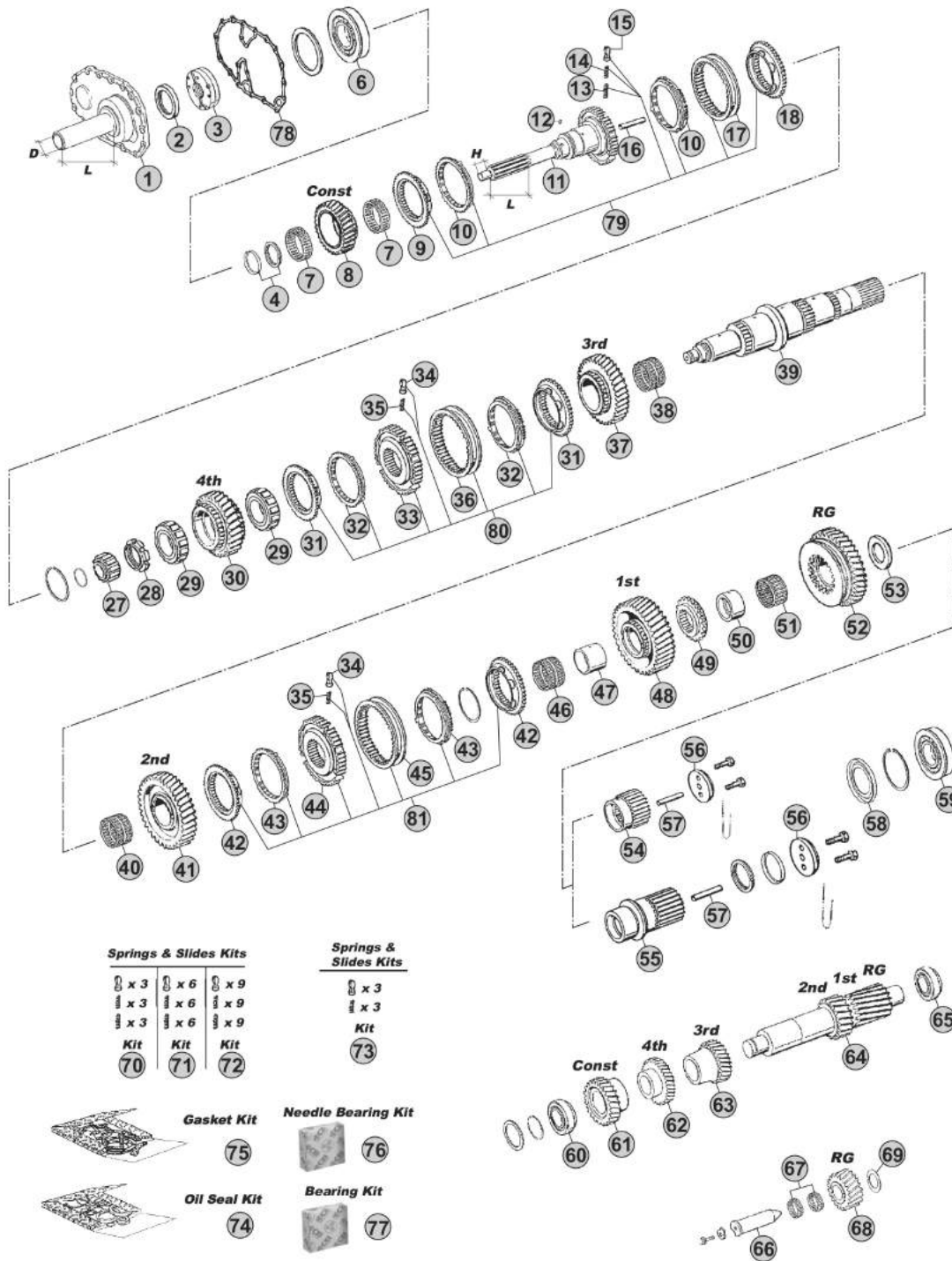

Our spare parts are not the originals but interchangeable with the originals ones. All original equipment manufacturers' numbers, pictures and models used in this catalogue are for reference only. Our products bear our trade-mark.

Notes

(C) R. 13,68-1,00

(E) R. 17,06-1,00

Our spare parts are not the originals but interchangeable with the originals ones. All original equipment manufacturers' numbers, pictures and models used in this catalogue are for reference only. Our products bear our trade-mark.

Fig.	CEI no.	ZF no.	Description	Q.ty	Notes	16S190/1			
1	128.338	1297 302 025	Front Cover	1	L=205 - H=68	●			
1	128.351	1297 302 043	Front Cover	1	L=170 - H=62,61	●			
2	139.879	0734 310 387	Oil Seal 55x75x8	1		●			
3	280.348	1295 202 041	Oil Pump	1		●			
4	298.400	1499 298 003	Washers Kit Th. 4,00mm	1		●			
4	298.401	1499 298 002	Washers Kit Th. 3,90mm	1		●			
4	298.402	1499 298 001	Washers Kit Th. 3,80mm	1		●			
6	130.305	0750 118 131	Bearing 80x150x27,50	1		●			
7	137.153	0735 320 896	Needle Cage 88x96x29	2		●			
8	145.406	1297 302 176	Constant Gear 28 T	1	C	●			
8	145.407	1297 302 241	Constant Gear 26 T	1	E	●			
9	109.072	1295 304 278	Synchronizer Cone	1		●			
10	119.084	1295 304 004	Synchronizer Ring	2	Old Type	●			
10	119.175	1304 304 686	Synchronizer Ring	2	New Type	●			
11	102.236	1297 202 009	Input Shaft	1	L=126 H=32	●			
11	102.540	1297 202 054	Input Shaft	1		●			
11	102.541	1297 202 003	Input Shaft	1		●			
12	171.084	0635 470 012	Needle D.7x7	1		●			
13	156.037	0732 040 385	Outer Spring De.6x34	3		●			
14	156.036	0732 040 386	Inner Spring De.3x34	3		●			
15	160.116	1240 304 278	Pressure Piece	3		●			
16	188.211	0730 062 323	Oil Plug	1		●			
17	154.097	1295 304 002	Sliding Sleeve	1		●			
18	109.072	1295 304 278	Synchronizer Cone	1		●			
27	137.113	0750 118 038	Roller Cage 35x68x27,50	1		●			
28	187.412	0737 502 092	Grooved Nut M60x1,5	1		●			
29	137.157	0750 118 220	Roller Cage D.63x97,5x37,50	2		●			
30	146.318	1297 304 260	Gear 4th Speed 30 T	1	C	●			
30	146.294	1297 304 413	Gear 4th Speed 29 T	1	E	●			
31	109.114	1297 304 369	Synchronizer Cone	2		●			
32	119.119	1297 304 402	Synchronizer Ring	2	Old Type	●			
32	119.167	1297 304 484	Synchronizer Ring	2	New Type	●			
33	157.140	1297 304 446	Synchronizer Hub	1		●			
34	160.189	1297 304 436	Pressure Piece	3	2x3 pcs.	●			
35	156.140	0732 040 409	Spring De.6,5x23,50	3	2x3 pcs.	●			
36	154.135	1310 304 202	Sliding Sleeve	1		●			
37	145.450	1297 304 261	Gear 3rd Speed 34 T	1	C	●			
37	145.377	1297 304 414	Gear 3rd Speed 34 T	1	E	●			
38	137.112	0735 320 451	Needle Cage 82x90x60	1		●			
39	103.132	1297 304 181	Main Shaft	1	C	●			
39	103.098	1297 304 193	Main Shaft	1	E	●			
40	137.109	0735 320 452	Needle Cage 82x90x55	1		●			
41	145.375	1297 304 442	Gear 2nd Speed 38 T	1		●			

ECOSPLIT II
16S190/1

Date

09/2014

Notes

MODELS:

- ECOSPLIT I-II

VERSIONS:

- 16S190/1 (1297 xxx xxx)

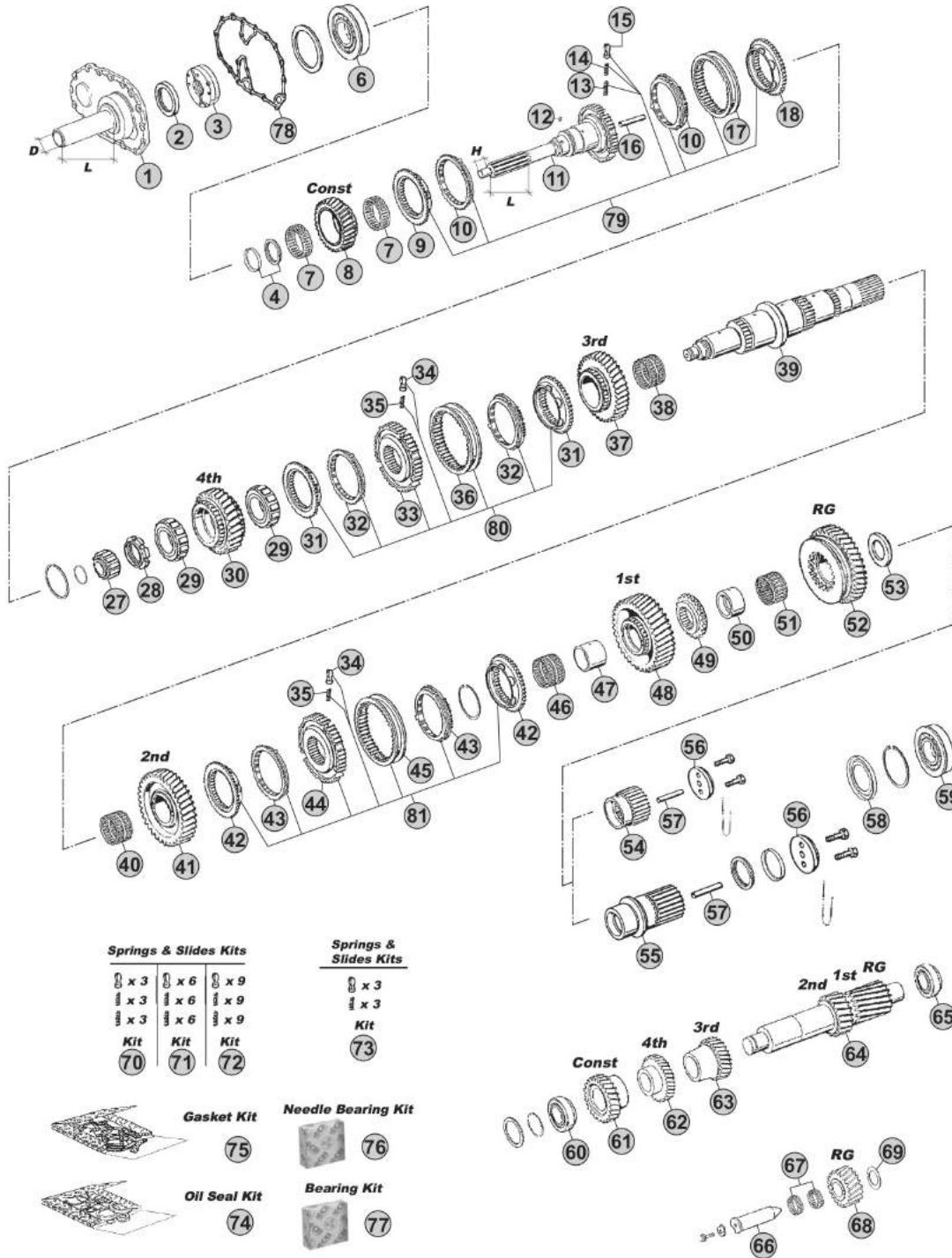

Notes

(C) R. 13,68-1,00

(E) R. 17,06-1,00

Our spare parts are not the originals but interchangeable with the originals ones. All original equipment manufacturers' numbers, pictures and models used in this catalogue are for reference only. Our products bear our trade-mark.

Our spare parts are not the originals but interchangeable with the originals ones. All original equipment manufacturers' numbers, pictures and models used in this catalogue are for reference only. Our products bear our trade-mark.

Fig.	CEI no.	ZF no.	Description	Q.ty	Notes	165190/1				
42	109.113	1297 304 371	Synchronizer cone	2		●				
43	119.122	1297 304 401	Synchronizer Ring	2	Old Type	●				
43	119.166	1297 304 485	Synchronizer Ring	2	New Type	●				
44	157.139	1297 304 445	Synchronizer Hub	1		●				
45	154.136	1297 304 450	Sliding Sleeve	1		●				
46	137.110	0735 320 487	Needle Cage 82x90x68	1		●				
47	117.246	1297 304 035	Bush	1		●				
48	145.376	1297 304 441	Gear 1st Speed 47 T	1		●				
49	109.178	1297 304 154	Synchronizer Cone	1		●				
50	117.318	1297 304 034	Bush	1	C	●				
51	137.111	0735 320 486	Needle Cage 78x86x44	1		●				
52	147.140	1297 304 148	Reverse Gear 38 T	1		●				
53	169.757	1297 304 381	Thrust Washer	1	C	●				
54	157.177	1297 304 187	Sun Gear 27 T	1	C	●				
55	157.198	1297 304 439	Sun Gear 24 T	1	E	●				
56	188.076	1272 304 021	Stop Washer	1		●				
57	189.671	0730 061 842	Oil Tube	1		●				
58	139.923	1297 301 004	Oil Collector	1		●				
59	130.702	0750 118 006	Bearing 65x140x33	1	C	●				
59	130.703	0750 118 471	Bearing 80x140x33	1	E	●				
60	130.242	0750 117 010	Bearing 50,80x100x35	1		●				
61	146.322	1297 303 066	Constant Gear 34 T	1	C	●				
61	146.321	1297 303 086	Constant Gear 35 T	1	E	●				
62	146.381	1297 303 065	Gear 4th Speed 31 T	1	C	●				
62	146.416	1297 303 123	Gear 4th Speed 32 T	1	E	●				
63	146.421	1297 303 067	Gear 3rd Speed 25 T	1	C	●				
63	146.422	1297 303 132	Gear 3rd Speed 26 T	1	E	●				
64	105.093	1297 303 140	Countershaft 17/20 T	1		●				
65	130.308	0750 117 009	Bearing 49,2x103,1x43,6	1		●				
66	107.108	1295 305 056	Reverse Gear Pin	1		●				
67	137.007	0750 115 011	Needle Cage 45x53x21	2		●				
68	147.094	1295 305 052	Reverse Gear 24 T	1		●				
69	169.234	0730 150 064	Thrust Washer	1		●				
70	198.339	1268 298 938	Spring Slide kit	1		●				
71	198.564		Spring Slide kit	1		●				
72	198.842	1295 298 933	Spring Slide kit	1		●				
73	198.843		Spring Slide kit	1		●				
74	198.428	1295 298 960	Oil Seal Ring Kit	1		●				
75	198.427	1295 298 915	Gasket Kit	1		●				
76	298.425	1295 298 947	Needle Cages Kit	1		●				
77	298.426	1295 298 943	Bearing kit	1		●				
78	139.686	1313 302 014	Gasket	1		●				
79	198.724	1295 298 936	Synchro Kit	1	W/"Old Type" synchro rings	●				

 ECOSPLIT-II
16S190/1

Date

09/2014

Notes

MODELS:

- ECOSPLIT I-II

VERSIONS:

- 16S190/1 (1297 xxx xxx)

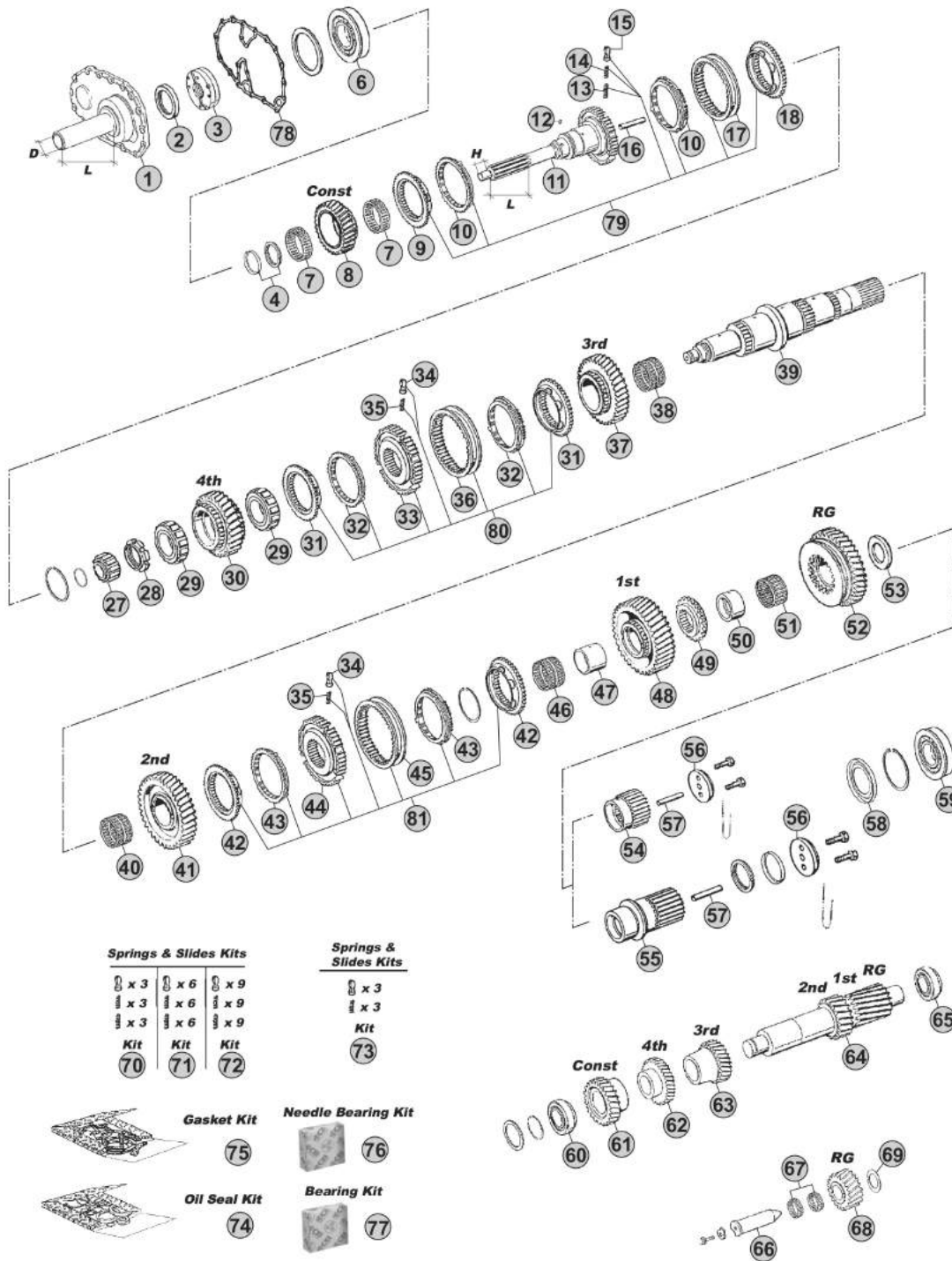

Our spare parts are not the originals but interchangeable with the originals ones. All original equipment manufacturers' numbers, pictures and models used in this catalogue are for reference only. Our products bear our trade-mark.

Notes

(C) R. 13,68-1,00

(E) R. 17,06-1,00

MODELS:

- ECOSPLIT I-II

VERSIONS:

- 16S190/1 (1297 xxx xxx)

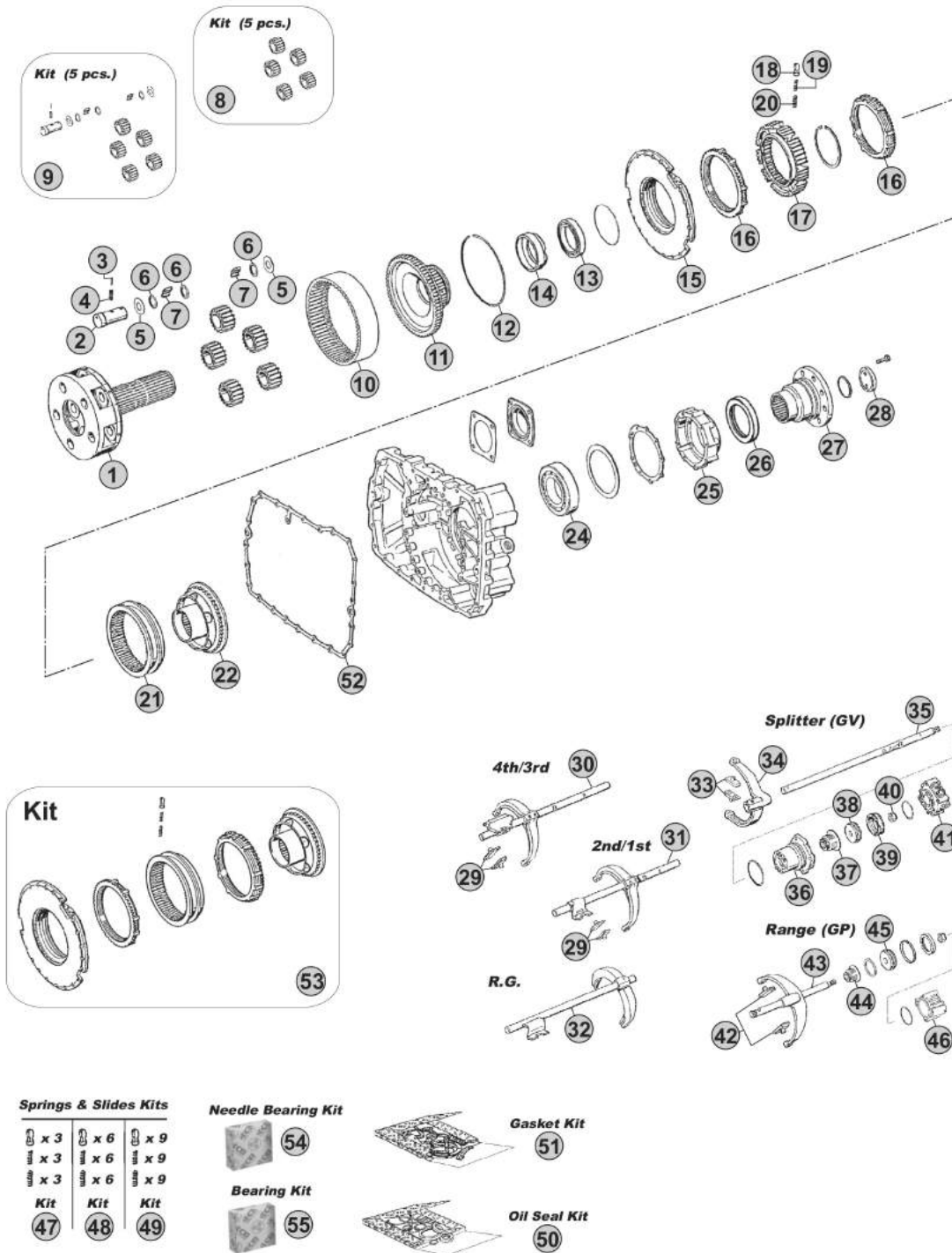

Notes

(C) R. 13,68-1,00
 (E) R. 17,06-1,00

Our spare parts are not the originals but interchangeable with the originals ones. All original equipment manufacturers' numbers, pictures and models used in this catalogue are for reference only. Our products bear our trade-mark.

Our spare parts are not the originals but interchangeable with the originals ones. All original equipment manufacturers' numbers, pictures and models used in this catalogue are for reference only. Our products bear our trade-mark.

Fig.	CEI no.	ZF no.	Description	Q.ty	Notes	165190/1				
1	190.396	1297 232 039	Planetary Carrier	1	C	●				
1	190.395	1297 232 045	Planetary Carrier	1	E	●				
1	190.556	1316 232 005	Planetary Carrier	1	(10) E	●				
2	107.163	1297 332 109	Planet pin	5		●				
2	107.165	1312 332 026	Planetary Pin	5	(10)	●				
3	160.191	0631 329 017	Lock Pin 3x24	5		●				
3	160.195	0631 329 167	Lock Pin 3x26	5	(10)	●				
4	160.192	0631 329 050	Lock Pin 5x24	5		●				
4	160.194	0631 329 051	Lock Pin 5x26	5	(10)	●				
5	169.753	0501 306 212	Thrust Washer 29x64x1,5	10		●				
5	169.759	0501 308 981	Thrust Washer	10	(10)	●				
6	169.410	0730 103 846	Spacer Ring 29x39x1,00	15		●				
6	169.744	0730 107 168	Spacer Ring	15	(10)	●				
7	171.045	0750 119 143	Needle 10x16,80 (120 pcs)	120		●				
7	171.062	0750 119 116	Needle 10x16,80 (140 pcs)	140	(10)	●				
8	198.803	1297 232 023	Planetary Gear Set (5 pcs)	1	C	●				
8	198.810	1297 232 024	Planetary Gear Set (5 pcs)	1	E	●				
8	198.801	1312 232 014	Planetary Gear Set (5 pcs)	1	(10) E	●				
9	198.704	1297 298 912	Planetary Gear Set (5 pcs)	1	C	●				
9	298.807	1297 298 919	Planetary Gear Set	1	E	●				
10	123.217	1297 332 080	Crown Gear 83 T	1	C	●				
10	123.208	1295 332 086	Crown Gear 86 T	1	E	●				
11	150.138	1297 332 017	Carrier Hub 83 T	1	C	●				
11	150.137	1297 332 035	Carrier Hub 86 T	1	E	●				
11	150.134	1297 332 120	Carrier Hub 86 T	1	(10) E	●				
12	111.129	0730 505 055	Locking Wire	1	C	●				
12	111.198	0730 505 056	Locking Wire	1	E	●				
13	130.310	0750 116 165	Bearing 80x110x16	1		●				
13	130.311	0635 338 035	Bearing 100x125x13	1	(10)	●				
14	119.255	1297 332 122	Intermediate Ring	1		●				
15	198.358	1296 233 006	Synchro Cone	1		●				
16	119.085	1296 333 022	Synchronizer Ring	2	Old Type	●				
16	119.172	1296 333 045	Synchronizer Ring	2	New Type	●				
17	157.113	1296 333 002	Synchronizer Hub	1		●				
17	157.183	1297 333 115	Synchronizer Hub	1	(10)	●				
18	160.116	1240 304 278	Pressure Piece	9		●				
19	156.036	0732 040 386	Inner Spring De.3x34	9		●				
20	156.037	0732 040 385	Outer Spring De.6x34	9		●				
21	154.098	1296 333 023	Sliding Sleeve	1		●				
22	198.374	1313 233 001	Synchronizer Cone (38 Spl.)	1		●				
22	198.790	1297 233 056	Synchronizer Cone (41 spl.)	1	(10)	●				
24	130.245	0750 116 394	Bearing 90x160x30	1		●				
25	128.260	1296 301 067	Cover	1		●				

 ECOSPLIT-II
16S190/1

Date

09/2014

Notes

(10) New reinforce style. Use item marked (5) together

MODELS:

- ECOSPLIT I-II

VERSIONS:

- 16S190/1 (1297 xxx xxx)

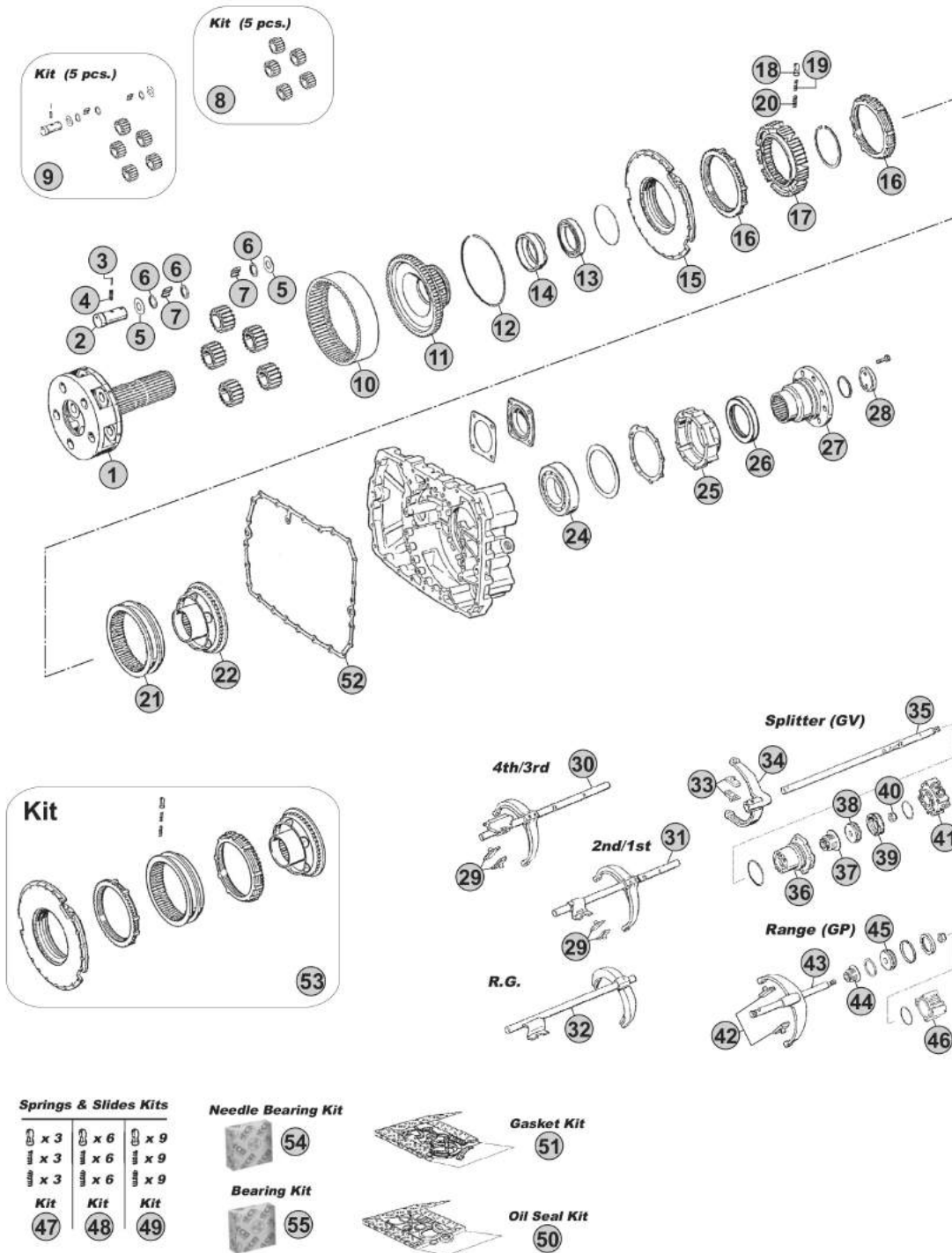

Notes

(C) R. 13,68-1,00

(E) R. 17,06-1,00

Our spare parts are not the originals but interchangeable with the originals ones. All original equipment manufacturers' numbers, pictures and models used in this catalogue are for reference only. Our products bear our trade-mark.

Fig.	CEI no.	ZF no.	Description	Q.ty	Notes	16S190/1				
25	128.098	1315 301 220	Cover	1	(10)	●				
26	139.878	0750 111 341	Oil Seal 105x130x12	1		●				
27	197.167	1297 338 041	Output Flange D.180 mm	1	D.180-4 H.	●				
27	197.254	1297 333 110	Output Flange D.180 mm	1	(10) D.180-4 H.	●				
28	188.077	1295 332 051	Stop Washer	1		●				
28	188.121	1312 332 028	Stop Washer	1	(10)	●				
29	141.163	1297 306 120	Slide	2	2x2 pcs.	●				
30	298.813	1297 206 103	Complete Fork	1		●				
31	298.819	1297 206 106	Complete Fork	1		●				
32	298.824	1297 206 174	Complete Fork	1		●				
33	141.068	1295 306 132	Bronze Slide	2		●				
34	141.086	1313 312 002	Shift Yoke	1		●				
35	149.268	1297 312 008	Selector Rod	1		●				
36	132.046	1296 312 042	Cylinder	1		●				
37	139.331	0750 112 034	Cap Collar 25x38x14,2	1		●				
38	189.421	1296 312 053	Piston	1		●				
39	139.912	0750 112 089	Ring 53x63x16,2	1		●				
40	287.091	0737 300 037	Nut	1		●				
41	132.084	0750 132 032	Cylinder	1		●				
41	280.350	0750 132 033	Cylinder	1		●				
42	141.085	1296 334 004	Bronze Slide	2		●				
43	149.171	1312 234 002	Fork	1		●				
44	139.331	0750 112 034	Cap Collar 25x38x14,2	1		●				
45	189.422	1296 334 039	Piston	1		●				
45	188.278	1297 334 056	Piston	1	(10)	●				
46	132.047	1295 334 075	Cylinder	1		●				
46	132.036	1297 334 055	Cylinder	1	(10)	●				
47	198.339	1268 298 938	Spring Slide kit	1		●				
48	198.564		Spring Slide kit	1		●				
49	198.842	1295 298 933	Spring Slide kit	1		●				
50	198.428	1295 298 960	Oil Seal Ring Kit	1		●				
51	198.427	1295 298 915	Gasket Kit	1		●				
52	139.685	1313 301 037	Gasket	1		●				
53	198.748	1295 298 939	Synchronizer kit	1	W/"Old Type" synchro rings	●				
53	298.113		Repair kit	1	(10)	●				
54	298.425	1295 298 947	Needle Cages Kit	1		●				
55	298.426	1295 298 943	Bearing kit	1		●				

ECOSPLIT I-II
16S190/1

Date
09/2014

Notes
(10) New reinforce style. Use item marked (5) together

