

MODELS:

- ECOSPLIT I-II

VERSIONS:

- 16S220A (1312 xxx xxx)

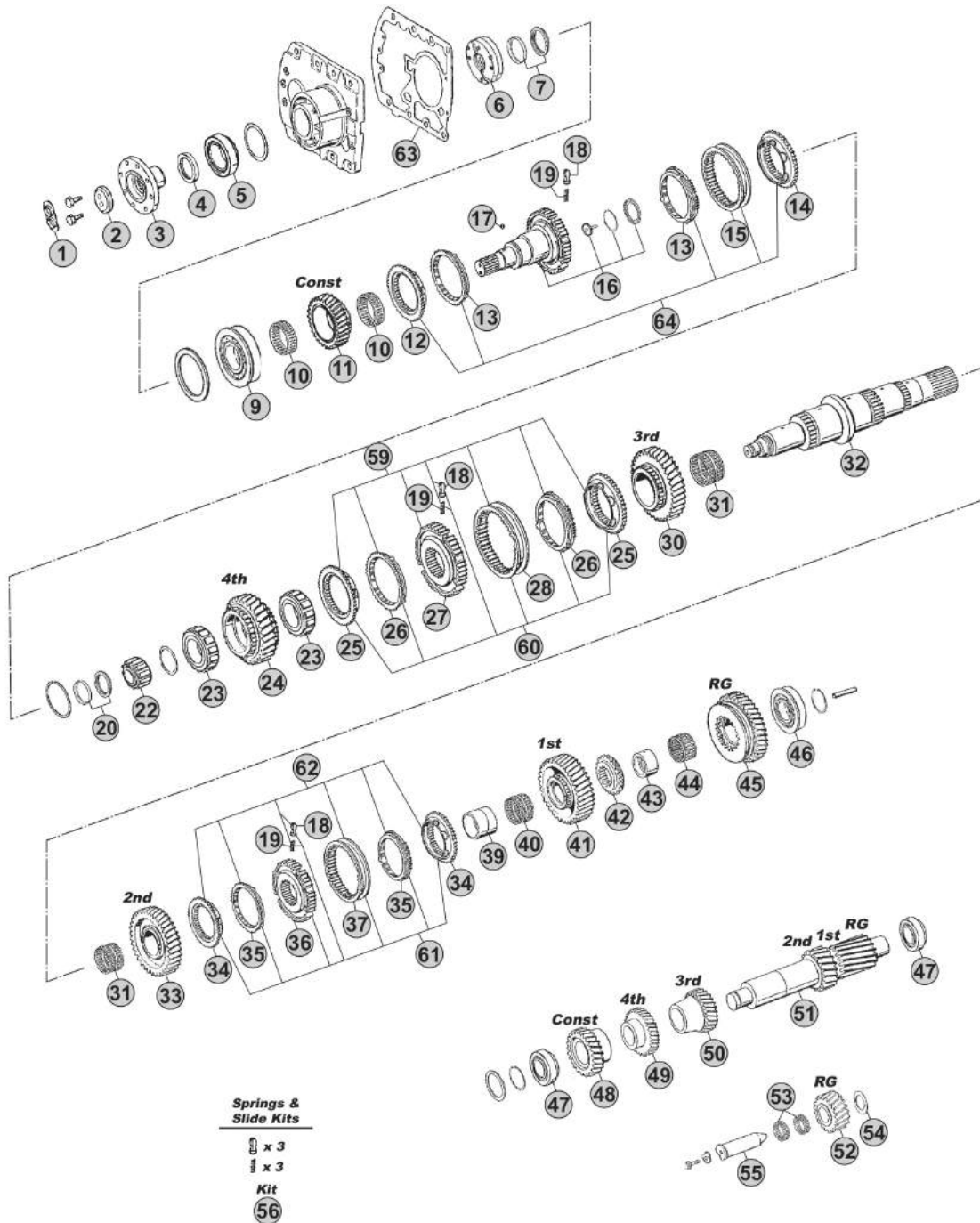

Our spare parts are not the originals but interchangeable with the originals ones. All original equipment manufacturers' numbers, pictures and models used in this catalogue are for reference only. Our products bear our trade-mark.

Notes

- (A) R. 14,14-0,86
- (B) R. 16,87-1,02

Our spare parts are not the originals but interchangeable with the originals ones. All original equipment manufacturers' numbers, pictures and models used in this catalogue are for reference only. Our products bear our trade-mark.

Fig.	CEI no.	ZF no.	Description	Q.ty	Notes	16S220A			
1	188.274	1269 302 164	Stop Washer	1		●			
2	188.078	1269 302 065	Stop Washer	1		●			
3	155.329	1312 304 152	Input Flange	1		●			
4	139.675	0734 319 276	Oil Seal 75X105X14	1		●			
5	130.686	0750 117 312	Roller Bearing 50,8x104,7x30,1	1		●			
6	280.348	1295 202 041	Oil Pump	1		●			
7	298.408	1499 298 136	Shims Kit Th. 4,35mm	1		●			
7	298.409	1499 298 135	Shims Kit Th. 4,30mm	1		●			
7	298.410	1499 298 134	Shims Kit Th. 4,25mm	1		●			
7	298.411	1499 298 133	Shims Kit Th. 4,20mm	1		●			
7	298.412	1499 298 132	Shims Kit Th. 4,15mm	1		●			
7	298.413	1499 298 131	Shims Kit Th. 4,10mm	1		●			
7	298.419	1499 298 130	Shims Kit Th. 4,05mm	1		●			
7	298.420	1499 298 129	Shims Kit Th.4,00 mm	1		●			
7	298.421	1499 298 128	Shims Kit Th.3,95 mm	1		●			
7	298.422	1499 298 127	Shims Kit Th.3,90 mm	1		●			
7	298.423	1499 298 126	Shims Kit Th.3,85 mm	1		●			
7	298.424	1499 298 125	Shims Kit Th.3,80 mm	1		●			
9	130.306	0750 117 431	Bearing 75x150x30,50	1		●			
10	137.134	0735 320 950	Needle Cage 93x101x32,50	2		●			
11	145.491	1312 302 073	Constant Gear 34 T	1	A	●			
11	145.490	1312 302 074	Constant Gear 30 T	1	B	●			
12	109.134	1312 304 027	Synchronizer Cone	1		●			
13	119.119	1297 304 402	Synchronizer Ring	2	Old Type	●			
13	119.167	1297 304 484	Synchronizer Ring	2	New Type	●			
14	109.133	1312 304 056	Synchronizer Cone	1		●			
15	154.135	1310 304 202	Sliding Sleeve	1		●			
16	190.559	1312 202 041	Input Shaft	1		●			
17	171.084	0635 470 012	Needle D.7x7	1		●			
18	160.189	1297 304 436	Pressure Piece	3	3x3 pcs.	●			
19	156.140	0732 040 409	Spring De.6,5x23,50	3	3x3 pcs.	●			
20	298.392	1499 298 027	Shims Kit Th=5,00mm	1		●			
20	298.393	1499 298 026	Shims Kit Th=4,90mm	1		●			
20	298.394	1499 298 025	Shims Kit Th=4,80mm	1		●			
20	298.395	1499 298 024	Shims Kit Th=4,70mm	1		●			
20	298.396	1499 298 023	Shims Kit Th=4,60mm	1		●			
22	137.150	0750 117 232	Roller Bearing 42x40,30	1		●			
23	130.825	0750 118 258	Roller Cage 67x101x38	2		●			
24	146.425	1312 304 032	Gear 4th Speed 30 T	1	A	●			
24	146.317	1312 304 031	Gear 4th Speed 34 T	1	B	●			
25	109.134	1312 304 027	Synchronizer Cone	2	(20)	●			
25	109.385	1316 304 159	Synchronizer Cone	2	(21)	●			
25	109.839	1316 304 190	Synchronizer Cone	2	(22)	●			

ECOSPLIT I-II
16S220A

Date

09/2014

Notes

(20) Only for 3rd/4th Speed - First version - Do not mix
(21) Only for 3rd/4th Speed - Second version - Do not mix

MODELS:

- ECOSPLIT I-II

VERSIONS:

- 16S220A (1312 xxx xxx)

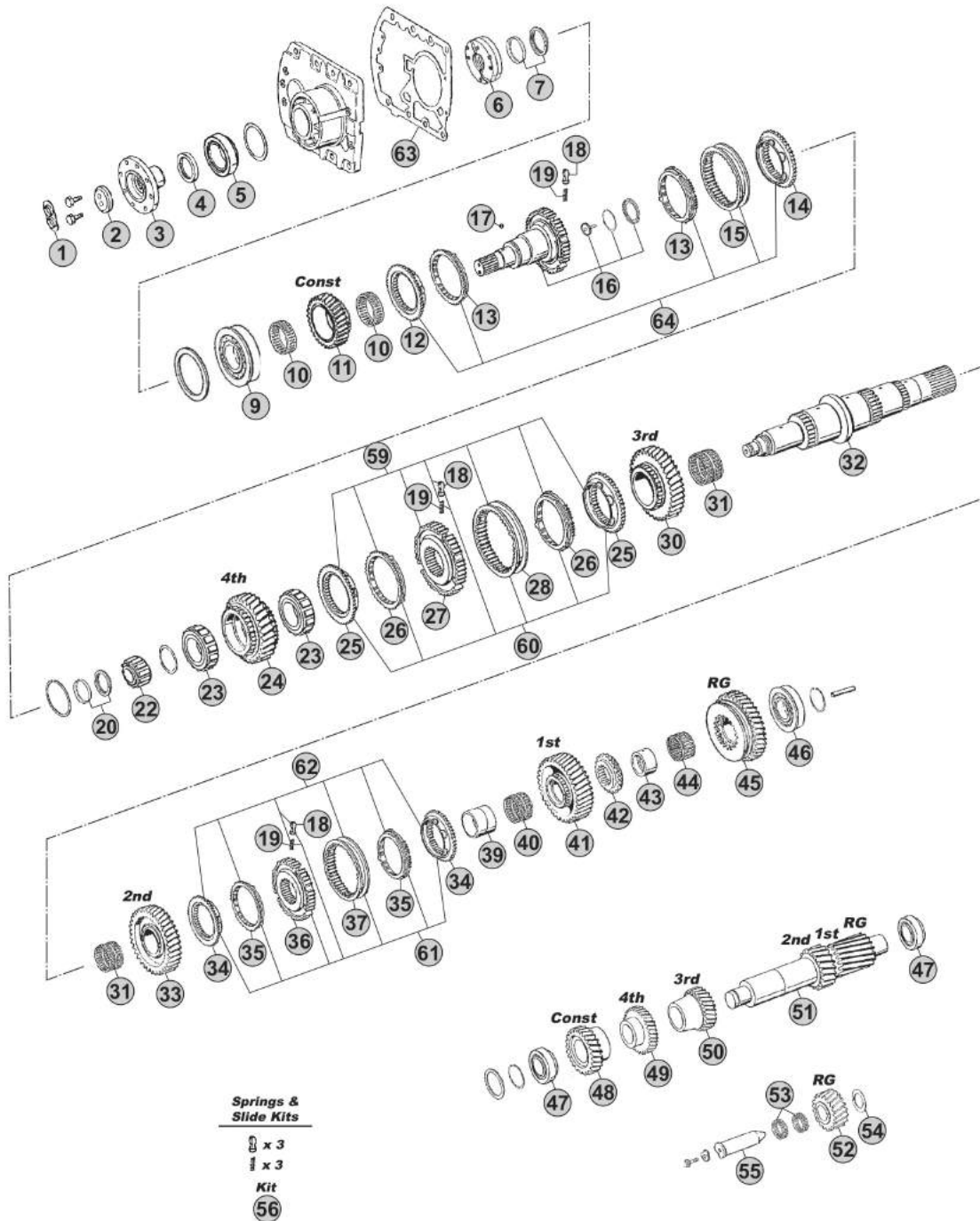

Our spare parts are not the originals but interchangeable with the originals ones. All original equipment manufacturers' numbers, pictures and models used in this catalogue are for reference only. Our products bear our trade-mark.

Notes

- (A) R. 14,14-0,86
- (B) R. 16,87-1,02

Our spare parts are not the originals but interchangeable with the originals ones. All original equipment manufacturers' numbers, pictures and models used in this catalogue are for reference only. Our products bear our trade-mark.

Fig.	CEI no.	ZF no.	Description	Q.ty	Notes	16S220A				
25	109.208	1356 304 025	Synchronizer Cone	2	(23)	●				
26	119.119	1297 304 402	Synchronizer Ring	2	(20) Old Type	●				
26	119.167	1297 304 484	Synchronizer Ring	2	(20) New Type	●				
26	119.217	1316 304 168	Synchronizer Ring	2	(21)	●				
26	119.308	1316 304 189	Synchronizer Ring	2	(22)	●				
26	119.327	1316 304 196	Synchronizer Ring	2	(23)	●				
27	157.180	1312 304 052	Synchronizer Hub	1	(20)	●				
27	157.227	1316 304 162	Synchronizer Hub	1	(21)	●				
27	155.291	1356 304 019	Synchronizer Hub	1	(22-23)	●				
28	154.135	1310 304 202	Sliding Sleeve	1	(20)	●				
28	154.357	1316 304 167	Sliding Sleeve	1	(21)	●				
28	154.482	1356 304 023	Sliding Sleeve	1	(22-23)	●				
30	145.498	1312 304 137	Gear 3rd Speed 32 T	1	A	●				
30	145.497	1312 304 136	Gear 3rd Speed 34 T	1	B	●				
31	137.138	0750 115 303	Needle Cage 92x100x63	2		●				
32	103.316	1312 304 133	Main Shaft	1		●				
33	145.504	1312 304 141	Gear 2nd Speed 37 T	1	A	●				
33	145.503	1312 304 139	Gear 2nd Speed 38 T	1	B	●				
34	109.132	1313 304 009	Synchronizer Cone	2	(31)	●				
34	109.386	1316 304 156	Synchronizer Cone	2	(32-33)	●				
34	109.824	1356 304 026	Synchronizer Cone	2	(34)	●				
35	119.122	1297 304 401	Synchronizer Ring	2	(31) Old Type	●				
35	119.166	1297 304 485	Synchronizer Ring	2	(31) New Type	●				
35	119.218	1316 304 170	Synchronizer Ring	2	(32-33)	●				
35	119.302	1316 304 173	Synchronizer Ring	2	(34)	●				
36	157.189	1313 304 008	Synchronizer Hub	1	(31)	●				
36	157.228	1316 304 163	Synchronizer Hub	1	(32)	●				
36	155.290	1356 304 022	Synchronizer Hub	1	(33-34)	●				
37	154.202	1316 304 078	Sliding Sleeve	1	(31)	●				
37	154.358	1316 304 169	Sliding Sleeve	1	(32)	●				
37	154.456	1356 304 024	Sliding Sleeve	1	(33-34)	●				
39	117.310	1312 304 084	Bush 85x96x72	1		●				
40	137.151	0750 115 327	Needle Cage 96x104x72	1		●				
41	145.509	1312 304 086	Gear 1st Speed 44 T	1	A	●				
41	145.510	1312 304 085	Gear 1st Speed 47 T	1	B	●				
42	109.181	1312 304 083	Synchronizer cone	1		●				
43	117.311	1316 304 133	Bush 80x90x50	1		●				
44	137.140	0750 115 326	Roller Cage 90x98x50	1		●				
45	147.141	1312 304 088	Reverse Gear 39 T	1	A	●				
45	147.139	1312 304 087	Reverse Gear 38 T	1	B	●				
46	130.304	0750 117 678	Bearing 80x140x36,50	1		●				
47	130.308	0750 117 009	Bearing 49,2x103,1x43,6	2		●				
48	146.411	1312 303 006	Constant Gear 37 T	1	A	●				

Date

09/2014

Notes

(22) Only for 3rd/4th Speed - Latest type - Do not mix
 (23) Only for 3rd/4th Speed - Latest type - Do not mix - Carbon version
 (20) Only for 3rd/4th Speed - First version - Do not mix
 (21) Only for 3rd/4th Speed - Second version - Do not mix
 (31) Only for 1st/2nd speed - First version (single cone) - Do not mix

(32) Only for 1st/2nd speed - Second version (Single cone) - Do not mix
 (33) Only for 1st/2nd speed - Latest type (single cone) - Do not mix
 (34) Only for 1st/2nd speed - Latest type (single cone) - Do not mix - Carbon version

MODELS:

- ECOSPLIT I-II

VERSIONS:

- 16S220A (1312 xxx xxx)

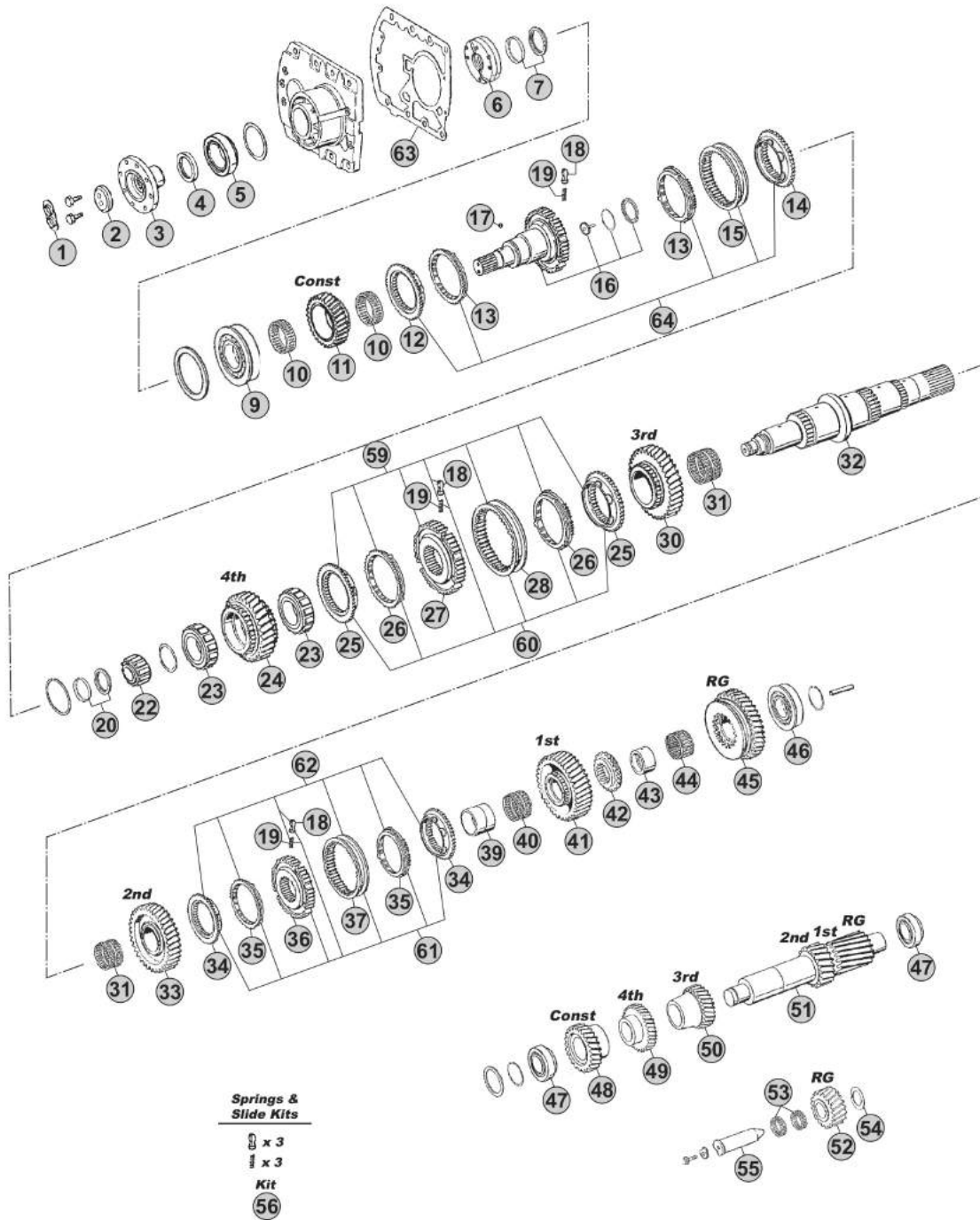

Our spare parts are not the originals but interchangeable with the originals ones. All original equipment manufacturers' numbers, pictures and models used in this catalogue are for reference only. Our products bear our trade-mark.

Notes

- (A) R. 14,14-0,86
- (B) R. 16,87-1,02

MODELS:

- ECOSPLIT I-II

VERSIONS:

- 16S220A (1312 xxx xxx)

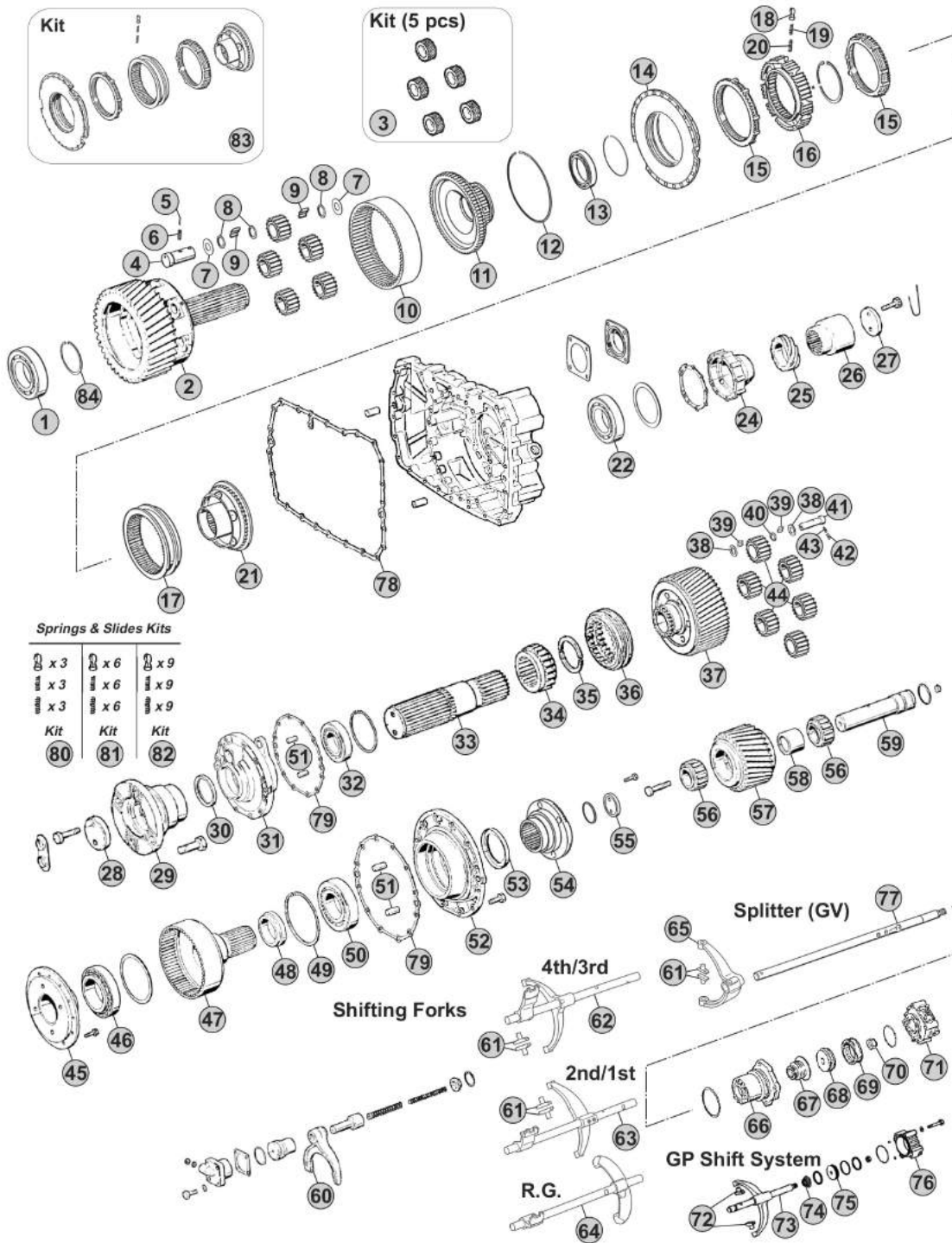

Springs & Slides Kits

x3	x6	x9
x3	x6	x9
x3	x6	x9
Kit 80	Kit 81	Kit 82

Notes

- (A) R. 14,14-0,86
- (B) R. 16,87-1,02

Our spare parts are not the originals but interchangeable with the originals ones. All original equipment manufacturers' numbers, pictures and models used in this catalogue are for reference only. Our products bear our trade-mark.

Fig.	CEI no.	ZF no.	Description	Q.ty	Notes	16S220A				
1	130.433	0735 410 110	Bearing 110x200x38	1		●				
2	190.560	1312 232 025	Planetary Carrier	1		●				
3	198.801	1312 232 014	Planetary Gear Set (5 pcs)	1		●				
4	107.165	1312 332 026	Planetary Pin	5		●				
5	160.195	0631 329 167	Lock Pin 3x26	5		●				
6	160.194	0631 329 051	Lock Pin 5x26	5		●				
7	169.759	0501 308 981	Thrust Washer	10		●				
8	169.744	0730 107 168	Spacer Ring	15		●				
9	171.062	0750 119 116	Needle 10x16,80 (140 pcs)	140		●				
10	123.208	1295 332 086	Crown Gear 86 T	1		●				
11	150.134	1297 332 120	Carrier Hub 86 T	1		●				
12	111.198	0730 505 056	Locking Wire	1		●				
13	130.311	0635 338 035	Bearing 100x125x13	1		●				
14	198.358	1296 233 006	Synchro Cone	1		●				
15	119.085	1296 333 022	Synchronizer Ring	2	Old Type	●				
15	119.172	1296 333 045	Synchronizer Ring	2	New Type	●				
16	157.183	1297 333 115	Synchronizer Hub	1		●				
17	154.098	1296 333 023	Sliding Sleeve	1		●				
18	160.116	1240 304 278	Pressure Piece	9		●				
19	156.036	0732 040 386	Inner Spring De.3x34	9		●				
20	156.037	0732 040 385	Outer Spring De.6x34	9		●				
21	198.790	1297 233 056	Synchronizer Cone (41 spl.)	1		●				
22	130.245	0750 116 394	Bearing 90x160x30	1		●				
24	128.355	1312 301 037	Rear Cover	1		●				
25	117.507	1297 238 005	Bush	1		●				
26	117.508	1312 332 033	Bush	1		●				
27	188.121	1312 332 028	Stop Washer	1		●				
28	188.077	1295 332 051	Stop Washer	1		●				
29	197.167	1297 338 041	Output Flange D.180 mm	1		●				
30	139.975	0750 111 107	Oil Seal	1		●				
31	128.341	1297 339 030	Rear Cover	1		●				
32	130.245	0750 116 394	Bearing 90x160x30	1		●				
33	103.315	1297 339 028	Output Shaft	1		●				
34	155.328	1297 339 024	Fixed Hub	1		●				
35	269.814	1297 339 005	Shim	1		●				
36	154.514	1297 339 035	Sliding Sleeve	1		●				
37	190.558	1312 237 002	Planetary Carrier	1		●				
38	269.671	0730 002 088	Washer	10		●				
39	171.088	0635 490 013	Needle 3,5x17,8	300		●				
40	269.672	0730 104 292	Ring	5		●				
41	107.222	1297 337 009	Planetary pin	5		●				
42	160.315	0631 329 014	Lock Pin	5		●				
43	160.316	0631 329 046	Lock pin	5		●				

ECOSPLIT I-II
16S220A

Date

09/2014

Notes

MODELS:

- ECOSPLIT I-II

VERSIONS:

- 16S220A (1312 xxx xxx)

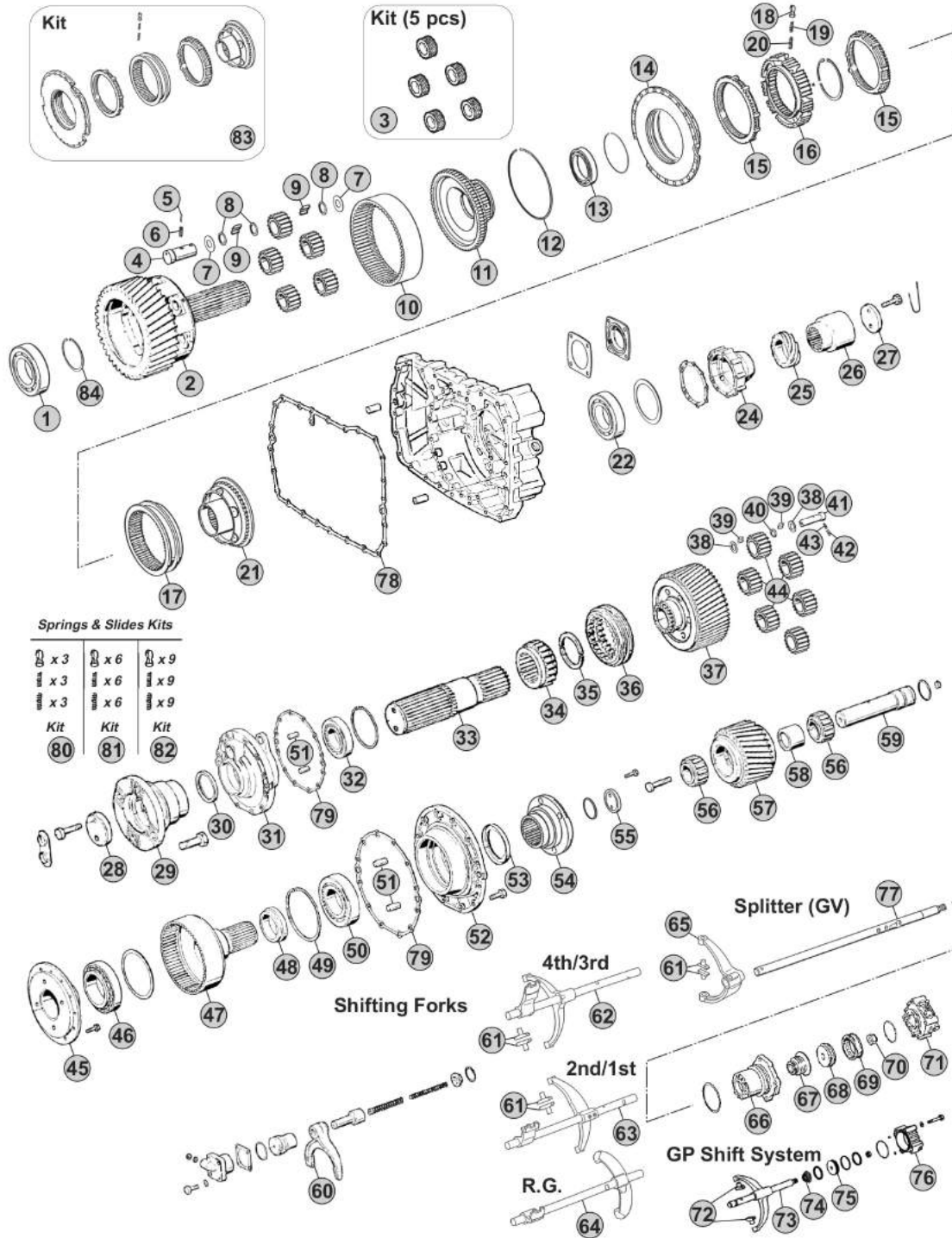

Notes

- (A) R. 14,14-0,86
- (B) R. 16,87-1,02

Our spare parts are not the originals but interchangeable with the originals ones. All original equipment manufacturers' numbers, pictures and models used in this catalogue are for reference only. Our products bear our trade-mark.

Fig.	CEI no.	ZF no.	Description	Q.ty	Notes	16S220A				
44	298.156	1297 237 005	Planetary Gear Set	1		●				
45	128.342	1297 337 017	Rear Cover	1		●				
46	130.434	0635 370 030	Bearing	2		●				
47	103.314	1297 338 048	Output Shaft	1		●				
48	269.818	1297 338 019	Thrust Ring	1		●				
49	111.441	0630 502 054	Retainer Ring	1		●				
50	130.245	0750 116 394	Bearing 90x160x30	1		●				
51	160.313	0631 306 776	Pin	2	2x2 pcs.	●				
52	128.343	1297 338 083	Cover	1		●				
53	139.975	0750 111 107	Oil Seal	1		●				
54	197.167	1297 338 041	Output Flange D.180 mm	1		●				
55	188.077	1295 332 051	Stop Washer	1		●				
56	137.016	0750 118 016	Needle Cage 55x106,5x43	2		●				
57	244.207	1312 336 001	Gear Low Speed	1		●				
58	117.505	1297 336 008	Bush	1		●				
59	160.317	1297 336 010	Pin	1		●				
60		1297 339 021	Fork	1		●				
61	141.163	1297 306 120	Slide	2	3x2 pcs.	●				
62		1312 206 046	Complete Fork	1		●				
63		1312 206 040	Complete Fork	1		●				
64		1312 206 033	Complete Fork	1		●				
65	141.086	1313 312 002	Shift Yoke	1		●				
66	132.046	1296 312 042	Cylinder	1		●				
67	139.331	0750 112 034	Cap Collar 25x38x14,2	1		●				
68	188.276	1312 312 003	Piston	1		●				
69	139.912	0750 112 089	Ring 53x63x16,2	1		●				
70	287.091	0737 300 037	Nut	1		●				
71	132.084	0750 132 032	Cylinder	1		●				
71	132.085	0750 132 033	Cylinder	1		●				
72	141.085	1296 334 004	Bronze Slide	2		●				
73	149.279	1297 234 021	Selector Rod	1		●				
74	139.331	0750 112 034	Cap Collar 25x38x14,2	1		●				
75	188.278	1297 334 056	Piston	1		●				
76	132.036	1297 334 055	Cylinder	1		●				
77		1312 312 008	Selector Rod	1		●				
78	239.005	0501 311 961	Gasket	1		●				
79	239.006	1313 339 002	Gasket	2		●				
80	198.339	1268 298 938	Spring Slide kit	1		●				
81	198.564		Spring Slide kit	1		●				
82	198.842	1295 298 933	Spring Slide kit	1		●				
83	298.113		Repair kit	1	W/"New Type" synchro rings	●				
84	111.440	0630 501 058	Retainer Ring	1		●				

ECOSPLIT I-II
16S220A

Date

09/2014

Notes