

Adattabile a : **SCANIA**  
Suitable To :

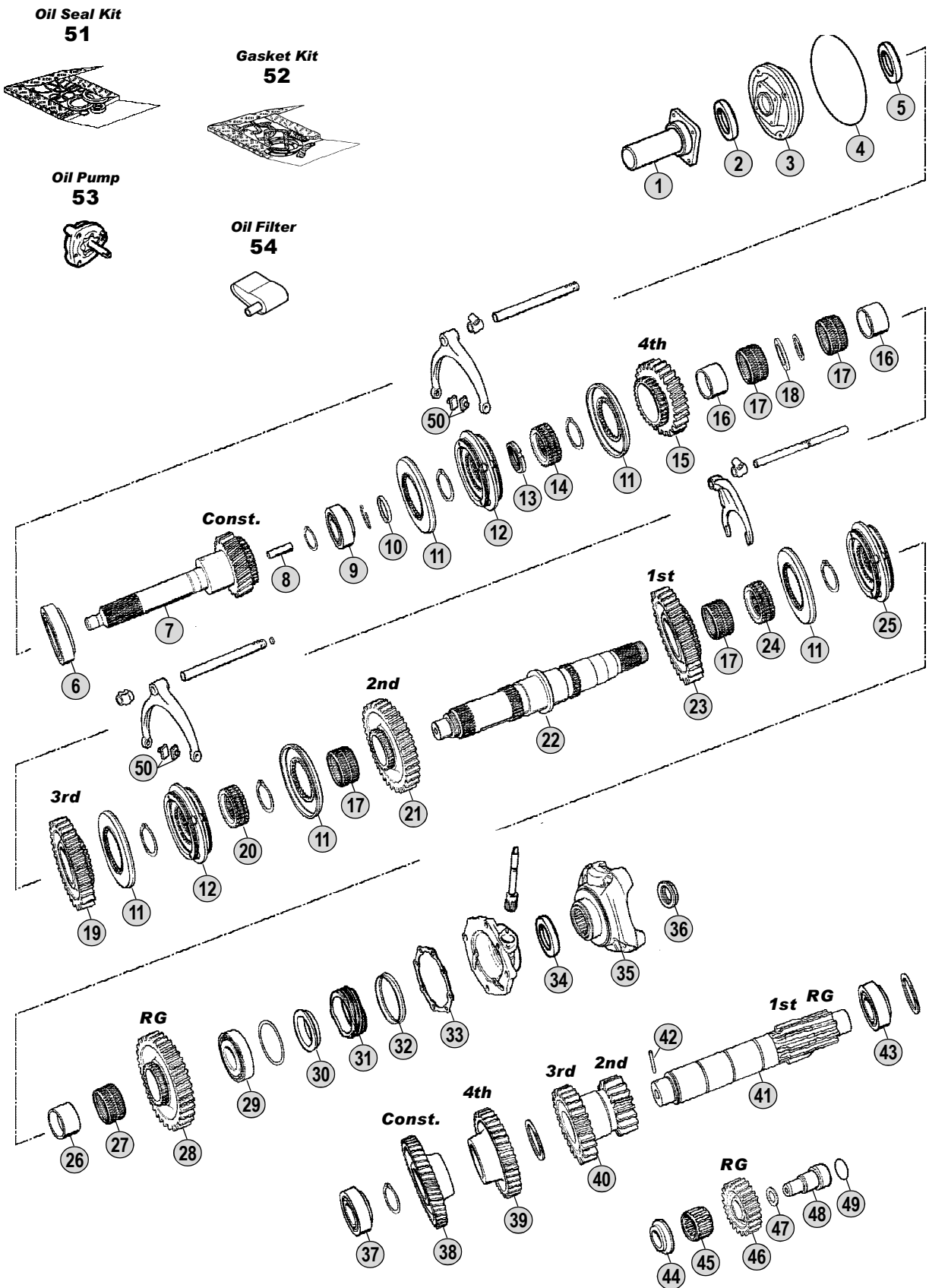

All original equipment manufacturers numbers, symbols, pictures, models and description used in this catalogue are for reference only, and it is not implied that any part listed is the product of these manufacturers. Tutti i nostri particolari non sono originali ma con essi intercambiabili. I riferimenti originali, le figure, i modelli sono esposti a semplice titolo indicativo. La nostra produzione riporta il nostro marchio.

Models

**Serie 2 - Serie 3**  
**Bus K92CL - Bus K112**  
**Bus K113**



Fig.	CEI no.	Rif. SCANIA	Description	Q.ty	Note	G776	G777			
1	135.150	1103619	Front Cover	1		●	●			
2	139.420	315270	V-Ring	1		●	●			
3	135.153	334389	Front Cover	1		●	●			
4	139.417	194414	O Ring 203x3 mm	1		●	●			
5	139.418	388528	Oil Seal Ring D.45x65x9	1		●	●			
6	130.611	1121538	Bearing 76,22x139,7x36	1		●	●			
7	102.209	294898	Input Shaft 25 T	1	(1)	●	●			
7	102.217	1352794	Input Shaft 25 T	1	(2)	●	●			
8	189.502	315060	Oil tube	1		●	●			
9	130.614	284843	Bearing 40x80x32	1		●	●			
10	111.230	315022	Ring	1		●	●			
11	109.118	325113	Synchronizer Cone	5	(A)	●				
11	109.117	332118	Synchronizer Cone	5	(B)	●				
11	109.117	332118	Synchronizer Cone	5			●			
12	196.105	244990	Synchronizer Assy.	2	(A)	●				
12	196.216	328117	Synchronizer Assy.	2	(B)	●				
12	196.216	328117	Synchronizer Assy.	2			●			
13	187.464	194484	Nut M50x1,5	1		●	●			
14	157.135	224086	Synchronizer Hub	1		●	●			
15	145.436	325251	Gear 4th Speed 28 T	1		●	●			
16	117.361	194376	Bush	2		●	●			
17	137.238	194413	Needle Cage D.70x78x46	4		●	●			
18	111.231	264225	Ring	1		●	●			
19	145.437	325252	Gear 3rd Speed 29 T	1		●	●			
20	157.134	224087	Guide Sleeve	1		●	●			
21	145.735	317978	Gear 2nd Speed 35 T	1		●				
21	145.733	328382	Gear 2nd Speed 35 T	1			●			
22	103.172	317400	Main Shaft	1		●	●			
23	145.736	317979	Gear 1st Speed 39 T	1		●				
23	145.737	1115264	Gear 1st Speed 39 T	1			●			
24	157.659	315680	Hub	1		●	●			
25	196.342	353041	Synchronizer Assy.	1	(A)	●				
25	196.343	325107	Synchronizer Assy.	1	(B)	●				
25	196.343	325107	Synchronizer Assy.	1			●			
26	117.367	315682	Bush	1		●	●			
27	137.239	315683	Needle Cage	1		●	●			
28	147.199	1117993	Reverse Gear 39 T	1		●	●			
29	130.615	284997	Bearing 57x119,9x32,7	1		●	●			
30	169.899	284806	Spacer	1		●	●			
31	126.027	174806	Speedometer Gear	1		●	●			
32	189.481	1307760	Dust Cover	1		●	●			
33	139.719	387314	Gasket	1		●	●			
34	139.384	1335243	Oil Seal Ring D.80x100x10 (Green)	1	Old Style (Green)	●	●			
34	139.544	338643	Oil Seal Ring (Brown)	1	New Style (Brown)	●	●			
35	197.101	315548	Output Flange	1	(3) P/PF40	●	●			

## Notes

- (A) Use items marked (A) together  
 (1) Up to gearbox **1823419**  
 (3) Old Type with spider straight housing (0°)  
 (5) Containing 1 pc. **194414** Size **203x3** (Fig.4)
- (B) Use items marked (B) together  
 (2) From gearbox **1823420**  
 (4) New Type with spider elical housing (4,5°)  
 (6) Containing 1 pc. **1309563** Size **203x5**

## Date

05 / 2010

## Table

0060

Adattabile a : **SCANIA**  
Suitable To :

Modelli Cambio/ Gearbox Models  
**G776 - G777**

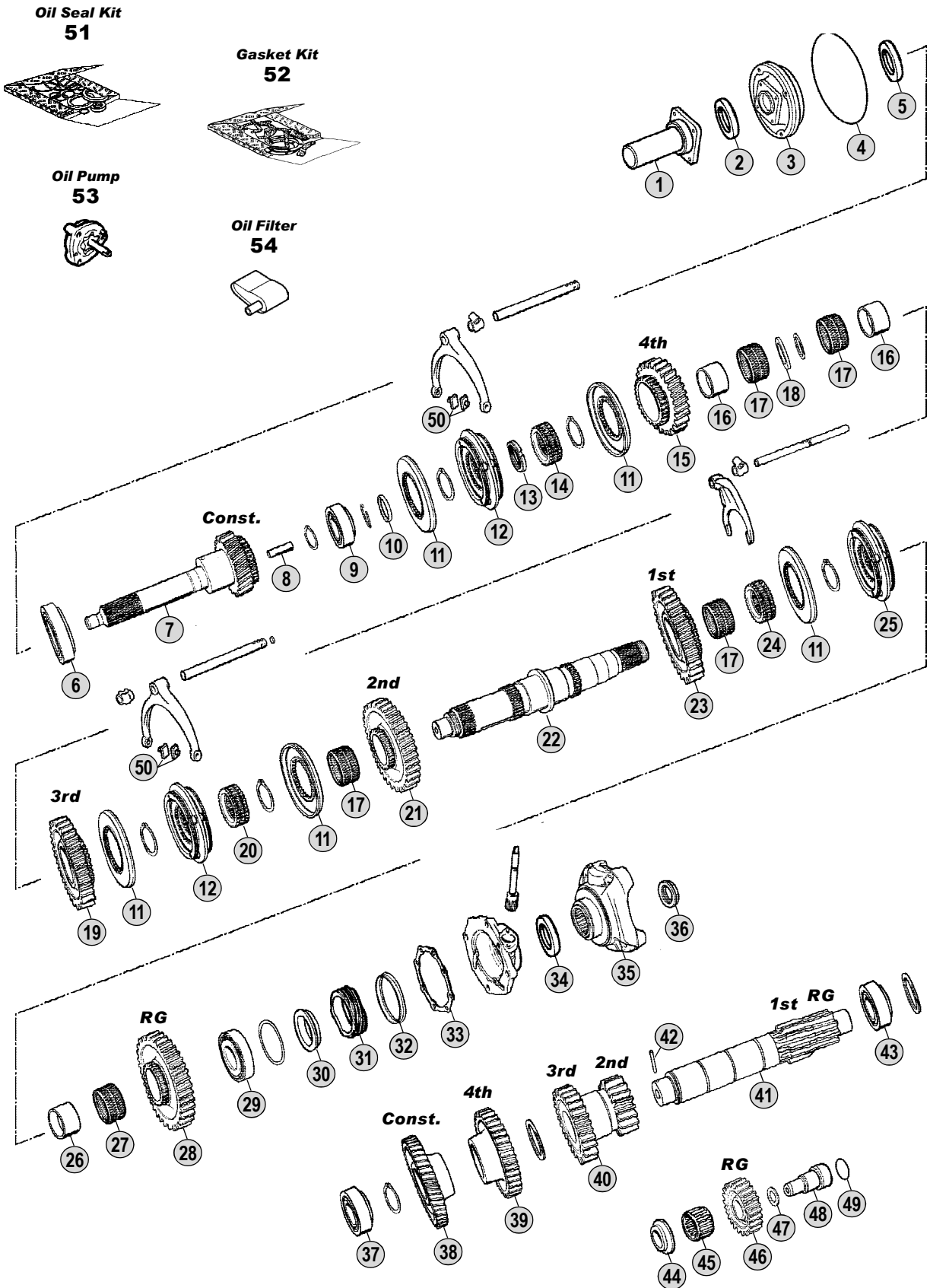

All original equipment manufacturer's numbers, symbols, pictures, models and description used in this catalogue are for reference only, and it is not implied that any part listed is the product of these manufacturers. Tutti i nostri particolari non sono originali ma con essi intercambiabili. I riferimenti originali, le figure, i modelli sono esposti a semplice titolo indicativo. La nostra produzione riporta il nostro marchio.

Models

**Serie 2 - Serie 3**

**Bus K92CL - Bus K112**

**Bus K113**



Fig.	CEI no.	Rif. SCANIA	Description	Q.ty	Note	G776	G777			
35	197.102	338234	Output Flange	1	(4) P/PF40	●	●			
36	187.468	315085	Grooved Nut M50x1,5	1		●	●			
37	130.616	317350	Bearing 50x90x28	1		●	●			
38	146.536	304623	Constant Gear 40 T	1		●	●			
39	146.538	284809	Gear 4th Speed 35 T	1		●	●			
40	143.114	317992	Double Gear 2nd/3rd Sp.-18/25 T	1		●				
40	143.095	325255	Double Gear 2nd/3rd Sp.-17/25 T	1			●			
41	105.164	317991	Countershaft 12/10 T	1		●				
41	105.163	284807	Countershaft 10/10 T	1			●			
42	187.645	340430	Pin	1		●	●			
43	130.617	294023	Bearing	1		●	●			
44	169.901	194798	Washer	1		●	●			
45	137.234	174371	Needle Cage D.38x50x32,8	1		●	●			
46	147.200	194562	Reverse Gear 23 T	1		●	●			
47	111.232	194400	Spacer Ring	1		●	●			
48	107.186	358046	Reverse Pin	1		●	●			
49	169.902	810974	O-Ring	1		●	●			
50	141.169	244090	Slide	4		●	●			
51	198.621	550520	Oil Seals Kit	1	(5)	●	●			
51	198.978	550537	Oil Seals Kit	1	(6)	●	●			
52	198.979	550532	Gasket Kit	1		●	●			
53	280.609	194838	Oil Pump	1		●	●			
54	280.610	224367	Oil Filter	1		●	●			

All original equipment manufacturer's numbers, symbols, pictures, models and description used in this catalogue are for reference only, and it is not implied that any part listed is the product of these manufactures. Tutti i nostri particolari non sono originali ma con essi intercambiabili. I riferimenti originali, le figure, i modelli sono esposti a semplice titolo indicativo. La nostra produzione riporta il nostro marchio.

#### Notes

- (A) Use items marked **(A)** together  
 (1) Up to gearbox **1823419**  
 (3) Old Type with spider straight housing (0°)  
 (5) Containing 1 pc. **194414** Size 203x3 (Fig.4)
- (B) Use items marked **(B)** together  
 (2) From gearbox **1823420**  
 (4) New Type with spider elical housing (4,5°)  
 (6) Containing 1 pc. **1309563** Size 203x5

#### Date

05 / 2010

#### Table

**0060**