

Adattabile a : **SCANIA**  
Suitable To :

**GR875 - GR875R (W/Retarder)**

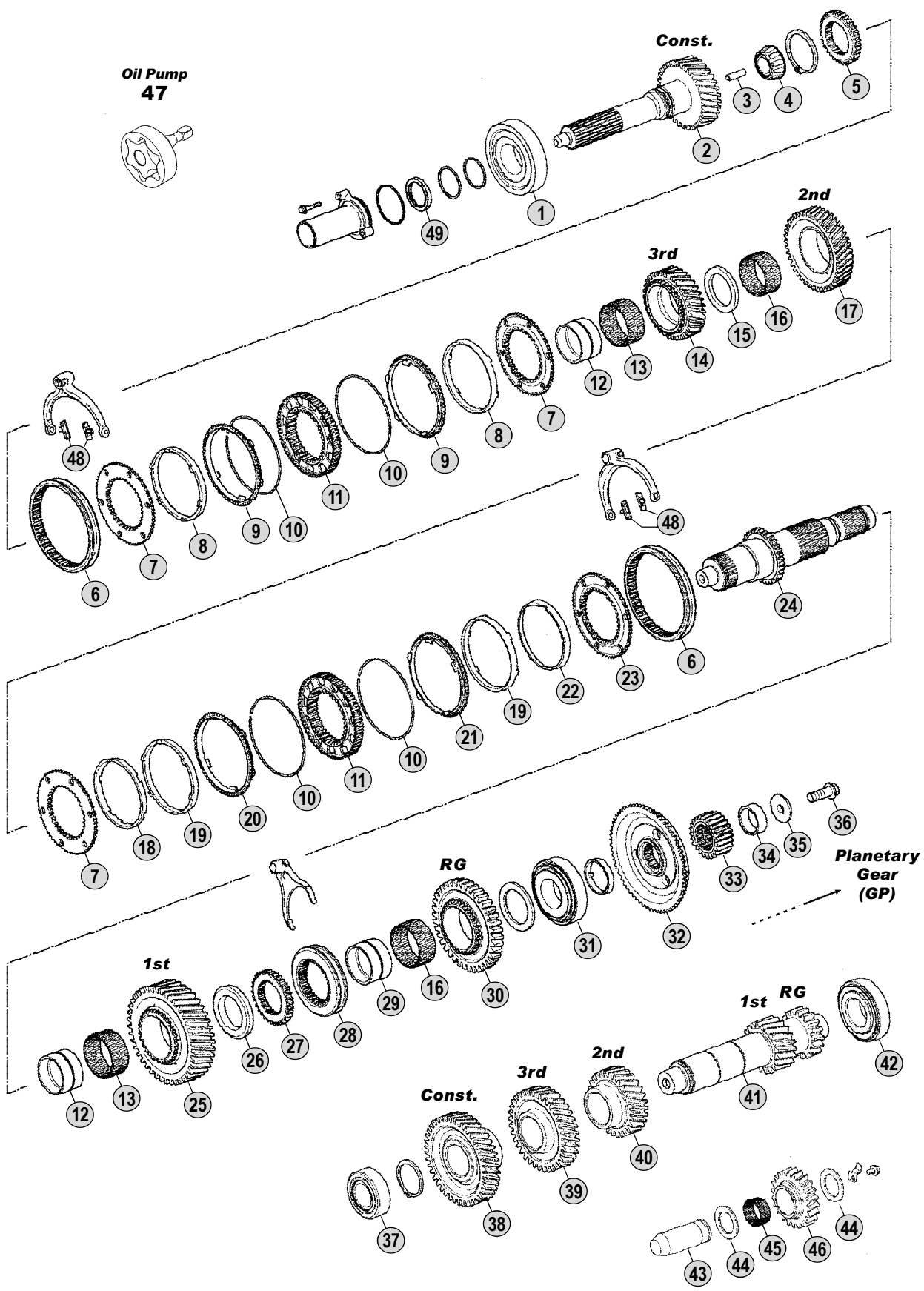

All original equipment manufacturers numbers, symbols, pictures, models and description used in this catalogue are for reference only, and it is not implied that any part listed is the product of these manufacturers. Tutti i nostri particolari non sono originali ma con essi intercambiabili. I riferimenti originali, le figure, i modelli sono esposti a semplice titolo indicativo. La nostra produzione riporta il nostro marchio.

Models

**Serie P - Serie R**

**P230 - P270 - P310**

**R230 - R270 - R310**



Fig.	CEI no.	Rif. SCANIA	Description	Q.ty	Note	GR875	GR875R			
1	130.528	1327878	Bearing D.65x150x40	1	Oem	●	●			
1	530.528	1327878	Bearing D.65x150x40	1	A.Market	●	●			
2	102.407	1769964	Input Shaft	1	Up to 2029367	●	●			
2	102.465	1778014	Input Shaft	1	From 2029368	●	●			
2	102.408	1772369	Input Shaft	1	EK-PTO Up to 2029367	●	●			
2	102.466	1783431	Input Shaft	1	EK-PTO From 2029368	●	●			
3	189.642	1762675	Tube	1		●	●			
4	130.530	1883975	Roller Bearing 40x30 mm	1		●	●			
5	155.233	1789137	Fixed Hub	1		●	●			
6	154.389	1752963	Sliding Sleeve	2		●	●			
7	109.416	1495269	Synchronizer Cone	3		●	●			
8	119.238	1849451	Intermediate Synchro Ring	2		●	●			
9	119.240	1543357	Synchronizer Ring	2		●	●			
10	111.275	1730173	Ring	4		●	●			
11	157.985	1788922	Synchronizer Hub	2		●	●			
12	117.388	1769457	Bush	2		●	●			
13	137.278	1774165	Needle Cage	2		●	●			
14	145.913	1476208	Gear 3rd Speed	1		●	●			
15		1490886	Washer	1		●	●			
16	137.279	1476286	Needle Cage	2		●	●			
17	145.914	1476214	Gear 2nd Speed	1		●	●			
18	119.241	1849457	Intermediate Synchro Ring	1		●	●			
19	119.242	1849454	Intermediate Synchro Ring	2		●	●			
20	119.243	1543359	Synchronizer Ring	1		●	●			
21	119.245	1543361	Synchronizer Ring	1		●	●			
22	119.244	1849460	Intermediate Synchro Ring	1		●	●			
23	109.417	1495267	Synchronizer Cone	1		●	●			
24	103.201	1476200	Main Shaft	1		●	●			
25	145.915	1476222	Gear 1st Speed	1		●	●			
26		1513484	Washer	1		●	●			
27	155.233	1789137	Fixed Hub	1		●	●			
28	154.391	1514712	Sliding Sleeve	1		●	●			
29	117.389	1476287	Bush	1		●	●			
30	147.246	1476236	Reverse Gear	1		●	●			
31	130.528	1327878	Bearing D.65x150x40	1	Oem	●	●			
31	530.528	1327878	Bearing D.65x150x40	1	A.Market	●	●			
32	109.419	1491227	Synchronizer Cone	1	(*) Old Generation	●	●			
32	109.418	1788171	Synchronizer Cone	1	(*) New Generation	●	●			
32	109.757	1883352	Synchronizer Cone	1	(@) Latest Generation	●	●			
33	157.986	1476324	Sun Gear	1		●	●			
34		1408485	Spacer	1		●	●			
34		1414441	Bearing	1			●			
35		1498317	Washer	1		●	●			
36		1887739	Screw	1		●	●			
37	130.721	1534829	Bearing	1		●	●			

## Notes

(\*) Old and New Generation. Can be replaced by Synchro rebuilt kit 298.189 (Latest Generation) shown in the next table.

(@) LATEST GENERATION. To be coupled together.

## Date

05/ 2010

## Table

0110

Adattabile a : **SCANIA**

**GR875 - GR875R (W/Retarder)**

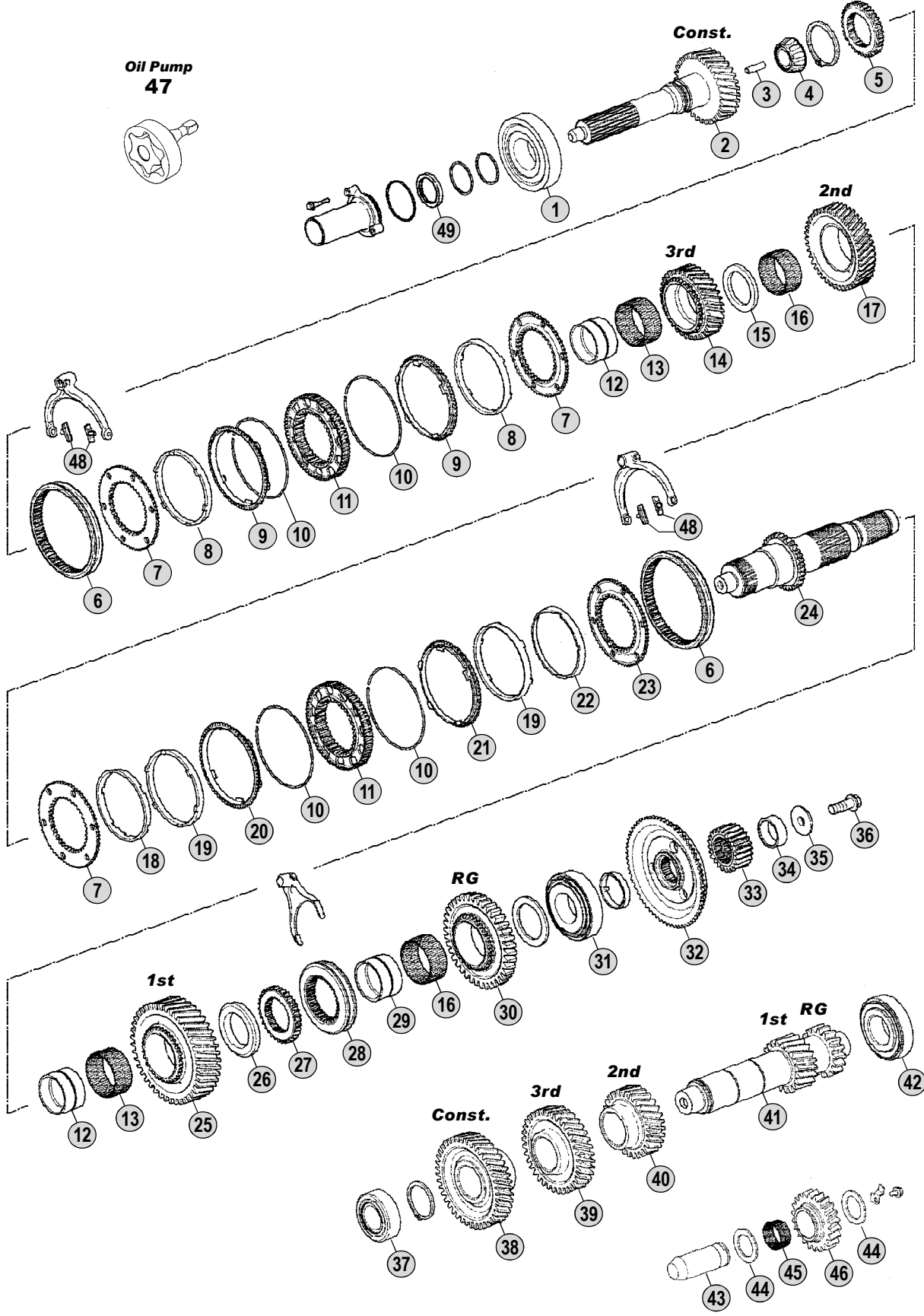

All original equipment manufacturers numbers, symbols, models and description used in this catalogue are for reference only, and it is not implied that any part listed is the product of these manufacturers. Tutti i nostri particolari non sono originali ma con essi intercambiabili. I riferimenti originali, le figure, i modelli sono esposti a semplice titolo indicativo. La nostra produzione riporta il nostro marchio.

Models

**Serie P - Serie R**

**P230 - P270 - P310**

**R230 - R270 - R310**



Fig.	CEI no.	Rif. SCANIA	Description	Q.ty	Note	GR875		GR875R	
						●	●	●	●
38	146.627	1476254	Constant Gear	1		●	●		
39	146.628	1476258	Gear 3rd Speed	1		●	●		
40	146.629	1476268	Gear 2nd Speed	1		●	●		
41	105.200	1770211	Countershaft	1		●	●		
42	130.532	1357711	Bearing 60X130X33,5	1	Oem	●	●		
42	530.532	1357711	Bearing 60X130X33,5	1	A.Market	●	●		
43		1525575	Reverse Pin	1		●	●		
44	169.908	380109	Spacer	2		●	●		
45	137.172	378615	Needle Cage D.50x62x21,5	2		●	●		
46		1476274	Reverse Gear	1		●	●		
47	280.676	1526232	Oil Pump	1		●	●		
48	141.207	1526229	Slide	4		●	●		
49	139.762	1443189	Oil seal	1		●	●		

All original equipment manufacturer's numbers, symbols, pictures, models and description used in this catalogue are for reference only, and it is not implied that any part listed is the product of these manufactures.  
 Tutti i nostri particolari non sono originali ma con essi intercambiabili. I riferimenti originali, le figure, i modelli sono esposti a semplice titolo indicativo. La nostra produzione riporta il nostro marchio.

**Notes**

(\*) Old and New Generation. Can be replaced by Synchro rebuilt kit 298.189 (Latest Generation) shown in the next table.  
 (@) LATEST GENERATION. To be coupled together.

**Date**

05/ 2010

**Table**

**0110**



Adattabile a : **SCANIA**

**GR875 - GR875R (W/Retarder)**

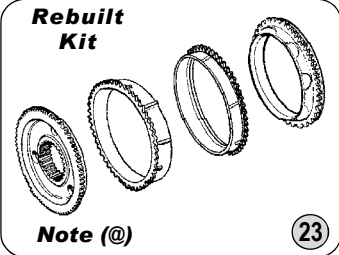

**Repair Kit**  
6 + 6 + 12  
▲ = 6

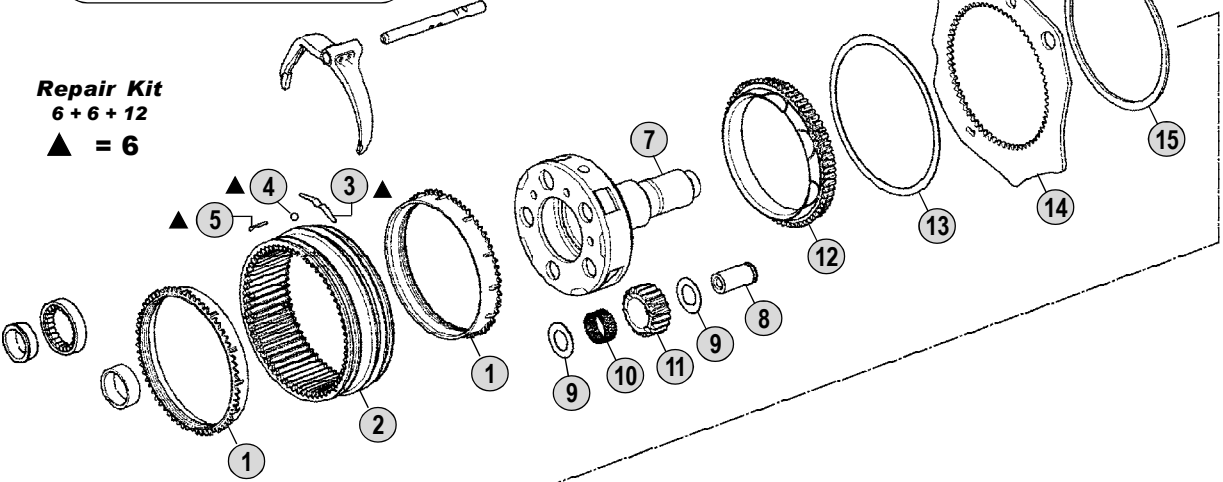

**Main Shaft**

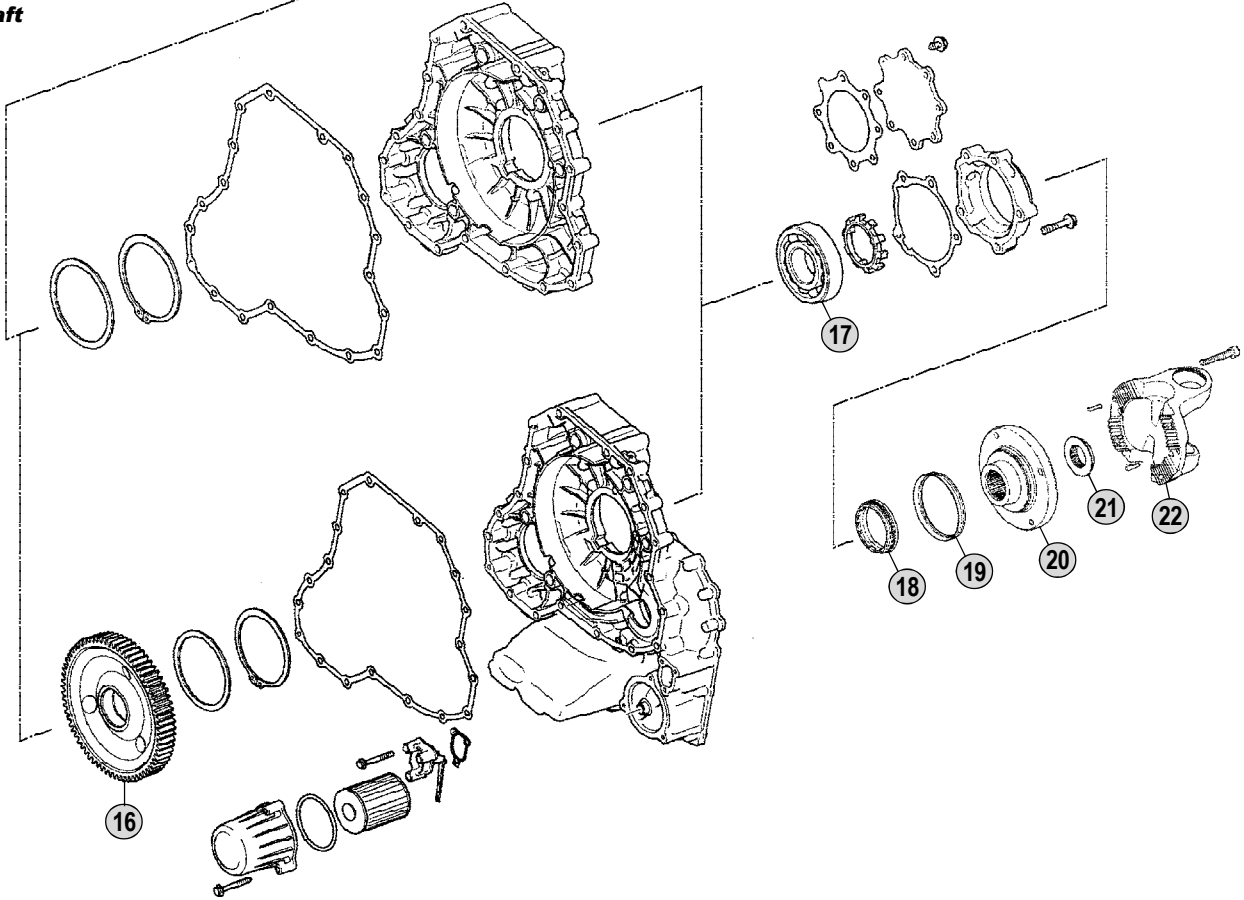

All original equipment manufacturer's numbers, symbols and description used in this catalogue are for reference only, and it is not implied that any part listed is the product of these manufactures. Tutti i nostri particolari non sono originali ma con essi intercambiabili. I riferimenti originali, le figure, i modelli sono esposti a semplice titolo indicativo. La nostra produzione riporta il nostro marchio.

**Models**

**Serie P - Serie R**

**P230 - P270 - P310**

**R230 - R270 - R310**



Fig.	CEI no.	Rif. SCANIA	Description	Q.ty	Note	GR875	GR875R			
1	<b>119.121</b>	1395624	Synchronizer Ring	2	(*) Old Generation	●	●			
1	119.249	1770058	Synchronizer Ring	2	(*) New Generation	●	●			
1	<b>119.288</b>	1883363	Synchronizer Ring	2	(@) Latest Generation	●	●			
2	<b>123.216</b>	1118030	Crown Gear 66 T	1		●	●			
3	<b>156.185</b>	1395039	Spring	6		●	●			
4	<b>160.216</b>	871702	Ball	12		●	●			
5	<b>160.215</b>	1332508	Pin	6		●	●			
6	<b>298.033</b>	CEI 298033	Repair Kit	1		●	●			
7	190.408	1776626	Planetary Carrier	1	Complete	●				
7	190.409	1776737	Planetary Carrier	1	Complete		●			
8	107.211	1776625	Pin	5		●	●			
9	269.072	1422910	Washer	10		●	●			
10	<b>137.168</b>	389434	Needle Bearing	5		●	●			
11	<b>157.199</b>	1373174	Planet Pinion 20 T	5		●	●			
12	<b>109.168</b>	1323147	Synchronizer Cone	1	(*) Old Generation	●	●			
12	109.421	1788170	Synchronizer Cone	1	(*) New Generation	●	●			
12	<b>109.756</b>	1883350	Synchronizer Cone	1	(@) Latest Generation	●	●			
13		1491380	Ring	1		●	●			
14	135.182	1520797	Plate	1		●	●			
15	<b>111.207</b>	1302665	Snap Ring	1		●	●			
16		1500145	Retarder Gear	1			●			
17	130.533	1783324	Bearing D.60x130x31	1		●	●			
18	139.568	1502384	Oil Seal 85x105x13	1		●	●			
19	139.481	1300977	Dust Cover	1		●	●			
20		1535361	Output Flange	1	P602	●	●			
21	<b>187.486</b>	1525988	Nut M44x1,5	1		●	●			
22		1531005	Output flange	1	P602	●	●			
23	<b>298.189</b>	CEI 298189	Synchro kit	1	(@)	●	●			

## Notes

(\*) Old and New Generation. Can be replaced by synchro rebuilt kit **298.189** (Fig.23).  
 (@) LATEST GENERATION. To be coupled together

## Date

05 / 2010

## Table

**0115**

All original equipment manufacturer's numbers, symbols, pictures, models and description used in this catalogue are for reference only, and it is not implied that any part listed is the product of these manufacturers.  
 Tutti i nostri particolari non sono originali ma con essi intercambiabili. I riferimenti originali, le figure, i modelli sono esposti a semplice titolo indicativo. La nostra produzione riporta il nostro marchio.