

Adattabile a: **VOLVO** R1000 - R1400 - R1500 - R1700 - R1900
 Suitable To:

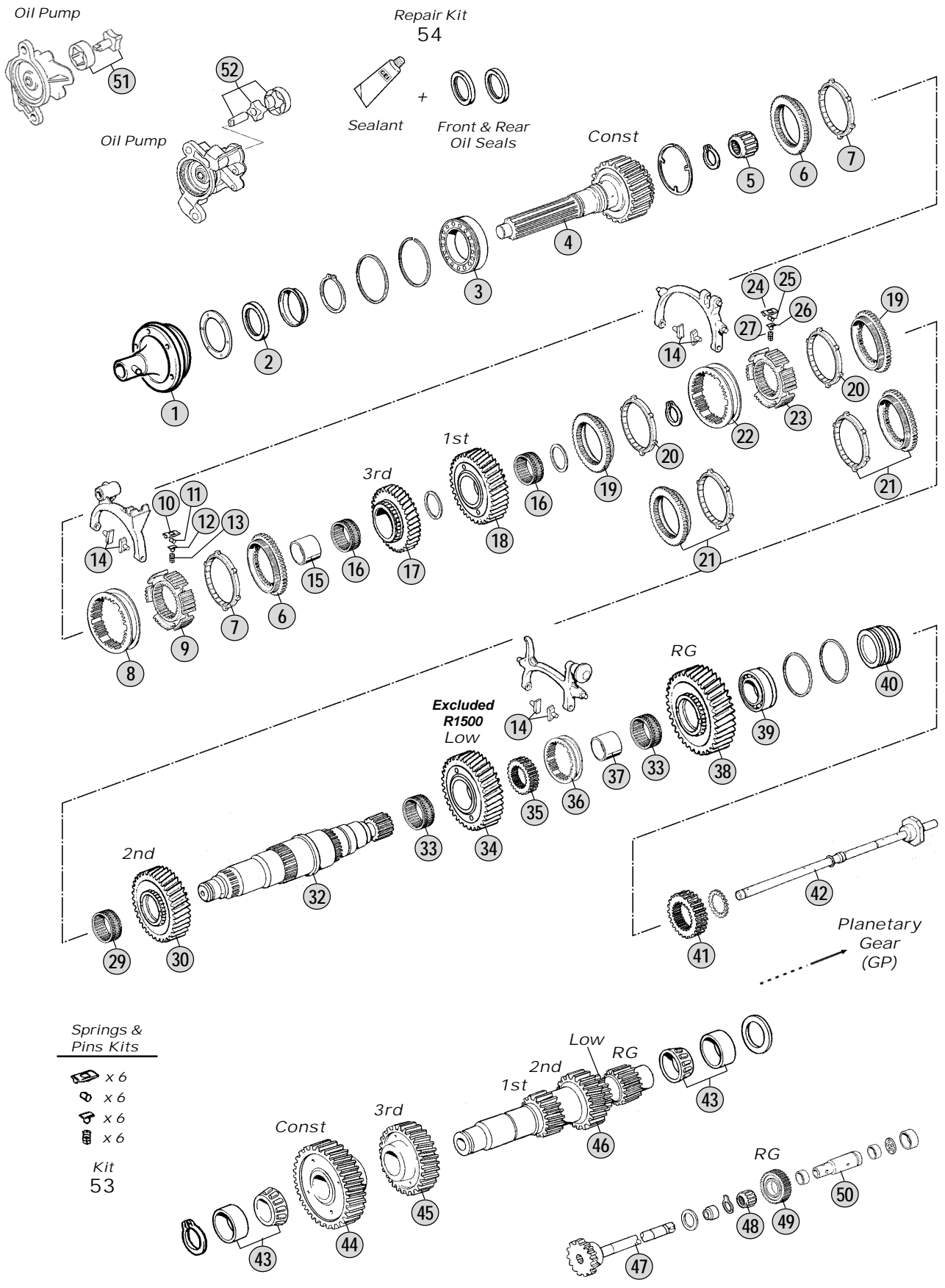

All original equipment manufacturers' numbers, symbols, pictures, models and description used in this catalogue are for reference only, and it is not implied that any part listed is the product of these manufactures. Tutti i nostri particolari non sono originali ma con essi intercambiabili. I riferimenti originali, le figure, i modelli sono esposti a semplice titolo indicativo. La nostra produzione riporta il nostro marchio.

Models

R1000	FL616-619 - FL7 - FS7
R1400/1700	FL7 - FM7 - F10 - FL10 - N10 - NL10 - F12 - FH12 - FL12 - FM12 - NH12 - NL12
R1500	FM7 - FM10
R1900	FH12 - FL12 - FM12 - NH12



Fig.	CEI no.	Rif. VOLVO	Description	Q.ty	Note	R1000	R1400	R1500	R1700	R1900
1	135.174	1652042	Front Cover	1	FL616/FL619	●				
1	135.136	1656121	Front Cover	1	FL7/FS7	●				
1	135.175	1653056	Front Cover	1	(A)		●		●	
1	135.136	1656121	Front Cover	1	(B)		●		●	
1	135.136	1656121	Front Cover	1				●		●
2	139.391	267268	Oil Seal 65x90x10 B1SL	1		●	●	●	●	●
3	130.570	18459	Bearing 85x150x30,5	1		●		●		
3	130.674	1522556	Bearing	1	(A)		●		●	
3	130.588	1656100	Bearing	1	(B)		●		●	
3	130.588	1656100	Bearing	1						●
4	102.340	1652039	Input Shaft	1	FL616/FL619	●				
4	102.316	1652036	Input Shaft	1	FL7/FS7	●				
4	102.341	1653095	Input Shaft 31 T	1	(A)		●		●	
4	102.317	1668470	Input Shaft 31 T	1	(B)		●		●	
4	102.318	1069193	Input Shaft	1				●		
4	102.317	1668470	Input Shaft 31 T	1						●
5	130.591	184679	Bearing	1		●				
5	130.593	1652559	Bearing 40x74x29	1	(A)		●		●	
5	130.568	1656104	Bearing 45x35	1	(B)		●		●	
5	130.568	1656104	Bearing 45x35	1				●		●
6	109.116	1653920	Synchronizer Cone	2		●	●	●	●	●
7	119.139	1653960	Synchronizer Ring	2		●	●	●	●	●
8	154.132	1653240	Sliding Sleeve	1		●	●	●	●	●
8	154.345	1653940	Sliding Sleeve	1	Old-Repl.by 1653240+1668213	●	●	●	●	●
9	155.171	1668213	Synchronizer Hub	1		●	●	●	●	●
10	160.200	1653990	Slide	4		●	●	●	●	●
11	160.202	1653900	Pin	4		●	●	●	●	●
12	160.201	1668280	Slide	4		●	●	●	●	●
13	156.179	1653901	Spring	4		●	●	●	●	●
14	141.045	382565	Sliding Block	6		●	●	●	●	●
15	117.345	1652131	Bush	1		●				
15	117.346	1652569	Bush	1			●	●	●	●
16	137.227	1652135	Needle Cage	2		●				
16	137.218	1652572	Needle Cage	2			●		●	●
16	137.197	1655563	Needle Cage	2				●		
17	145.695	1652051	Gear 3rd Speed	1		●				
17	145.697	1652871	Gear 3rd Speed 36 T	1			●		●	●
17	145.705	1069196	Gear 3rd Speed	1				●		
18	145.696	1652052	Gear 1st Speed	1		●				
18	145.698	1653378	Gear 1st Speed 44 T	1	(C)		●		●	
18	145.700	1671996	Gear 1st Speed 44 T	1	(D)		●		●	
18	145.706	1069317	Gear 1st Speed	1	(E)		●		●	
18	145.701	1069316	Gear 1st Speed 44 T	1				●		
18	145.700	1671996	Gear 1st Speed 44 T	1						●
19	109.115	1653924	Synchronizer Cone	2	(F)	●	●		●	

Notes

Date

(A) R1000 Up to gearbox 11842 - R1400 Up to gearbox 18614 - R1700 Up to gearbox 6739

(B) R1000 From gearbox 11843 - R1400 From gearbox 18615 - R1700 From gearbox 6740

(C) Up to gearbox 95414001

(D) From gearbox 95414002

(E) Latest Generation

(F) R1000 Up to gearbox 95043006 - R1400 Up to gearbox 95043006 - R1700 Up to gearbox 9502000

(G) R1000 From gearbox 95043007 - R1400 From gearbox 95043007 - R1700 From gearbox 9502001

04 / 2012

Table

Adattabile a: **VOLVO** R1000 - R1400 - R1500 - R1700 - R1900
 Suitable To:

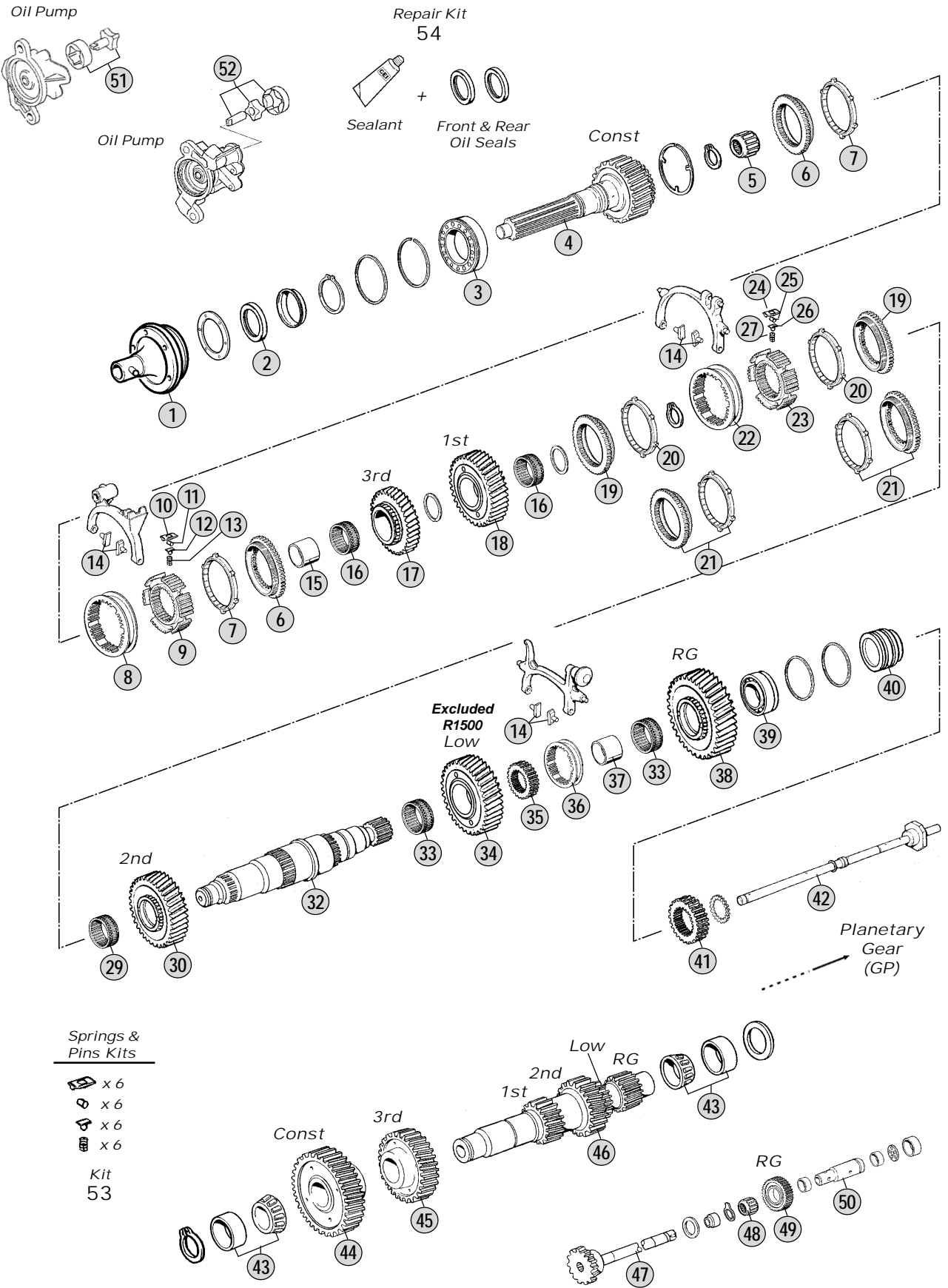

All original equipment manufacturers' numbers, symbols, pictures, models and description used in this catalogue are for reference only, and it is not implied that any part listed is the product of these manufactures. Tutti i nostri particolari non sono originali ma con essi intercambiabili. I riferimenti originali, le figure, i modelli sono esposti a semplice titolo indicativo. La nostra produzione riporta il nostro marchio.

Models

R1000	FL616-619 - FL7 - FS7
R1400/1700	FL7 - FM7 - F10 - FL10 - N10 - NL10 - F12 - FH12 - FL12 - FM12 - NH12 - NL12
R1500	FM7 - FM10
R1900	FH12 - FL12 - FM12 - NH12



Fig.	CEI no.	Rif. VOLVO	Description	Q.ty	Note	R1000	R1400	R1500	R1700	R1900
20	119.140	1653964	Synchronizer Ring	2	(F)	●	●		●	
21	198.806	1669360	Synchro kit 1st/2nd Speed	2	(G)	●	●		●	
21	198.806	1669360	Synchro kit 1st/2nd Speed	2				●		●
22	154.133	1668244	Sliding Sleeve	1	(F)	●	●		●	
22	154.344	1653944	Sliding Sleeve 1st-2nd Speed	1	(F) Old-Repl.by 1668244+1668214	●	●		●	
22	154.300	1669034	Sliding Sleeve	1	(G)	●	●		●	
22	154.300	1669034	Sliding Sleeve	1				●		●
23	155.172	1668214	Synchronizer Hub	1		●	●	●	●	●
24	160.200	1653990	Slide	4		●	●	●	●	●
25	160.202	1653900	Pin	4		●	●	●	●	●
26	160.201	1668280	Slide	4		●	●	●	●	●
27	156.179	1653901	Spring	4		●	●	●	●	●
29	137.195	1652261	Needle Cage 90x98x40	1		●		●		
29	137.196	1652575	Needle Cage 90x98x45,50	1			●		●	●
30	145.702	1652061	Gear 2nd Speed	1		●				
30	145.482	1653376	Gear 2nd Speed 39 T	1			●	●	●	●
32	103.162	1652037	Main Shaft	1	(A)	●				
32	103.164	1668068	Main Shaft	1	(B)	●				
32	103.165	1652523	Main Shaft	1	(A)		●		●	
32	103.163	1656251	Main Shaft	1	(B)		●		●	
32	103.152	20366733	Main Shaft 34/42/28/28 T	1				●		
32	103.163	1656251	Main Shaft	1						●
33	137.228	1652139	Needle Cage	2		●				
33	137.196	1652575	Needle Cage 90x98x45,50	2			●	●	●	●
34	145.703	1652065	Gear Low Speed	1		●				
34	145.476	1652617	Gear Low Speed 47 T	1	(CD) Straight Tooth		●		●	
34	145.704	1673434	Gear Low Speed 38 T	1	(E) Helical Tooth		●		●	
34	145.704	1673434	Gear Low Speed 38 T	1						●
35	157.679	1652544	Fixed Hub	1	(A)	●	●		●	
35	157.184	1656265	Fixed Hub	1	(B) Old Type with Sleeve 1656266	●	●	●	●	●
35	157.185	20366731	Fixed Hub	1	(B) New Type with Sleeve 2036682	●	●	●	●	●
36	154.193	1652545	Sliding Sleeve	1	(A)	●	●		●	
36	154.192	1656266	Sliding Sleeve	1	(B) Old Type With Hub 1656265	●	●	●	●	●
36	154.198	20366826	Sliding Sleeve	1	(B) New Type With Hub 20366731	●	●	●	●	●
37	117.349	1652143	Bush	1		●				
37	117.350	1652578	Bush	1			●		●	●
38	147.190	1652066	Reverse Gear	1		●				
38	147.129	1652618	Reverse Gear 43 T	1	(CD) Straight Tooth		●		●	
38	147.192	1673432	Reverse Gear 34 T	1	(E) Helical Tooth		●		●	
38	147.191	1672243	Reverse Gear 34 T	1				●		
38	147.192	1673432	Reverse Gear 34 T	1						●
39	130.569	1652123	Bearing 70x150x30,5	1		●				
39	130.589	1652553	Bearing	1	(A)		●		●	
39	130.590	1656129	Bearing 70x150x40	1	(B)		●		●	
39	530.590	1656129	Bearing 70x150x40	1	(B)		●		●	

Notes

(A) R1000 Up to gearbox 11842 - R1400 Up to gearbox 18614 - R1700 Up to gearbox 6739
 (B) R1000 From gearbox 11843 - R1400 From gearbox 18615 - R1700 From gearbox 6740
 (C) Up to gearbox 95414001 (D) From gearbox 95414002 (E) Latest Generation
 (F) R1000 Up to gearbox 95043006 - R1400 Up to gearbox 95043006 - R1700 Up to gearbox 9502000
 (G) R1000 From gearbox 95043007 - R1400 From gearbox 95043007 - R1700 From gearbox 9502001

Date

04 / 2012

Table

080/A

Adattabile a: **VOLVO** R1000 - R1400 - R1500 - R1700 - R1900
 Suitable To:

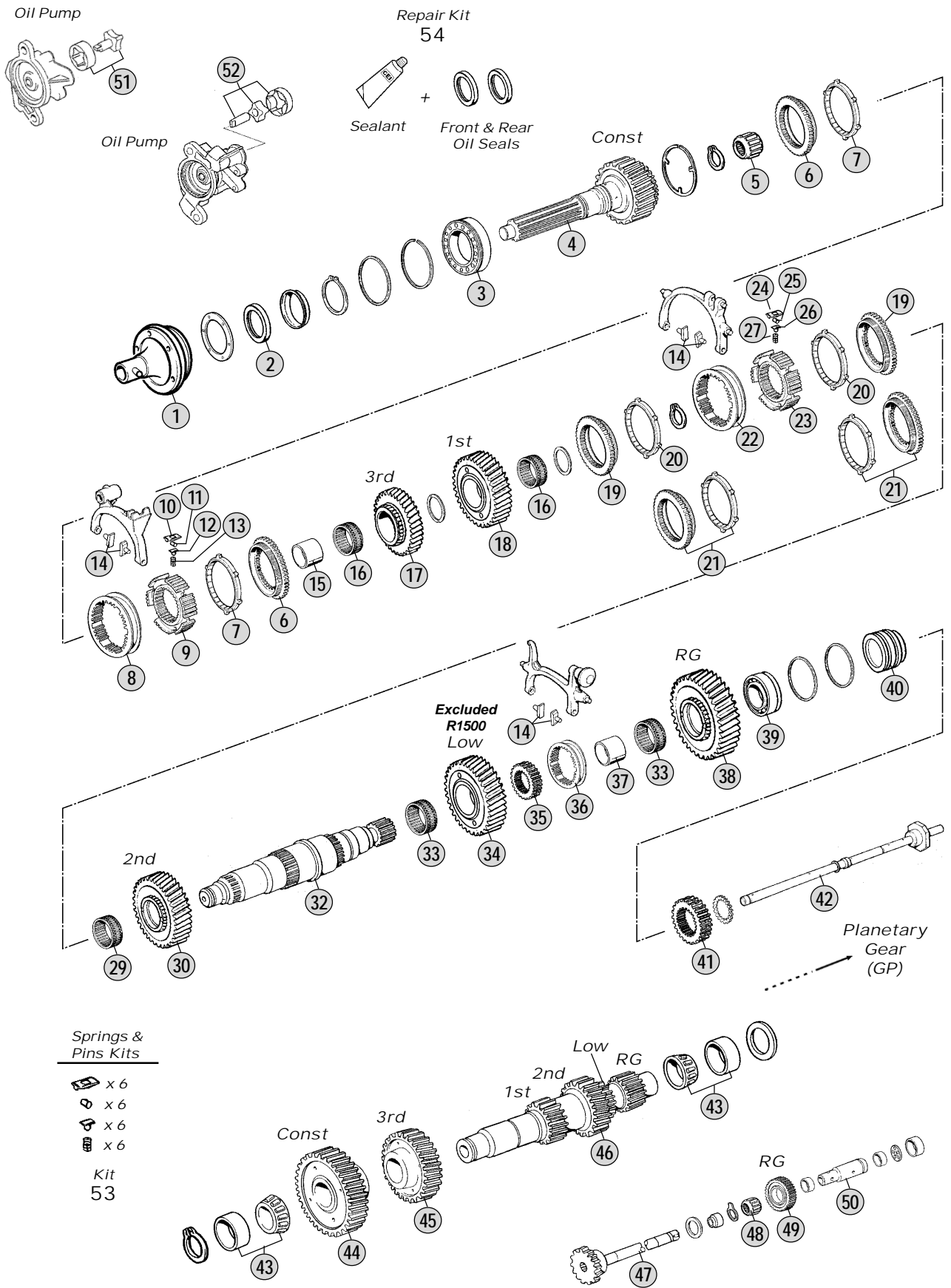

All original equipment manufacturers' numbers, symbols, pictures, models and description used in this catalogue are for reference only, and it is not implied that any part listed is the product of these manufactures. Tutti i nostri particolari non sono originali ma con essi intercambiabili. I riferimenti originali, le figure, i modelli sono esposti a semplice titolo indicativo. La nostra produzione riporta il nostro marchio.

Models

R1000	FL616-619 - FL7 - FS7
R1400/1700	FL7 - FM7 - F10 - FL10 - N10 - NL10 - F12 - FH12 - FL12 - FM12 - NH12 - NL12
R1500	FM7 - FM10
R1900	FH12 - FL12 - FM12 - NH12



Fig.	CEI no.	Rif. VOLVO	Description	Q.ty	Note	R1000	R1400	R1500	R1700	R1900
39	130.569	1652123	Bearing 70x150x30,5	1				●		
39	130.590	1656129	Bearing 70x150x40	1						●
40	117.347	1652548	Spacer	1	(A)	●	●		●	
40	117.348	1656232	Spacer	1	(B)	●	●	●	●	●
41	157.643	1652550	Sun Gear 24 T	1	(A)	●	●		●	
41	157.610	1656226	Sun Gear 24 T	1	(B)	●	●		●	
41	157.610	1656226	Sun Gear 24 T	1				●		●
42	188.183	1652257	Oil Tube	1	(A)	●				
42	188.182	1668074	Oil Tube	1	(B)	●				
42	188.184	1652681	Oil Tube	1	(A)		●		●	
42	188.185	1656263	Oil Tube	1	(B)		●		●	
42	188.182	1668074	Oil Tube	1			●			
42	188.185	1656263	Oil Tube	1						●
43	130.567	1652099	Bearing Cone	2		●				
43	130.565	1652563	Bearing Cone 110x60x39,50	2			●	●	●	●
44	146.524	1652060	Constant Gear	1		●				
44	146.482	1669804	Constant Gear 44 T	1			●		●	●
44	146.525	1069194	Constant Gear 44 T	1				●		
45	146.522	1652057	Gear 3rd Speed	1		●				
45	146.523	1652872	Gear 3rd Speed 38 T	1			●		●	●
45	146.526	1069195	Gear 3rd Speed 38 T	1				●		
46	105.146	1652040	Countershaft	1		●				
46	105.147	1653379	Countershaft 23/29/15/15 D	1	(C)		●		●	
46	105.148	1669631	Countershaft 23/29/15/15 T	1	(D)		●		●	
46	105.149	1069314	Countershaft	1	(E)		●		●	
46	105.150	20366930	Countershaft 23/29/12 T	1				●		
46	105.151	1673443	Countershaft	1						●
47	107.185	1652253	Reverse Shaft	1		●				
47	107.184	3192123	Reverse Shaft	1			●		●	●
47	107.176	1667078	Reverse Shaft	1				●		
48	137.194	1652147	Needle Cage	1		●				
48	137.229	1652581	Needle Cage 42x50x60	1			●		●	●
48	137.194	1652147	Needle Cage	1				●		
49	147.193	1652064	Reverse Gear	1		●				
49	147.194	1652539	Reverse Gear 24 T	1	(CD) Straight Tooth		●		●	
49	147.195	1521423	Reverse Gear 20 T	1	(E) Helical Tooth		●		●	
49	147.167	1672244	Reverse Gear 20 T	1				●		
49	147.195	1521423	Reverse Gear 20 T	1						●
50	107.183	1652035	Reverse Shaft	1		●				
50	107.182	20366756	Reverse Pin	1			●		●	●
50	107.175	1655527	Reverse Shaft	1				●		
51	198.821	1652671	Oil Pump Gear Kit	1		●	●	●	●	●
52	198.888	1521787	Oil Pump Gear Kit	1	Latest Type		●	●	●	●
53	198.893	CEI 198893	Springs/Slides Kit	1		●	●	●	●	●
54	198.894	CEI 198894	Sealant and Oil Seals Kit	1		●	●	●	●	●

Notes

Date

(A) R1000 Up to gearbox 11842 - R1400 Up to gearbox 18614 - R1700 Up to gearbox 6739

04 / 2012

(B) R1000 From gearbox 11843 - R1400 From gearbox 18615 - R1700 From gearbox 6740

(C) Up to gearbox 95414001

(D) From gearbox 95414002

(E) Latest Generation

Table

(F) R1000 Up to gearbox 95043006 - R1400 Up to gearbox 95043006 - R1700 Up to gearbox 9502000

(G) R1000 From gearbox 95043007 - R1400 From gearbox 95043007 - R1700 From gearbox 9502001

080/A

Adattabile a: **VOLVO** R1000 - R1400 - R1500 - R1700 - R1900
 Suitable To:

Old Type

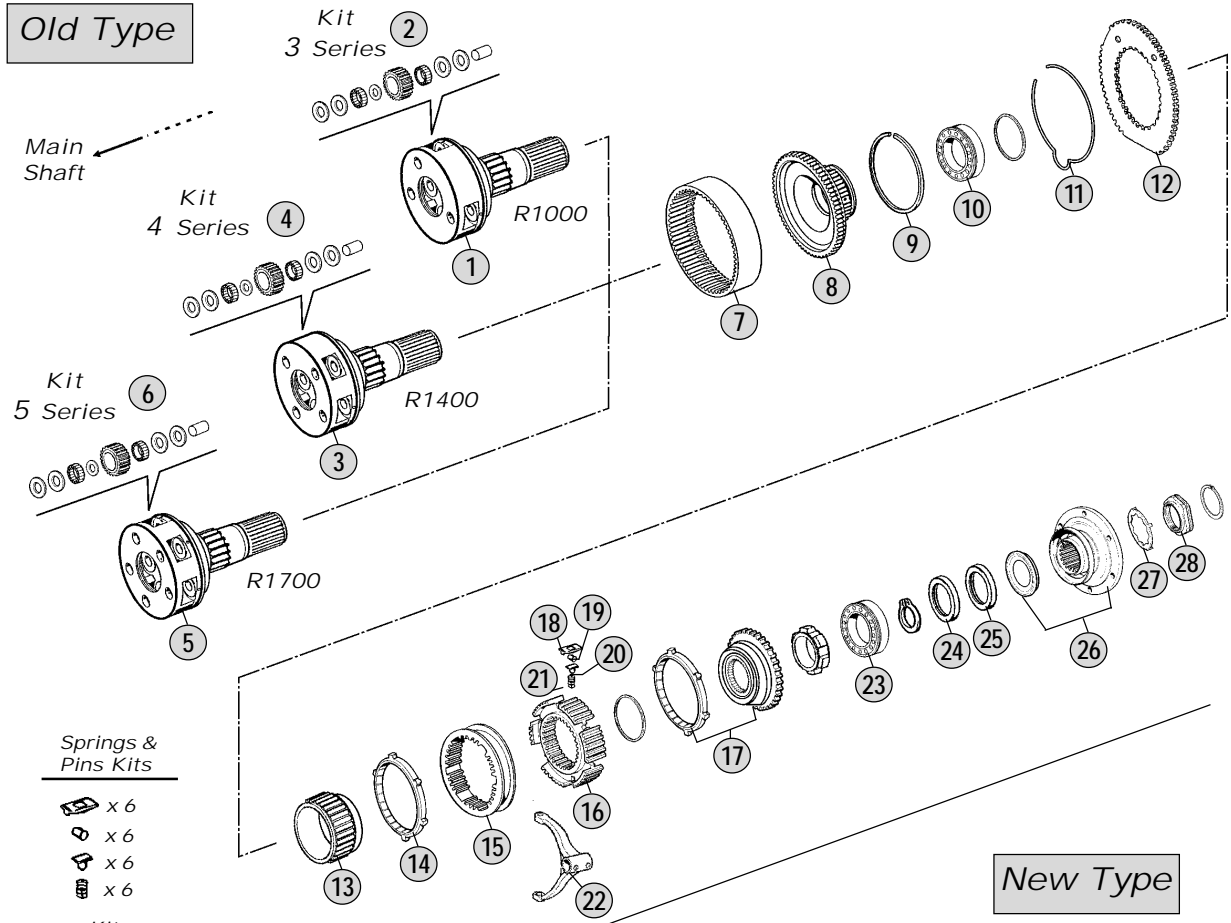

- Springs & Pins Kits**
- x 6
 - x 6
 - x 6
 - Kit 55

New Type

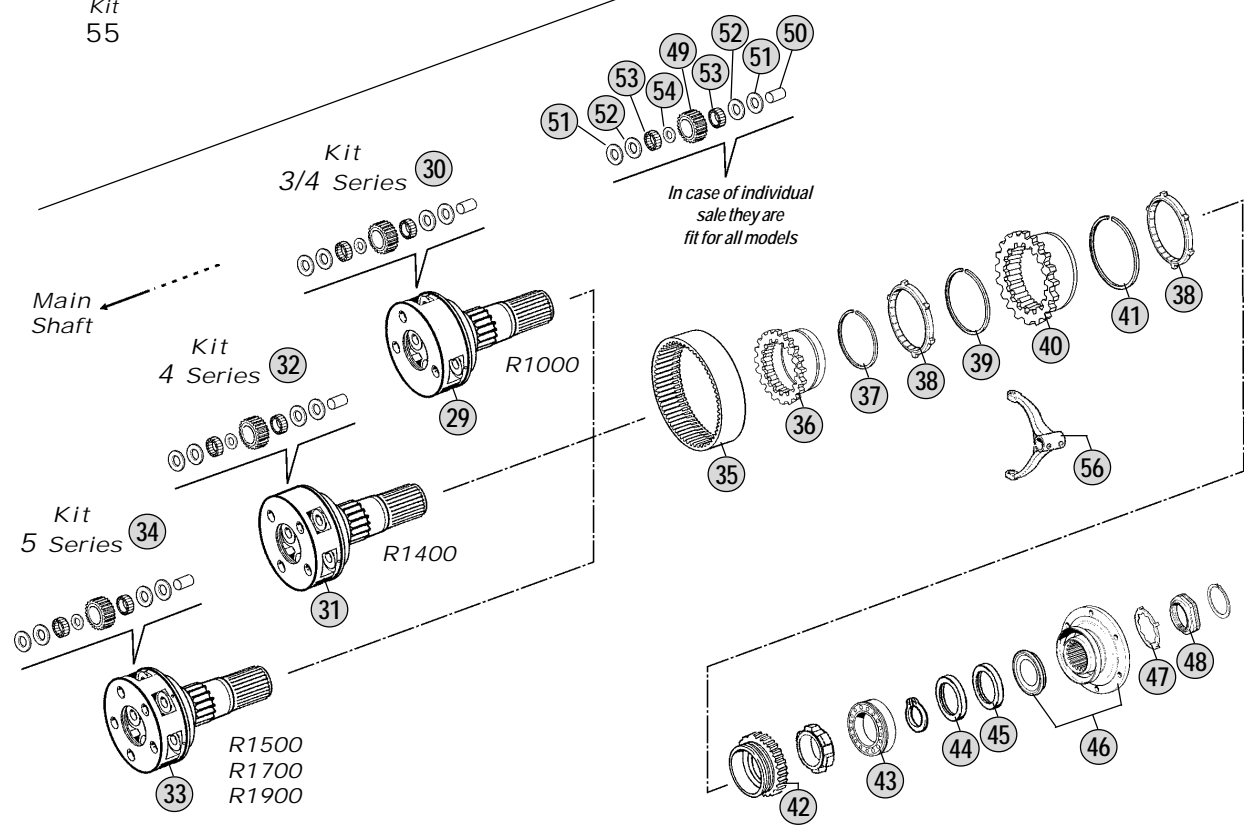

In case of individual sale they are fit for all models

Models

R1000	FL616 - 619 - FL7 - FS7
R1400/1700	FL7 - FM7 - F10 - FL10 - N10 - NL10 - F12 - FH12 - FL12 - FM12 - NH12 - NL12
R1500	FM7 - FM10
R1900	FH12 - FL12 - FM12 - NH12



All original equipment manufacturers' numbers, symbols, pictures, models and description used in this catalogue are for reference only, and it is not implied that any part listed is the product of these manufactures. Tutti i nostri particolari non sono originali ma con essi intercambiabili. I riferimenti originali, le figure, i modelli sono esposti a semplice titolo indicativo. La nostra produzione riporta il nostro marchio.

Fig.	CEI no.	Rif. VOLVO	Description	Q.ty	Note	R1000	R1400	R1500	R1700	R1900
1	190.347	1652282	Planetary carrier	1	Complete	●				
2	198.819	271123	Repair kit	1	3 Series for kit	●				
3	190.343	1652592	Planetary Carrier	1	Complete		●			
4	198.831	270192	Repair Kit	1	4 Serie for kit		●			
5	190.348	1652593	Planetary Carrier	1	Complete				●	
6	198.820	270193	Repair Kit	1	5 Series for kit				●	
7	123.234	1652552	Crown Gear 66 T	1		●	●		●	
8	150.147	1652587	Flange Gear	1		●	●		●	
9	111.215	1652589	Lock Ring	1		●	●		●	
10	130.592	1652600	Bearing	1		●	●		●	
11	111.214	1652177	Lock Ring	1		●	●		●	
12	135.147	1652280	Saddle Plate	1		●	●		●	
13	109.164	1653935	Synchronizer Cone	1		●	●		●	
14	119.124	1653956	Synchronizer Ring	1		●	●		●	
15	154.313	1668248	Sliding Sleeve	1		●	●		●	
15	154.348	1653948	Sliding Sleeve	1	Old-Repl.by 1668248+1668216	●	●		●	
16	155.207	1668216	Synchronizer Hub	1		●	●		●	
17	198.818	1668232	Synchronizer Kit	1		●	●		●	
18	160.203	1653996	Slide	6		●	●		●	
19	160.202	1653900	Pin	6		●	●		●	
20	160.204	1669260	Plunger	6		●	●		●	
21	156.180	1653902	Spring	6		●	●		●	
22	141.167	1652919	Fork	1		●	●		●	
23	130.566	1652604	Bearing 70x140x26	1		●	●		●	
24	139.560	1652776	Oil Seal 90x145x10	1		●	●		●	
25	139.561	1652622	Oil Seal 90x111x6/8	1		●	●	●	●	
26	197.094	1524358	Output Flange D.203	1		●	●		●	
27	169.804	1523318	Thrust Washer	1		●	●		●	
28	187.610	8171334	Grooved Nut	1		●	●		●	
29	190.346	1656297	Planetary carrier	1	Complete-To 276113 (3 Series)	●				
29	190.340	1656299	Planetary Carrier	1	Complete-To 276114 (4 Series)	●				
30	198.832	276113	Repair kit	1	3 Series for kit	●				
30	198.833	276114	Repair Kit	1	4 Series for kit	●				
31	190.340	1656299	Planetary Carrier	1	Complete		●			
31	190.345	1673898	Planetary Carrier	1	Complete-Latest Type		●			
32	198.833	276114	Repair Kit	1	4 Series for kit		●			
33	190.342	1656298	Planetary Carrier	1	Complete				●	●
33	190.344	1673844	Planetary Carrier	1	Complete-Latest Type			●	●	●
34	198.834	276115	Pins/Sides Kit	1	5 Series for kit			●	●	●
35	123.233	1656209	Crown Gear 66 T	1		●	●	●	●	●
36	157.609	1668452	Synchronizer Hub	1		●	●	●	●	●
37	111.213	943760	Lock Ring	1		●	●	●	●	●
38	119.159	1668456	Synchronizer Ring	2		●	●	●	●	●
39	111.211	1668459	Lock Ring	1		●	●	●	●	●
40	150.146	1068946	Carrier Hub GP	1		●	●	●	●	●

Notes

Date

04 / 2012

Table

080/B

Adattabile a: **VOLVO** R1000 - R1400 - R1500 - R1700 - R1900
 Suitable To:

Old Type

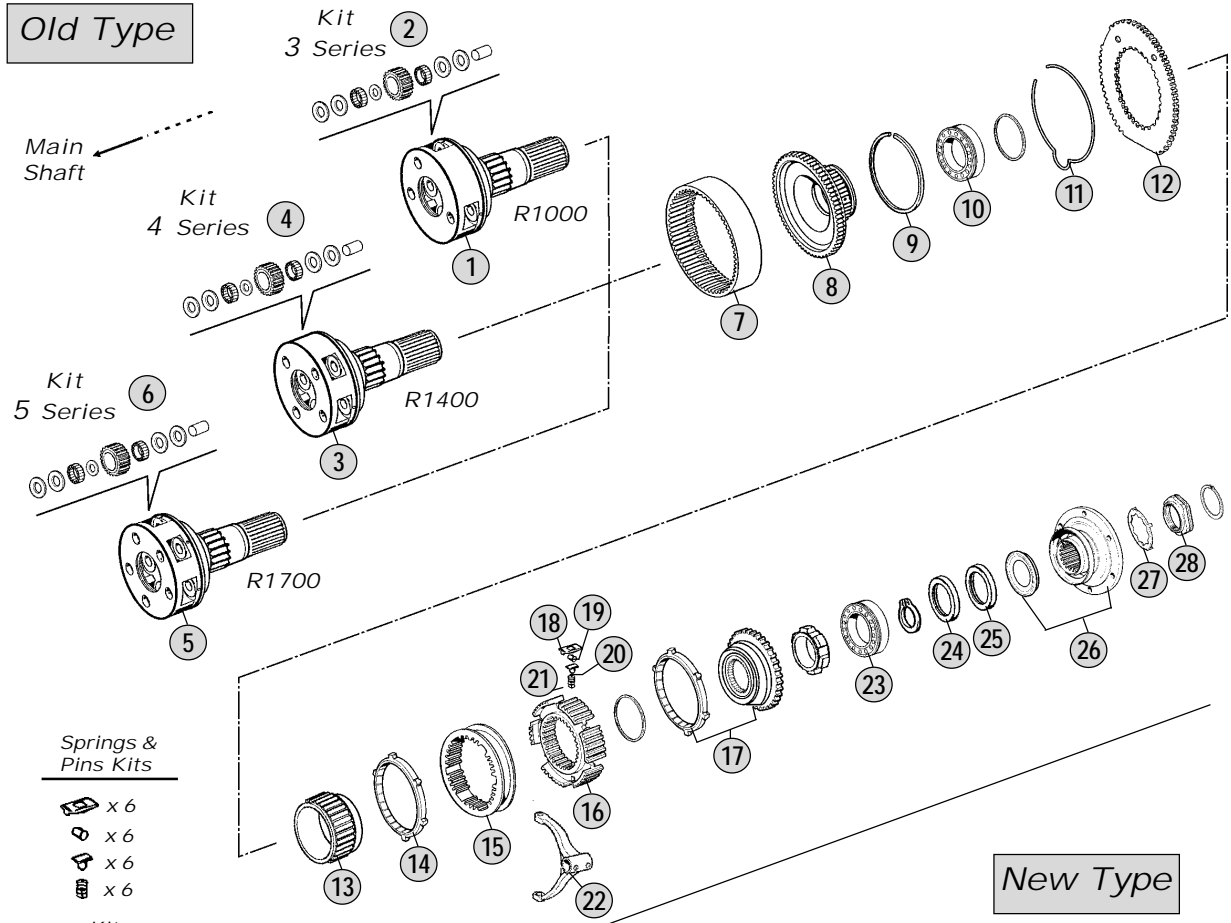

New Type

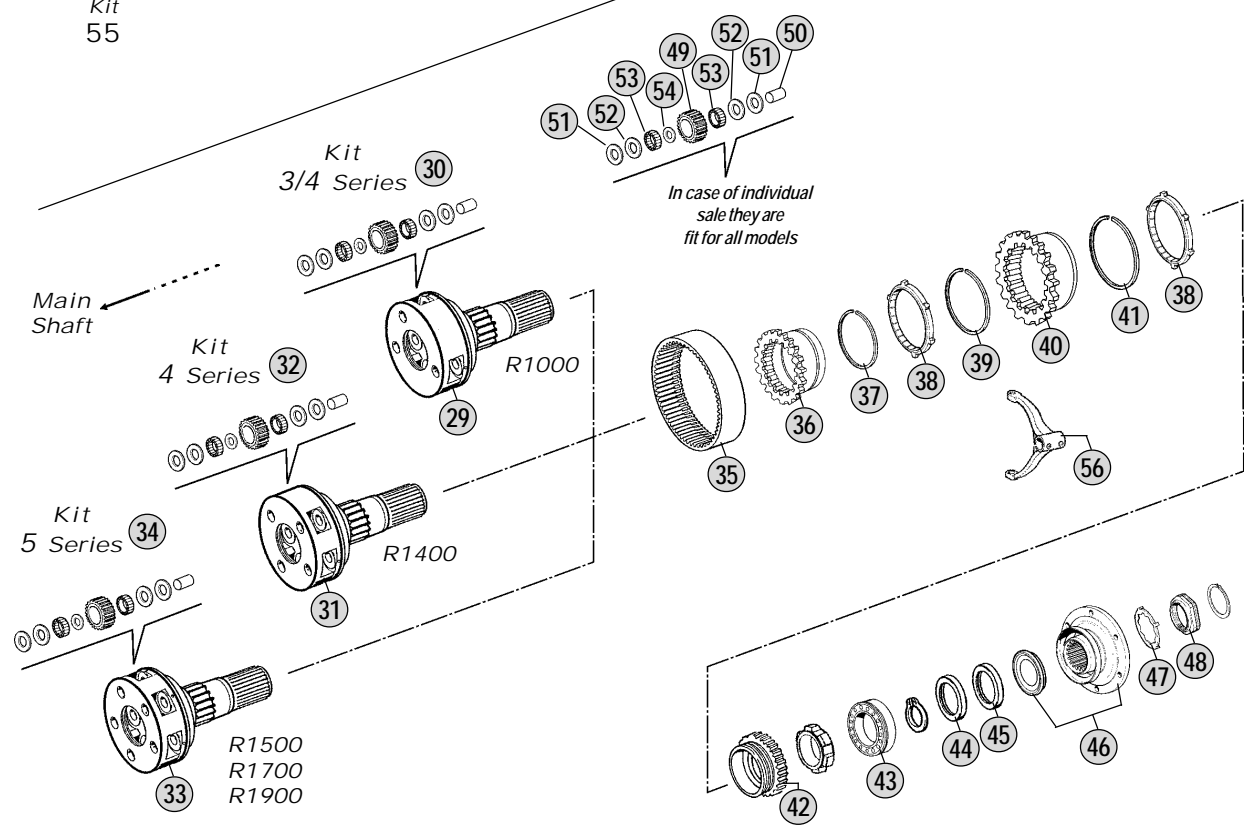

All original equipment manufacturers' numbers, symbols, pictures, models and description used in this catalogue are for reference only, and it is not implied that any part listed is the product of these manufactures. Tutti i nostri particolari non sono originali ma con essi intercambiabili. I riferimenti originali, le figure, i modelli sono esposti a semplice titolo indicativo. La nostra produzione riporta il nostro marchio.

Models

R1000	FL616 - 619 - FL7 - FS7
R1400/1700	FL7 - FM7 - F10 - FL10 - N10 - NL10 - F12 - FH12 - FL12 - FM12 - NH12 - NL12
R1500	FM7 - FM10
R1900	FH12 - FL12 - FM12 - NH12



