

Adattabile a: **VOLVO**
 Suitable To:

Modelli Cambio/ Gearbox Models
 SR1400 - SR1700 - SR1900

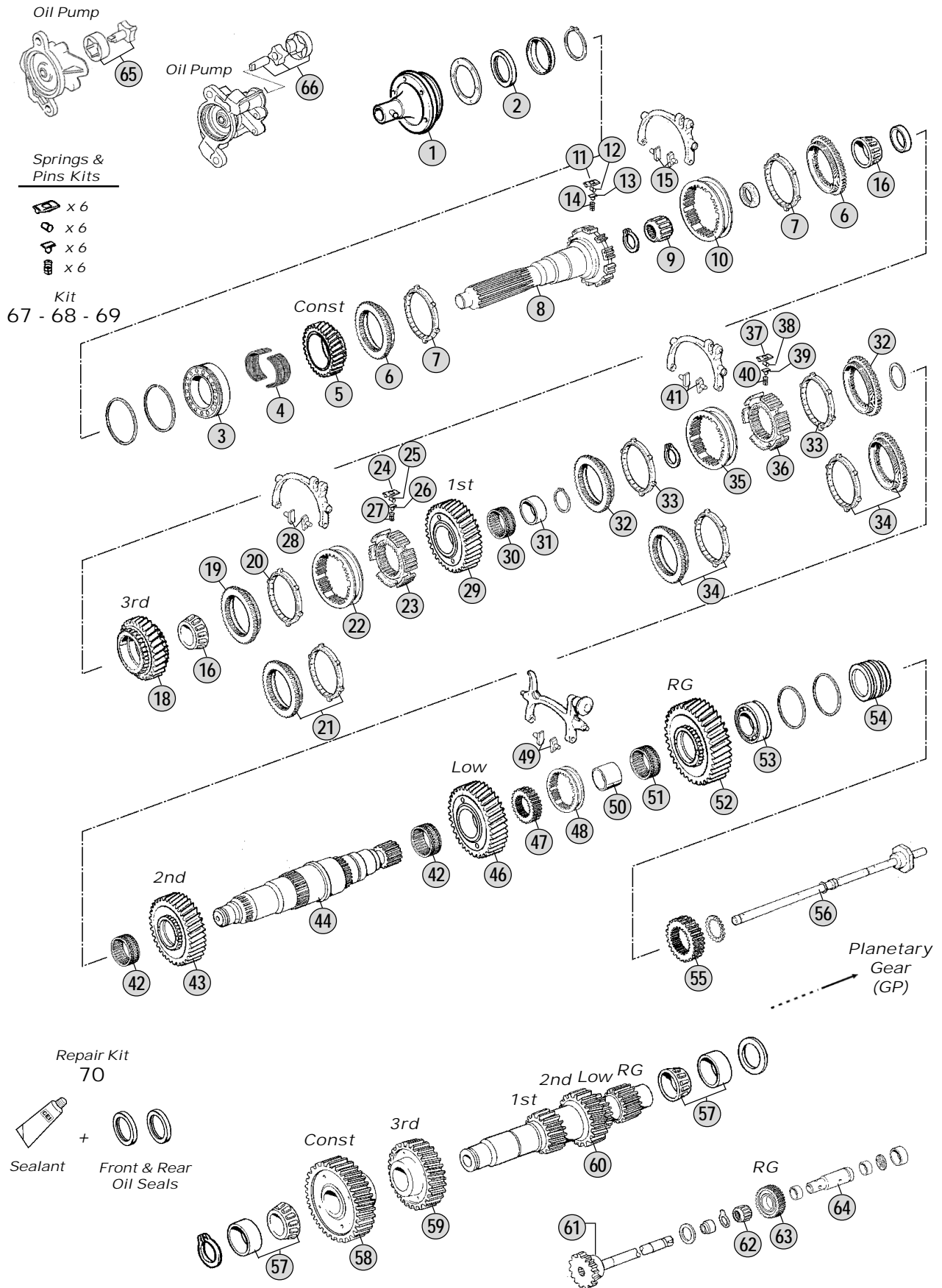

All original equipment manufacturers numbers, symbols, pictures, models and description used in this catalogue are for reference only, and it is not implied that any part listed is the product of these manufactures. Tutti i nostri particolari non sono originali ma con essi intercambiabili. I riferimenti originali, le figure, i modelli sono esposti a semplice titolo indicativo. La nostra produzione riporta il nostro marchio.

Models

SR1400	FL7 - FM7 - F10 - FL10 - N10 - NL10 - F12 - FH12 - FL12 - FM12 - NH12 - NL12
SR1700	FL7 - FM7 - F10 - FL10 - N10 - NL10 - F12 - FH12 - FL12 - FM12 - NH12 - NL12
SR1900	FL7 - FM7 - F10 - FL10 - N10 - NL10 - F12 - FH12 - FL12 - FM12 - NH12 - NL12



Fig.	CEI no.	Rif. VOLVO	Description	Q.ty	Note	SR1400	SR1700	SR1900
1	135.175	1653056	Front Cover	1	(A)	●	●	●
1	135.136	1656121	Front Cover	1	(B)	●	●	●
2	139.391	267268	Oil Seal 65x90x10 B1SL	1		●	●	●
3	130.589	1652553	Bearing	1	(A)	●	●	●
3	130.590	1656129	Bearing 70x150x40	1	(B)	●	●	●
3	530.590	1656129	Bearing 70x150x40	1	(B)	●	●	●
4	137.230	1654088	Needle Bearing 92x100x26,6	1		●	●	●
5	145.560	1653092	Constant Gear 31 T	1		●	●	●
6	109.138	1653921	Synchronizer cone	2		●	●	●
7	119.120	1653961	Synchronizing ring	2		●	●	●
8	102.319	1652521	Input Shaft	1	(A)	●	●	●
8	102.227	1656031	Input Shaft	1	(B)	●	●	●
9	130.593	1652559	Bearing 40x74x29	1	(A)	●	●	●
9	130.594	1656116	Roller Bearing 40x38	1	(B)	●	●	●
10	154.177	1668241	Sliding Sleeve	1		●	●	●
11	160.211	1653991	Slide	6		●	●	●
12	160.212	1653904	Pin 6,50x5,70	6		●	●	●
13	160.201	1668280	Slide	6		●	●	●
14	156.179	1653901	Spring	6		●	●	●
15	141.045	382565	Sliding Block	2		●	●	●
16	137.152	1652611	Roller cage 65x31	2		●	●	●
18	196.262	1693883	Gear Assy 3rd Speed 29 T	1	(Fig.18+Fig.16x2+Spacer)	●	●	●
19	109.139	1653922	Synchronizer cone	1	(C)	●	●	●
20	119.123	1653962	Synchronizer ring	1	(C)	●	●	●
21	198.804	1669358	Synchro kit	1	(D)	●	●	●
22	154.175	1668242	Sliding sleeve	1	(C)	●	●	●
22	154.346	1653942	Sliding Sleeve	1	(C) Old-Repl.by 1668242+1668212	●	●	●
22	154.218	1669032	Sliding sleeve	1	(D)	●	●	●
23	155.208	1668212	Synchronizer hub	1		●	●	●
24	160.208	1653995	Slide	6		●	●	●
25	160.202	1653900	Pin	6		●	●	●
26	160.209	1653983	Slide	6		●	●	●
27	156.179	1653901	Spring	6		●	●	●
28	141.045	382565	Sliding Block	2		●	●	●
29	145.707	1652528	Gear 1st speed 46 T	1	(E) Old Execution	●	●	●
29	145.709	1656064	Gear 1st speed 46 T	1	(E) Old Execution			●
29	145.708	1669656	Gear 1st speed 46 T	1	(F) New Execution	●	●	●
29	145.710	1069318	Gear 1st speed 46 T	1	(G) Latest Execution-Helical Tooth	●	●	●
30	137.218	1652572	Needle Cage	1		●	●	●
31	117.351	1652819	Bush	1		●	●	●
32	109.140	1653925	Synchronizer cone	2	(C)	●	●	●
33	119.124	1653956	Synchronizer Ring	2	(C)	●	●	●
34	198.805	1669359	Synchro kit 1st/2nd Speed	2	(D)	●	●	●
35	154.176	1668245	Sliding sleeve	1	(C)	●	●	●
35	154.347	1653945	Sliding Sleeve	1	(C) Old-Repl.by 1668245+1668214	●	●	●

Notes

(A) SR1400 Up to gearbox 21623 - SR1700 Up to gearbox 46057 - SR1900 Up to gearbox ----
 (B) SR1400 From gearbox 21624 - SR1700 From gearbox 46058 - SR1900 From gearbox ----
 (C) SR1400 Up to gearbox 95041003 - SR1700 Up to gearbox 95041017 - SR1900 Up to gearbox 95042000
 (D) SR1400 From gearbox 95041004 - SR1400 From gearbox 95041018 - SR1900 From gearbox 95042001
 (E-F-G) (E) Old Execution / (F) New Execution / (G) Latest Execution. Helical Tooth
 (Q-R) (Q) Old - Low/Rg speed with Straight Tooth (R) New - Low/Rg speed with Helical Tooth

Date

04 / 2012

Table**090/A**

Adattabile a: **VOLVO**
Suitable To:

Modelli Cambio/ Gearbox Models
SR1400 - SR1700 - SR1900

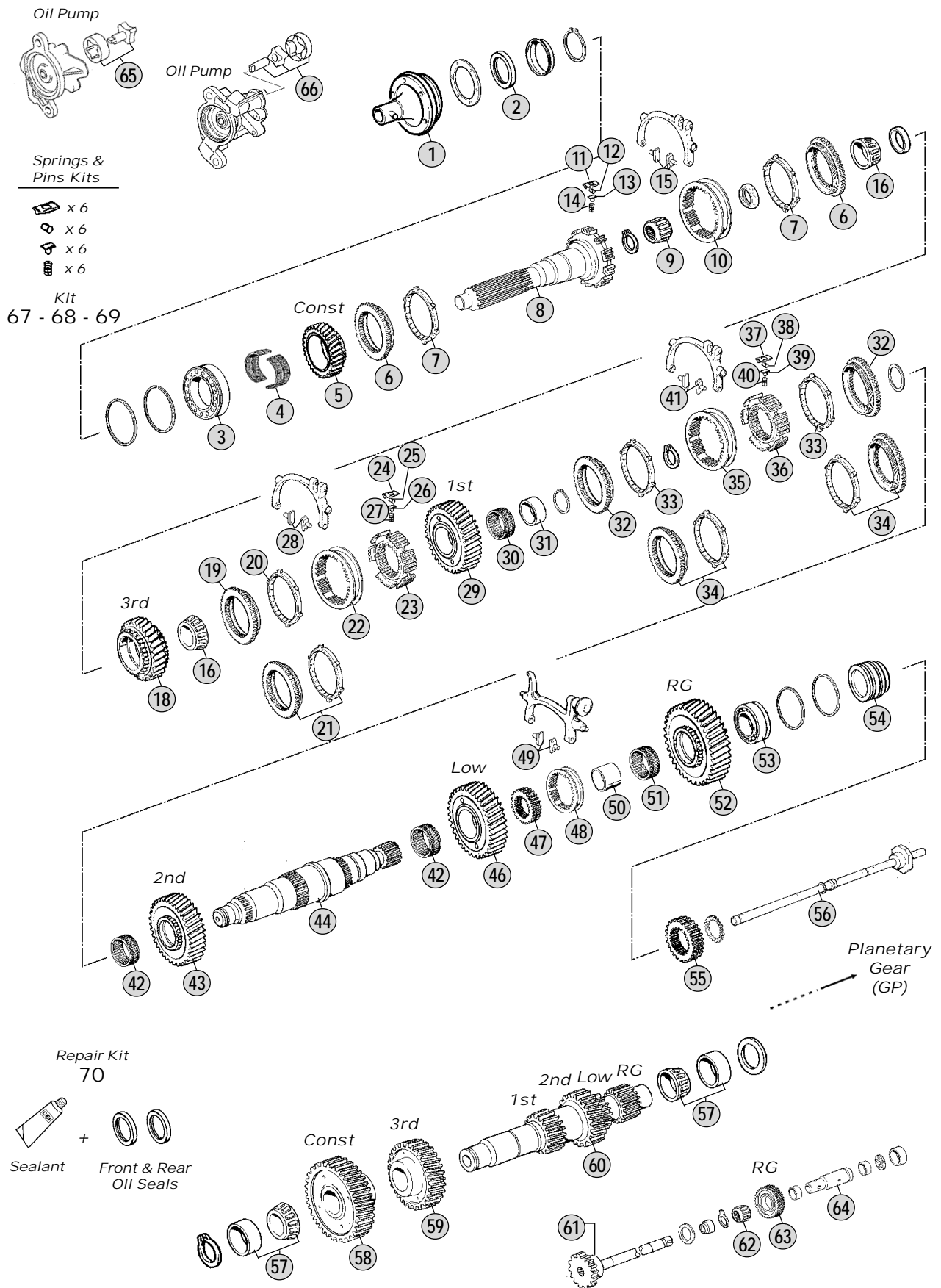

All original equipment manufacturers numbers, symbols, pictures, models and description used in this catalogue are for reference only, and it is not implied that any part listed is the product of these manufactures. Tutti i nostri particolari non sono originali ma con essi intercambiabili. I riferimenti originali, le figure, i modelli sono esposti a semplice titolo indicativo. La nostra produzione riporta il nostro marchio.

Models

- SR1400 FL7 - FM7 - F10 - FL10 - N10 - NL10 - F12 - FH12 - FL12 - FM12 - NH12 - NL12
- SR1700 FL7 - FM7 - F10 - FL10 - N10 - NL10 - F12 - FH12 - FL12 - FM12 - NH12 - NL12
- SR1900 FL7 - FM7 - F10 - FL10 - N10 - NL10 - F12 - FH12 - FL12 - FM12 - NH12 - NL12



Fig.	CEI no.	Rif. VOLVO	Description	Q.ty	Note	SR1400	SR1700	SR1900
35	154.312	1669035	Sliding Sleeve	1	(D)	●	●	●
36	155.172	1668214	Synchronizer Hub	1		●	●	●
37	160.210	1653994	Slide	6		●	●	●
38	160.202	1653900	Pin	6		●	●	●
39	160.201	1668280	Slide	6		●	●	●
40	156.179	1653901	Spring	6		●	●	●
41	141.045	382565	Sliding Block	2		●	●	●
42	137.196	1652575	Needle Cage 90x98x45,50	2		●	●	●
43	145.482	1653376	Gear 2nd Speed 39 T	1		●	●	●
44	103.167	1652524	Main shaft	1	(A)	●	●	●
44	103.166	1668148	Main Shaft	1	(B)	●	●	●
46	145.476	1652617	Gear Low Speed 47 T	1	(Q) Straight Tooth	●	●	●
46	145.704	1673434	Gear Low Speed 38 T	1	(R) Helical Tooth	●	●	●
47	157.679	1652544	Fixed Hub	1	(A)	●	●	●
47	157.184	1656265	Fixed Hub	1	(B) Old Type with Sleeve 1656266	●	●	●
47	157.185	20366731	Fixed Hub	1	(B) New Type with Sleeve 2036682	●	●	●
48	154.193	1652545	Sliding Sleeve	1	(A)	●	●	●
48	154.192	1656266	Sliding Sleeve	1	(B) Old Type with Hub 1656265	●	●	●
48	154.198	20366826	Sliding Sleeve	1	(B) New Type With Hub 20366731	●	●	●
49	141.045	382565	Sliding Block	2		●	●	●
50	117.350	1652578	Bush	1		●	●	●
51	137.196	1652575	Needle Cage 90x98x45,50	1		●	●	●
52	147.129	1652618	Reverse Gear 43 T	1	(Q) Straight Tooth	●	●	●
52	147.192	1673432	Reverse Gear 34 T	1	(R) Helical Tooth	●	●	●
53	130.589	1652553	Bearing	1	(A)	●	●	●
53	130.590	1656129	Bearing 70x150x40	1	(B)	●	●	●
54	117.347	1652548	Spacer	1	(A)	●	●	●
54	117.348	1656232	Spacer	1	(B)	●	●	●
55	157.643	1652550	Sun Gear 24 T	1	(A)	●	●	●
55	157.610	1656226	Sun Gear 24 T	1	(B)	●	●	●
56	188.187	1652682	Oil Tube	1	(A)	●	●	●
56	188.186	1656264	Oil Tube	1	(B)	●	●	●
57	130.565	1652563	Bearing Cone 110x60x39,50	2		●	●	●
58	146.482	1669804	Constant Gear 44 T	1		●	●	●
59	146.483	1653088	Gear 3rd speed 33 T	1		●	●	●
60	105.152	1652901	Countershaft 22/29/15/15 T	1	(E)(Q)	●	●	
60	105.153	1656038	Countershaft	1	(E)(Q)			●
60	105.154	1669652	Countershaft 22/29/15/15 T	1	(F)(Q)	●	●	●
60	105.155	1673442	Countershaft	1	(F)(R)	●	●	
60	105.157	1673445	Countershaft 22/22/12/12 T	1	(F)(R)			●
60	105.156	1069315	Countershaft 22/29/12/12 T	1	(G)(R)	●	●	
61	107.184	3192123	Reverse Shaft	1		●	●	●
62	137.229	1652581	Needle Cage 42x50x60	1		●	●	●
63	147.194	1652539	Reverse Gear 24 T	1	(Q) Straight Tooth	●	●	●
63	147.195	1521423	Reverse Gear 20 T	1	(R) Helical Tooth	●	●	●

Notes

(A) SR1400 Up to gearbox 21623 - SR1700 Up to gearbox 46057 - SR1900 Up to gearbox ----
 (B) SR1400 From gearbox 21624 - SR1700 From gearbox 46058 - SR1900 From gearbox ----
 (C) SR1400 Up to gearbox 95041003 - SR1700 Up to gearbox 95041017 - SR1900 Up to gearbox 95042000
 (D) SR1400 From gearbox 95041004 - SR1400 From gearbox 95041018 - SR1900 From gearbox 95042001
 (E-F-G) (E) Old Execution / (F) New Execution / (G) Latest Execution. Helical Tooth
 (Q-R) (Q) Old - Low/Rg speed with Straight Tooth (R) New - Low/Rg speed with Helical Tooth

Date

04 / 2012

Table**090/A**

Adattabile a: **VOLVO**
 Suitable To:

Modelli Cambio/ Gearbox Models
 SR1400 - SR1700 - SR1900

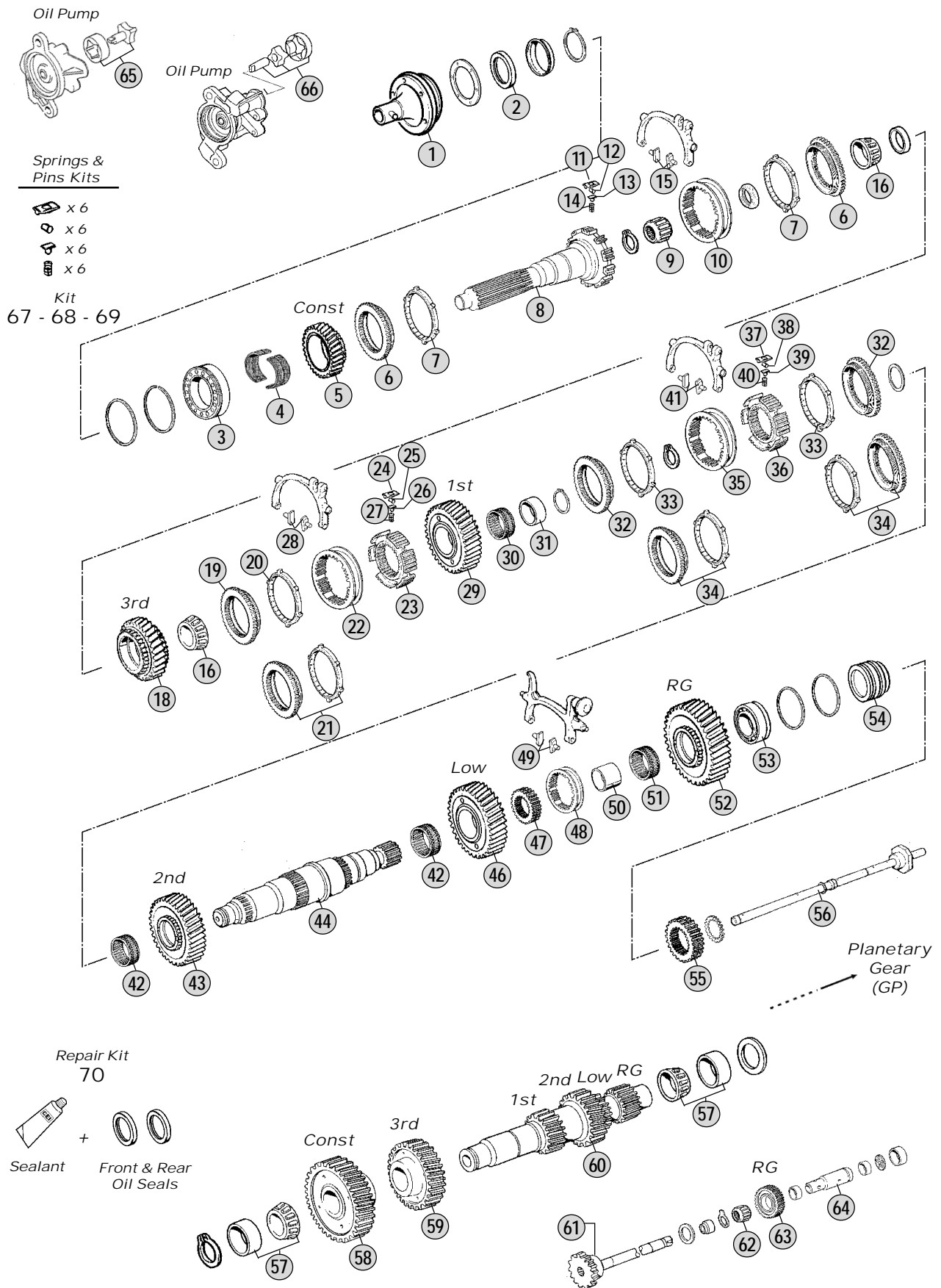

All original equipment manufacturers numbers, symbols, pictures, models and description used in this catalogue are for reference only, and it is not implied that any part listed is the product of these manufactures. Tutti i nostri particolari non sono originali ma con essi intercambiabili. I riferimenti originali, le figure, i modelli sono esposti a semplice titolo indicativo. La nostra produzione riporta il nostro marchio.

Models

- SR1400 FL7 - FM7 - F10 - FL10 - N10 - NL10 - F12 - FH12 - FL12 - FM12 - NH12 - NL12
- SR1700 FL7 - FM7 - F10 - FL10 - N10 - NL10 - F12 - FH12 - FL12 - FM12 - NH12 - NL12
- SR1900 FL7 - FM7 - F10 - FL10 - N10 - NL10 - F12 - FH12 - FL12 - FM12 - NH12 - NL12



Adattabile a: **VOLVO**
 Suitable To:

Modelli Cambio/ Gearbox Models
 SR1400 - SR1700 - SR1900

Old Type

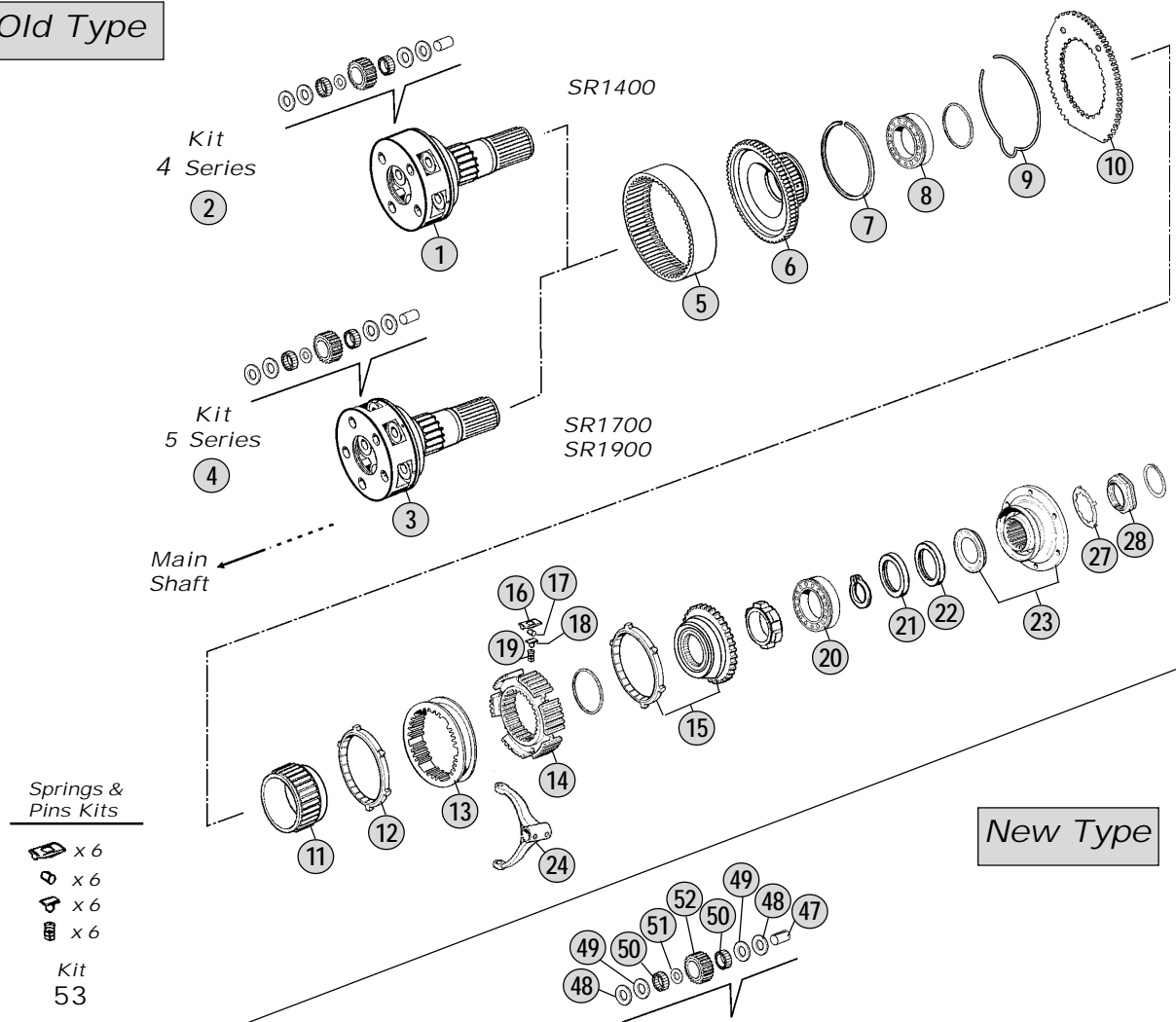

New Type

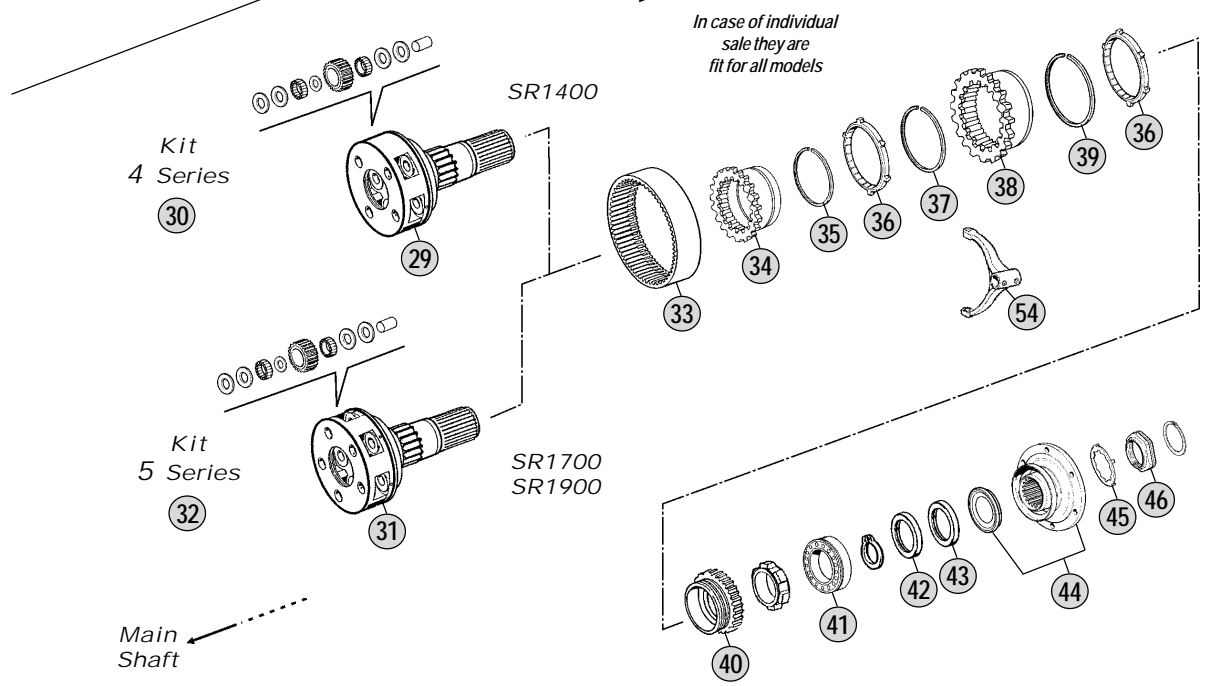

Models

SR1400	FL7 - FM7 - F10 - FL10 - N10 - NL10 - F12 - FH12 - FL12 - FM12 - NH12 - NL12
SR1700	FL7 - FM7 - F10 - FL10 - N10 - NL10 - F12 - FH12 - FL12 - FM12 - NH12 - NL12
SR1900	FL7 - FM7 - F10 - FL10 - N10 - NL10 - F12 - FH12 - FL12 - FM12 - NH12 - NL12



All original equipment manufacturers' numbers, symbols, models and description used in this catalogue are for reference only, and it is not implied that any part listed is the product of these manufacturers. Tutti i nostri particolari non sono originali ma con essi intercambiabili. I riferimenti originali, le figure, i modelli sono esposti a semplice titolo indicativo. La nostra produzione riporta il nostro marchio.

Fig.	CEI no.	Rif. VOLVO	Description	Q.ty	Note	SR1400	SR1700	SR1900
1	190.343	1652592	Planetary Carrier	1	Complete	●		
2	198.831	270192	Repair Kit	1	4 Series for kit	●		
3	190.348	1652593	Planetary Carrier	1	Complete		●	●
4	198.820	270193	Repair Kit	1	5 Series for kit		●	●
5	123.234	1652552	Crown Gear 66 T	1		●	●	●
6	150.147	1652587	Flange Gear	1		●	●	●
7	111.215	1652589	Lock Ring	1		●	●	●
8	130.592	1652600	Bearing	1		●	●	●
9	111.214	1652177	Lock Ring	1		●	●	●
10	135.147	1652280	Saddle Plate	1		●	●	●
11	109.164	1653935	Synchronizer Cone	1		●	●	●
12	119.124	1653956	Synchronizer Ring	1		●	●	●
13	154.313	1668248	Sliding Sleeve	1		●	●	●
13	154.348	1653948	Sliding Sleeve	1	Old-Repl.by 1668248+1668216	●	●	●
14	155.207	1668216	Synchronizer Hub	1		●	●	●
15	198.818	1668232	Synchronizer Kit	1		●	●	●
16	160.203	1653996	Slide	6		●	●	●
17	160.202	1653900	Pin	6		●	●	●
18	160.204	1669260	Plunger	6		●	●	●
19	156.180	1653902	Spring	6		●	●	●
20	130.566	1652604	Bearing 70x140x26	1		●	●	●
21	139.560	1652776	Oil Seal 90x145x10	1		●	●	●
22	139.561	1652622	Oil Seal 90x111x6/8	1		●	●	●
23	197.094	1524358	Output Flange D.203	1		●	●	●
24	141.167	1652919	Fork	1		●	●	●
27	169.804	1523318	Thrust Washer	1		●	●	●
28	187.610	8171334	Grooved Nut	1		●	●	●
29	190.340	1656299	Planetary Carrier	1	Complete	●		
29	190.345	1673898	Planetary Carrier	1	Complete-Latest Type	●		
30	198.833	276114	Repair Kit	1	4 Series for kit	●		
31	190.342	1656298	Planetary Carrier	1	Complete		●	●
31	190.344	1673844	Planetary Carrier	1	Complete-Latest Type		●	●
32	198.834	276115	Pins/Sides Kit	1	5 Series for kit		●	●
33	123.233	1656209	Crown Gear 66 T	1		●	●	●
34	157.609	1668452	Hub	1		●	●	●
35	111.213	943760	Lock Ring	1		●	●	●
36	119.159	1668456	Synchronizer Ring	2		●	●	●
37	111.211	1668459	Lock Ring	1		●	●	●
38	150.146	1068946	Carrier Hub GP	1		●	●	●
39	111.212	8171420	Lock Ring	1		●	●	●
40	109.185	1668450	Synchronizer Cone	1		●	●	●
41	130.566	1652604	Bearing 70x140x26	1		●	●	●
42	139.560	1652776	Oil Seal 90x145x10	1		●	●	●
43	139.561	1652622	Oil Seal 90x111x6/8	1		●	●	●
44	197.094	1524358	Output Flange D.203	1		●	●	●

Notes

Date

04 / 2012

Table

Adattabile a: **VOLVO**
 Suitable To:

Modelli Cambio/ Gearbox Models
 SR1400 - SR1700 - SR1900

Old Type

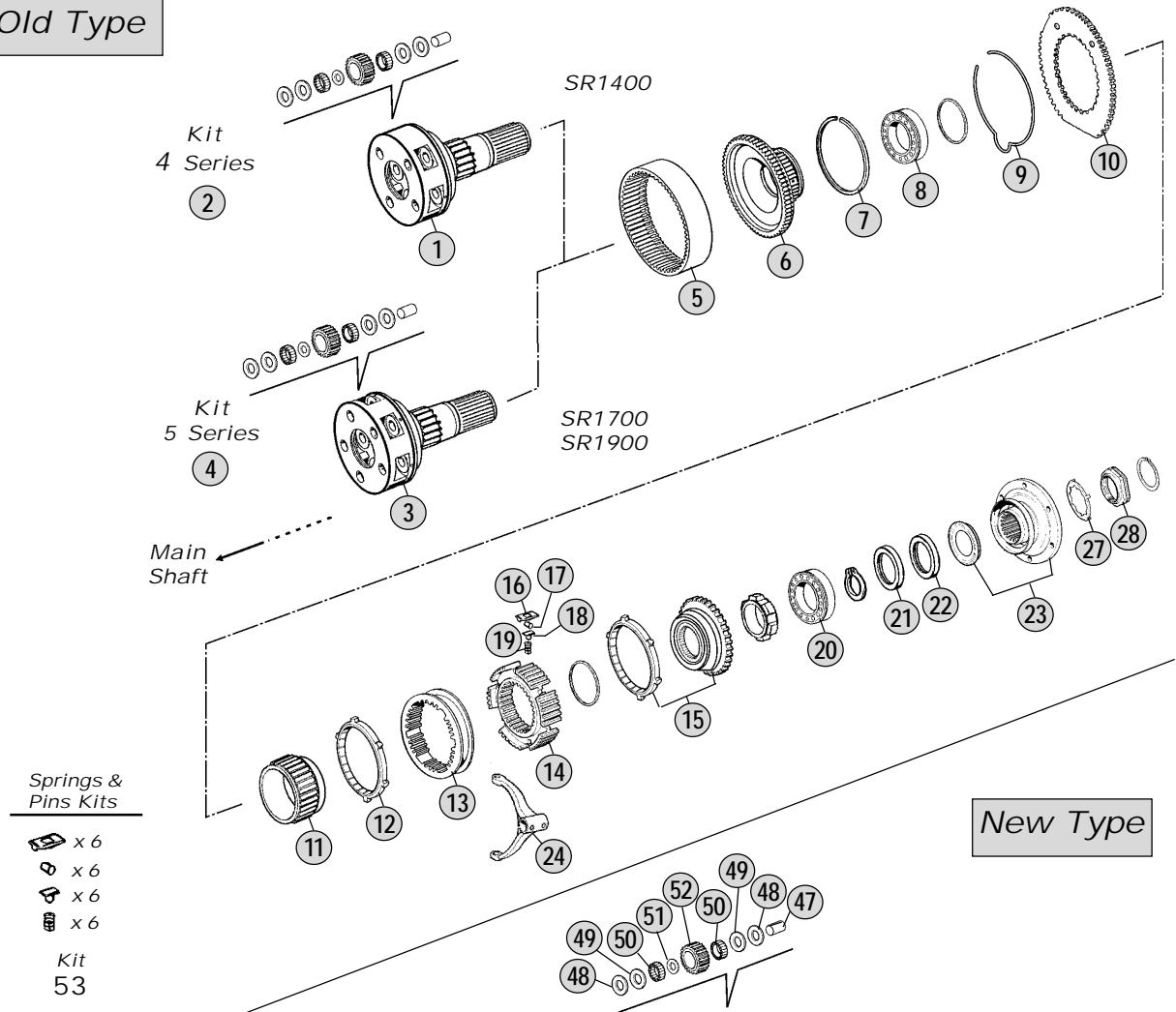

New Type

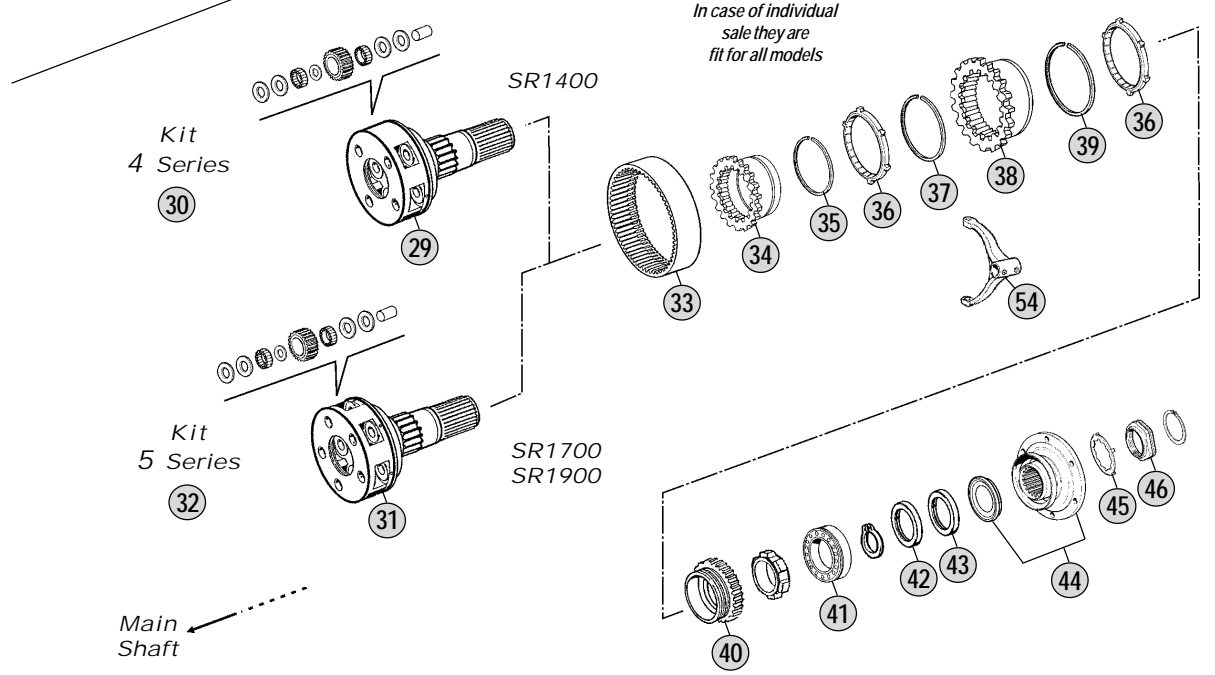

Models

SR1400	FL7 - FM7 - F10 - FL10 - N10 - NL10 - F12 - FH12 - FL12 - FM12 - NH12 - NL12
SR1700	FL7 - FM7 - F10 - FL10 - N10 - NL10 - F12 - FH12 - FL12 - FM12 - NH12 - NL12
SR1900	FL7 - FM7 - F10 - FL10 - N10 - NL10 - F12 - FH12 - FL12 - FM12 - NH12 - NL12



All original equipment manufacturers' numbers, symbols, models and description used in this catalogue are for reference only, and it is not implied that any part listed is the product of these manufactures. Tutti i nostri particolari non sono originali ma con essi intercambiabili. I riferimenti originali, le figure, i modelli sono esposti a semplice titolo indicativo. La nostra produzione riporta il nostro marchio.

Fig.	CEI no.	Rif. VOLVO	Description	Q.ty	Note	SR1400	SR1700	SR1900
44	197.126	8172618	Output Flange	1	Latest Type	●	●	●
45	169.804	1523318	Thrust Washer	1		●	●	●
46	187.610	8171334	Grooved Nut	1		●	●	●
46	187.613	8171338	Grooved Nut	1	Latest Type	●	●	●
47	107.169	1654054	Planetary Pin	1	Use 4 or 5 pcs.	●	●	●
48	169.780	8171167	Washer 33,5x61x1 (Bronze)	1	Use 8 or 10 pcs.	●	●	●
49	169.779	8171165	Washer 33,5x61x1 (Steel)	1	Use 8 or 10 pcs.	●	●	●
50	171.051	1656113	Needle 6x18,80	1	Use 160 or 200 pcs.	●	●	●
51	169.781	267375	Spacer 36x44x2	1	Use 4 or 5 pcs.	●	●	●
52	157.216	1656208	Planet Pinion 19 T	1	Use 4 or 5 pcs.	●	●	●
53	198.895	CEI 198895	Pins/Springs Kit	1		●	●	●
54	141.167	1652919	Fork	1		●	●	●

All original equipment manufacturer's numbers, symbols, pictures, models and description used in this catalogue are for reference only, and it is not implied that any part listed is the product of these manufacturers.
 Tutti i nostri particolari non sono originali ma con essi intercambiabili. I riferimenti originali, le figure, i modelli sono esposti a semplice titolo indicativo. La nostra produzione riporta il nostro marchio.

Notes _____ Date _____



04 / 2012

Table _____

090/B