

Adattabile a: **VOLVO** SR2000 - SRO2000 - SR2400 - SRO2400
 Suitable To:

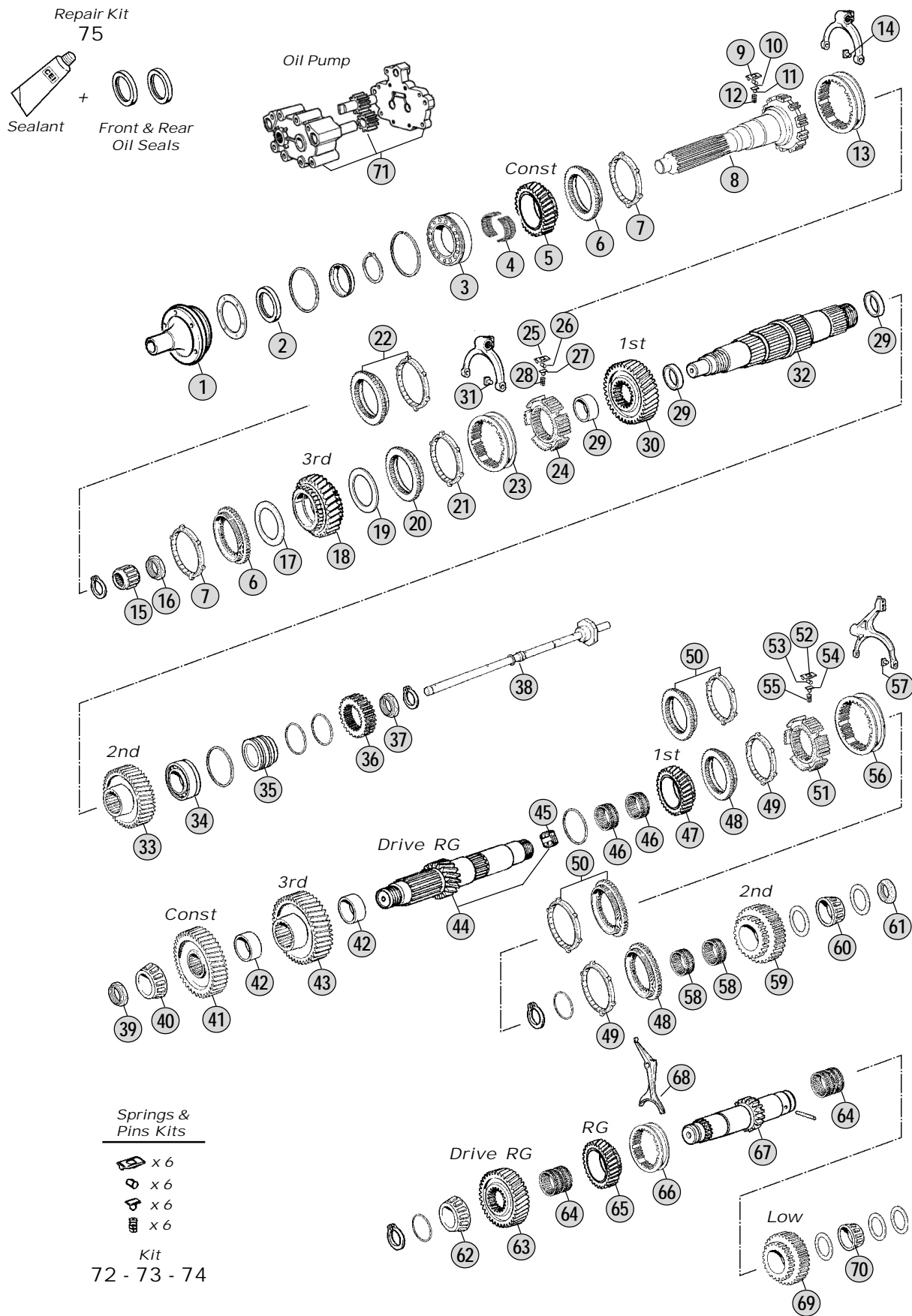

All original equipment manufacturers' numbers, symbols, models and description used in this catalogue are for reference only, and it is not implied that any part listed is the product of these manufactures. Tutti i nostri particolari non sono originali ma con essi intercambiabili. I riferimenti originali, le figure, i modelli sono esposti a semplice titolo indicativo. La nostra produzione riporta il nostro marchio.

Models

SR2000	F16 - FH16
SRO2000	F16 - FH16
SR2400	F16 - FH16
SRO2400	F16 - FH16



Fig.	CEI no.	Rif. VOLVO	Description	Q.ty	Note	SR2000	SRO2000	SR2400	SRO2400
1	135.176	1654090	Front Cover	1		●	●	●	●
2	139.391	267268	Oil Seal 65x90x10 B1SL	1		●	●	●	●
3	130.589	1652553	Bearing	1		●	●	●	●
4	137.230	1654088	Needle Bearing 92x100x26,6	1		●	●	●	●
5	145.776	1654290	Constant Gear	1	Old Repl.by1669496+1669497	●	●	●	●
5	145.777	1669496	Constant Gear 27 T	1		●	●	●	●
5	145.559	1654362	Constant Gear 35 T	1		●	●	●	●
6	109.138	1653921	Synchronizer cone	2		●	●	●	●
7	119.120	1653961	Synchronizing ring	2		●	●	●	●
8	102.255	1654015	Input Shaft 48 T	1		●	●	●	●
9	160.211	1653991	Slide	6		●	●	●	●
10	160.212	1653904	Pin 6,50x5,70	6		●	●	●	●
11	160.201	1668280	Slide	6		●	●	●	●
12	156.179	1653901	Spring	6		●	●	●	●
13	154.177	1668241	Sliding Sleeve	1		●	●	●	●
14	141.045	382565	Sliding Block	2		●	●	●	●
15	130.593	1652559	Bearing 40x74x29	1		●	●	●	●
16	187.678	1652855	Nut	1		●	●	●	●
17	169.974	1653061	Washer	1		●	●	●	●
18	146.479	1069518	Gear 3rd Speed 27 T	1		●	●	●	●
19	169.975	1654195	Washer	1		●	●	●	●
20	109.139	1653922	Synchronizer cone	1	(A)	●	●	●	●
21	119.123	1653962	Synchronizer ring	1	(A)	●	●	●	●
22	198.804	1669358	Synchro kit	1	(B)	●	●	●	●
23	154.175	1668242	Sliding sleeve	1	(A)	●	●	●	●
23	154.346	1653942	Sliding Sleeve	1	(A) Old Repl.by 1668242+1668219	●	●	●	●
23	154.218	1669032	Sliding sleeve	1	(B)	●	●	●	●
24	155.209	1668219	Synchronizer hub	1		●	●	●	●
25	160.208	1653995	Slide	6		●	●	●	●
26	160.202	1653900	Pin	6		●	●	●	●
27	160.209	1653983	Slide	6		●	●	●	●
28	156.179	1653901	Spring	6		●	●	●	●
29	117.375	1654253	Bush	3		●	●	●	●
30	145.778	1669328	Gear 1st Speed 39 T	1		●	●	●	●
31	141.045	382565	Sliding Block	2		●	●	●	●
32	103.181	1654020	Main Shaft	1		●	●	●	●
33	145.779	1669498	Gear 2nd Speed 33 T	1		●	●	●	●
34	130.675	1654070	Bearing	1		●	●	●	●
35	169.976	1654255	Spacer	1	(C)	●	●	●	●
35	169.977	1669427	Spacer	1	(D)	●	●	●	●
36	157.680	1654218	Sun Gear	1	(C)	●	●	●	●
36	157.681	1669449	Sun Gear 28 T	1	(D)	●	●	●	●
37	187.678	1652855	Nut	1		●	●	●	●
38	188.202	1654266	Oil Tube	1	(C)	●	●	●	●
38	188.203	1669447	Oil Tube	1	(D)	●	●	●	●

Notes

- (A) Up to gearbox 95041000 - Use items marked (A) together
 (B) From gearbox 95041001 - Use items marked (B) together
 (C) Old Type - Use items marked (C) together
 (D) New Type - Use items marked (D) together

Date

04 / 2012

Table

100A

Adattabile a: **VOLVO** SR2000 - SRO2000 - SR2400 - SRO2400
 Suitable To:

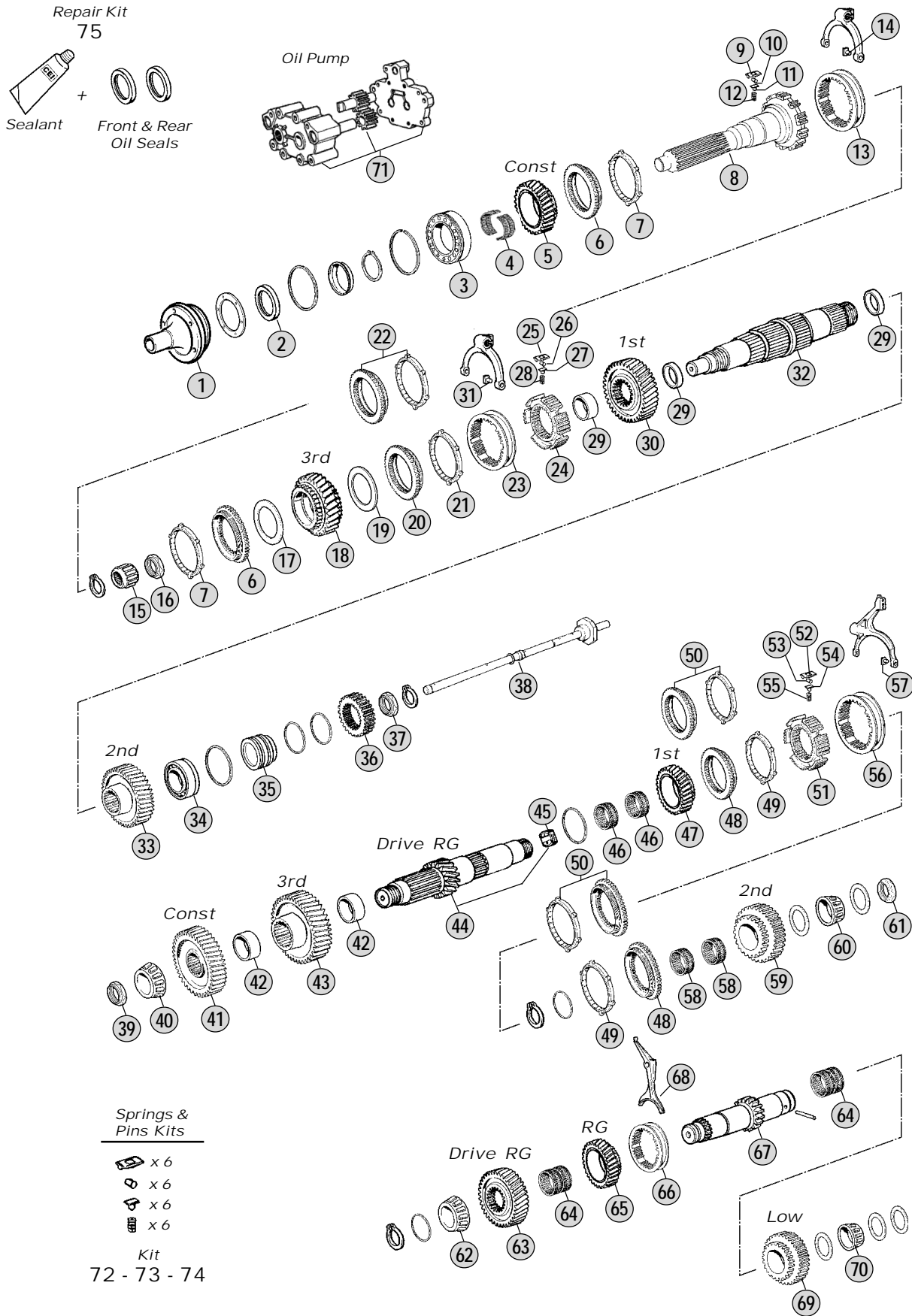

All original equipment manufacturers' numbers, symbols, models and description used in this catalogue are for reference only, and it is not implied that any part listed is the product of these manufactures. Tutti i nostri particolari non sono originali ma con essi intercambiabili. I riferimenti originali, le figure, i modelli sono esposti a semplice titolo indicativo. La nostra produzione riporta il nostro marchio.

Models

SR2000	F16 - FH16
SRO2000	F16 - FH16
SR2400	F16 - FH16
SRO2400	F16 - FH16



Fig.	CEI no.	Rif. VOLVO	Description	Q.ty	Note	SR2000	SRO2000	SR2400	SRO2400
39	187.678	1652855	Nut	1		●	●	●	●
40	130.676	1654326	Bearing	1		●	●	●	●
41	146.556	1654293	Constant Gear	1	Old Repl.by 1669497+1669496	●	●	●	●
41	146.557	1669497	Constant Gear 41 T	1		●	●	●	●
41	146.480	1654363	Constant Gear 34 T	1		●	●	●	●
42	117.375	1654253	Bush	2		●	●	●	●
43	146.481	1669331	Gear 3rd Speed 33 T	1		●	●	●	●
44	105.176	1654038	Countershaft 17 T	1		●	●	●	●
45	160.225	1526614	Pin	1		●	●	●	●
46	137.243	1654073	Needle Cage	2		●	●	●	●
47	146.558	1669329	Gear 1st Speed 21 T	1		●	●	●	●
48	109.357	1653923	Synchronizer cone	2	(A)	●	●	●	●
49	119.123	1653962	Synchronizer ring	2	(A)	●	●	●	●
50	198.890	1669361	Synchro kit 1st-2nd Speed	2	(B)	●	●	●	●
51	155.171	1668213	Synchronizer Hub	1		●	●	●	●
52	160.203	1653996	Slide	6		●	●	●	●
53	160.202	1653900	Pin	6		●	●	●	●
54	160.201	1668280	Slide	6		●	●	●	●
55	156.179	1653901	Spring	6		●	●	●	●
56	154.314	1668243	Sliding sleeve	1	(A)	●	●	●	●
56	154.349	1653943	Sliding Sleeve	1	(A) Old Repl.by 1668243+1668213	●	●	●	●
56	154.315	1669033	Sliding sleeve	1	(B)	●	●	●	●
57	141.045	382565	Sliding Block	2		●	●	●	●
58	137.244	1654085	Needle Cage	2		●	●	●	●
59	146.559	1654037	Gear 2nd Speed 27 T	1		●	●	●	●
60	130.677	20901349	Bearing Cone	1		●	●	●	●
61	187.679	1654251	Nut	1		●	●	●	●
62	130.678	1654323	Bearing	1		●	●	●	●
63	147.214	1654295	Reverse Gear	1		●	●	●	●
64	137.245	1654076	Needle Cage	2		●	●	●	●
65	147.215	1654042	Reverse Gear	1		●	●	●	●
66	157.225	266961	Sliding Sleeve	1		●	●	●	●
67	107.194	1654040	Reverse Shaft	1		●	●	●	●
68	141.187	267892	Reverse Fork	1		●	●	●	●
69	146.560	1654043	Gear	1		●	●	●	●
70	130.678	1654323	Bearing	1		●	●	●	●
71	280.619	1655249	Oil Pump	1	Assy	●	●	●	●
72	198.896	CEI 198896	Plunger/spring-Kit	1	(Fig.9+Fig.10+Fig.11+Fig.12)	●	●	●	●
73	198.897	CEI 198897	Plunger/spring-Kit	1	(Fig.25+Fig.26+Fig.27+Fig.28)	●	●	●	●
74	198.899	CEI 198899	Plunger/spring-Kit	1	(Fig.52+Fig.53+Fig.54+Fig.55)	●	●	●	●
75	198.894	CEI 198894	Sealant and Oil Seals Kit	1		●	●	●	●

Notes

- (A) Up to gearbox 95041000 - Use items marked (A) together
 (B) From gearbox 95041001 - Use items marked (B) together
 (C) Old Type - Use items marked (C) together
 (D) New Type - Use items marked (D) together

Date

04 / 2012



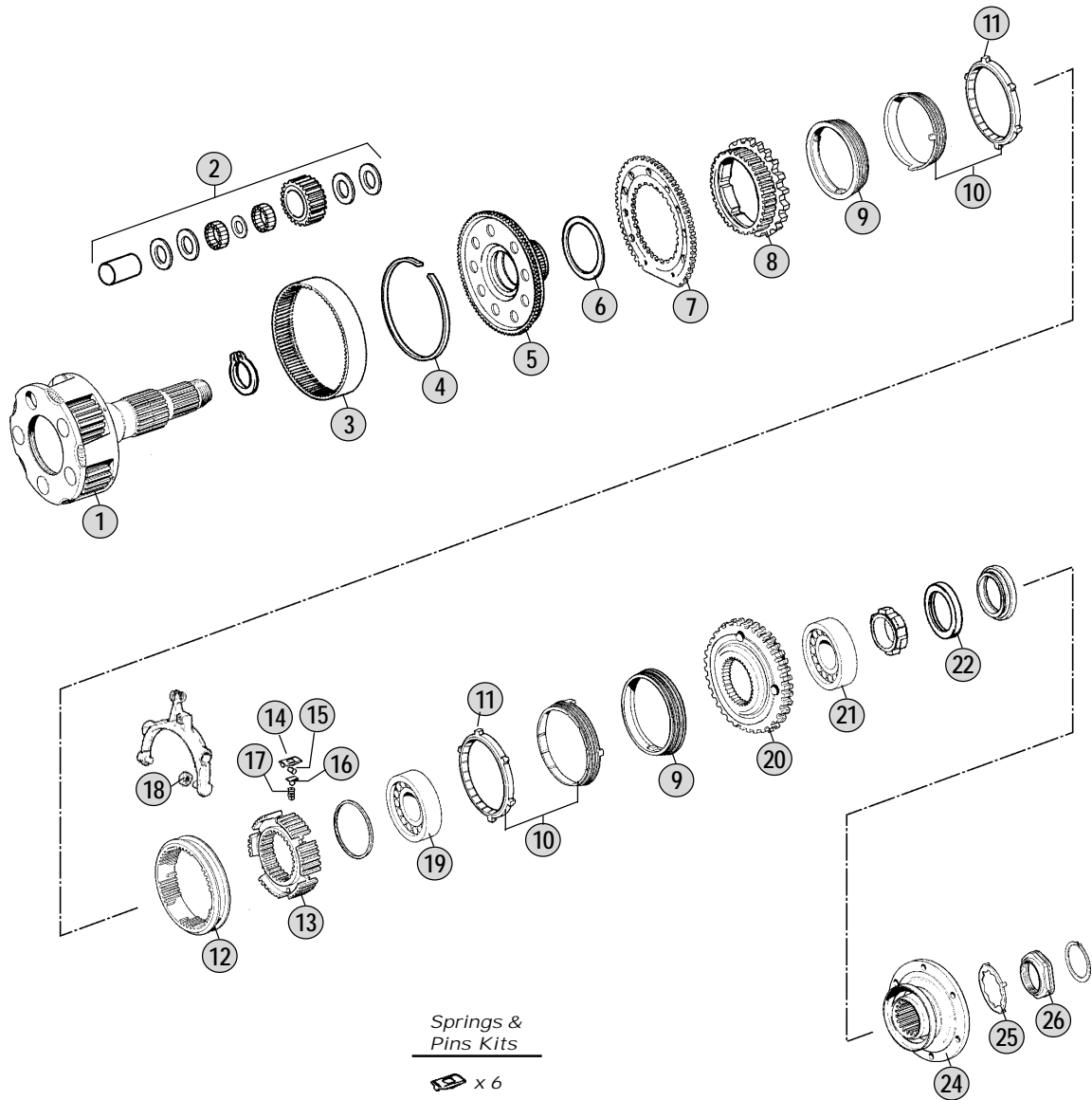

Table

100/A

Adattabile a : **VOLVO** SR2000 - SRO2000 - SR2400 - SRO2400
 Suitable To :



Springs & Pins Kits

-  x 6
-  x 6
-  x 6
-  x 6

Kit
27

Models

SR2000	F16 - FH16
SRO2000	F16 - FH16
SR2400	F16 - FH16
SRO2400	F16 - FH16

All original equipment manufacturers' numbers, symbols and description used in this catalogue are for reference only, and it is not implied that any part listed is the product of these manufactures. Tutti i nostri particolari non sono originali ma con essi intercambiabili. I riferimenti originali, le figure, i modelli sono esposti a semplice titolo indicativo. La nostra produzione riporta il nostro marchio.

Fig.	CEI no.	Rif. VOLVO	Description	Q.ty	Note	SR2000	SRO2000	SR2400	SRO2400
1	190.360	1654050	Planetary Carrier	1	Empty-W/out Retarder	●	●	●	●
1	190.361	1654345	Planetary Carrier	1	Complete-With Retarder	●	●	●	●
2	198.835	276819	Repair Kit	1	(1) Only for Models W/out Retarder	●	●	●	●
3	123.259	1654061	Crown Gear	1		●	●	●	●
4	111.212	8171420	Lock Ring	1		●	●	●	●
5	150.159	1654060	Flange Gear	1		●	●	●	●
6	169.978	949909	Washer	1		●	●	●	●
7	135.177	1654066	Saddle Plate	1		●	●	●	●
8	109.358	1653938	Synchronizer Cone	1		●	●	●	●
9	119.190	1653979	Synchronizer Ring Outer	2		●	●	●	●
10	119.191	1668231	Synchronizer Ring Intermediate	2		●	●	●	●
11	119.124	1653956	Synchronizer Ring	2		●	●	●	●
12	154.316	1668247	Sliding Sleeve	1		●	●	●	●
13	155.210	1668217	Synchronizer Hub	1		●	●	●	●
14	160.213	1653997	Slide	6		●	●	●	●
15	160.202	1653900	Pin	6		●	●	●	●
16	160.204	1669260	Plunger	6		●	●	●	●
17	156.180	1653902	Spring	6		●	●	●	●
18	160.226	1652616	Slide	2		●	●	●	●
19	130.679	1654082	Bearing	1		●	●	●	●
20	109.359	1653937	Synchronizer Cone	1		●	●	●	●
21	130.680	184413	Bearing 85x150x28	1		●	●	●	●
22	139.561	1652622	Oil Seal 90x111x6/8	1		●	●	●	●
24	197.094	1524358	Output Flange D.203	1		●	●	●	●
25	169.804	1523318	Thrust Washer	1		●	●	●	●
26	187.610	8171334	Grooved Nut	1		●	●	●	●
27	198.900	CEI 198900	Pins/Springs Kit	1		●	●	●	●

Notes

- (1) 5 Series per Kit .
 This repair kit **CANNOT** be used with 1654345 (Suitable only for Retarder Models)
 For Retarder Models use complete Planetary carrier.

Date

04 / 2012

Table

100/B