

Adattabile a : **VOLVO**  
 Suitable To :

Modelli Cambio/ Gearbox Models  
**6S-1000 (ATO1056)**

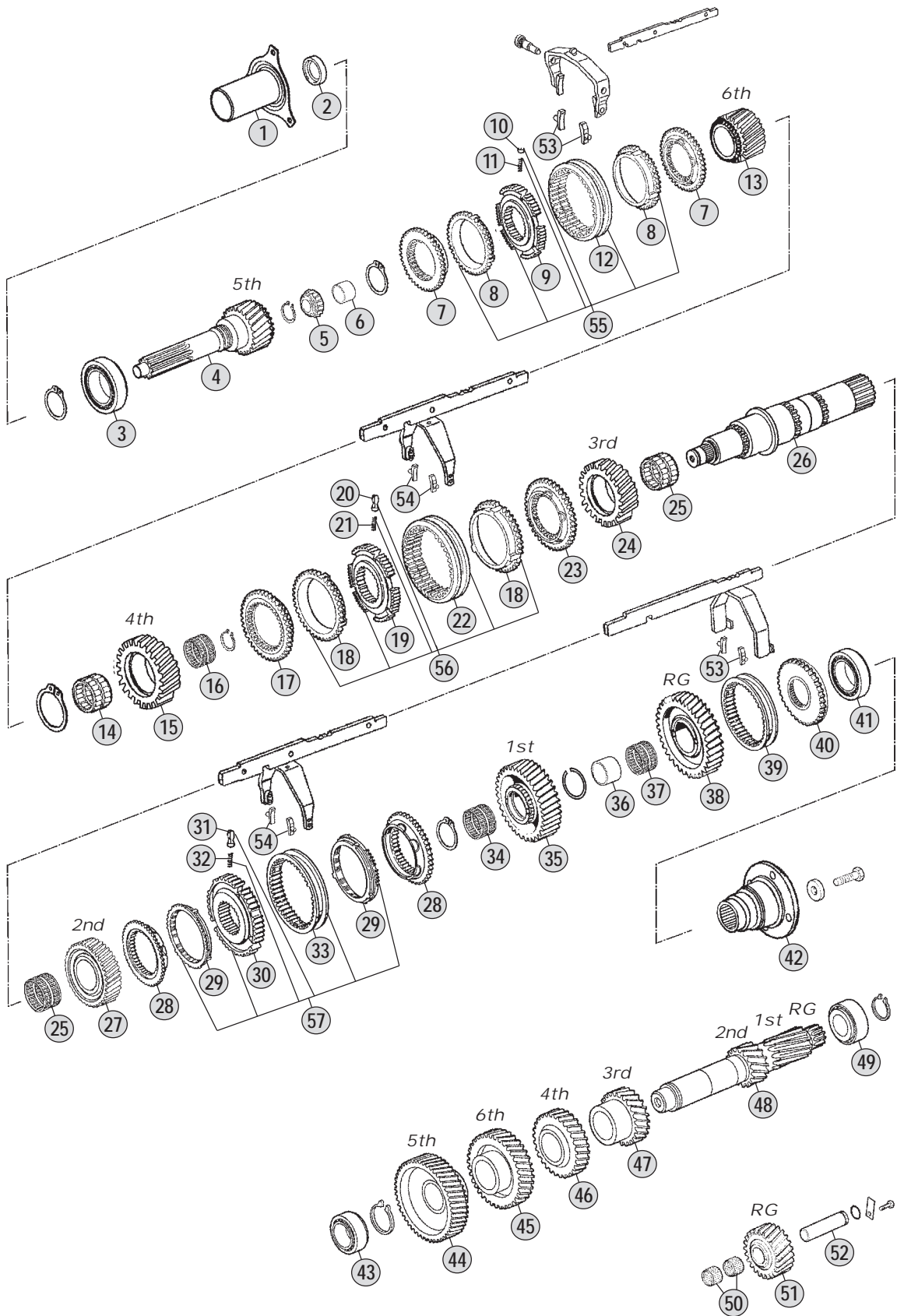

All original equipment manufacturers' numbers, symbols, pictures, models and description used in this catalogue are for reference only, and it is not implied that any part listed is the product of these manufactures. Tutti i nostri particolari non sono originali ma con essi intercambiabili. I riferimenti originali, le figure, i modelli sono esposti a semplice titolo indicativo. La nostra produzione riporta il nostro marchio.

**Models**

6S-1000 : 6,75 - 0,78

Fig.	CEI no.	O.E.M. Reference		Description	Q.ty	Note	6S-1000				
		ZF no.	VOLVO no.								
1	128.259	1346 302 056	21095434	Front Cover	1		●				
2	269.633	21095435	21095435	Washer	1		●				
3	130.937	0735 330 801	21095915	Roller Bearing	1		●				
4	102.542	1346 302 047		Input Shaft	1		●				
5	130.940	0735 358 346	21094173	Bearing	1		●				
6	117.467	0735 295 223	20921789	Bush	1		●				
7	109.796	1346 304 047		Synchronizer Cone	2		●				
8	119.266	1317 304 150		Synchronizer Ring	2		●				
9	157.740	1290 304 586		Synchronizer Hub	1		●				
10	188.231	1317 304 081		Pressure Piece	3		●				
11	156.195	0732 042 510		Spring De.5x22,5	3		●				
12	154.440	1333 304 061		Sliding Sleeve	1		●				
13	244.168	1346 304 048	20916527	Gear 6th Speed	1		●				
14	137.370	0735 321 588	20916622	Needle Cage	1		●				
15	244.169	1346 304 099	21093710	Gear 4th Speed	1		●				
16	130.939	0735 371 994	21094007	Bearing	1		●				
17	109.799	1346 304 093		Synchronizer Cone	1		●				
18	119.142	1268 304 594	20910593	Synchronizer Ring	2		●				
19	157.739	1346 304 025	20920392	Synchronizer Hub	1		●				
20	160.189	1297 304 436	20853449	Pressure Piece	3		●				
21	156.140	0732 040 409	20853453	Spring De.6,5x23,50	3		●				
22	154.371	1310 304 195	20966249	Sliding Sleeve	1		●				
23	109.795	1346 304 094	21094162	Synchronizer Cone	1		●				
24	244.170	1346 304 102	21093703	Gear 3rd Speed	1		●				
25	130.940	0735 358 346	21094173	Bearing	2		●				
26	103.273	1346 304 107	21093719	Main Shaft	1		●				
27	244.171	1346 304 011	20916525	Gear 2nd Speed	1		●				
28	109.795	1346 304 094	21094162	Synchronizer Cone	2		●				
29	119.142	1268 304 594	20910593	Synchronizer Ring	2		●				
30	157.767	1346 304 026	20920393	Synchronizer Hub	1		●				
31	160.189	1297 304 436	20853449	Pressure Piece	3		●				
32	156.140	0732 040 409	20853453	Spring De.6,5x23,50	3		●				
33	154.484	1290 304 383	20917183	Sliding Sleeve	1		●				
34	137.307	0735 321 529		Needle Cage	1		●				
35	244.172	1346 304 115	21094166	Gear 1st Speed	1		●				
36	117.468	0735 295 239		Bush	1		●				
37	137.307	0735 321 529		Needle Cage	1		●				
38	147.294	1346 304 045	21149306	Reverse Gear 20 T	1		●				
39	154.364	1308 304 087	3094540	Sliding Sleeve	1		●				
40	109.844	1346 304 119	21116263	Synchronizer Cone	1		●				
41	130.938	0735 330 799	21093713	Bearing	1		●				
42	197.228	1346 304 086	20919210	Output Flange	1		●				
43	130.939	0735 371 994	21094007	Bearing	1		●				
44	146.745	1346 303 034	20916523	Gear 5th Speed	1		●				
45	146.746	1346 303 033	20916522	Gear 6th Speed	1		●				

Notes

Date

04 / 2012

Table

Adattabile a : **VOLVO**  
 Suitable To :

Modelli Cambio/ Gearbox Models  
**6S-1000 (ATO1056)**

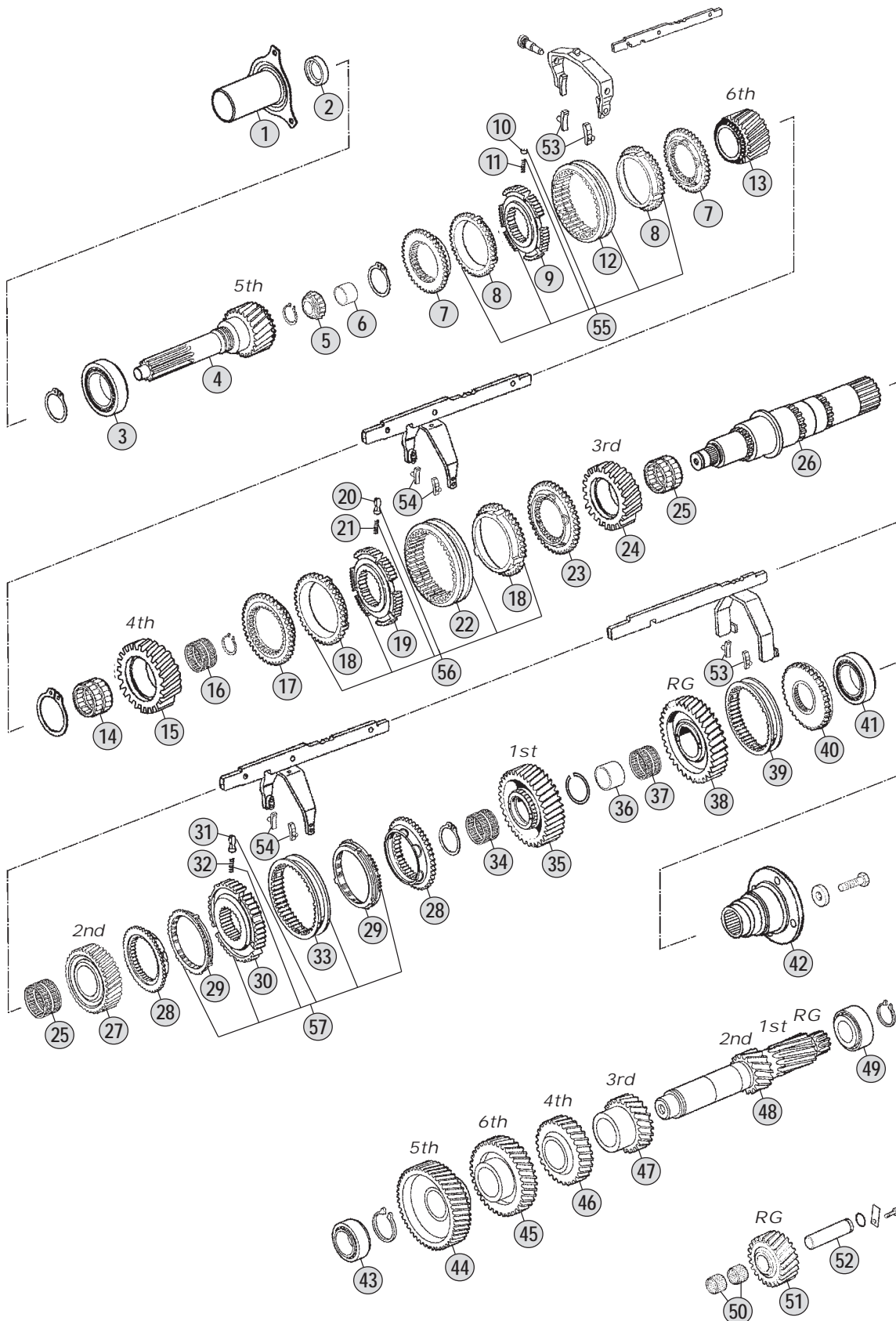

All original equipment manufacturers' numbers, symbols, pictures, models and description used in this catalogue are for reference only, and it is not implied that any part listed is the product of these manufactures. Tutti i nostri particolari non sono originali ma con essi intercambiabili. I riferimenti originali, le figure, i modelli sono esposti a semplice titolo indicativo. La nostra produzione riporta il nostro marchio.

**Models**

6S-1000 : 6,75 - 0,78



