

**MODELS:**

- ECOLITE

**VERSIONS:**

- S6-85 (1310 xxx xxx)

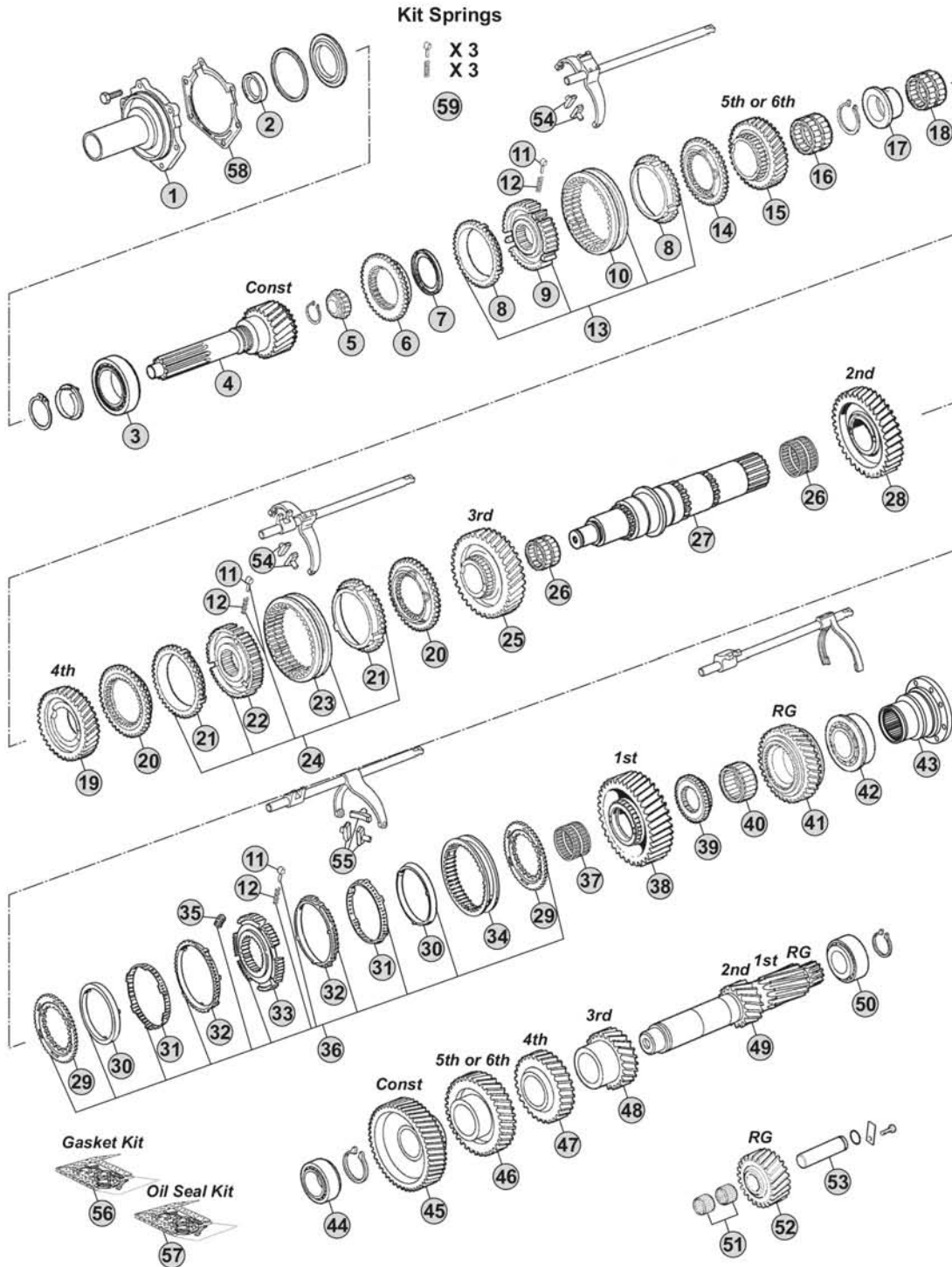

Our spare parts are not the originals but interchangeable with the originals ones. All original equipment manufacturers' numbers, pictures and models used in this catalogue are for reference only. Our products bear our trade-mark.

**Notes**

(A) R. 6,75-0,83

(B) R. 7,72-1,00

Our spare parts are not the originals but interchangeable with the originals ones. All original equipment manufacturers' numbers, pictures and models used in this catalogue are for reference only. Our products bear our trade-mark.

Fig.	CEI no.	ZF no.	Description	Q.ty	Notes	56-85				
1	128.277	1311 302 033	Front cover	1	(A)	●				
1	128.275	1310 302 016	Front cover	1	(B)	●				
1	128.356	1310 302 029	Front cover	1	(B)	●				
2	139.753	0750 111 149	Oil Seal 48x65x10	1		●				
3	130.704	0750 117 347	Bearing 70x115x29	1		●				
4	102.672	1310 302 007	Input shaft 29 T	1	(20) (A)	●				
4	102.387	1310 302 001	Input Shaft 29 T	1	(21) (A)	●				
4	102.673	1310 302 020	Input Shaft Z 29	1	(21) (A)	●				
4	102.388	1310 302 025	Input Shaft 29 T	1	(21) (A)	●				
4	102.391	1310 302 022	Input Shaft 27 T	1	(B)	●				
4	102.390	1310 302 026	Input Shaft 27 T	1	(B)	●				
5	130.951	0750 117 562	Needle Bearing 28x32	1	(20) (A)	●				
5	130.951	0750 117 562	Needle Bearing 28x32	1	(21) (A)	●				
5	130.951	0750 117 562	Needle Bearing 28x32	1	(B)	●				
6	109.857	1311 302 022	Synchronizer Cone	1	(20) (A)	●				
6	109.400	1310 302 023	Synchronizer Cone	1	(21) (A)	●				
6	109.401	1310 302 024	Synchronizer Cone	1	(B)	●				
7	189.608	0501 311 146	Diaphragm 60x74,8x4,7	1	(20) (A)	●				
7	269.011	0501 313 171	Diaphragm	1	(21) (A)	●				
7	269.011	0501 313 171	Diaphragm	1	(B)	●				
8	119.219	1311 304 076	Synchronizer Ring	2	Old Type	●				
8	119.220	1311 304 255	Synchronizer Ring	2	New Type	●				
9	157.706	1311 304 226	Synchronizer Hub	1		●				
10	154.363	1304 304 664	Sliding Sleeve	1		●				
11	160.189	1297 304 436	Pressure Piece	3	3x3 pcs.	●				
12	156.140	0732 040 409	Spring De.6,5x23,50	3	3x3 pcs.	●				
13		1311 204 022	Synchro Kit	1		●				
14	109.402	1311 304 009	Synchronizer Cone	1		●				
15	244.235	1310 304 061	Gear 6th Speed 23 T	1	(20) (A)	●				
15	145.886	1310 304 091	Gear 6th Speed 23 T	1	(21) (A)	●				
15	145.887	1310 304 092	Gear 5th Speed 26 T	1	(B)	●				
16	137.269	0735 321 678	Needle Cage 52x60x23	1		●				
17	117.384	1311 304 124	Bush	1		●				
18	137.078	0735 320 493	Needle Cage 70x78x36,50	1		●				
19	244.236	1310 304 047	Gear 4th Speed 29 T	1	(20) (A)	●				
19	145.888	1310 304 088	Gear 4th Speed 29 T	1	(21) (A)	●				
19	145.889	1310 304 093	Gear 4th Speed 30 T	1	(B)	●				
20	109.392	1311 304 015	Synchronizer Cone	2	(20) (A)	●				
20	109.134	1312 304 027	Synchronizer Cone	2	(21) (A)	●				
20	109.134	1312 304 027	Synchronizer Cone	2	(B)	●				
21	119.118	1268 304 445	Synchronizer Ring	2	(20) (A) Old Type	●				
21	119.142	1268 304 594	Synchronizer Ring	2	(20) (A) New Type	●				
21	119.119	1297 304 402	Synchronizer Ring	2	(21) (A) New Type	●				

 ECOLITE  
S6-85

Date

04/2015

Notes

(20) To be coupled together  
(21) To be coupled together

**MODELS:**

- ECOLITE

**VERSIONS:**

- S6-85 (1310 xxx xxx)

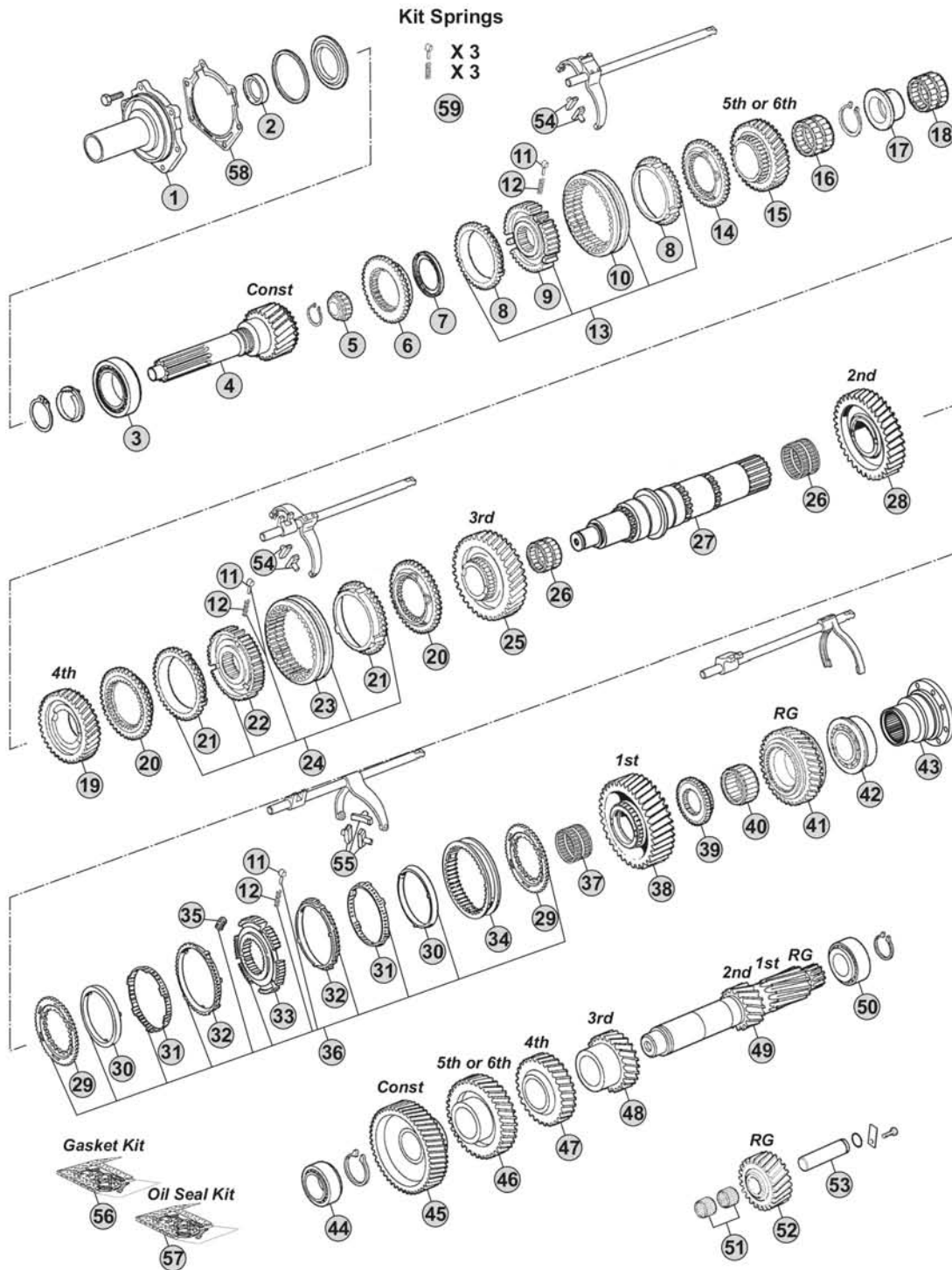

**Notes**

(A) R. 6,75-0,83

(B) R. 7,72-1,00

Our spare parts are not the originals but interchangeable with the originals ones. All original equipment manufacturers' numbers, pictures and models used in this catalogue are for reference only. Our products bear our trade-mark.

Fig.	CEI no.	ZF no.	Description	Q.ty	Notes	56-85				
21	119.167	1297 304 484	Synchronizer Ring	2	(21) (A) New Type	●				
21	119.119	1297 304 402	Synchronizer Ring	2	(B) Old Type	●				
21	119.167	1297 304 484	Synchronizer Ring	2	(B) New Type	●				
22	257.001	1311 304 014	Synchronizer hub	1	(20) (A)	●				
22	157.707	1310 304 080	Synchronizer Hub	1	(21) (A)	●				
22	157.707	1310 304 080	Synchronizer Hub	1	(B)	●				
23	154.200	1304 304 597	Sliding Sleeve	1	(20) (A)	●				
23	154.135	1310 304 202	Sliding Sleeve	1	(21) (A)	●				
23	154.135	1310 304 202	Sliding Sleeve	1	(B)	●				
24		1311 204 027	Synchro Kit	1	(20) (A)	●				
24		1310 204 011	Synchro Kit	1	(21) (A)	●				
24		1310 204 011	Synchro Kit	1	(B)	●				
25	244.237	1310 304 055	Gear 3rd Speed 35 T	1	(20) (A)	●				
25	145.890	1310 304 085	Gear 3rd Speed 35 T	1	(21) (A)	●				
25	145.891	1310 304 124	Gear 3rd Speed 37 T	1	(B)	●				
26	137.270	0735 321 106	Needle Cage 80x88x48	2		●				
27	103.195	1311 304 248	Main Shaft	1		●				
28	145.892	1310 304 012	Gear 2nd Speed 43 T	1		●				
29	109.176	1312 304 106	Synchronizer Cone	2		●				
30	119.152	1268 304 424	Intermediate Synchro Ring	2		●				
31	119.153	1268 304 494	Intermediate Synchro Ring	2		●				
32	119.144	1268 304 525	Synchronizer Ring	2		●				
33	157.708	1310 304 157	Synchronizer Hub	1		●				
34	154.190	1310 304 175	Sliding Sleeve	1		●				
35	156.176	1312 304 159	Slide	3		●				
36		1310 204 026	Synchro Kit	1		●				
37	137.271	0735 321 108	Needle Cage 75x83x50	1		●				
38	145.893	1310 304 011	Gear 1st Speed 50 T	1		●				
39	157.709	1311 304 250	Fixed Hub	1		●				
40	137.795	0735 321 027	Needle Cage 70x78x40	1	(20) (A)	●				
40	137.272	0735 298 255	Needle Cage 70x86x42,5	1	(21) (A)	●				
40	137.272	0735 298 255	Needle Cage 70x86x42,5	1	(B)	●				
41	147.308	1310 304 051	Reverse Gear 46 T	1	(20) (A)	●				
41	147.238	1310 304 200	Reverse Gear 46 T	1	(21) (A)	●				
41	147.238	1310 304 200	Reverse Gear 46 T	1	(B)	●				
42	130.705	0735 370 730	Bearing 60x120x29,7	1		●				
43		1310 304 010	Output flange	1		●				
44	130.234	1246 203 007	Bearing 50,8x95,2x27,7	1		●				
45	146.600	1310 303 032	Constant Gear 47 T	1	(20-21) (A)	●				
45	146.605	1310 303 044	Constant Gear 50 T	1	(B)	●				
46	146.609	1310 303 033	Gear 6th Speed 45 T	1	(20-21) (A)	●				
46	146.610	1310 303 045	Gear 5th Speed 37 T	1	(B)	●				
47	146.787	1310 303 029	Gear 4th Speed 32 T	1	(20) (A)	●				

 ECOLITE  
S6-85
**Date**

04/2015

**Notes**(21) To be coupled together  
(20) To be coupled together

**MODELS:**

- ECOLITE

**VERSIONS:**

- S6-85 (1310 xxx xxx)

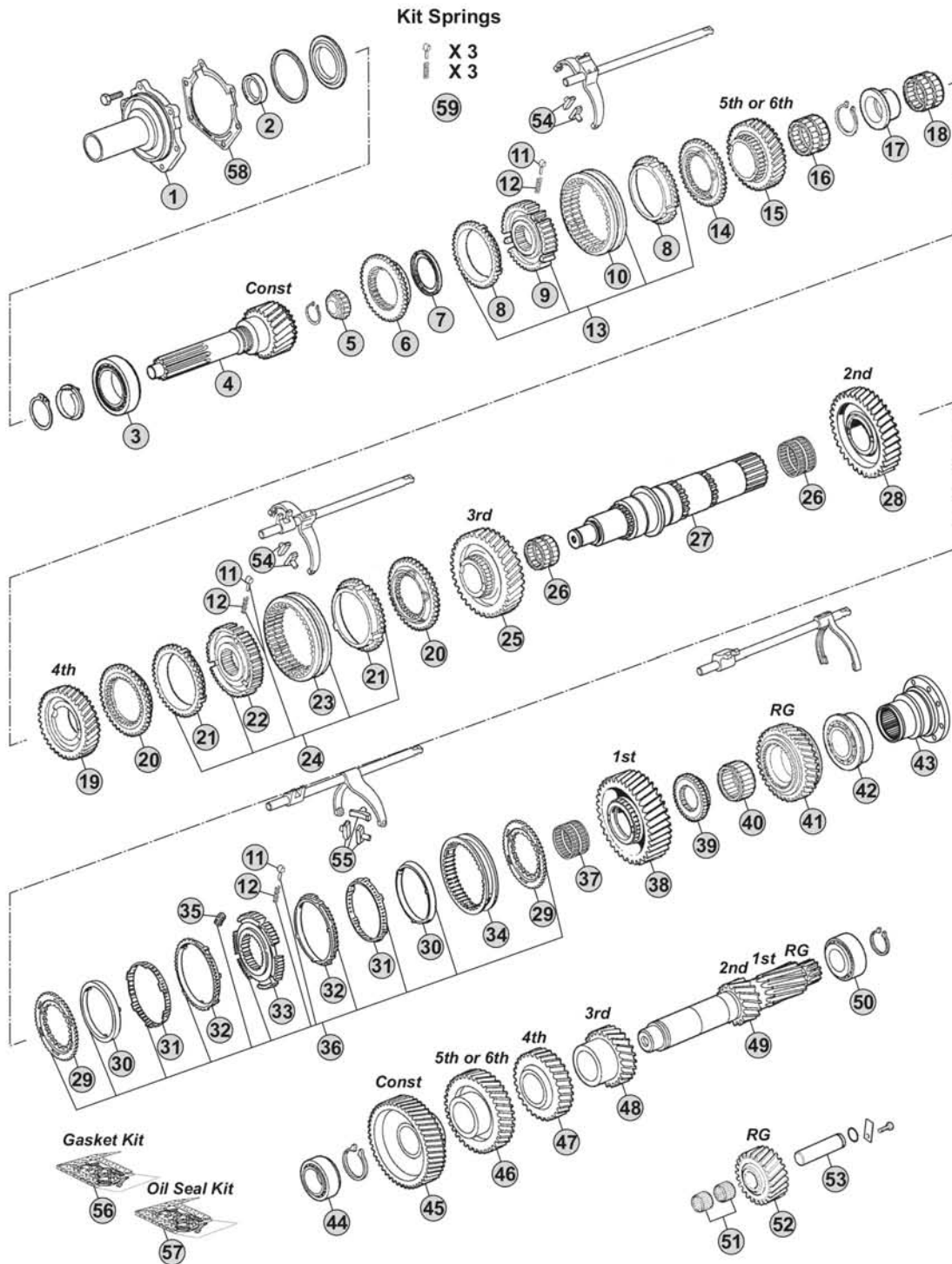

**Notes**

(A) R. 6,75-0,83

(B) R. 7,72-1,00

Our spare parts are not the originals but interchangeable with the originals ones. All original equipment manufacturers' numbers, pictures and models used in this catalogue are for reference only. Our products bear our trade-mark.

Our spare parts are not the originals but interchangeable with the originals ones. All original equipment manufacturers' numbers, pictures and models used in this catalogue are for reference only. Our products bear our trade-mark.

Fig.	CEI no.	ZF no.	Description	Q.ty	Notes	56-85				
47	146.611	1310 303 051	Gear 4th Speed 32 T	1	(21) (A)	●				
47	146.612	1310 303 050	Gear 4th Speed 29 T	1	(B)	●				
48	146.613	1310 303 031	Gear 3rd Speed 24 T	1	(20-21) (A)	●				
48	146.614	1310 303 052	Gear 3rd Speed 24 T	1	(B)	●				
49	105.191	1310 303 076	Countershaft 12/18 T	1		●				
50	130.233	1246 203 008	Bearing 44,45x95,25x27,7	1		●				
51	137.273	0750 115 233	Needle Cage 30x38x30	2		●				
52	147.309	1310 305 002	Reverse gear 21 T	1	(20) (A)	●				
52	147.239	1310 305 013	Reverse Gear 21 T	1	(21) (A)	●				
52	147.239	1310 305 013	Reverse Gear 21 T	1	(B)	●				
53	107.201	1310 305 001	Reverse Pin	1		●				
54	141.194	1290 306 066	Bronze Slide	2	2x2 pcs.	●				
55	141.194	1290 306 066	Bronze Slide	3		●				
56	298.039	1310 298 002	Gasket Kit	1		●				
57	298.040	1310 298 003	Oil Seals Kit	1		●				
58	139.959	0501 317 402	Gasket	1		●				
59	198.843	1295 298 956	Spring Slide kit	1		●				

ECOLITE  
S6-85

Date  
04/2015

Notes  
(21) To be coupled together  
(20) To be coupled together

