

MODELS:

- NEW ECOLITE

VERSIONS:

- 6S1600 (1310 xxx xxx)

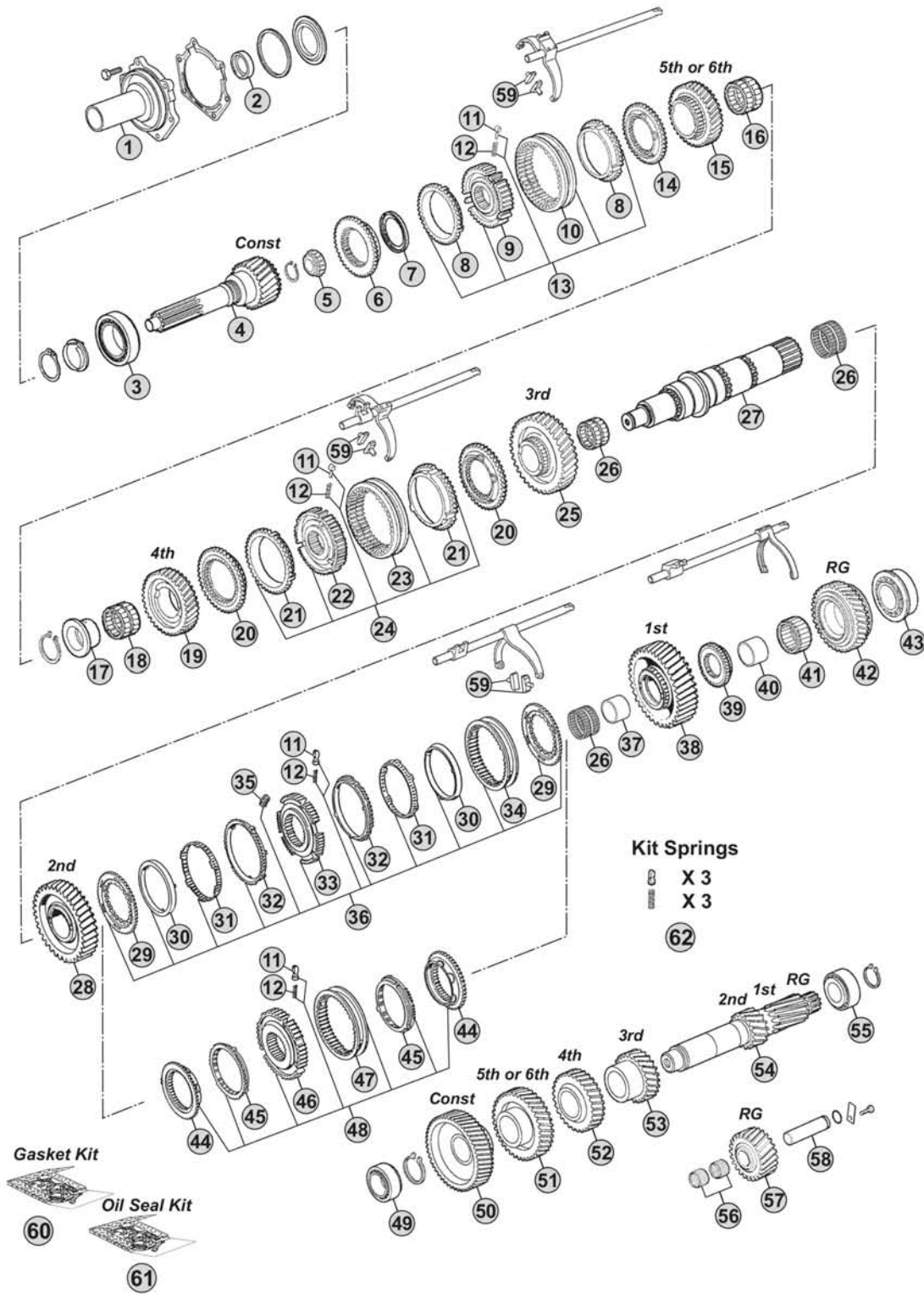

Notes

(A) R. 6,32-0,81

(B) R. 7,72-1,00

Our spare parts are not the originals but interchangeable with the originals ones. All original equipment manufacturers' numbers, pictures and models used in this catalogue are for reference only. Our products bear our trade-mark.

Fig.	CEI no.	ZF no.	Description	Q.ty	Notes	6S1600			
1	128.278	1310 302 041	Front cover	1	(20) (A)	●			
1	128.279	1310 302 075	Front cover	1	(21) (A)	●			
1	128.280	1310 302 077	Front cover	1	(21) (A)	●			
1	128.281	1310 302 080	Front cover	1	(B)	●			
1	128.282	1310 302 076	Front cover	1	(B)	●			
1	128.283	1310 302 101	Front cover	1	(B)	●			
2	139.879	0734 310 387	Oil Seal 55x75x8	1		●			
3	130.995	0750 117 326	Bearing 75x120x31	1	(20) (A)	●			
3	130.706	0750 117 518	Bearing 71,4x120x32,5	1	(21) (A)	●			
3	130.706	0750 117 518	Bearing 71,4x120x32,5	1	(B)	●			
4	102.674	1310 302 040	Input Shaft 31 T	1	(20) (A)	●			
4	102.396	1310 302 089	Input Shaft 31 T	1	(21) (A)	●			
4	102.395	1310 302 097	Input Shaft 31 T	1	(21) (A)	●			
4	102.400	1310 302 092	Input Shaft 27 T	1	(B)	●			
4	102.398	1310 302 090	Input Shaft 27 T	1	(B)	●			
4	102.397	1310 302 088	Input Shaft 27 T	1	(B)	●			
4	102.675	1310 302 119	Input Shaft 27 T	1	(B)	●			
4	102.401	1310 302 093	Input Shaft 27 T	1	(B)	●			
5	137.150	0750 117 232	Roller Bearing 42x40,30	1		●			
6	109.403	1310 302 045	Synchronizer Cone	1		●			
7	269.377	0501 315 236	Diaphragm	1		●			
8	119.118	1268 304 445	Synchronizer Ring	2	Old Type	●			
8	119.142	1268 304 594	Synchronizer Ring	2	New Type	●			
9	257.003	1310 304 159	Synchronizer Hub	1	(20) (A)	●			
9	157.710	1310 304 158	Synchronizer Hub	1	(21) (A)	●			
9	157.710	1310 304 158	Synchronizer Hub	1	(B)	●			
10	154.200	1304 304 597	Sliding Sleeve	1	(20) (A)	●			
10	154.371	1310 304 195	Sliding Sleeve	1	(21) (A)	●			
10	154.371	1310 304 195	Sliding Sleeve	1	(B)	●			
11	160.189	1297 304 436	Pressure Piece	3	3x3 pcs.	●			
12	156.140	0732 040 409	Spring De.6,5x23,50	3	3x3 pcs.	●			
13		1310 204 013	Synchro Kit	1	(20) (A)	●			
13		1310 204 016	Synchro Kit	1	(21) (A)	●			
13		1310 204 016	Synchro Kit	1	(B)	●			
14	109.404	1310 304 161	Synchronizer Cone	1		●			
15	145.894	1310 304 138	Gear 6th Speed 23 T	1	(A)	●			
15	145.895	1310 304 137	Gear 5th Speed 27 T	1	(B)	●			
16	137.274	0735 321 560	Needle Cage 65x73x48	1		●			
17	117.464	0730 162 753	Bush	1		●			
18	137.275	0735 321 392	Needle Cage 85x93x44	1		●			
19	244.238	1310 304 141	Gear 4th Speed 29 T	1	(20) (A)	●			
19	145.896	1310 304 178	Gear 4th Speed 28 T	1	(21) (A)	●			
19	145.897	1310 304 177	Gear 4th Speed 28 T	1	(B)	●			

 NEW ECOLITE
6S1600

Date

04/2015

Notes

(20) To be coupled together

(21) To be coupled together

MODELS:

- NEW ECOLITE

VERSIONS:

- 6S1600 (1310 xxx xxx)

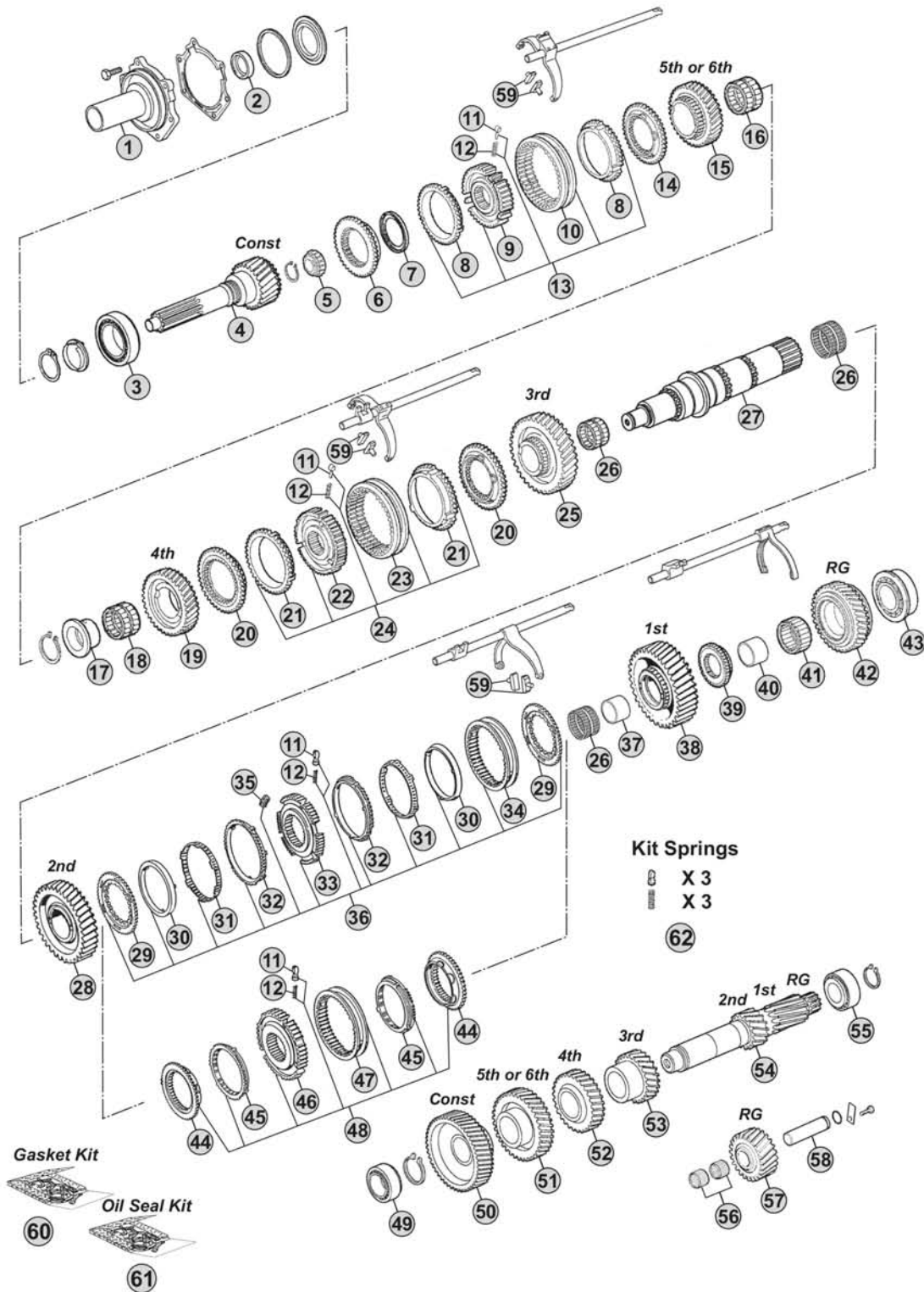

Our spare parts are not the originals but interchangeable with the originals ones. All original equipment manufacturers' numbers, pictures and models used in this catalogue are for reference only. Our products bear our trade-mark.

Notes

- (A) R. 6,32-0,81
- (B) R. 7,72-1,00

Our spare parts are not the originals but interchangeable with the originals ones. All original equipment manufacturers' numbers, pictures and models used in this catalogue are for reference only. Our products bear our trade-mark.

Fig.	CEI no.	ZF no.	Description	Q.ty	Notes	6S1600			
20	109.850	1310 304 232	Synchronizer Cone	2		●			
21	119.119	1297 304 402	Synchronizer Ring	2	Old Type	●			
21	119.167	1297 304 484	Synchronizer Ring	2	New Type	●			
22	157.180	1312 304 052	Synchronizer Hub	1		●			
23	154.357	1316 304 167	Sliding Sleeve	1		●			
24		1349 204 001	Synchro Kit	1		●			
25	244.239	1310 304 144	Gear 3rd Speed 35 T	1	(20) (A)	●			
25	145.898	1310 304 186	Gear 3rd Speed 34 T	1	(21) (A)	●			
25	145.899	1310 304 185	Gear 3rd Speed 33 T	1	(B)	●			
26	130.996	0735 321 393	Needle cage 92x100x51	3	(20) (A)	●			
26	137.276	0735 321 432	Needle Cage 92x100x49,5	3	(21) (A)	●			
26	137.276	0735 321 432	Needle Cage 92x100x49,5	3	(B)	●			
27	103.294	1310 304 135	Main Shaft	1	(20) (A)	●			
27	103.196	1310 304 189	Main Shaft	1	(21) (A)	●			
27	103.196	1310 304 189	Main Shaft	1	(B)	●			
28	244.240	1310 304 145	Gear 2nd Speed 43 T	1	(20) (A)	●			
28	145.900	1310 304 196	Gear 2nd Speed 43 T	1	(21) (A)	●			
28	145.900	1310 304 196	Gear 2nd Speed 43 T	1	(B)	●			
29	109.176	1312 304 106	Synchronizer Cone	2	(30)	●			
30	119.152	1268 304 424	Intermediate Synchro Ring	2	(30)	●			
31	119.153	1268 304 494	Intermediate Synchro Ring	2	(30)	●			
32	119.144	1268 304 525	Synchronizer Ring	2	(30)	●			
33	157.181	1312 304 158	Synchronizer Hub	1	(30)	●			
34	154.190	1310 304 175	Sliding Sleeve	1	(30)	●			
35	156.176	1312 304 159	Slide	3	(30)	●			
36	198.969	1312 298 911	Synchro Kit	1	(30)	●			
37	117.489	0730 162 750	Bush	1	(20) (A)	●			
37	117.465	0735 295 148	Bush 80,5x92x49,5	1	(21) (A)	●			
37	117.465	0735 295 148	Bush 80,5x92x49,5	1	(B)	●			
38	244.241	1310 304 146	Gear 1st Speed 50 T	1	(20) (A)	●			
38	145.901	1310 304 182	Gear 1st Speed 50 T	1	(21) (A)	●			
38	145.901	1310 304 182	Gear 1st Speed 50 T	1	(B)	●			
39	257.004	1310 304 148	Reverse synchro Hub	1	(20) (A)	●			
39	157.711	1310 304 188	Synchronizer Hub	1	(21) (A)	●			
39	157.711	1310 304 188	Synchronizer Hub	1	(B)	●			
40	117.466	0750 119 131	Bush	1		●			
41	137.277	0735 321 394	Needle Cage 82x90x47	1		●			
42	147.311	1310 304 147	Reverse Gear	1	(20) (A)	●			
42	147.240	1310 304 201	Reverse Gear 46 T	1	(21) (A)	●			
42	147.240	1310 304 201	Reverse Gear 46 T	1	(B)	●			
43	130.706	0750 117 518	Bearing 71,4x120x32,5	1		●			
44	109.132	1313 304 009	Synchronizer Cone	2	(31)	●			
45	119.122	1297 304 401	Synchronizer Ring	2	(31) Old Type	●			

NEW ECOLITE
6S1600

Date

04/2015

Notes

(20) To be coupled together

(21) To be coupled together

(30) Triple cone version. To be coupled together

(31) Single cone version. Pay attention, Ration (A) with note (20) uses ONLY triple cone version with note (30)

MODELS:

- NEW ECOLITE

VERSIONS:

- 6S1600 (1310 xxx xxx)

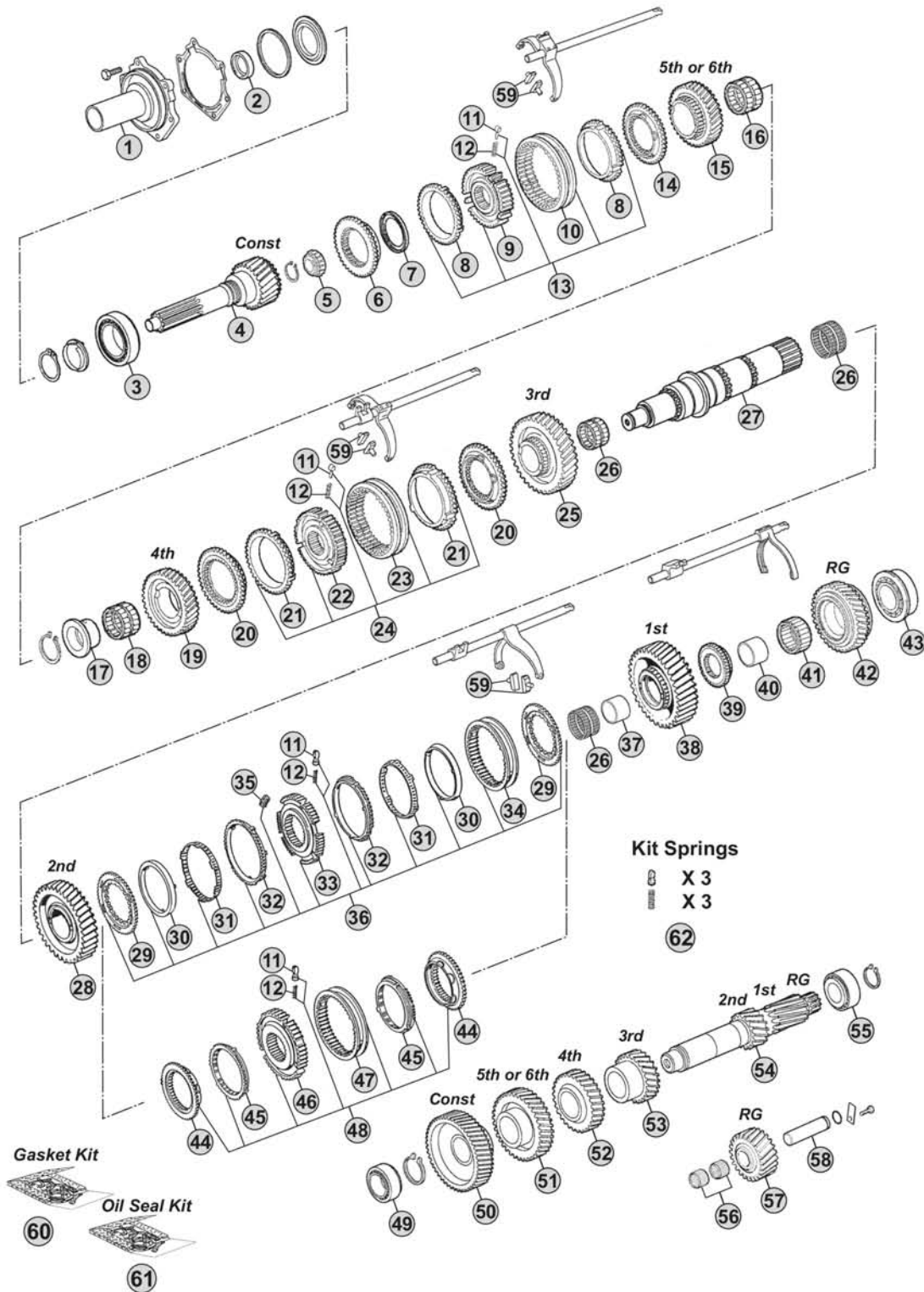

Our spare parts are not the originals but interchangeable with the originals ones. All original equipment manufacturers' numbers, pictures and models used in this catalogue are for reference only. Our products bear our trade-mark.

Notes

- (A) R. 6,32-0,81
- (B) R. 7,72-1,00

