

MODELS:

- ECOLITE

VERSIONS:

- S6-66 (1311 xxx xxx)

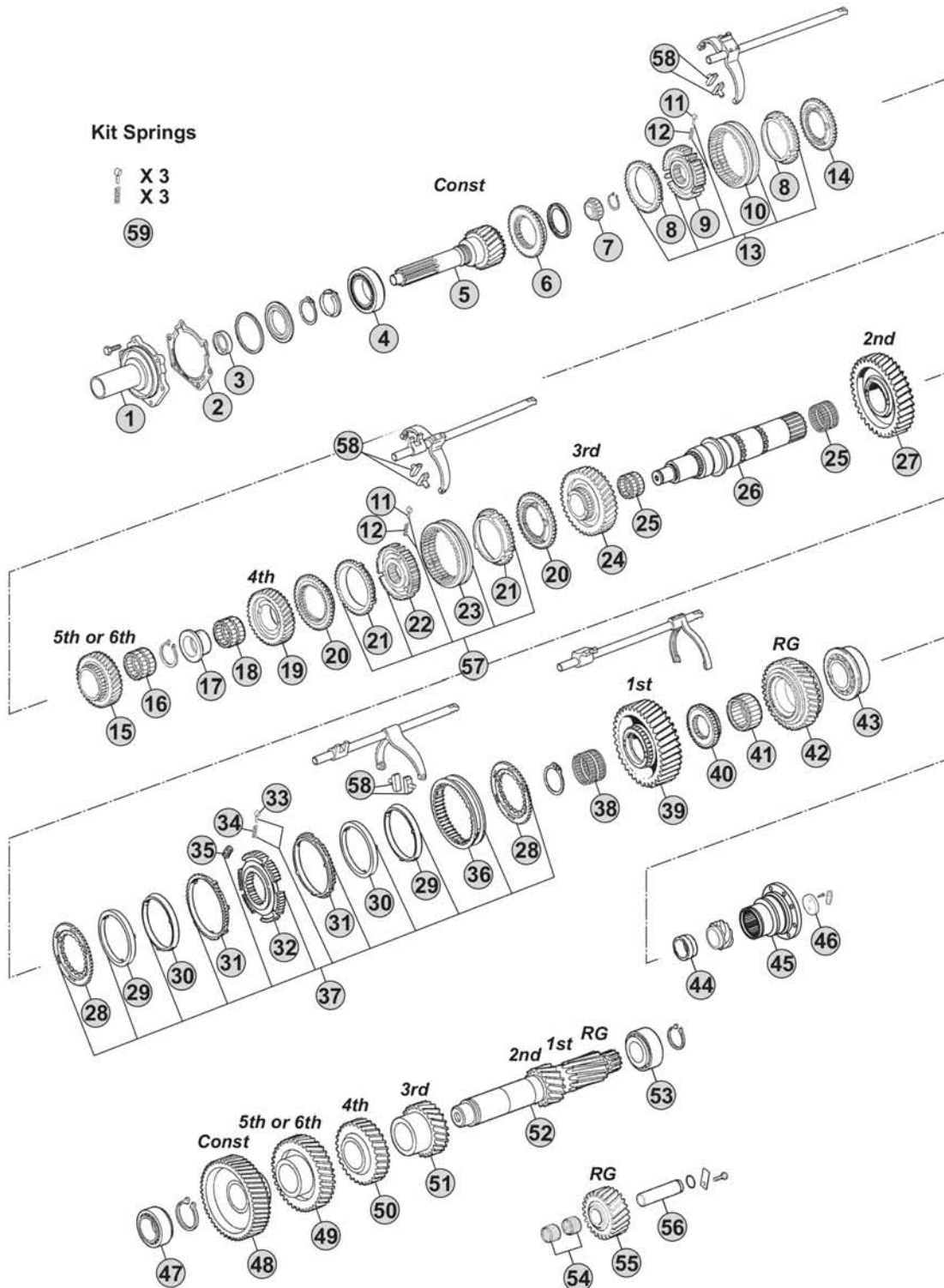

Our spare parts are not the originals but interchangeable with the originals ones. All original equipment manufacturers' numbers, pictures and models used in this catalogue are for reference only. Our products bear our trade-mark.

Notes

(A) R. 6,82-0,79

(B) R. 9,06-1,00

Our spare parts are not the originals but interchangeable with the originals ones. All original equipment manufacturers' numbers, pictures and models used in this catalogue are for reference only. Our products bear our trade-mark.

Fig.	CEI no.	ZF no.	Description	Q.ty	Notes	56-66				
1	128.277	1311 302 033	Front cover	1		●				
1	128.303	1311 302 032	Front cover	1		●				
2	139.959	0501 317 402	Gasket	1		●				
3	139.753	0750 111 149	Oil Seal 48x65x10	1		●				
4	130.704	0750 117 347	Bearing 70x115x29	1		●				
5	102.699	1311 302 051	Input Shaft	1	(A)	●				
5	102.700	1311 302 018	Input Shaft	1	(B)	●				
6	109.863	1311 302 007	Synchronizer cone	1		●				
7	137.804	0735 371 591	Needle bearing 28x32	1		●				
8	119.219	1311 304 076	Synchronizer Ring	2	Old Type	●				
8	119.220	1311 304 255	Synchronizer Ring	2	New Type	●				
9	157.706	1311 304 226	Synchronizer Hub	1		●				
10	154.363	1304 304 664	Sliding Sleeve	1		●				
11	160.189	1297 304 436	Pressure Piece	3	2x3 pcs.	●				
12	156.140	0732 040 409	Spring De.6,5x23,50	3	2x3 pcs.	●				
13		1311 204 022	Synchro Kit	1		●				
14	109.402	1311 304 009	Synchronizer Cone	1		●				
15	244.287	1311 304 206	Gear 5th Speed	1	(A)	●				
15	244.288	1311 304 204	Gear 5th Speed	1	(B)	●				
16	137.269	0735 321 678	Needle Cage 52x60x23	1		●				
17	117.384	1311 304 124	Bush	1		●				
18	137.078	0735 320 493	Needle Cage 70x78x36,50	1		●				
19	244.289	1311 304 201	Gear 4th Speed	1		●				
20	109.392	1311 304 015	Synchronizer Cone	2		●				
21	119.118	1268 304 445	Synchronizer Ring	2	Old Type	●				
21	119.142	1268 304 594	Synchronizer Ring	2	New Type	●				
22	257.001	1311 304 014	Synchronizer hub	1		●				
23	154.200	1304 304 597	Sliding Sleeve	1		●				
24	244.290	1311 304 199	Gear 3rd Speed	1		●				
25	137.270	0735 321 106	Needle Cage 80x88x48	2		●				
26	103.195	1311 304 248	Main Shaft	1		●				
27	244.291	1311 304 197	Gear 2nd Speed	1		●				
28	109.858	6002 305 893	Synchronizer cone	2		●				
29	119.342	1311 304 022	Synchronizer Ring	2		●				
30	119.343	1311 304 078	Intermediate synchro ring	2		●				
31	119.344	1311 304 024	Outer synchro ring	2		●				
32	257.002	1311 304 251	Synchronizer hub	1		●				
33	160.189	1297 304 436	Pressure Piece	3		●				
34	156.140	0732 040 409	Spring De.6,5x23,50	3		●				
35	156.176	1312 304 159	Slide	3		●				
36	154.499	6002 305 973	Sliding sleeve	1		●				
37	298.358	1311 204 025	Synchro Kit	1		●				
38	137.271	0735 321 108	Needle Cage 75x83x50	1		●				

 ECOLITE
S6-66

Date

Notes

04/2015

MODELS:

- ECOLITE

VERSIONS:

- S6-66 (1311 xxx xxx)

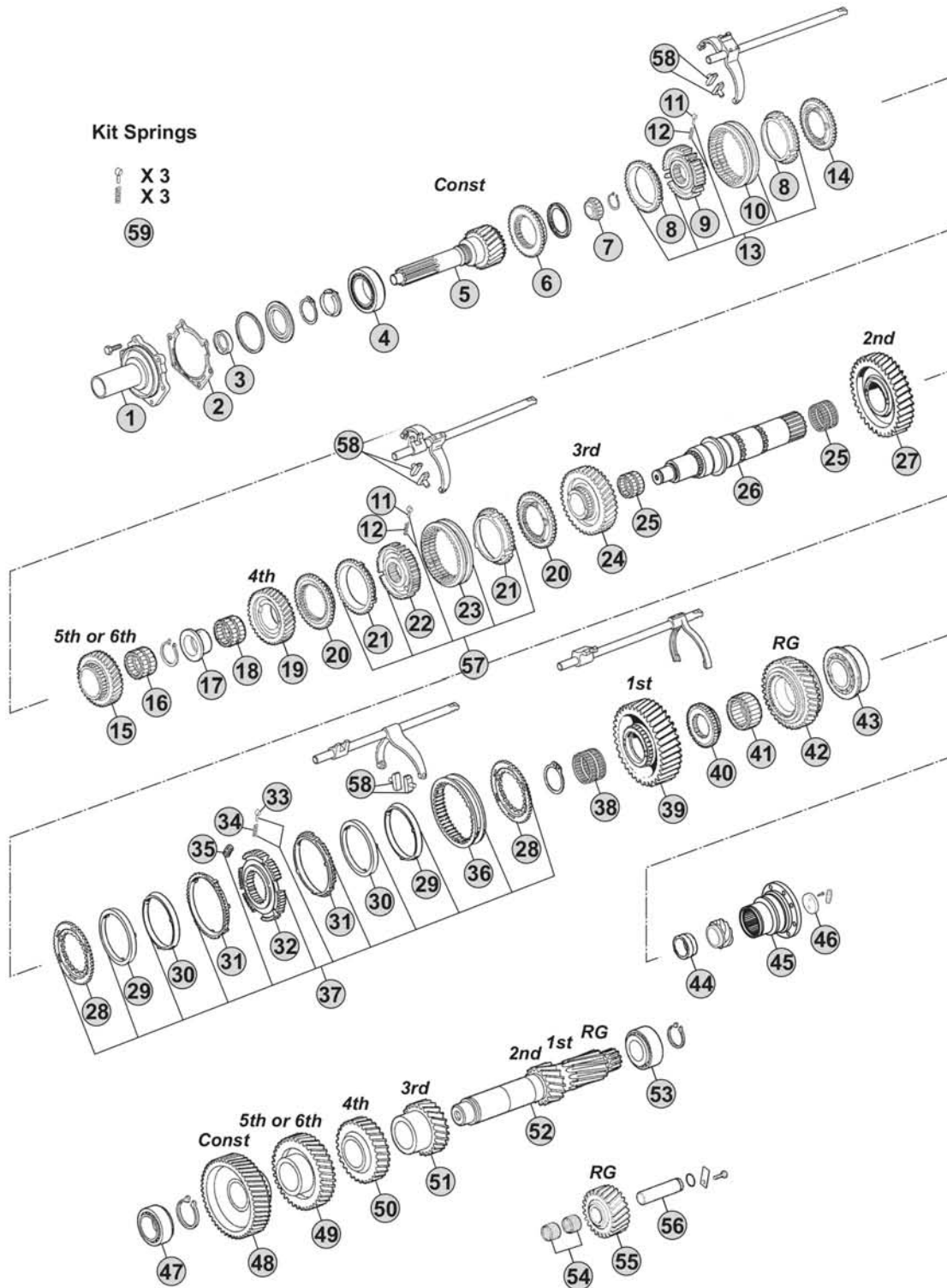

Notes

(A) R. 6,82-0,79

(B) R. 9,06-1,00

Our spare parts are not the originals but interchangeable with the originals ones. All original equipment manufacturers' numbers, pictures and models used in this catalogue are for reference only. Our products bear our trade-mark.

Fig.	CEI no.	ZF no.	Description	Q.ty	Notes	56-66			
39	244.292	1311 304 195	Gear 1st Speed	1		●			
40	157.709	1311 304 250	Fixed Hub	1		●			
41	137.272	0735 298 255	Needle Cage 70x86x42,5	1		●			
42	244.293	1311 304 249	Reverse Gear	1		●			
43	130.705	0735 370 730	Bearing 60x120x29,7	1		●			
44	117.493	1311 304 055	Bush	1		●			
45		1310 304 010	Output flange	1		●			
45		1311 304 081	Output flange	1		●			
46	269.753	1250 304 218	Washer	1		●			
47	130.234	1246 203 007	Bearing 50,8x95,2x27,7	1		●			
48	146.835	1311 303 052	Constant Gear	1	(A)	●			
48	146.836	1311 303 033	Constant Gear 52 T	1	(B)	●			
49	146.837	1311 303 039	Gear 6th Speed	1	(A)	●			
49	146.838	1311 303 032	Gear 5th Speed	1	(B)	●			
50	146.839	1311 303 025	Gear 4th Speed	1		●			
51	146.840	1311 303 047	Gear 3rd Speed 24 T	1		●			
52	105.295	1311 203 002	Countershaft	1		●			
53	130.233	1246 203 008	Bearing 44,45x95,25x27,7	1		●			
54	137.273	0750 115 233	Needle Cage 30x38x30	2		●			
55	147.317	1311 305 007	Reverse Gear 19 T	1		●			
56	107.201	1310 305 001	Reverse Pin	1		●			
57		1311 204 027	Synchro Kit	1		●			
58	141.194	1290 306 066	Bronze Slide	2	3x2 pcs.	●			
59	198.843	1295 298 956	Spring Slide kit	1		●			

ECOLITE
S6-66

Date: 04/2015 Notes: _____

